

RoHS

MAPX

MODIFICATION

DRW

DATE

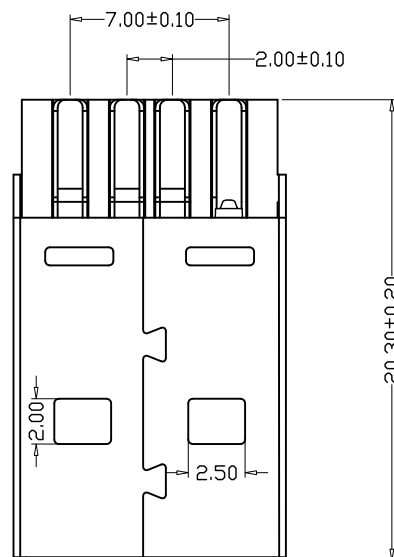
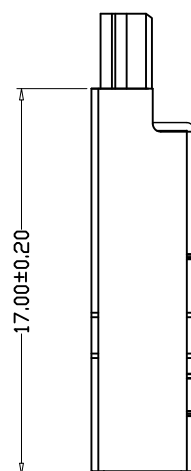
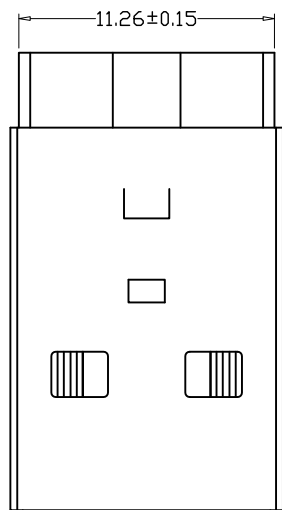
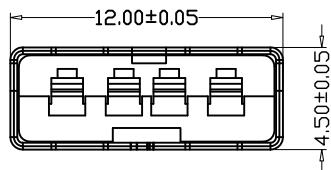

NOTES:

- Housing: Thermoplastics
- Contact: Copper Alloy
- Shell: Copper Alloy/Steel
- Voltage Current Rating:1.5 AMP, 30V AC
- Insulation Resistance:1000MΩ Min.
- Contact Resistance:30 MΩ Max.
- Dielectric Withstanding Voltage:500W AC
- Temperature Range:-55° C to +85° C
- Insulator color: Black/White
- Plastic material:PBT/LCP
- Shell finish:Nickel plated/Tin-Lead plated
- Contact finish:
  - 01:Selective Gold Flash
  - 02:Selective Gold 3U"
  - 03:Selective Gold 5U"
  - 04:Selective Gold 15U"
  - 05:Selective Gold 30U"

产品图

PRODUCT CHART DWG

公差一览表

TOLERANCE UNLESS OTHERWISE			
X	±0.30	X	±5.°
.X	±0.25	.XX	±2.°
.XX	±0.15	.XXX	±1.°
.XXX	±0.10	.XXX	±0.5°

深圳市精拓金电子有限公司  
Shenzhen Jing Tuo Jin Electronics Co., Ltd.

单位 UNITS	MM	制图 DRAWING	许榕强	制图料号 PRODUCT PART NO.	917-141B101AAX0220
比例 SCALE	1:1	审核 CHKD	郭治富	产品名称 PRODUCT NAME	AM A款一体式双卡点无脚正面铆脚 铁壳反向PBT白胶1U 17MM
日期 DATE	2018-11-27	核准 APPD	黄国荣	角法 VIEW	版本 VER
					AO