

Coaxial

# Power Splitter/Combiner

2 Way-0° 50Ω 2000 to 10000 MHz

ZFSC-2-10G+  
ZFSC-2-10G



CASE STYLE: JJJ142

Connectors	Model	Price	Qty.
SMA	ZFSC-2-10G-S(+)	\$69.95	(1-9)

+ RoHS compliant in accordance with EU Directive (2002/95/EC)

The +Suffix identifies RoHS Compliance. See our web site for RoHS Compliance methodologies and qualifications.

## Maximum Ratings

Operating Temperature	-55°C to 100°C
Storage Temperature	-55°C to 100°C
Power Input (as a splitter)	1W max.
Internal Dissipation	0.125W max.

## Coaxial Connections

SUMPORT	S
PORT 1	1
PORT 2	2

## Outline Drawing

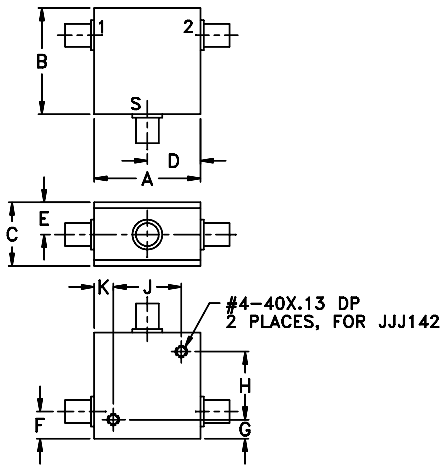

## Outline Dimensions (inch/mm)

A	B	C	D	E	F
1.25	1.25	.75	.63	.38	.32
31.75	31.75	19.05	16.00	9.65	8.13
G	H	J	K	wt	
.23	.800	.800	.23	grams	
5.84	20.32	20.32	5.84	70.0	

## Features

- very wideband, 2000 to 10000 MHz
- low insertion loss, 0.5 dB typ.
- excellent amplitude unbalance, 0.1 dB typ.
- rugged shielded case

## Applications

- instrumentation
- satellite communications
- defense communications

## Splitter Electrical Specifications

FREQ. RANGE (MHz)	ISOLATION (dB)				INSERTION LOSS (dB) ABOVE 3.0 dB				PHASE UNBALANCE (Degrees)		AMPLITUDE UNBALANCE (dB)	
	L		U		L		U		L	U	L	U
	Typ.	Min.	Typ.	Min.	Typ.	Max.	Typ.	Max.	Max.	Max.	Max.	Max.
2000-10000	15	9	20	12	0.5	1.5	0.6	1.6	7	12	0.6	0.5

L =  $f_L$  to 6 GHz U = 6 GHz to  $f_U$

## Typical Performance Data

Frequency (MHz)	Insertion Loss (dB)		Amplitude Unbalance (dB)	Isolation (dB)	Phase Unbalance (deg.)	VSWR S	VSWR 1	VSWR 2
	S-1	S-2						
2000	3.56	3.60	0.04	11.59	0.17	1.75	1.41	1.39
2100	3.58	3.61	0.02	12.13	0.26	1.74	1.38	1.37
2500	3.28	3.29	0.02	14.31	0.59	1.67	1.32	1.30
3000	3.50	3.54	0.04	17.98	0.45	1.52	1.28	1.28
4000	3.28	3.36	0.08	26.34	0.77	1.13	1.24	1.27
4800	3.23	3.29	0.06	24.52	0.92	1.04	1.16	1.19
5000	3.31	3.37	0.05	23.24	0.78	1.06	1.13	1.16
5500	3.69	3.75	0.06	19.67	1.04	1.17	1.07	1.08
6000	3.60	3.61	0.01	18.65	0.66	1.31	1.11	1.12
7000	3.79	3.77	0.03	20.54	1.11	1.35	1.18	1.17
8000	3.60	3.57	0.03	19.11	0.90	1.30	1.31	1.28
9000	3.60	3.55	0.05	18.60	1.30	1.49	1.46	1.42
9800	3.91	3.87	0.04	14.90	1.69	1.87	1.45	1.40
9900	4.02	3.98	0.04	14.21	1.30	1.93	1.44	1.39
10000	3.99	3.95	0.04	13.68	1.70	2.00	1.43	1.38

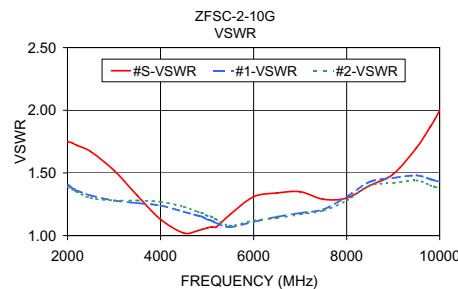
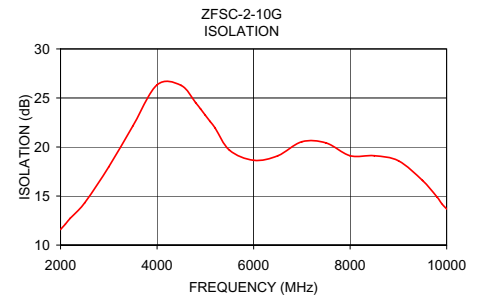
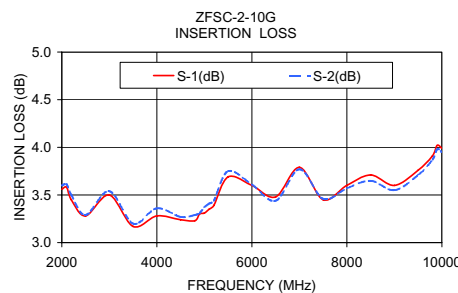

## electrical schematic

