



# MS85049/96

## 1/4 Perimeter Nut Plate for Flange Mount Receptacle Connector

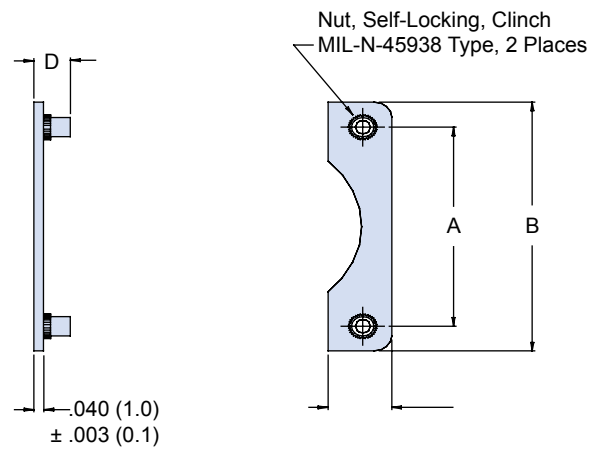
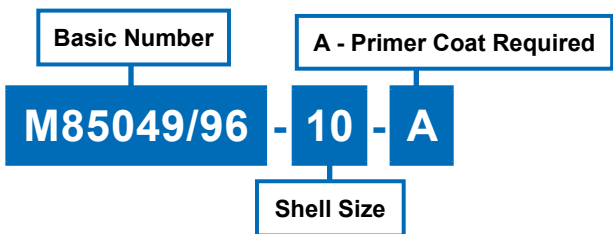

TABLE I									
Shell Size	Thread UNJC-3B	A		B		C		D	
		± .003 (0.1)		± .015 (0.4)		+ .015 (.4) - .000 (.0)		± .030 (0.8)	
3	4-40	.625	(15.9)	.925	(23.5)	.300	(7.6)	.136	(3.5)
7	4-40	.719	(18.3)	1.016	(25.8)	.298	(7.6)	.136	(3.5)
8	4-40	.594	(15.1)	.891	(22.6)	.296	(7.5)	.136	(3.5)
10	4-40	.719	(18.3)	1.016	(25.8)	.298	(7.6)	.136	(3.5)
12	4-40	.812	(20.6)	1.109	(28.2)	.296	(7.5)	.136	(3.5)
14	4-40	.906	(23.0)	1.203	(30.6)	.296	(7.5)	.136	(3.5)
16	4-40	.969	(24.6)	1.266	(32.2)	.298	(7.6)	.136	(3.5)
18	4-40	1.062	(27.0)	1.390	(35.3)	.328	(8.3)	.136	(3.5)
19	4-40	.906	(23.0)	1.203	(30.6)	.296	(7.5)	.136	(3.5)
20	4-40	1.156	(29.4)	1.510	(38.4)	.354	(9.0)	.136	(3.5)
22	4-40	1.250	(31.8)	1.640	(41.7)	.390	(9.9)	.136	(3.5)
24	6-32	1.375	(34.9)	1.760	(44.7)	.386	(9.8)	.153	(3.9)
25	6-32	1.500	(38.1)	1.859	(47.2)	.358	(9.1)	.153	(3.9)
27	4-40	.969	(24.6)	1.266	(32.2)	.298	(7.6)	.136	(3.5)
28	6-32	1.562	(39.7)	2.000	(50.8)	.438	(11.1)	.153	(3.9)
32	6-32	1.750	(44.5)	2.312	(58.7)	.562	(14.3)	.153	(3.9)
36	6-32	1.938	(49.2)	2.500	(63.5)	.562	(14.3)	.153	(3.9)
37	4-40	1.187	(30.1)	1.500	(38.1)	.314	(8.0)	.136	(3.5)
61	4-40	1.437	(36.5)	1.812	(46.0)	.376	(9.6)	.136	(3.5)

