

A. Electrical Specifications:

P/N	Turns	L (nH)	Tol.	Q Min.	Test Freq. MHz	DCR Max. (mΩ)	SRF Typ. (GHz)	I DC Max. (A)
LSQ0807A-6N9_	3	6.9	J, K	100	400	6.0	4.6	2.7
LSQ0807A-10N_	4	10.2	J, K	100	400	7.0	4.0	2.7
LSQ0807A-11N_	4	11.2	J, K	90	400	6.3	3.6	2.7
LSQ0807A-14N_	5	13.7	J, K	100	400	8.0	4.3	2.7
LSQ0807A-17N_	6	17.0	J, K	100	400	9.0	4.0	2.7
LSQ0807A-22N_	7	22.0	J, K	100	400	10.0	3.5	2.7

B. Dimensions: mm (Inch)

Series	a	b	c	d	e	f
LSQ0807A-6N9	1.295 (0.051)	1.829 (0.072)	1.524 (0.060)	1.02 (0.040)	2.600 (0.102)	0.510 (0.02)
Tol.	±0.102 (0.004)	±0.254 (0.010)	±0.254 (0.010)	Typ.	Typ.	Typ.
LSQ0807A-10N	1.626 (0.064)	1.829 (0.072)	1.524 (0.060)	1.32 (0.052)	2.600 (0.102)	0.510 (0.02)
Tol.	±0.152 (0.006)	±0.254 (0.010)	±0.254 (0.010)	Typ.	Typ.	Typ.
LSQ0807A-11N	1.549 (0.061)	1.829 (0.072)	1.524 (0.060)	1.24 (0.049)	2.600 (0.102)	0.510 (0.02)
Tol.	±0.152 (0.006)	±0.254 (0.010)	±0.254 (0.010)	Typ.	Typ.	Typ.
LSQ0807A-14N	1.930 (0.076)	1.829 (0.072)	1.524 (0.060)	1.63 (0.064)	2.600 (0.102)	0.510 (0.02)
Tol.	±0.152 (0.006)	±0.254 (0.010)	±0.254 (0.010)	Typ.	Typ.	Typ.
LSQ0807A-17N	2.286 (0.090)	1.829 (0.072)	1.524 (0.060)	1.96 (0.077)	2.600 (0.102)	0.510 (0.02)
Tol.	±0.152 (0.006)	±0.254 (0.010)	±0.254 (0.010)	Typ.	Typ.	Typ.
LSQ0807A-22N	2.591 (0.102)	1.829 (0.072)	1.524 (0.060)	2.29 (0.090)	2.600 (0.102)	0.510 (0.02)
Tol.	±0.152 (0.006)	±0.254 (0.010)	±0.254 (0.010)	Typ.	Typ.	Typ.

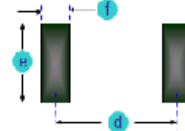
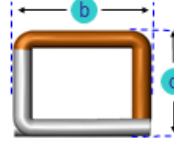
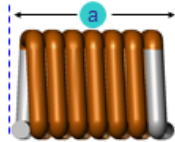
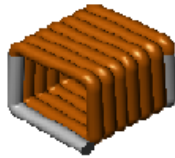

C. General Information:

1. LSQ0807A-xxx_, "LSQ0807A" = P/N, "xxx" = Inductance, "_" = Tolerance.
2. Tolerance "_": K: ± 10%, J: ± 5%
3. Test Frequency: 400MHz, 0.1Vrms.
4. Small and lightweight surface mounting type
5. High Q at high frequency
6. High self-resonance frequency
7. Maximum Temperature Rise: 15°C (when measured at 25°C ambient).
8. Inductance & Q measured with HP4291B Impedance Analyzer with HP16193 test fixture
9. SRF measured using the HP8753E Network Analyzer or equivalent.
10. DCR measured using the Chroma 16502 or equivalent.
11. Operating temperature: -40°C to +125°C
12. Storage temp. : -40°C to +85°C.
13. Inductance and Current Range: From 6.9 nH (2700 mA) to 22.0 nH (2700 mA)
14. SRF: From 3500 MHz to 4600 MHz
15. MSL: Level 1.



D. Applications:

- 1. Game Consoles
- 2. Set Top Boxes
- 3. Cables Modems
- 4. Computers
- 5. Mobile Communication Devices (Cell Phones, Radios)
- 6. RF Filters

E. Characteristics curve:

Inductance vs. Frequency

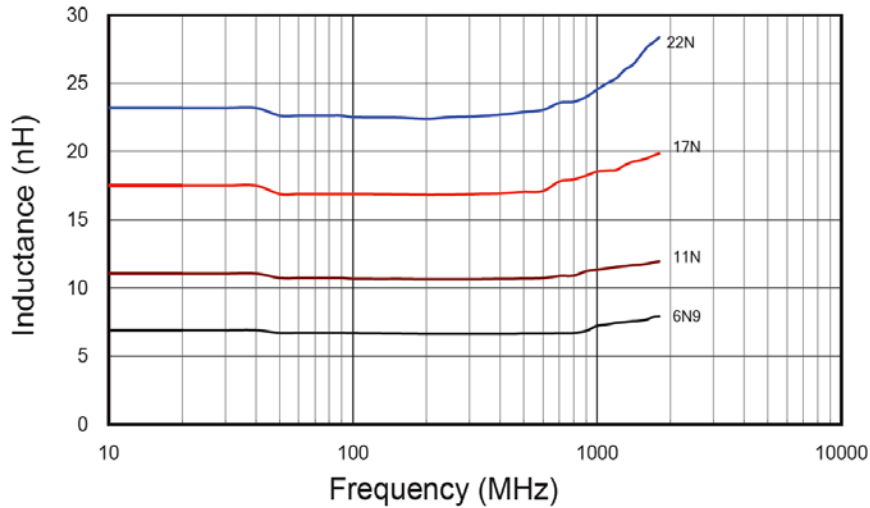

Typical Q vs. Frequency

