

Surface Mount Fuse, 1.05 x 0.55 mm, Super-Quick-Acting FF, 32 VDC



Exemplary part photo depending on part no.

UL 248-14 · 32VDC · Super-Quick-Acting FF



**Description**

- UL characteristic
- Low melting I<sup>2</sup>t-values, fast interruption
- Marking optional
- Impermeable to potting compound

**Standards**

- UL 248-14
- CSA C22.2 no. 248.14

**Approvals**

- UL File Number: E41599

**Applications**

- Secondary Protection
- Circuits without inrush
- Semiconductor protection
- Digital Consumer Electronics

**References**

[Packaging Details](#)

**Weblinks**

[pdf-datasheet](#), [html-datasheet](#), [General Product Information](#), [Packaging details](#), [Approvals](#), [CE declaration of conformity](#), [RoHS](#), [CHINA-RoHS](#), [REACH](#), [Distributor-Stock-Check](#), [Detailed request for product](#)

**Technical Data**

|                              |                               |
|------------------------------|-------------------------------|
| Rated Voltage                | 24 - 32VDC                    |
| Rated current                | 0.375 - 5 A                   |
| Breaking Capacity            | 35 A                          |
| Characteristic               | Super-Quick-Acting FF         |
| Mounting                     | PCB,SMT                       |
| Admissible Ambient Air Temp. | -55 °C to 125 °C              |
| Climatic Category            | 55/125/21 acc. to IEC 60068-1 |
| Material: Housing            | Thermoset                     |
| Material: Terminals          | Gold-Plated Copper Alloy      |
| Unit Weight                  | 0.004 g                       |
| Storage Conditions           | 0 °C to 60 °C, max. 70% r.h.  |
| Product Marking              | Letter (see variants) marking |

|                              |  |
|------------------------------|--|
| Soldering Methods            | Reflow<br><a href="#">Soldering Profile</a>                |
| Solderability                | 245 °C / 3sec acc. to IEC 60068-2-58, Test Td              |
| Resistance to Soldering Heat | 260 +0/-5 °C / 30sec acc. to IPC/JEDEC J-STD-020D, 1 cycle |
| Flammability                 | min. UL 94V-1<br>(acc. to EIA/IS-722, Test 4.12)           |

**Dimension**

H 1.05 mm

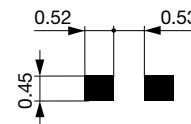
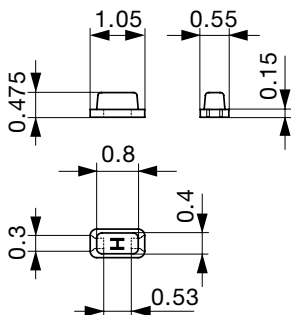

Soldering pads

**Pre-Arcing Time**

| Rated Current I <sub>n</sub> | 1.0 x I <sub>n</sub> min | 2.0 x I <sub>n</sub> max |
|------------------------------|--------------------------|--------------------------|
| 0.375 A - 5 A                | 4 h                      | 5 s                      |

Time-Current-Curves

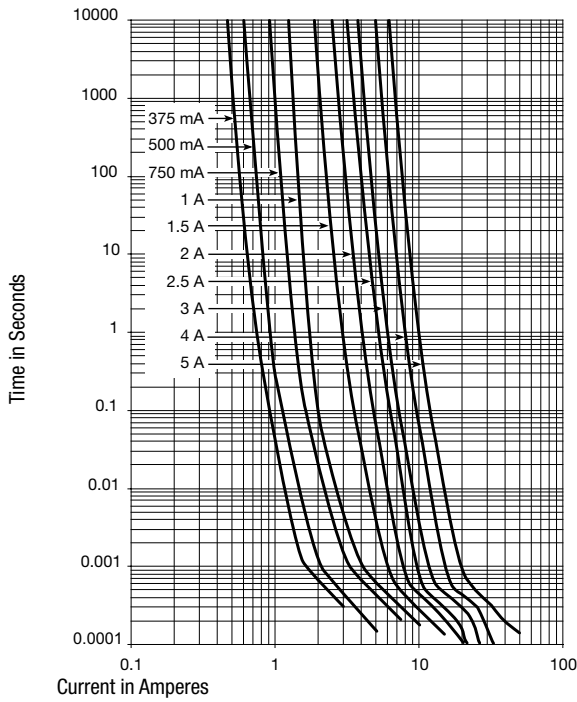

All Variants

| Rated Current [A] | Rated Voltage [VDC] | Marking | Breaking Capacity | Voltage Drop 1.0 In max. [mV] | Voltage Drop 1.0 In typ. [mV] | Cold Resistance typ. [mΩ] | Melting I <sup>2</sup> t 8.0 In typ. [A <sup>2</sup> s] |  | Order Number |
|-------------------|---------------------|---------|-------------------|-------------------------------|-------------------------------|---------------------------|---|---|--------------|
| 0.375             | 32                  | E       | 1)                | 90                            | 70                            | 173                       | 0.003   | ●   | 3414.0112.11 |
| 0.375             | 32                  | E       | 1)                | 90                            | 70                            | 173                       | 0.003   | ●   | 3414.0112.22 |
| 0.375             | 32                  | E       | 1)                | 90                            | 70                            | 173                       | 0.003   | ●   | 3414.0112.24 |
| 0.375             | 32                  | E       | 1)                | 90                            | 70                            | 173                       | 0.003   | ●   | 3414.0112.26 |
| 0.5               | 32                  | F       | 1)                | 90                            | 67                            | 124                       | 0.004   | ●   | 3414.0113.11 |
| 0.5               | 32                  | F       | 1)                | 90                            | 67                            | 124                       | 0.004   | ●   | 3414.0113.22 |
| 0.5               | 32                  | F       | 1)                | 90                            | 67                            | 124                       | 0.004   | ●   | 3414.0113.24 |
| 0.5               | 32                  | F       | 1)                | 90                            | 67                            | 124                       | 0.004   | ●   | 3414.0113.26 |
| 0.75              | 32                  | G       | 1)                | 90                            | 63                            | 78                        | 0.009   | ●   | 3414.0114.11 |
| 0.75              | 32                  | G       | 1)                | 90                            | 63                            | 78                        | 0.009   | ●   | 3414.0114.22 |
| 0.75              | 32                  | G       | 1)                | 90                            | 63                            | 78                        | 0.009   | ●   | 3414.0114.24 |
| 0.75              | 32                  | G       | 1)                | 90                            | 63                            | 78                        | 0.009   | ●   | 3414.0114.26 |
| 1                 | 32                  | H       | 1)                | 90                            | 63                            | 57                        | 0.016   | ●   | 3414.0115.11 |
| 1                 | 32                  | H       | 1)                | 90                            | 63                            | 57                        | 0.016   | ●   | 3414.0115.22 |
| 1                 | 32                  | H       | 1)                | 90                            | 63                            | 57                        | 0.016   | ●   | 3414.0115.24 |
| 1                 | 32                  | H       | 1)                | 90                            | 63                            | 57                        | 0.016   | ●   | 3414.0115.26 |
| 1.5               | 32                  | K       | 1)                | 90                            | 62                            | 37                        | 0.029   | ●   | 3414.0117.11 |
| 1.5               | 32                  | K       | 1)                | 90                            | 62                            | 37                        | 0.029   | ●   | 3414.0117.22 |
| 1.5               | 32                  | K       | 1)                | 90                            | 62                            | 37                        | 0.029   | ●   | 3414.0117.24 |
| 1.5               | 32                  | K       | 1)                | 90                            | 62                            | 37                        | 0.029   | ●   | 3414.0117.26 |
| 2                 | 32                  | N       | 1)                | 90                            | 58                            | 26                        | 0.044   | ●   | 3414.0119.11 |
| 2                 | 32                  | N       | 1)                | 90                            | 58                            | 26                        | 0.044   | ●   | 3414.0119.22 |
| 2                 | 32                  | N       | 1)                | 90                            | 58                            | 26                        | 0.044   | ●   | 3414.0119.24 |
| 2                 | 32                  | N       | 1)                | 90                            | 58                            | 26                        | 0.044   | ●   | 3414.0119.26 |
| 2.5               | 32                  | O       | 1)                | 90                            | 59                            | 21                        | 0.06  | ●   | 3414.0120.11 |
| 2.5               | 32                  | O       | 1)                | 90                            | 59                            | 21                        | 0.06  | ●   | 3414.0120.22 |
| 2.5               | 32                  | O       | 1)                | 90                            | 59                            | 21                        | 0.06  | ●   | 3414.0120.24 |
| 2.5               | 32                  | O       | 1)                | 90                            | 59                            | 21                        | 0.06  | ●   | 3414.0120.26 |
| 3                 | 32                  | P       | 1)                | 90                            | 52                            | 17                        | 0.098   | ●   | 3414.0121.11 |

| Rated Current [A] | Rated Voltage [VDC] | Marking | Breaking Capacity | Voltage Drop 1.0 In max. [mV] | Voltage Drop 1.0 In typ. [mV] | Cold Resistance typ. [mΩ] | Melting I <sup>2</sup> t 8.0 In typ. [A <sup>2</sup> s] |  | Order Number |
|-------------------|---------------------|---------|-------------------|-------------------------------|-------------------------------|---------------------------|---|---|--------------|
| 3                 | 32                  | P       | 1)                | 90                            | 52                            | 17                        | 0.098   | ●   | 3414.0121.22 |
| 3                 | 32                  | P       | 1)                | 90                            | 52                            | 17                        | 0.98  | ●   | 3414.0121.24 |
| 3                 | 32                  | P       | 1)                | 90                            | 52                            | 17                        | 0.98  | ●   | 3414.0121.26 |
| 4                 | 32                  | S       | 1)                | 90                            | 60                            | 13                        | 0.113   | ●   | 3414.0123.11 |
| 4                 | 32                  | S       | 1)                | 90                            | 60                            | 13                        | 0.113   | ●   | 3414.0123.22 |
| 4                 | 32                  | S       | 1)                | 90                            | 60                            | 13                        | 0.113   | ●   | 3414.0123.24 |
| 4                 | 32                  | S       | 1)                | 90                            | 60                            | 13                        | 0.113   | ●   | 3414.0123.26 |
| 5                 | 24                  | T       | 2)                | 90                            | 52                            | 10                        | 0.288   | ●   | 3414.0124.11 |
| 5                 | 24                  | T       | 2)                | 90                            | 52                            | 10                        | 0.288   | ●   | 3414.0124.22 |
| 5                 | 24                  | T       | 2)                | 90                            | 52                            | 10                        | 0.288   | ●   | 3414.0124.24 |
| 5                 | 24                  | T       | 2)                | 90                            | 52                            | 10                        | 0.288   | ●   | 3414.0124.26 |

Most Popular.

Availability for all products can be searched real-time:<http://www.schurter.com/Stock-Check/Stock-Check-SCHURTER>

1) 35 A @ 32 VDC

2) 35 A @ 24 VDC

Marking is optional: .xx.M = with Marking (e.g. 3414.0112.22.M)

#### Packaging Unit

- .xx = .11 Blister Tape of 100 pcs. in Plastic Bag
- .xx = .22 Blister Tape 18 cm Reel (1000 pcs.)
- .xx = .24 Blister Tape 18 cm Reel (5000 pcs.)
- .xx = .26 Blister Tape 33 cm Reel (15000 pcs.)