

SMD Power Inductor (PSCD-0403 Series)

Dimensions

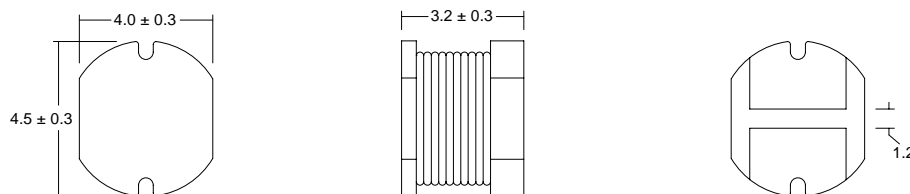

(Not to scale)

Dimensions in mm

Part Numbering Guide

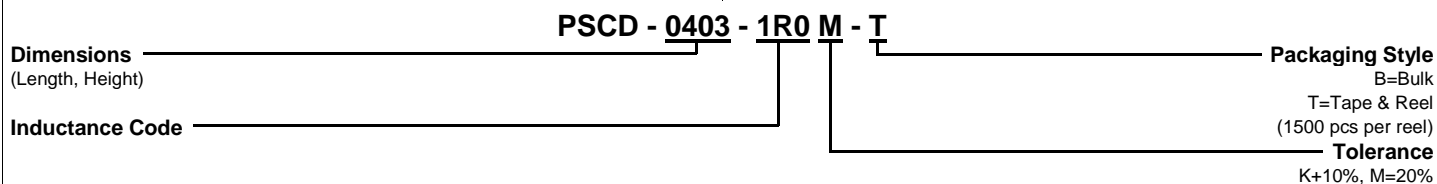

Features

Inductance Range	1.0 μ H to 27 μ H
Tolerance	10%, 20% (see below for tolerance availability)
Construction	Magnetically Shielded

Electrical Specifications

Inductance Code	Inductance (μ H)	Available Tolerance	Test Freq (MHz)	DCR Max (Ohms)	Permissible DC Current
1R0	1.0	M	7.96	0.033	3.80
1R4	1.4	M	7.96	0.038	3.30
1R8	1.8	M	7.96	0.042	2.91
2R2	2.2	M	7.96	0.047	2.60
2R7	2.7	M	7.96	0.052	2.43
3R3	3.3	M	7.96	0.058	2.15
3R9	3.9	M	7.96	0.076	1.98
4R7	4.7	M	7.96	0.094	1.70
5R6	5.6	M	7.96	0.101	1.60
6R8	6.8	M	7.96	0.117	1.41
8R2	8.2	M	7.96	0.132	1.26
100	10	M	2.52	0.182	1.15
120	12	M	2.52	0.210	1.05
150	15	M	2.52	0.235	0.92
180	18	M	2.52	0.338	0.84
220	22	M	2.52	0.378	0.76
270	27	M	2.52	0.522	0.71
330	33	K, M	2.52	0.540	0.64
390	39	K, M	2.52	0.587	0.59
470	47	K, M	2.52	0.844	0.54
560	56	K, M	2.52	0.937	0.50
680	68	K, M	2.52	1.117	0.46

Specifications subject to change without notice. Rev. 10/00