

Gold Aluminum Housed Wirewound Resistors



AHW Series

MERITEK

FEATURES

- High power rating, small size and ultra precision.
- Standard winding & non-inductive winding types.
- High stability, strong construction.



ELECTRICAL SPECIFICATION

Characteristics	Limits	Test Methods
Resistance Tolerance	Resistance $1\Omega \leq R \pm 5\%$ (J) Resistance Tolerance $1\Omega \leq R$ $\pm 10\%$ (K)	JIS-C-5202 5-1
Temperature Coefficient	± 200 ppm/ °C max.	JIS-C-5202 5-2b
Power Rating Load	$\Delta R/R \leq \pm(1\% + 0.05\Omega)$ Surface Temp. Rise 350°C max.	JIS-C-5202 5-4
Short-Time Overload	$\Delta R/R \leq \pm(2\% + 0.05\Omega)$ 100% Rated Power 5 Seconds	JIS-C-5202 5-5
Insulation Resistance	DC500V 100M Ω min	JIS-C-5202 5-6
Dielectric Withstanding Voltage	AC3000V 60Sec.	JIS-C-5202 5-7

DIMENSIONS AND RESISTANCE RANGE

Type	DIMENSIONS(mm)										Resistance Range
	L1 ± 2	L2 ± 1	L3 ± 1	A ± 1	B ± 1	C ± 1	E ± 0.3	S ± 1	H ± 0.5	P ± 2	
AHW-5W	25	15	10	16.5	12.5	8.5	2	8	4	5	0.1 Ω ~50K
AHW-10W	32	19	14	20	15.5	10.5	2	10	5	6	0.1 Ω ~50K
AHW-25W	47	27	18	27	19	15	3.2	15.5	7	10	0.1 Ω ~100K
AHW-50W	70	50	39	29	21	15	3.2	15.5	7	10	0.1 Ω ~100K
AHW-80W	102	66	35	47	37	28	4.5	25	12	5*18	0.1 Ω ~100K
AHW-100WS	102	66	35	47	37	28	4.5	25	12	5*18	0.1 Ω ~100K
AHW-100W	135	89	69	70	58	46	5	44.5	19.5	6*23	0.1 Ω ~3K
AHW-250W	155	114	98	77	64	53	5	55.5	25	6*21	0.1 Ω ~3K
AHW-300W	155	114	98	77	64	53	5	55.5	25	6*21	0.1 Ω ~3K

Specifications are subject to change without notice.

Gold Aluminum Housed Wirewound Resistors



AHW Series

MERITEK

PRECISION POWER RESISTORS DIMENSIONS---5~50W.100W.250W

AHW-5W
 AHW-10W
 AHW-25W
 AHW-50W

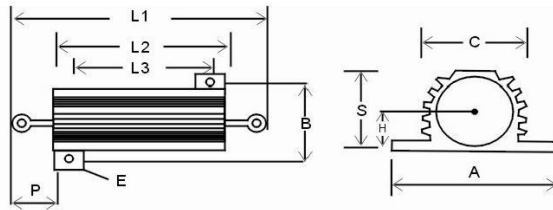

AP-5W
 AP-10W
 AP-25W
 AP-50W

AHW-80W
 AHW-100WS

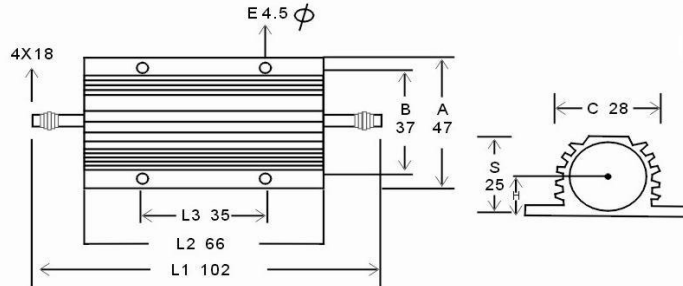

Type P: Copper Leads on both sides.

AHW-100W

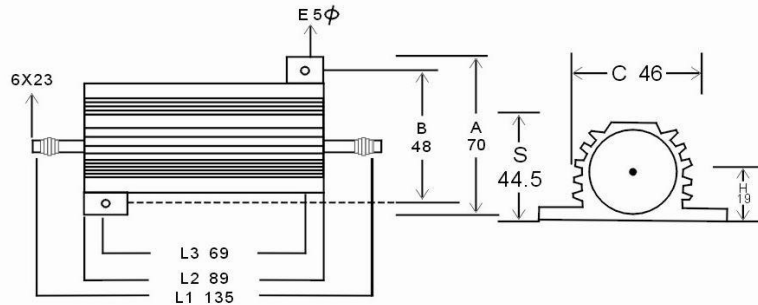

AHW-200W
 AHW-250W
 AHW-300W

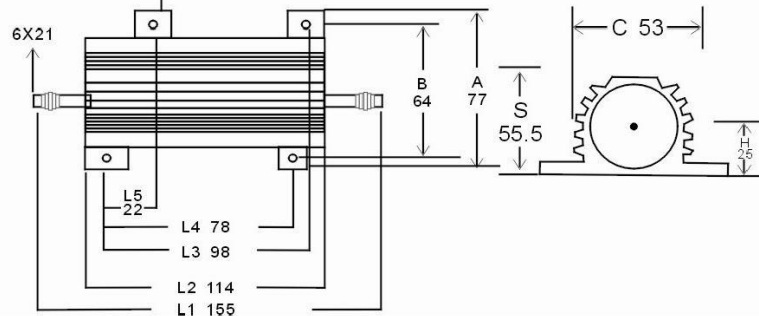

Gold Aluminum Housed Wirewound Resistors



AHW Series

MERITEK

SHORT-TIME OVERLOAD RATING

Load Time (Second)	1	2	3	4	5	10	30	60	180	300	600	900
Power Increase (%)	2600	2000	1600	1400	1300	1000	600	450	200	150	120	110

PERFORMANCE

Parameters	Test Conditions	Specifications
Short time Over Load	5X wattage rating-5sec	$\Delta R \pm (0.5\% + 0.05\Omega) \text{MAX}$
Moisture Resistance	Temp 40°C moisture 95% DC100V 500HR	$\Delta R \pm (0.5\% + 0.05\Omega) \text{MAX}$
Moisture Load Life	Temp 40°C moisture 95% 1/10X Wattage rating (1.5Hr ON-0.5Hr OFF)-Repeat 1000Hr	$\Delta R \pm (0.5\% + 0.05\Omega) \text{MAX}$
Load Life	Load Rating(chass is mounted) (1.5Hr ON 0.5Hr OFF) -Repeat 1000Hr	$\Delta R \pm (1.5\% + 0.05\Omega) \text{MAX}$
Vibration	10c/s~50c/s~10c/s(1min)2Hr each of paralleled and right angle	$\Delta R \pm (0.2\% + 0.05\Omega) \text{MAX}$
Heat Resistance	275°C 2Hr	$\Delta R \pm (0.5\% + 0.05\Omega) \text{MAX}$
Dielectric Strength	AHW-5 AHW-10 AHW-25 1000V AHW-50 1500V AHW-100 AHW-250 2500V	$\Delta R \pm (0.2\% + 0.05\Omega) \text{MAX}$
Insulation Resistance	Under the same test condition of Dielectric Strength, Load DC500v and measure the insulation R.	1000M Ω min
Terminal Strength	(1) Pull Test (30 sec Min) AHW-51kg.AHW-10 2.3kg.AHW-25.AHW-50 4.5kg (2) Torque Test (5~15sec) AHW-100 27kg-cm,AHW 250 36Kg-cm	$\Delta R \pm (0.2\% + 0.05\Omega) \text{MAX}$

Gold Aluminum Housed Wirewound Resistors



AHW Series

MERITEK

SURFACE TEMPERATURE VERSUS POWER LOAD (On Chassis)

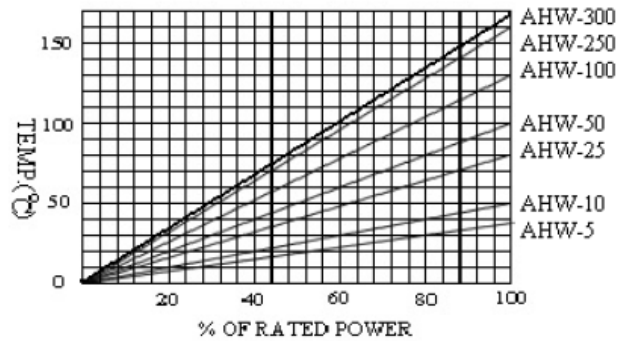
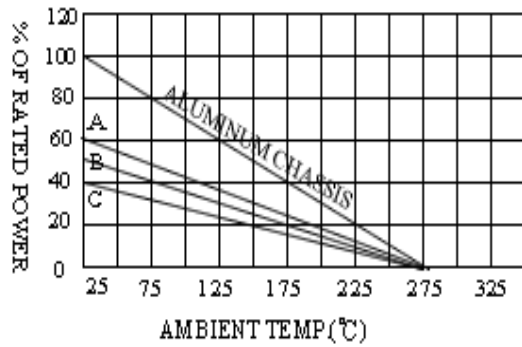

PACKING

AHW	BOX(PCS)	CARTON(PCS)
5W	400	2400
10W	300	1800
25W	150	600
50W	100	600
80W	8	48
100W	10	60
250W	6	36
300W	6	36