

DETAILS

| | |
|------------------------|---------------------|
| Product Number | C13896_STRADA-SQ-FS |
| Family | Strada |
| Type | Lens |
| Color | clear |
| Diameter | 25x25 mm |
| Height | 12,4 mm |
| Style | square |
| Optic Material | PMMA |
| Holder Material | |
| Fastening | pin, glue |
| Status | production ready |
| ROHS Compliant | Yes |
| Date Updated | 6/10/2014 |

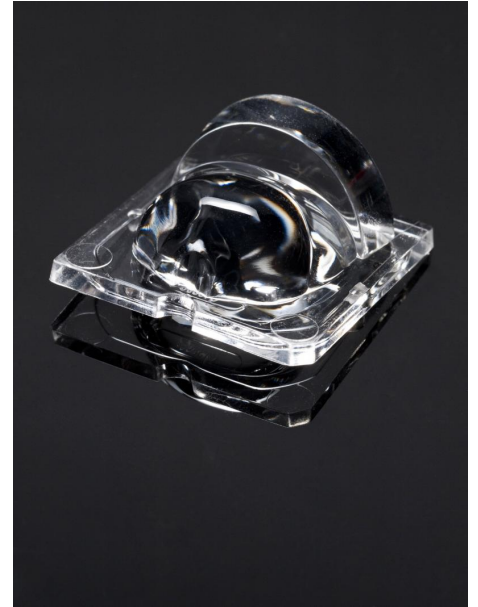

OPTICAL PROPERTIES

| LED | Viewing Angle | Light Beam | Efficiency | cd/lm | Connector |
|-------------|-----------------|------------|------------|------------|---|
| MK-R | Asymmetric deg | Asymmetric | 93 % | 0.900 | - |
| XM-L | Asymmetric deg | Asymmetric | 93 % | 1.200 | - |
| XT-E | Asymmetric deg | Asymmetric | 93 % | 1.200 | - |
| XP-L | Asymmetric deg | Asymmetric | 94 % | 1.000 | - |
| MHB-A/B | sim: Asymmetric | Asymmetric | - | - | - |
| XHP50 | Asymmetric deg | Asymmetric | 93 % | 0.900 | - |
| XHP70 | Asymmetric deg | Asymmetric | 80 % | 0.610 | Undefined Manufacturer: Protective Plate, Glass |
| XP-L2 | Asymmetric deg | Asymmetric | 94 % | 1.000 | - |
| LUXEON M/MX | asymmetric deg | Asymmetric | 92 % | 0.900 | - |
| LUXEON MZ | asymmetric deg | Asymmetric | 94 % | 1.200 | - |
| NFMW48xA | sim: asym | Asymmetric | sim: 91 % | sim: 0.990 | - |
| Duris P10 | sim: Asymmetric | Asymmetric | sim: 91 % | sim: 1.050 | - |

D

C

B

A

4

4

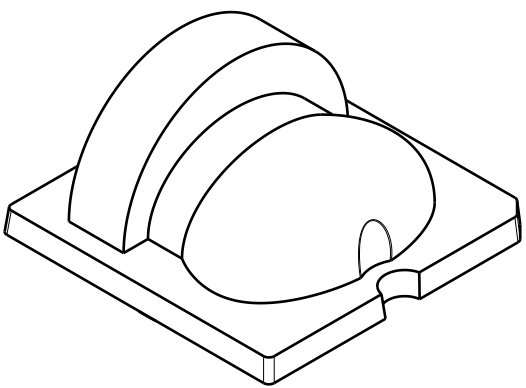
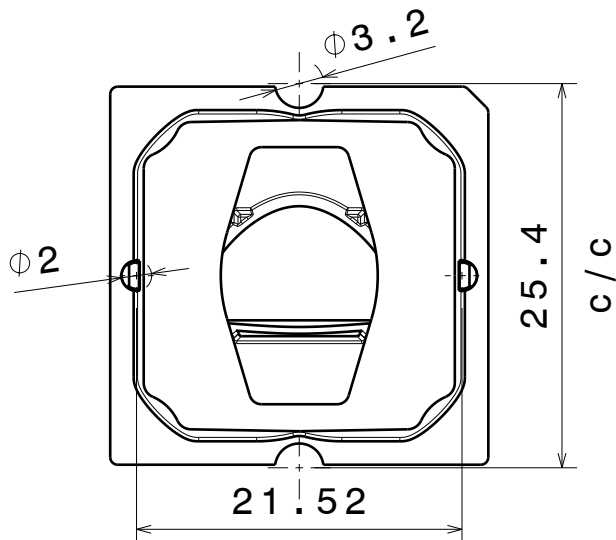

Isometric view

Bottom view

3

3

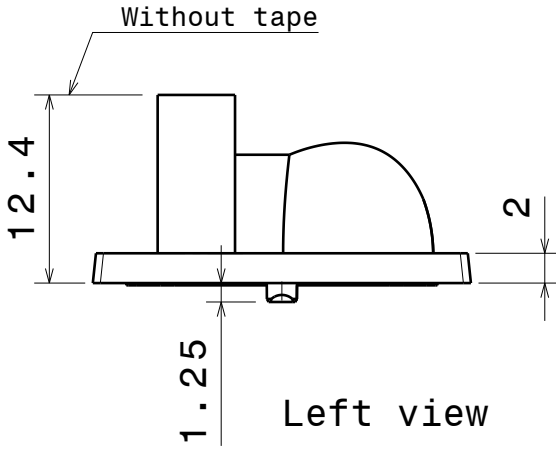
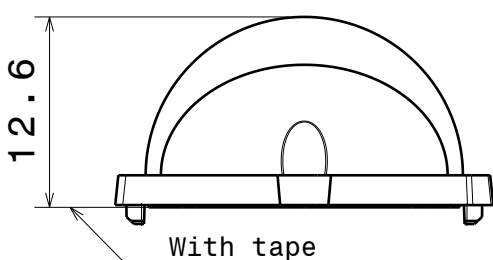

Front view

Left view

2

2

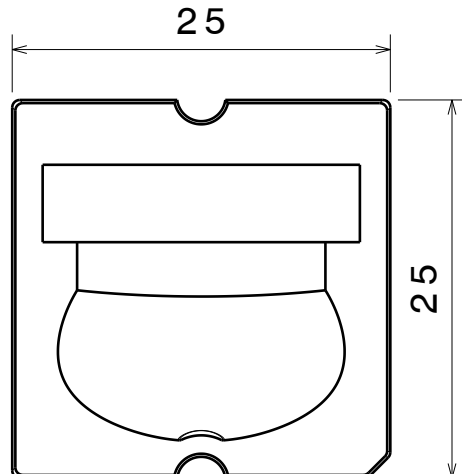

Top view

Tolerances if not otherwise shown
 According to DIN ISO 2768-1
 Linear measures:
 Up to 30mm class M, otherwise class C.
 According to DIN ISO 2768-2
 Form and position: class L

LEDiL Ledil Oy
 Salorankatu 10
 FIN 24240 SALO
 Finland

THIRD ANGLE PROJECTION:

DRAWING TITLE
STRADA-SQ-FS

This drawing is the property of LEDiL Oy. It may not be reproduced, copied or communicated without a written agreement with LEDiL Oy."

| | |
|------|-------------|
| SIZE | PART NUMBER |
| A4 | - |

| | | | | | |
|-------|-----|--------|-----|-------|-----|
| SCALE | 2:1 | WEIGHT | - g | SHEET | 1/1 |
|-------|-----|--------|-----|-------|-----|

D

A

1

LEDiL Oy C13896/CA13897_STRADA-SQ-FS_(MK-R) Eff.92.6% / LDC (Linear)

Luminaire: LEDiL Oy C13896/CA13897_STRADA-SQ-FS_(MK-R) Eff.92.6%
Lamps: 1 x CREE_MK-R_358.348lm@250mA_P=2.84311W_I=249.9mA

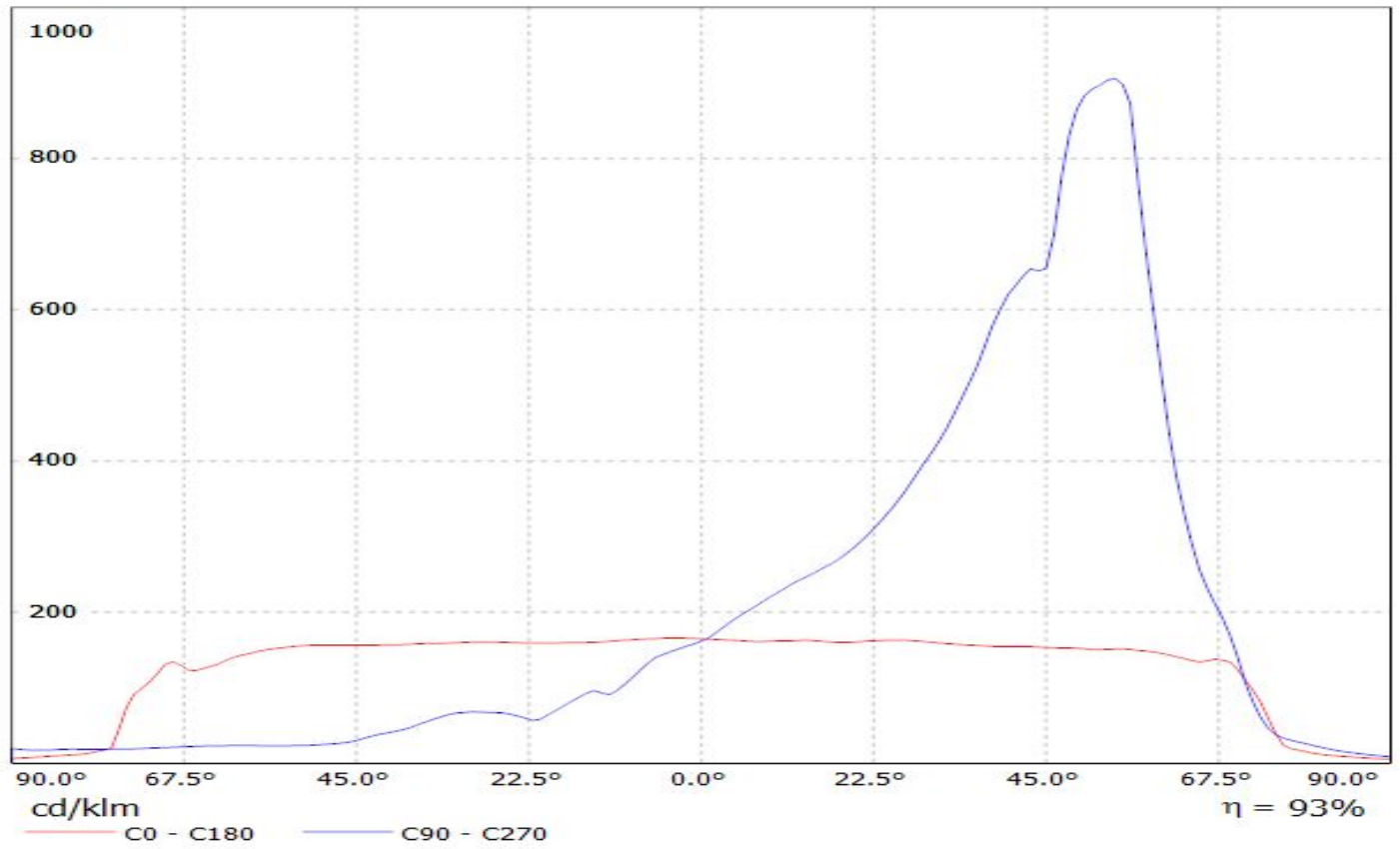

LEDiL Oy C13896/CA13897_STRADA-SQ-FS_(XM-L) Eff.93.1% / LDC (Linear)

Luminaire: LEDiL Oy C13896/CA13897_STRADA-SQ-FS_(XM-L) Eff.93.1%
Lamps: 1 x CREE_XM-L_(XMLAWT-00-0000-0000T6051)
_100.386lm@259mA_P=0.724735W_I=249.9mA

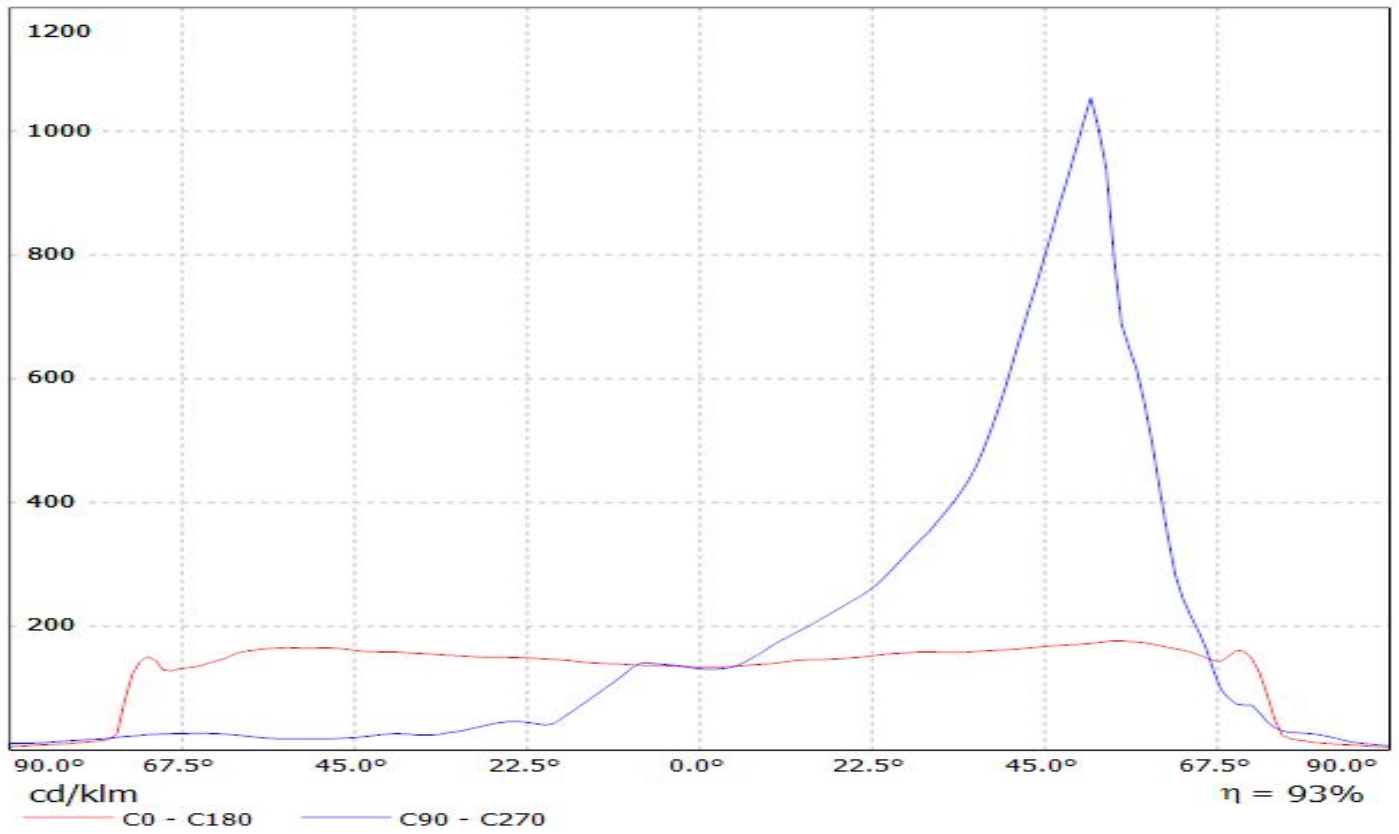

LEDiL Oy C13896/CA13897_STRADA-SQ-FS_(XT-E) Eff.93.0% / LDC (Linear)

Luminaire: LEDiL Oy C13896/CA13897_STRADA-SQ-FS_(XT-E) Eff.93.0%
Lamps: 1 x CREE_XT-E_(XTEAWT-00-0000-00000HBE8)
_73.2149lm@250mA_P=0.779476W_I=249.9mA

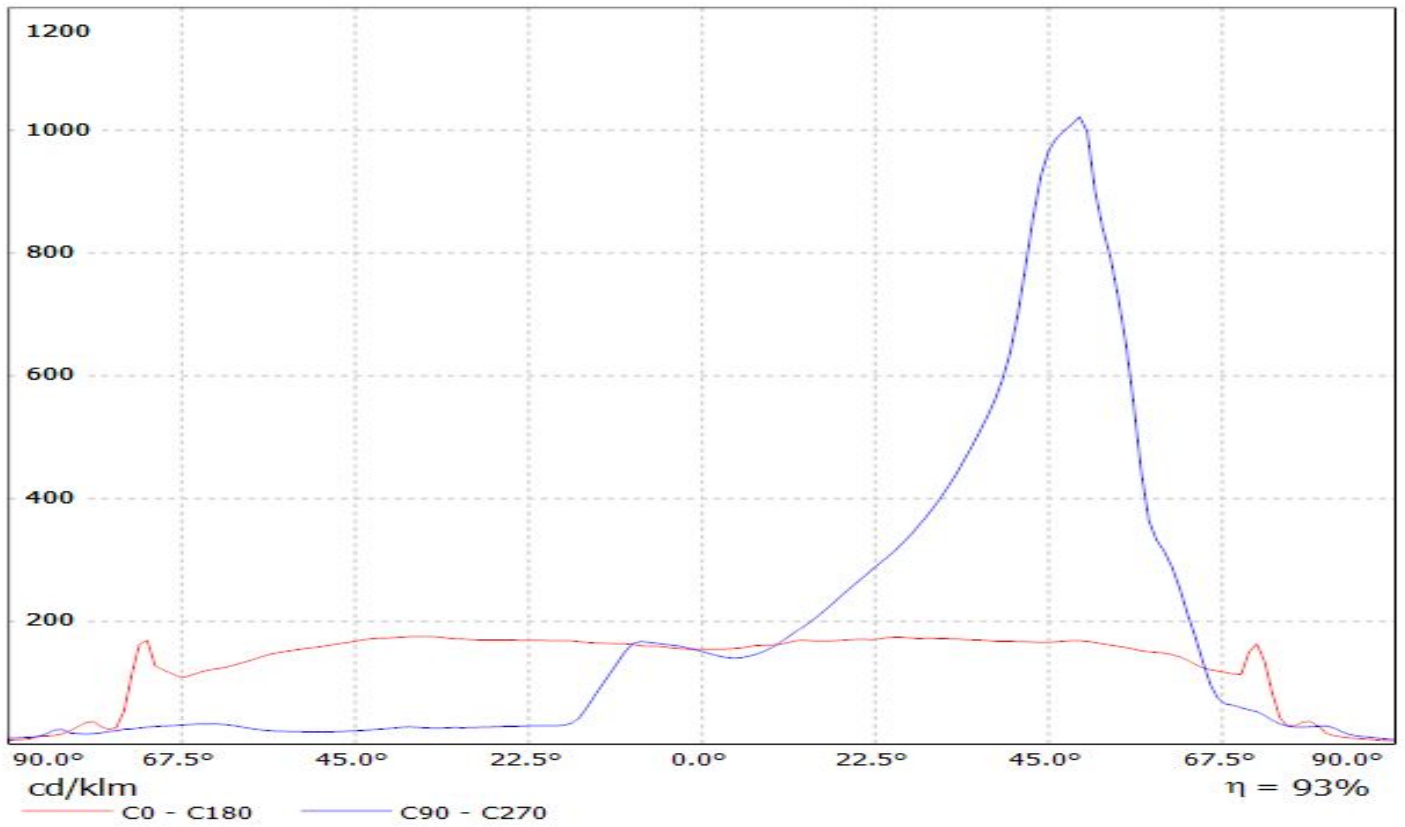

Luminaire: LEDiL Oy C13896_STRADA-SQ-FS_(XP-L)
Lamps: 1 x Cree_XP-L_125.481lm@250mA_P=0.737584W_I=249.9mA

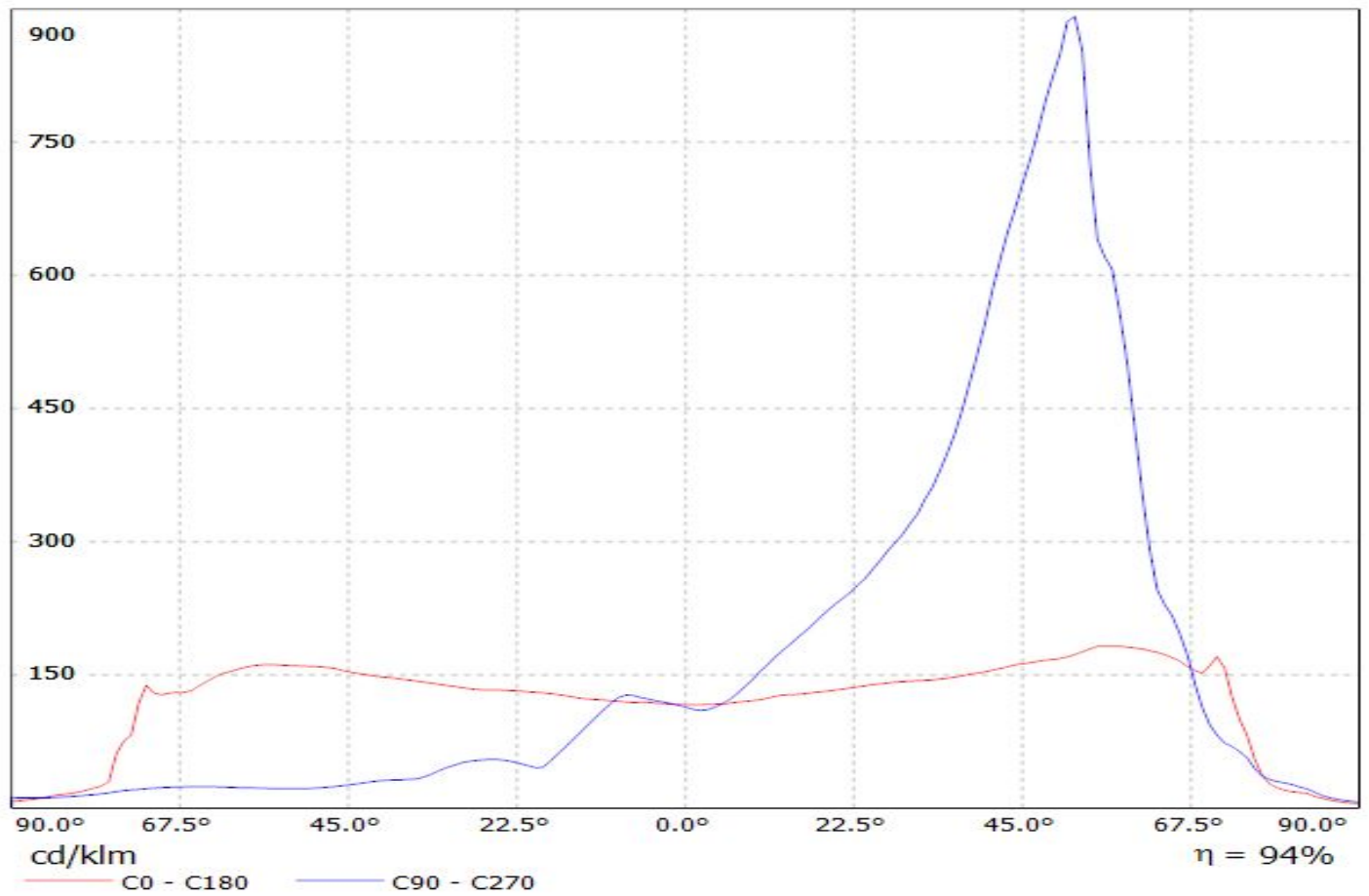

Luminaire: LEDiL Oy C13896_STRADA-SQ-FS_(XHP50 Cool white)
Lamps: 1 x XHP50 Cool white_244.744lm@250mA_P=1.42773W_I=0.2499A

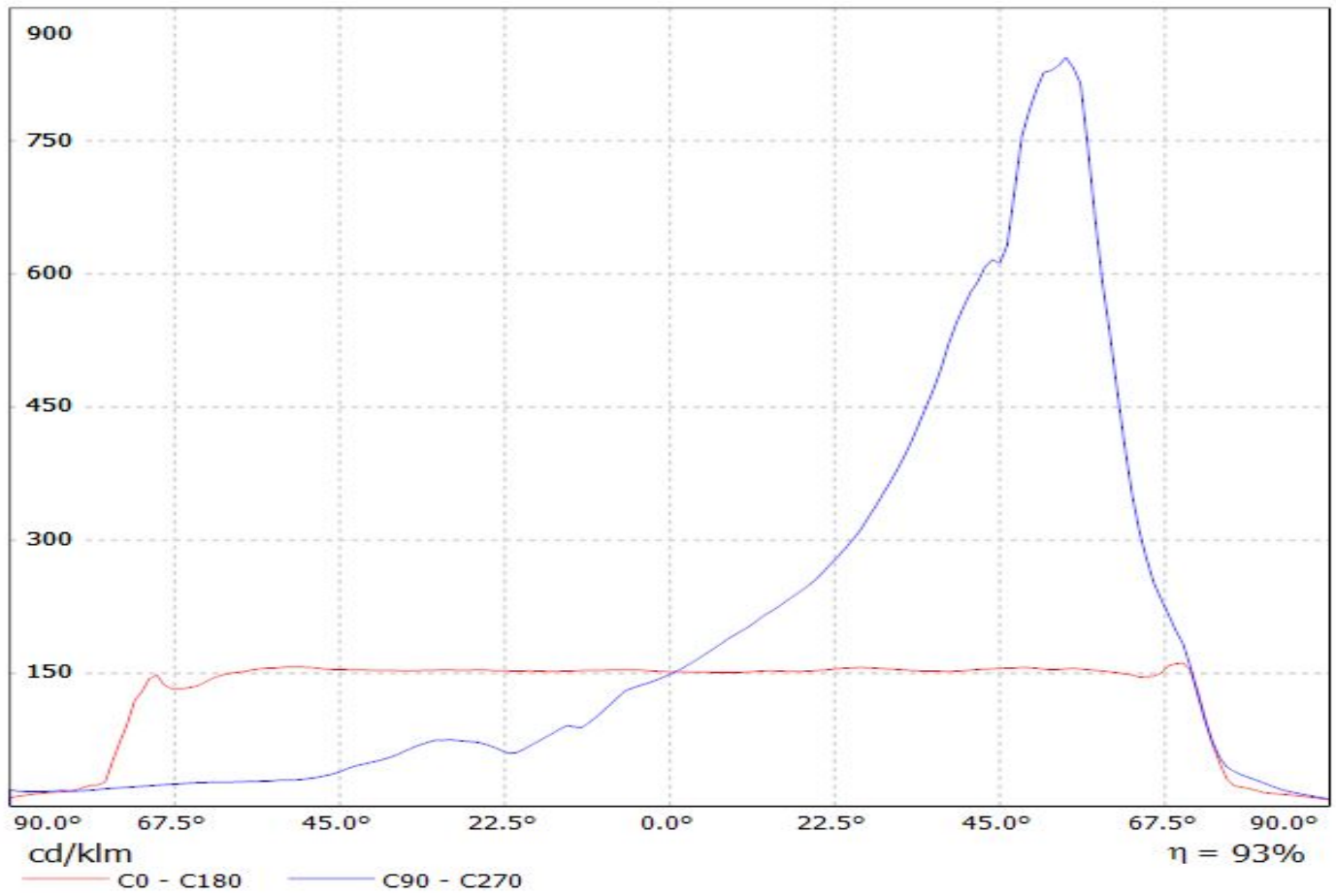

Luminaire: LEDiL Oy C13896_STRADA-SQ-FS_(XHP70)_glass
Lamps: 1 x Cree_XHP70_glass-chassis_260.488lm@250mA_P=1.38405W_η=0.2499A

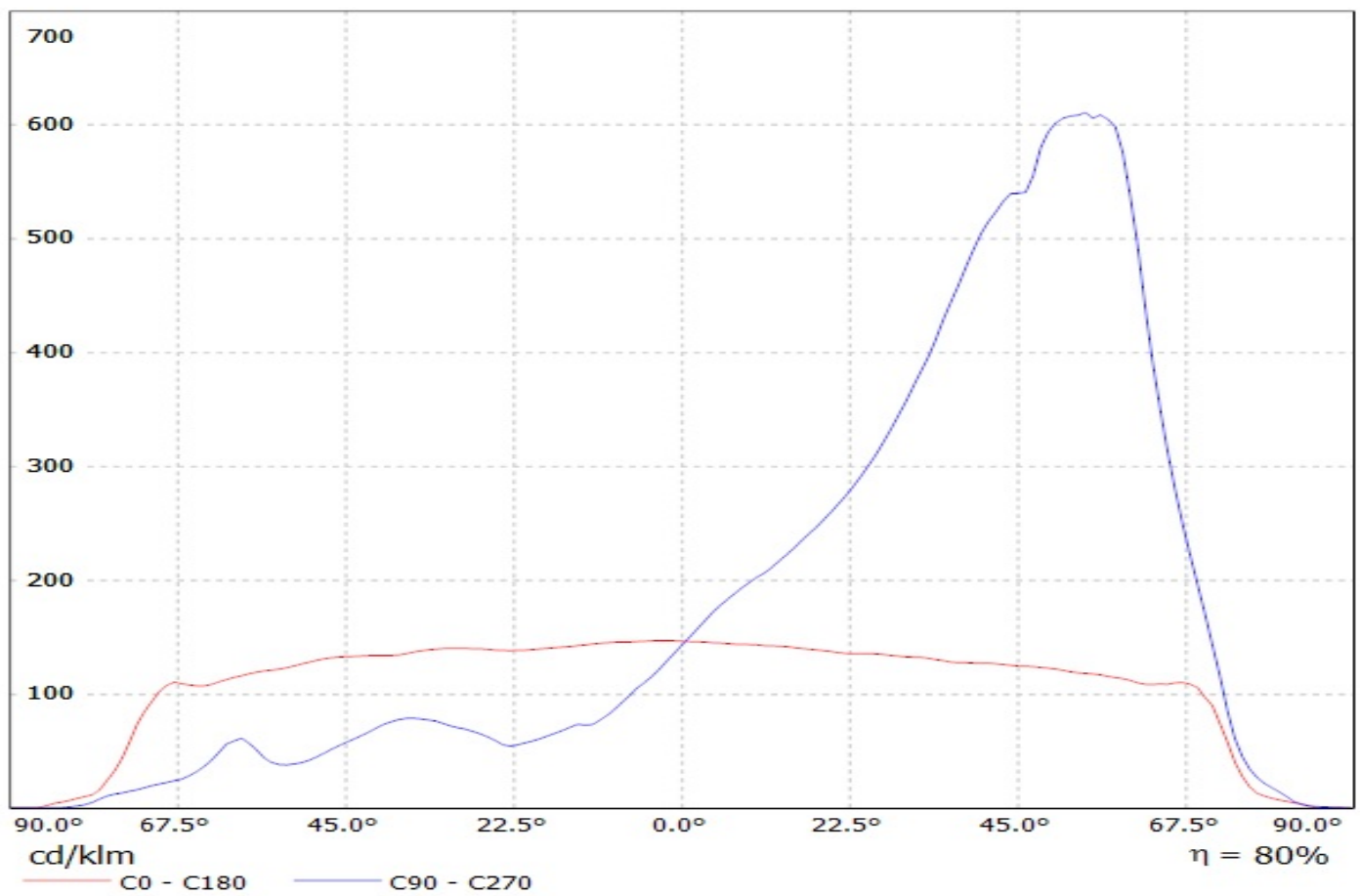

Luminaire: Ledil C13896_STRADA-SQ-FS_(XP-L2)

Lamps: 1 x Cree_XP-L2_(XPLWT-00-0000-000HU630G)_115.868lm@250mA_P=0.717875W_I=0.25A

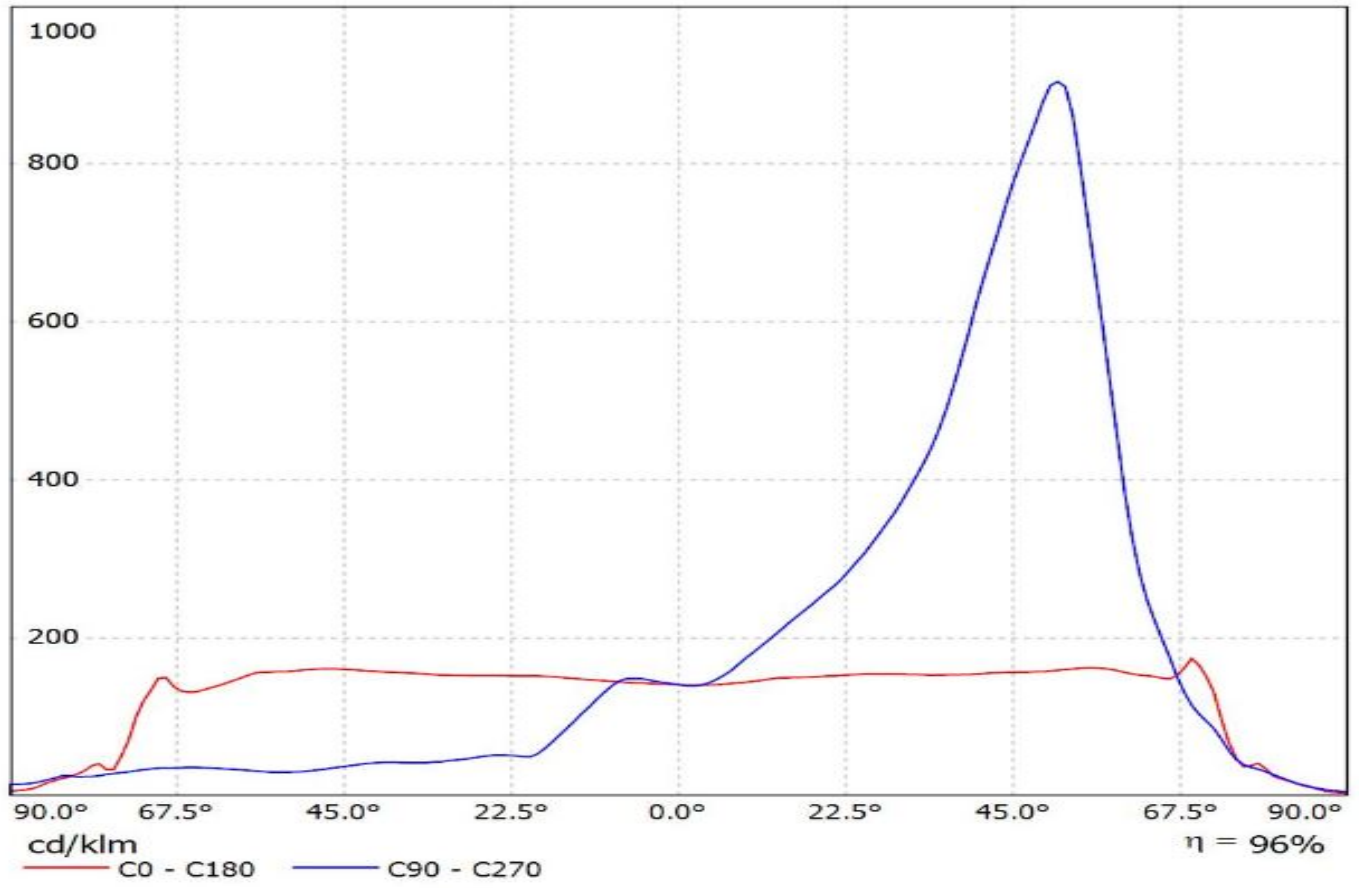

Luminaire: LEDiL Oy C13896_STRADA-SQ-FS_(LUXEON_M) Eff.92.4%
Lamps: 1 x LUXEON_M_349.54lm@250mA_CCT=4092K_P=2.72807W_I=249.8mA

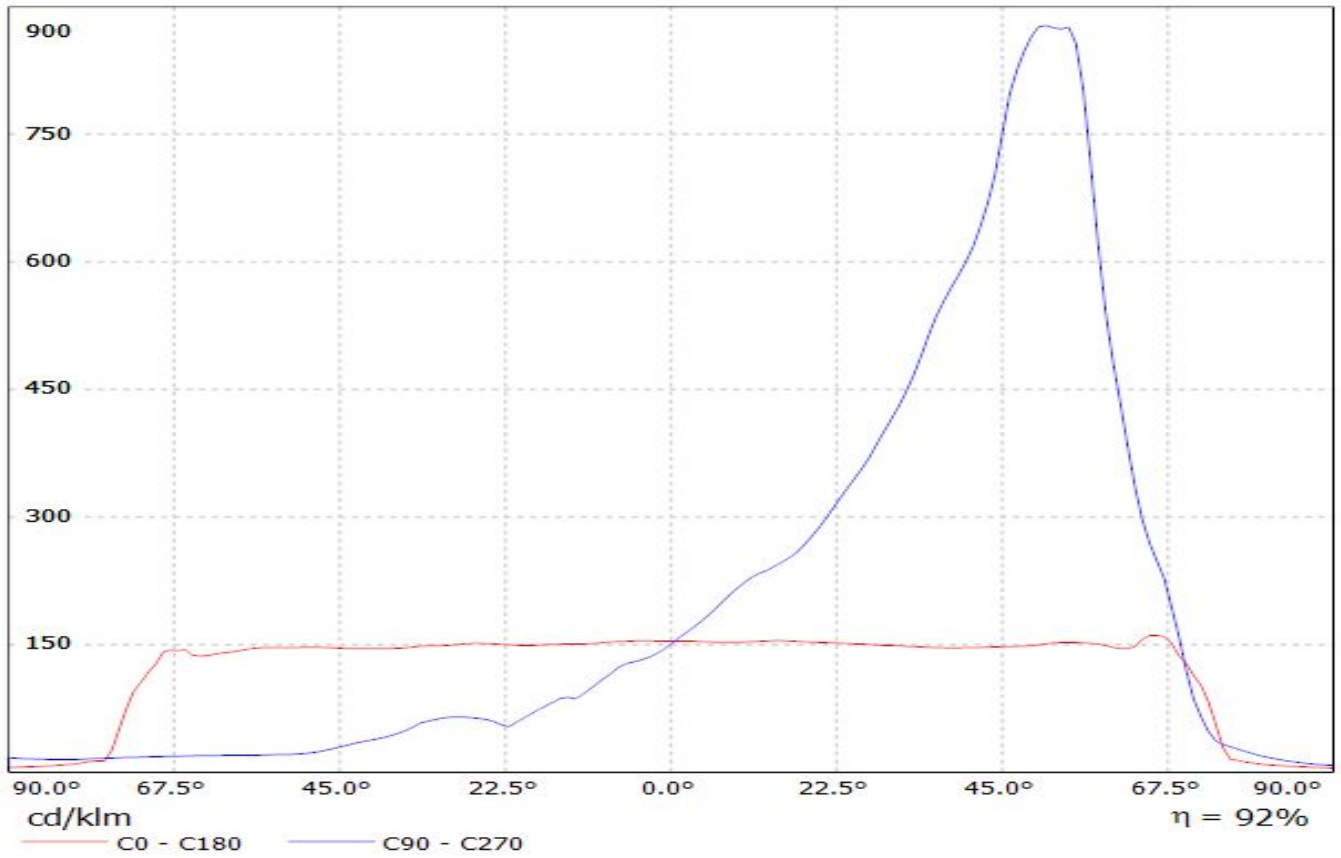

Luminaire: LEDil Oy C13896_STRADA-SQ-FS_(Luxeon_MZ) Efficiency=94%
Lamps: 1 x Philips lumileds Luxeon MZ (389lm @ 250mA) CCT=3800K P=2.8W I=250mA

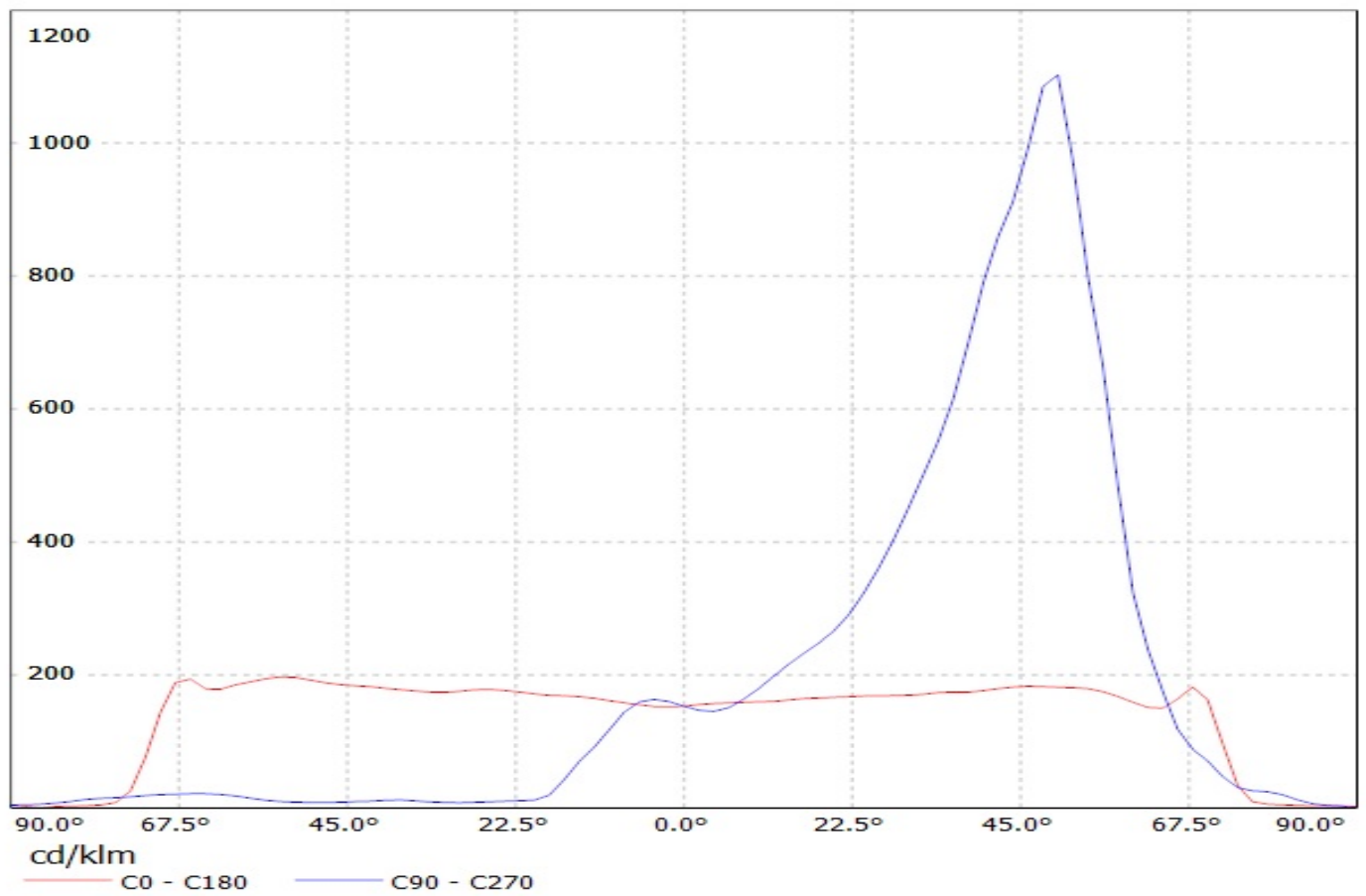

LEDiL Oy C13896/CA13897_STRADA-SQ-FS_(MK-R) Eff.92.6% / LDC (Polar)

Luminaire: LEDiL Oy C13896/CA13897_STRADA-SQ-FS_(MK-R) Eff.92.6%
Lamps: 1 x CREE_MK-R_358.348lm@250mA_P=2.84311W_I=249.9mA

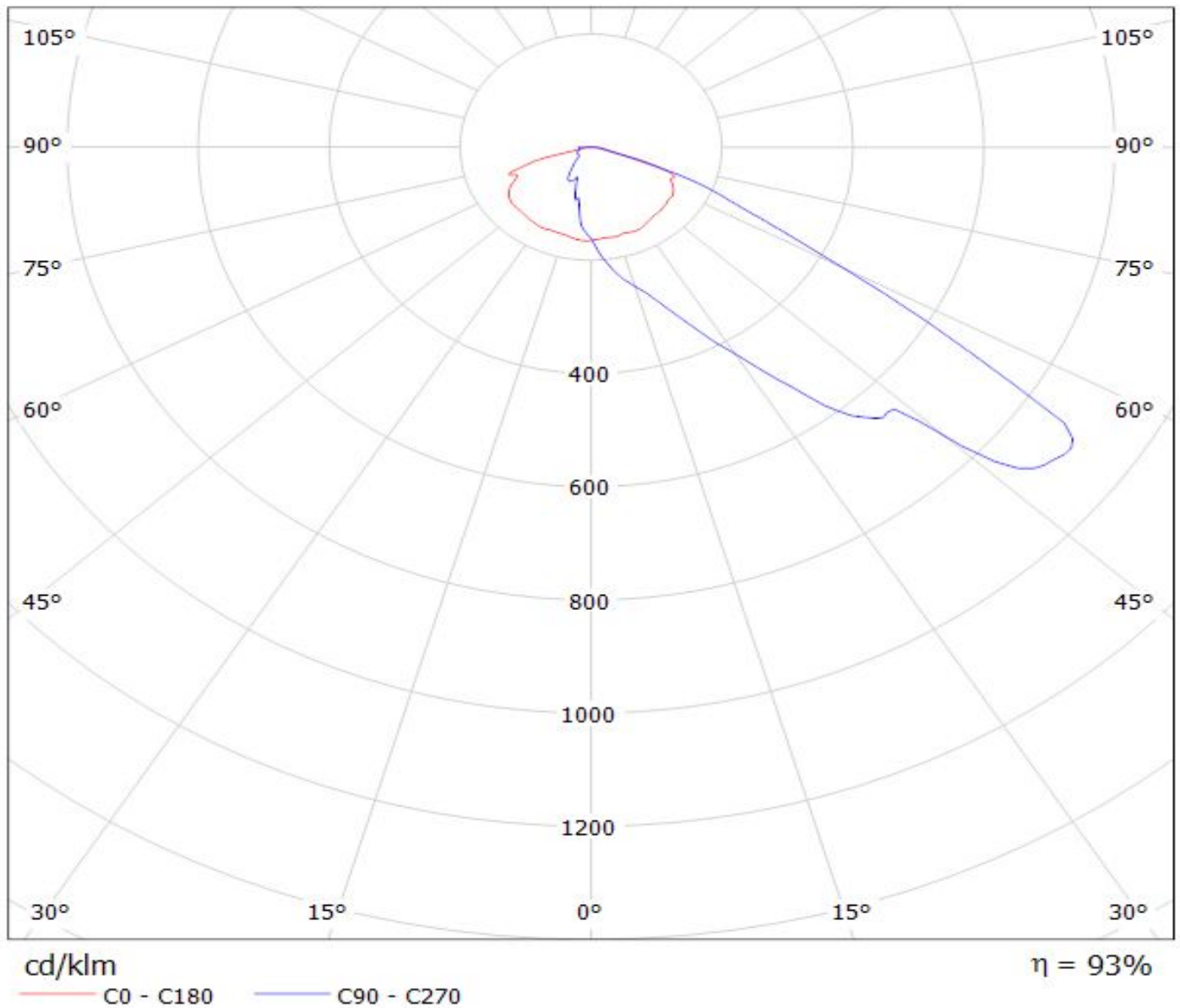

LEDiL Oy C13896/CA13897_STRADA-SQ-FS_(XM-L) Eff.93.1% / LDC (Polar)

Luminaire: LEDiL Oy C13896/CA13897_STRADA-SQ-FS_(XM-L) Eff.93.1%

Lamps: 1 x CREE_XM-L_(XMLAWT-00-0000-0000T6051)

_100.386lm@259mA_P=0.724735W_I=249.9mA

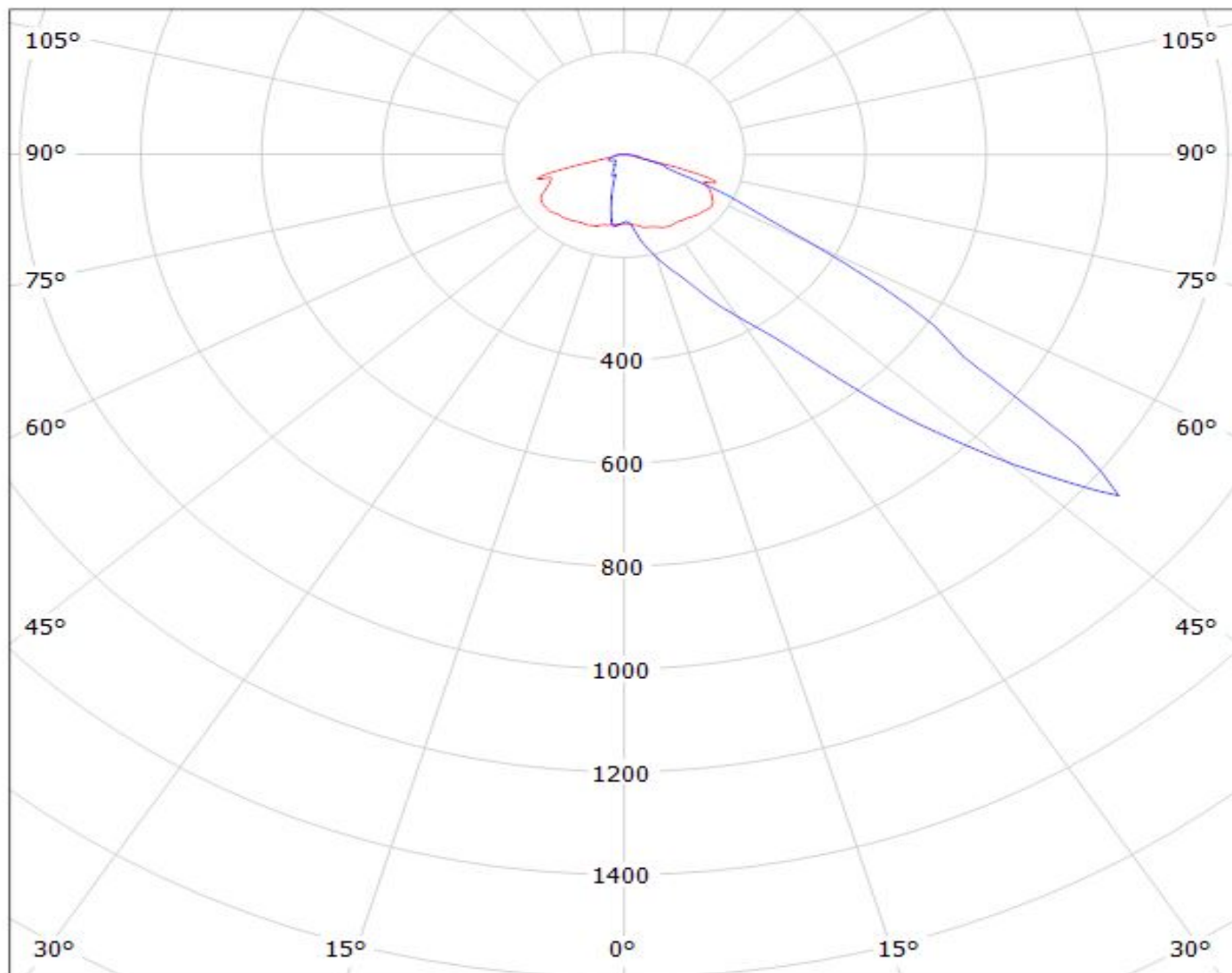

cd/klm

η = 93%

— C0 - C180

— C90 - C270

LEDiL Oy C13896/CA13897_STRADA-SQ-FS_(XT-E) Eff.93.0% / LDC (Polar)

Luminaire: LEDiL Oy C13896/CA13897_STRADA-SQ-FS_(XT-E) Eff.93.0%
Lamps: 1 x CREE_XT-E_(XTEAWT-00-0000-00000HBE8)
_73.2149lm@250mA_P=0.779476W_I=249.9mA

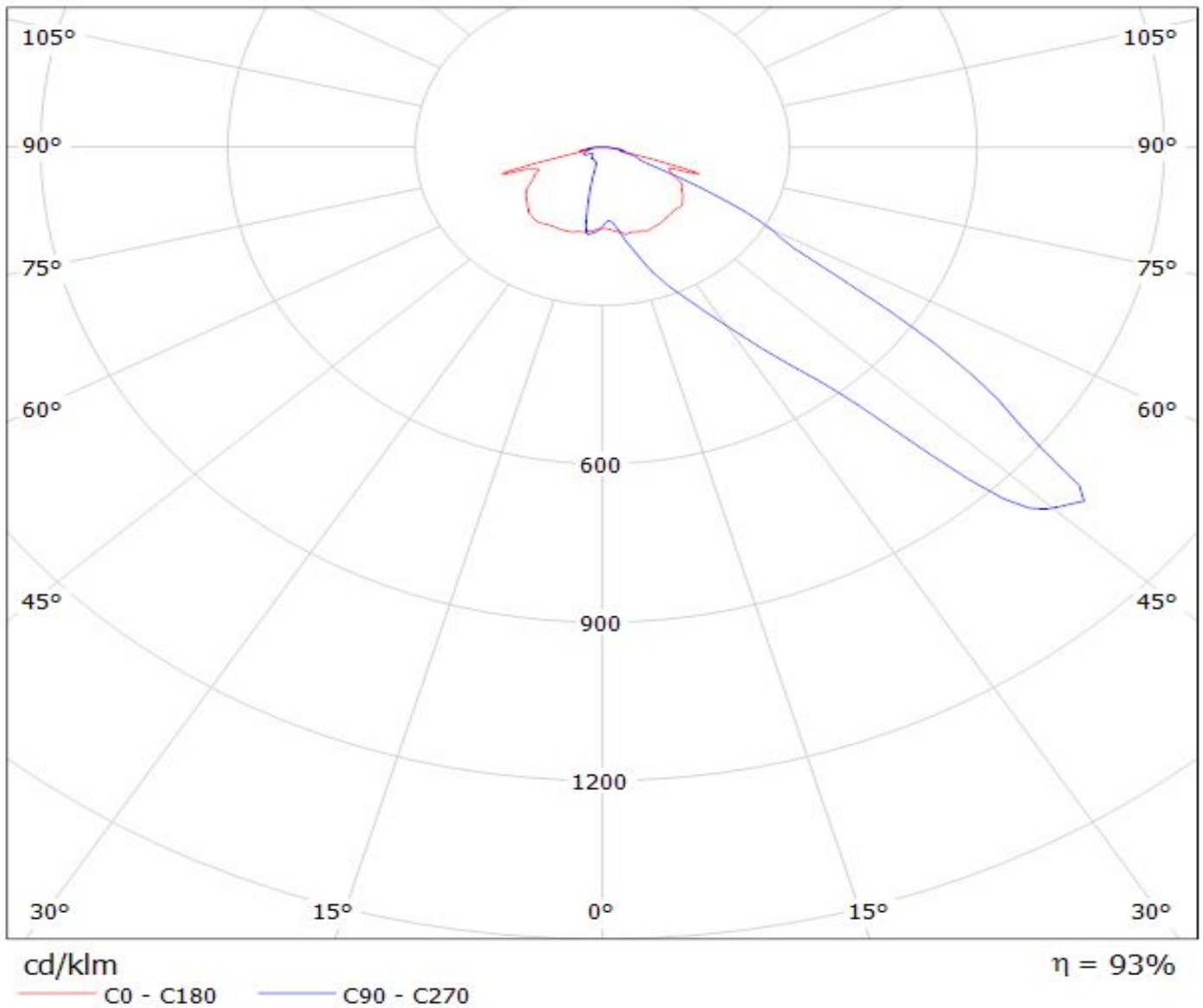

Luminaire: LEDiL Oy C13896_STRADA-SQ-FS_(XP-L)
Lamps: 1 x Cree_XP-L_125.481lm@250mA_P=0.737584W_I=249.9mA

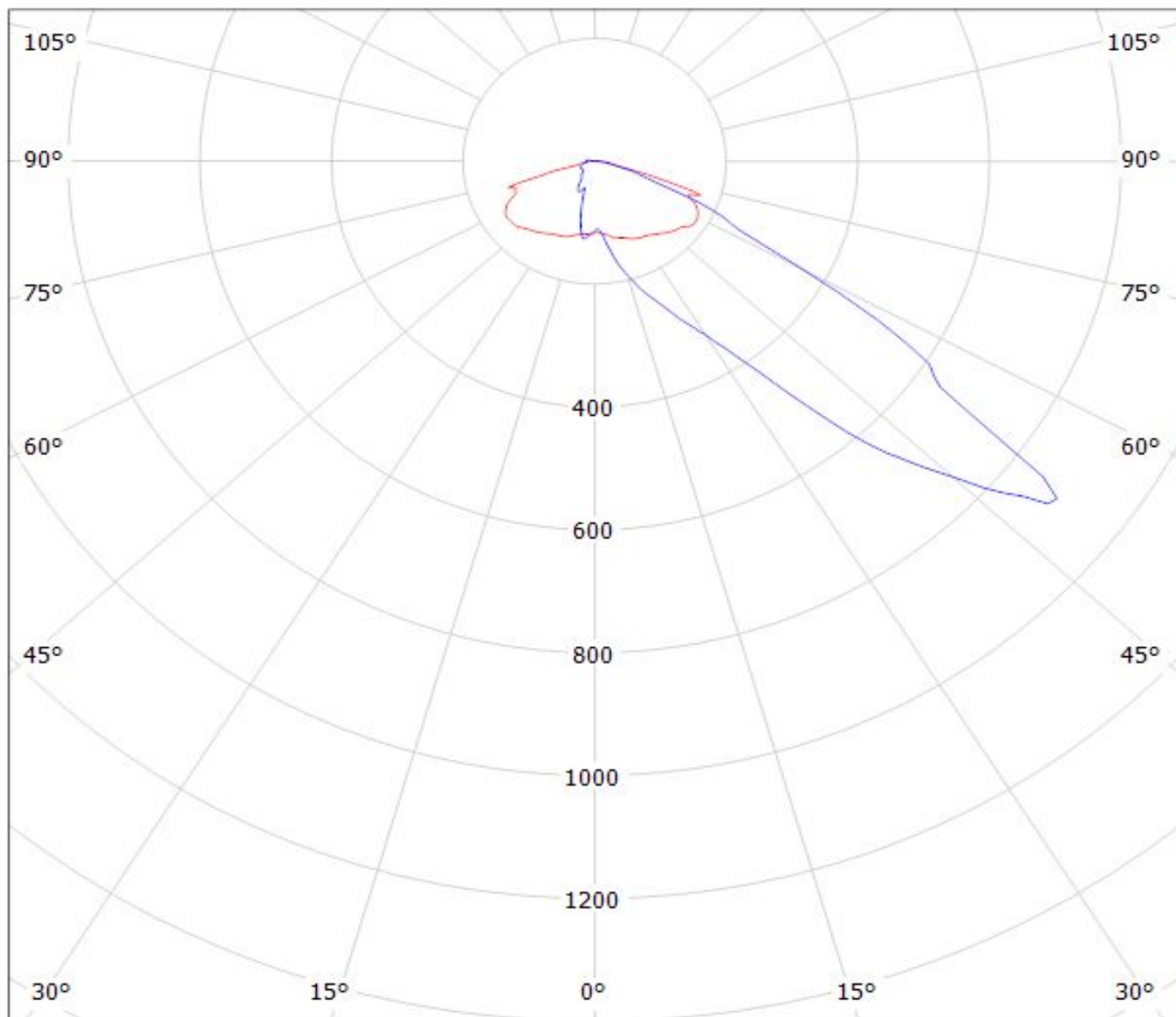

cd/klm

$\eta = 94\%$

— C0 - C180

— C90 - C270

Luminaire: LEDiL Oy C13896_STRADA-SQ-FS_(XHP50 Cool white)

Lamps: 1 x XHP50 Cool white_244.744lm@250mA_P=1.42773W_I=0.2499A

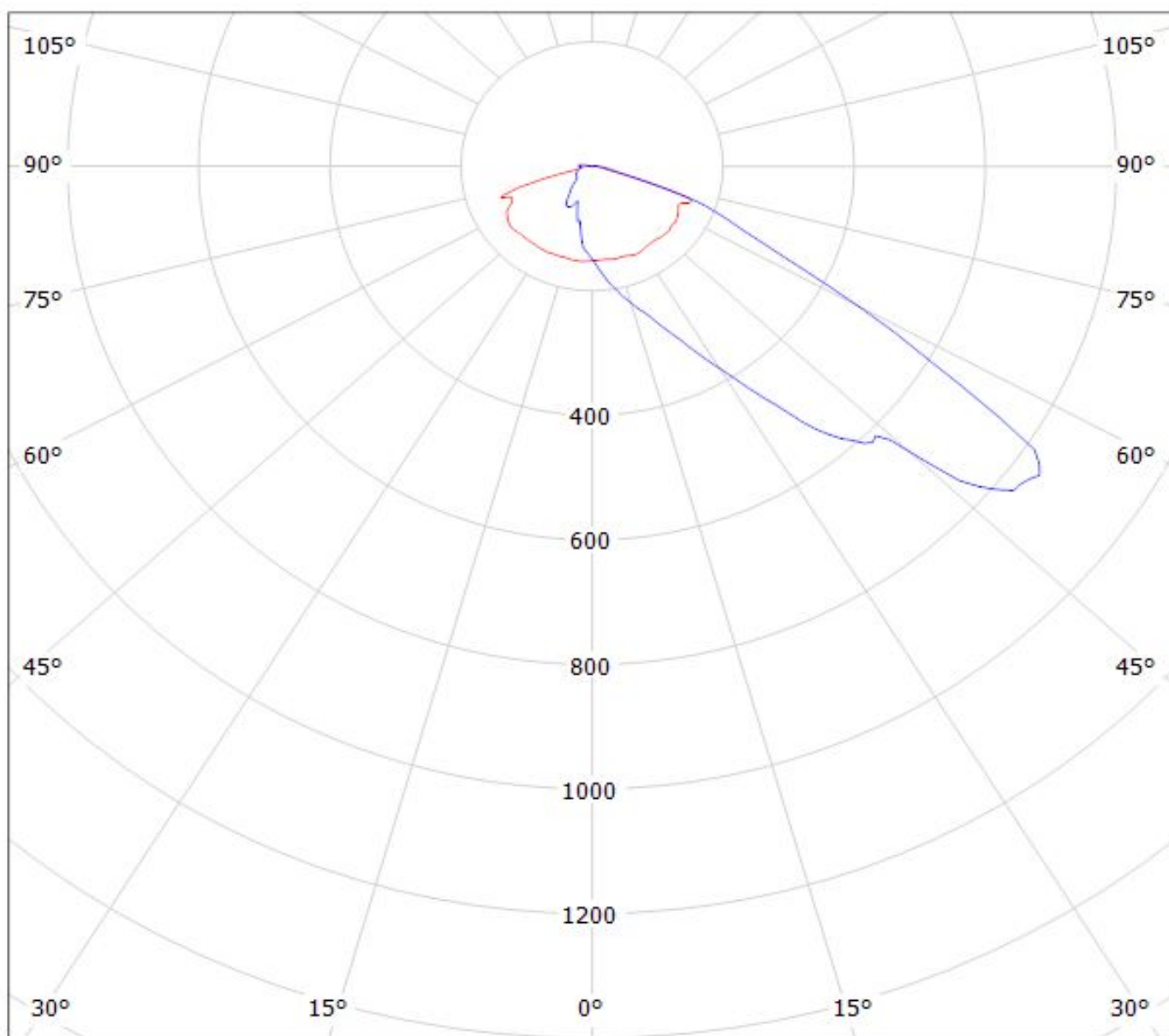

cd/klm

— C0 - C180

— C90 - C270

$\eta = 93\%$

Luminaire: LEDiL Oy C13896_STRADA-SQ-FS_(XHP70)_glass

Lamps: 1 x Cree_XHP70_glass-chassis_260.488lm@250mA_P=1.38405W_I=0.2499A

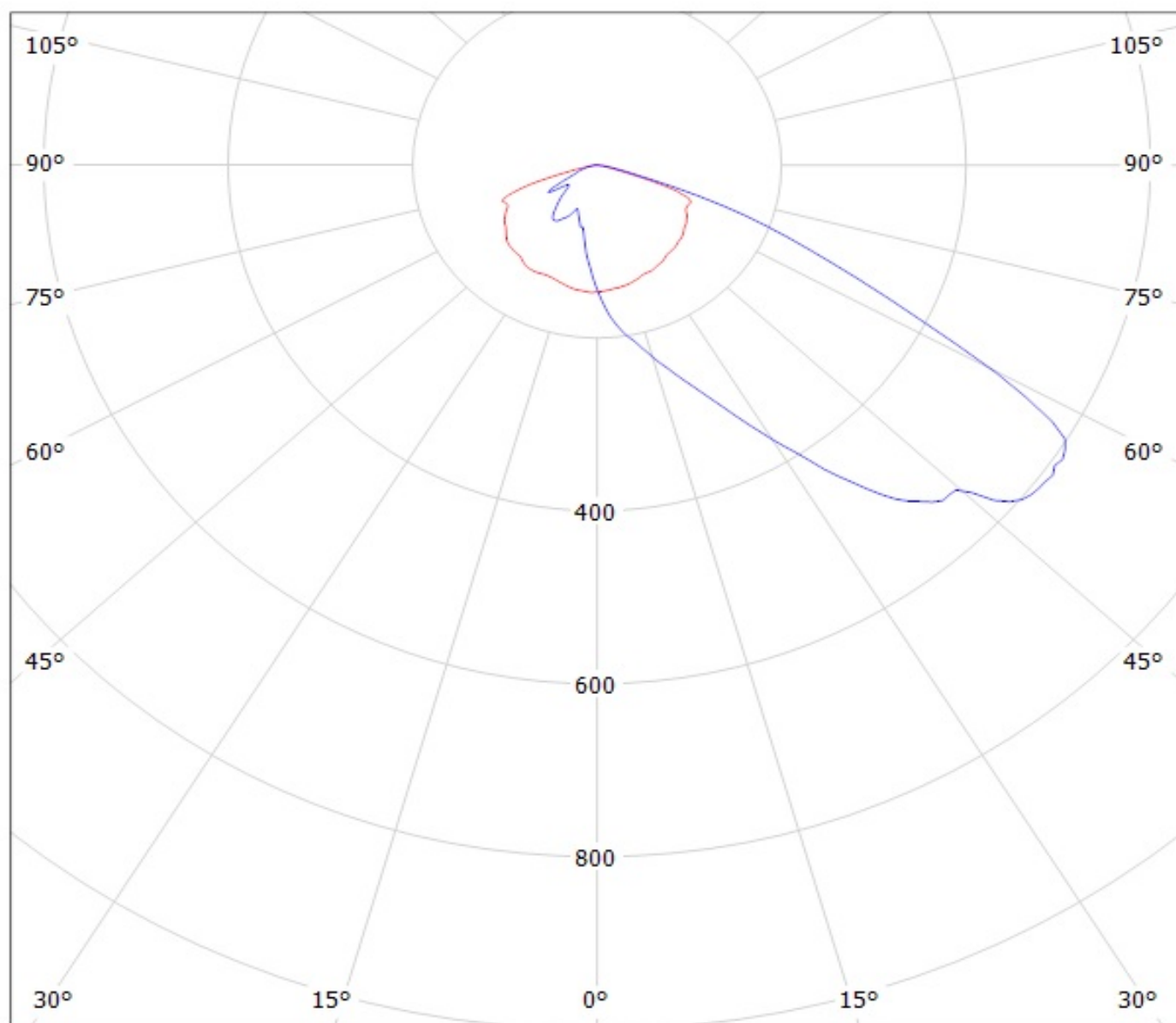

cd/klm

— C0 - C180

— C90 - C270

$\eta = 80\%$

Luminaire: Ledil C13896_STRADA-SQ-FS_(XP-L2)

Lamps: 1 x Cree_XP-L2_(XPLWT-00-0000-000HU630G)_115.868lm@250mA_P=0.717875W_I=0.25A

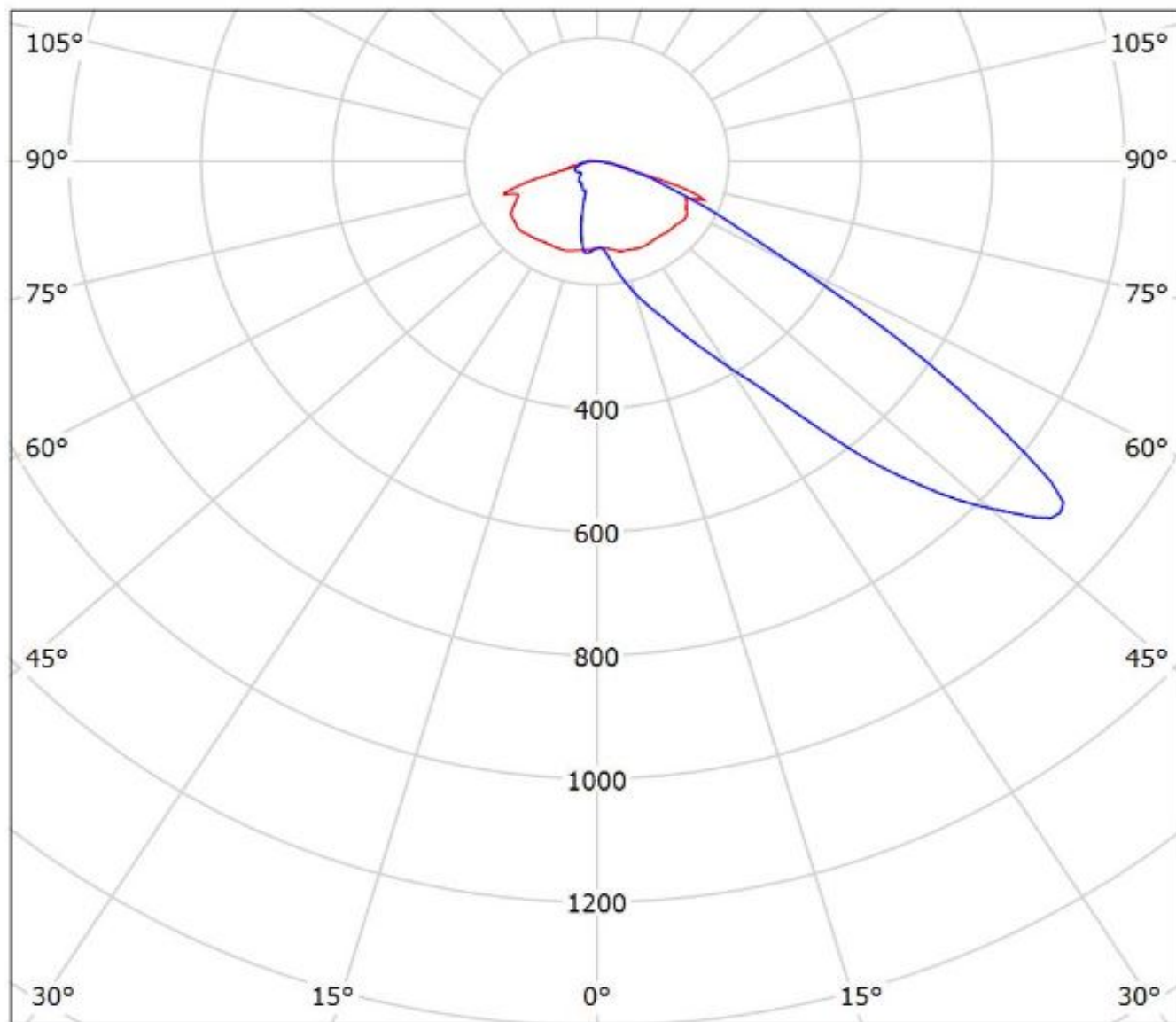

cd/klm

— C0 - C180 — C90 - C270

$\eta = 96\%$

Luminaire: LEDiL Oy C13896_STRADA-SQ-FS_(LUXEON_M) Eff.92.4%
Lamps: 1 x LUXEON_M_349.54lm@250mA_CCT=4092K_P=2.72807W_I=249.8mA

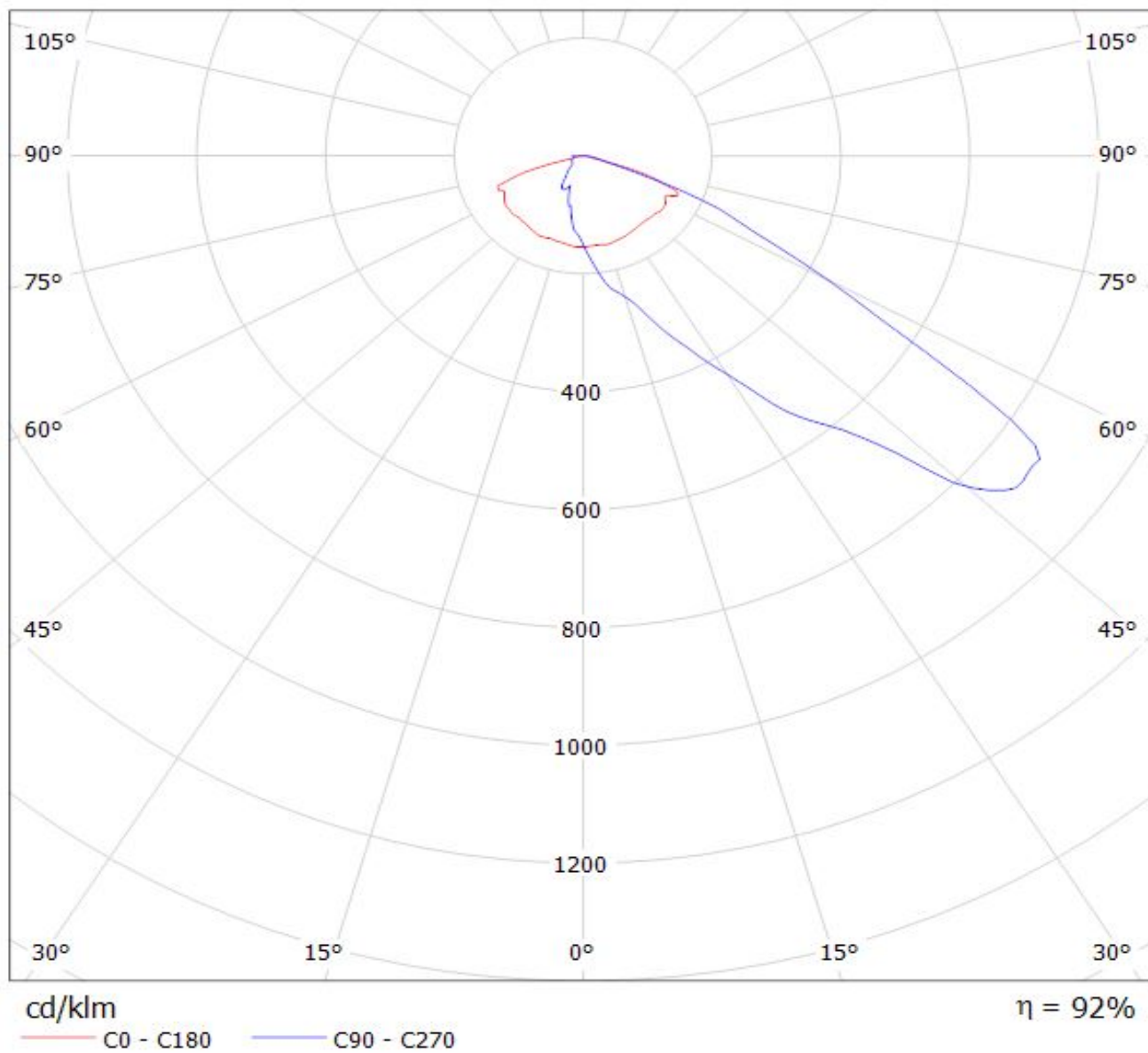

Luminaire: LEDil Oy C13896_STRADA-SQ-FS_(Luxeon_MZ) Efficiency=94%
Lamps: 1 x Philips lumileds Luxeon MZ (389lm @ 250mA) CCT=3800K P=2.8W I=250mA

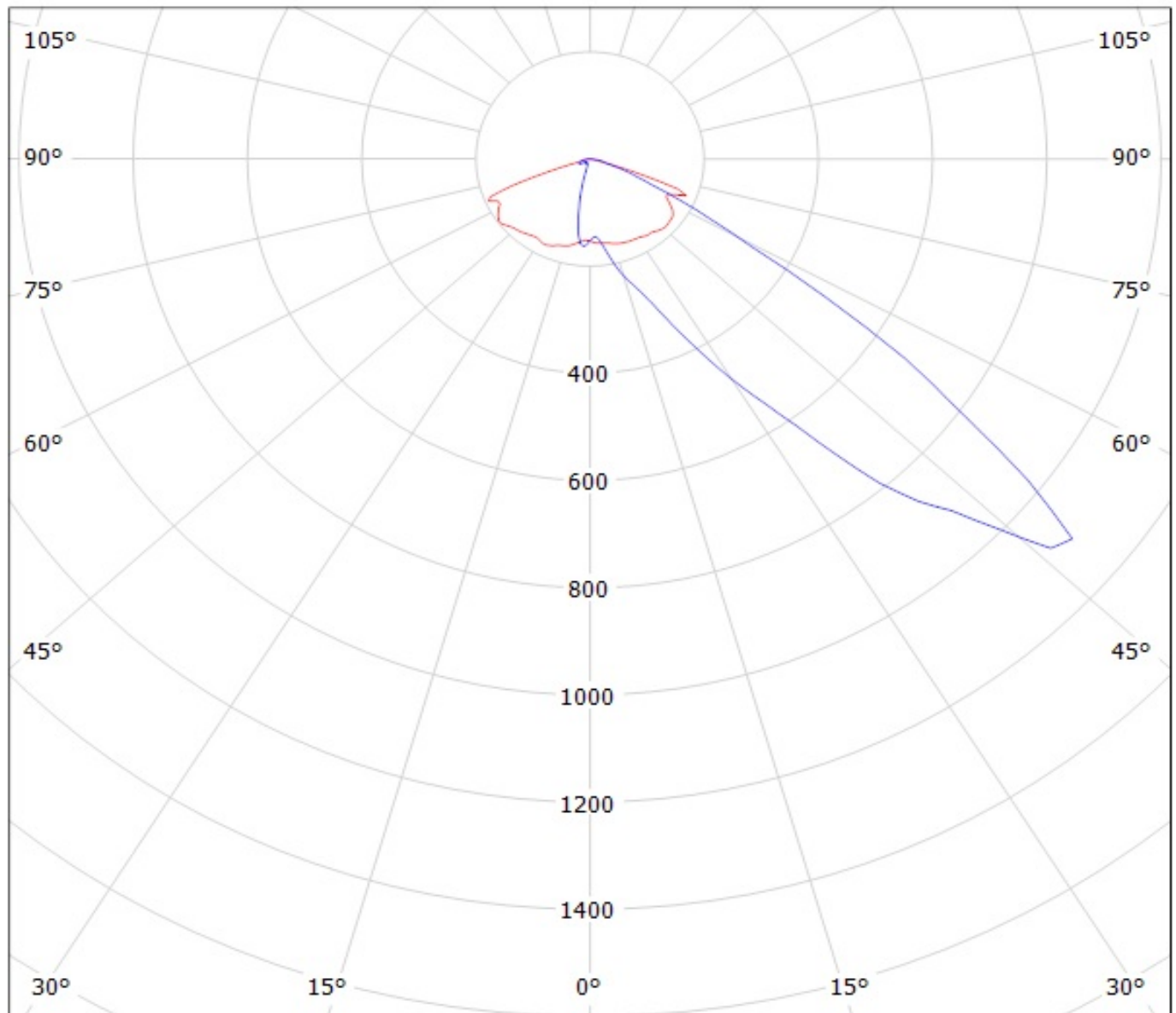

cd/klm
— C0 - C180 — C90 - C270

Luminaire: Ledil Oy C13896_STRADA-SQ-FS_NFMW488AR_SIMULATED
Lamps: 1 x NICHIA NFMW488AR

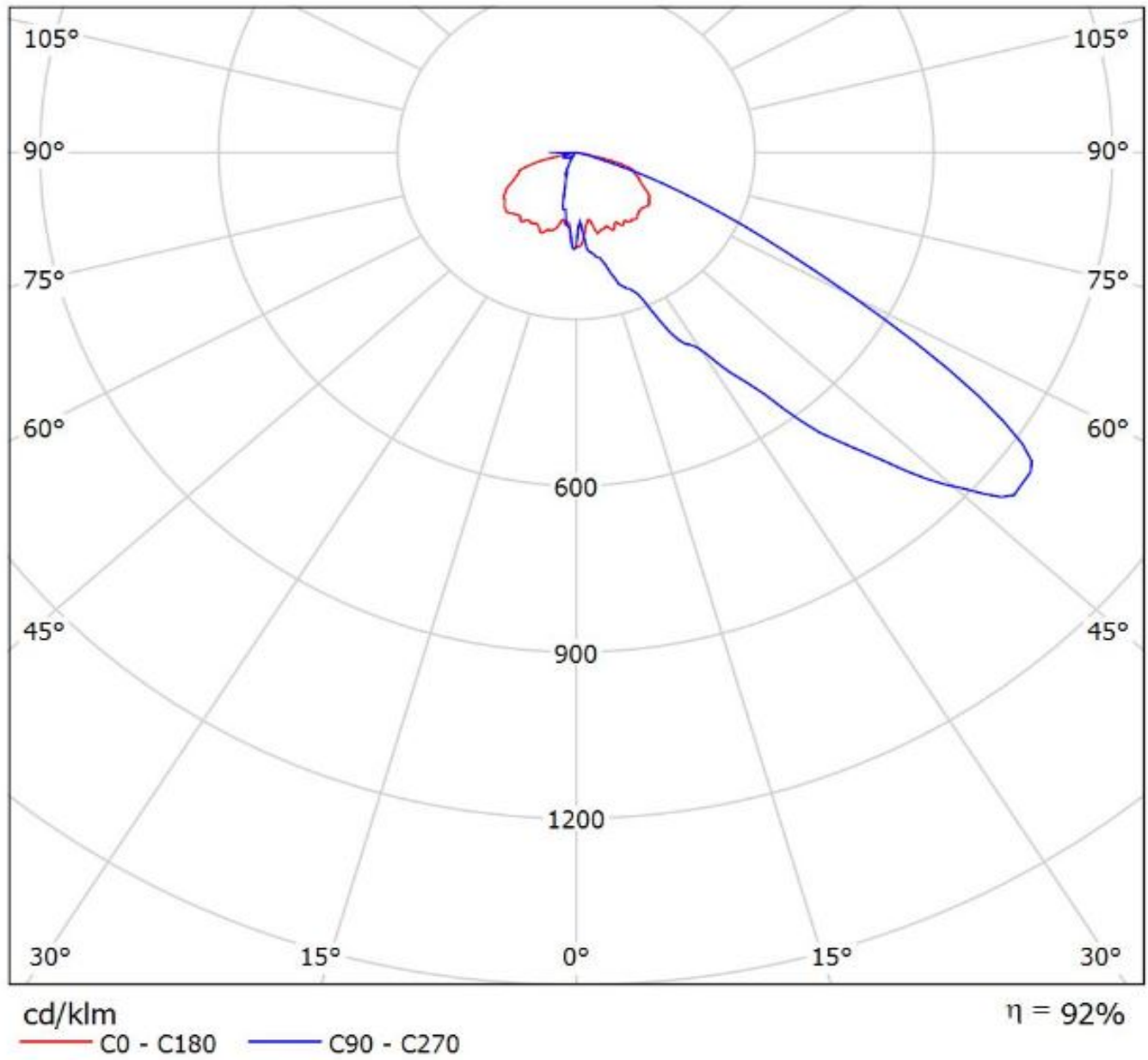

NOTE: The typical divergence will be changed by different color, chip size and chip position tolerance. The typical total divergence is the full angle measured where the luminous intensity is half of the peak value.