

SPECIFICATIONS

Rated(额定参数): 150V,4A
 Dielectric strength(抗电强度): AC:1250V/1 Minute
 Insulation Resistance(绝缘电阻):1000MΩ Min
 Contact Resistance(接触电阻):20mΩ Max
 Temp. range(操作温度): -40℃~+105℃
 MAX Soldering(瞬时温度):+250°C,5s

Housing Material(塑件): PA66 (UL94 V-0)
 Contact(端子): Brass, Tin plating(黄铜镀锡)

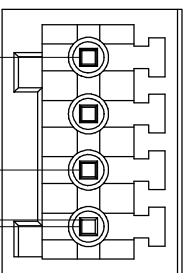
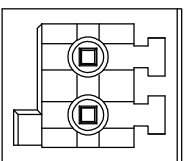
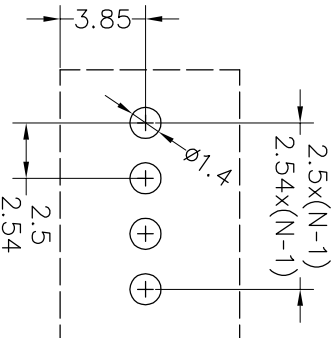

Recommended P.C.B Layout(Top Side)

PITCH RANGE	NOMINAL DIMENSION RANGE					
	IN MM	OVER	IN MM	OVER	OVER	OVER
TO 6	6	10	TO 30	30	60	100
TO 10	10	24	TO 60	60	100	150
±0.10	±0.15	±0.25	±0.30	±0.30	±0.50	±0.70
						±1.00

Ordering Information

JL15EDGVC-XXX XX X X 1

Pitch
 250=2.50PH
 254=2.54PH
 No. of pins
 2P~24P
 Housing Color
 B=Black
 G=Green
 U=Blue
 R=Red
 W=White
 Y=Yellow
 O=Orange
 E=Grey
 Packing
 O=Pe bag
 T=Tube
 A=Troy

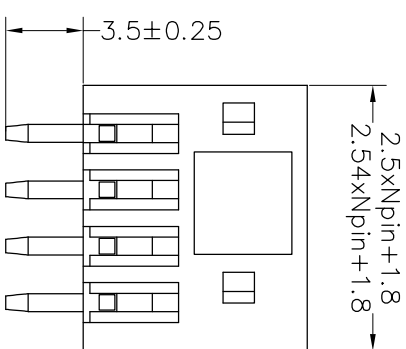
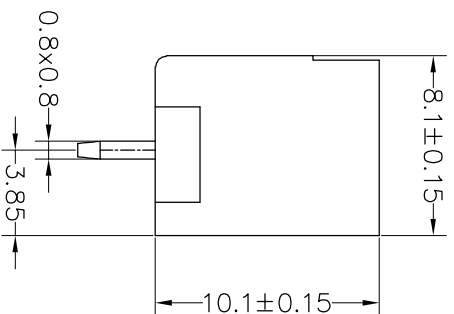

OPERATION		DRAW		SCALE		FIT		PART NO.	
XX	±0.30	yiyusheng	19.08.28	UNIT	mm	A4	1/1	JL15EDGVC-XXXXXXX1	
X:XX	±0.20	CHECK		SIZE					
X:XXX	±0.10			SHEET					
Angle	±3°	APPROVE		PROJ.					
REV	DATE	MODIFICATION DESCRIPTION	CHANGE	DIM	TOL	TITLE: 2.50/2.54mm Pitch Male Pluggable Terminal Blocks			
1									

JILN 深圳市锦凌电子有限公司
 SHENZHEN JINLING ELECTRONIC CO.,LTD
 Tel: 86-755-2997-5806/5802 Fax: 86-755-2997-5992