

FEATURES 特点

Low Frequency Power Amplifier 低频功率放大
Suitable for Driver Stage of Small Motor 小马达
驱动 Complementary to S8050 与 S8050 互补

SOT-23

1. BASE
2. EMITTER
3. COLLECTOR

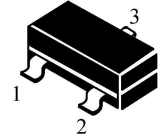

MARKING 丝印

S8550:2TY

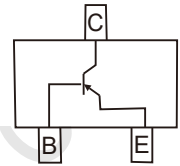

最大额定值($T_a=25^{\circ}\text{C}$)

| CHARACTERISTIC 特性参数 | Symbo 符号 | Rating 额定值 | Unit 单位 |
|--|------------------|---------------|--------------------|
| Collector-Base Voltage 集电极-基极电压 | V_{CB0} | -40 | Vdc |
| Collect-Emitter Voltage 集电极-发射极电压 | V_{CE0} | -25 | Vdc |
| Emitter-Base Voltage 发射极-基极电压 | V_{EBO} | -5.0 | Vdc |
| Collector Current 集电极电流 | I_c | -500 | mAdc |
| Collector Power Dissipation 集电极耗散功率 | P_C | 225 | mW |
| Junction Temperature 结温 | T_j | 150 | $^{\circ}\text{C}$ |
| Storage Temperature Range 储存温度 | T_{stg} | -55~ 150 | $^{\circ}\text{C}$ |

ELECTRICAL CHARACTERISTICS 电特性
($T_A=25^{\circ}\text{C}$ unless otherwise noted 如无特殊说明, 温度为 25°C)

| Characteristic 特性参数 | Symbol 符号 | Test Condition 测试条件 | Min. 最小值 | Typ. 典型值 | Max. 最大值 | Unit 单位 |
|---|---------------|---|-------------|-------------|-------------|---------------|
| Collector Cutoff Current 集电极截止电流 | I_{CBO} | $V_{CB}=-30\text{V}, I_E=0$ | — | — | -0.1 | μA |
| Emitter Cutoff Current 发射极截止电流 | I_{EBO} | $V_{EB}=-5\text{V}, I_C=0$ | — | — | -0.1 | μA |
| Collector-Base Breakdown Voltage 集电极-基极击穿电压 | $V_{(BR)CBO}$ | $I_C=-100\mu\text{A}$ | -40 | — | — | V |
| Collector-Emitter Breakdown Voltage 集电极-发射极击穿电压 | $V_{(BR)CEO}$ | $I_C=-10\text{mA}$ | -25 | — | — | V |
| Emitter-Base Breakdown Voltage 发射极-基极击穿电压 | $V_{(BR)EBO}$ | $I_E=-100\mu\text{A}$ | -5 | — | — | V |
| DC Current Gain 直流电流增益 | $H_{FE(1)}$ | $V_{CE}=-1\text{V},$ $I_C=-100\text{mA}$ | 85 | — | 400 | — |
| | $H_{FE(2)}$ | $V_{CE}=-1\text{V},$ $I_C=-500\text{mA}$ | 40 | — | — | |
| Collector-Emitter Saturation Voltage 集电极-发射极饱和压降 | $V_{CE(sat)}$ | $I_C=-500\text{mA},$ $I_B=-50\text{mA}$ | — | — | -0.6 | V |
| Base-Emitter Saturation Voltage 基极-发射极饱和压降 | $V_{BE(sat)}$ | $I_C=-500\text{mA},$ $I_B=-50\text{mA}$ | — | — | -1.2 | V |
| Base-Emitter Voltage 基极-发射极电压 | V_{BE} | $V_{CE}=-1\text{V},$ $I_C=-10\text{mA}$ | — | -0.8 | -1.0 | V |
| Transition Frequency 特征频率 | f_T | $V_{CE}=-5\text{V},$ $I_C=-10\text{mA}$ | 100 | 120 | — | MHz |
| Collector Output Capacitance 输出电容 | C_{ob} | $V_{CB}=-10\text{V}, I_E=0,$ $f=1\text{MHz}$ | — | 13 | 30 | pF |

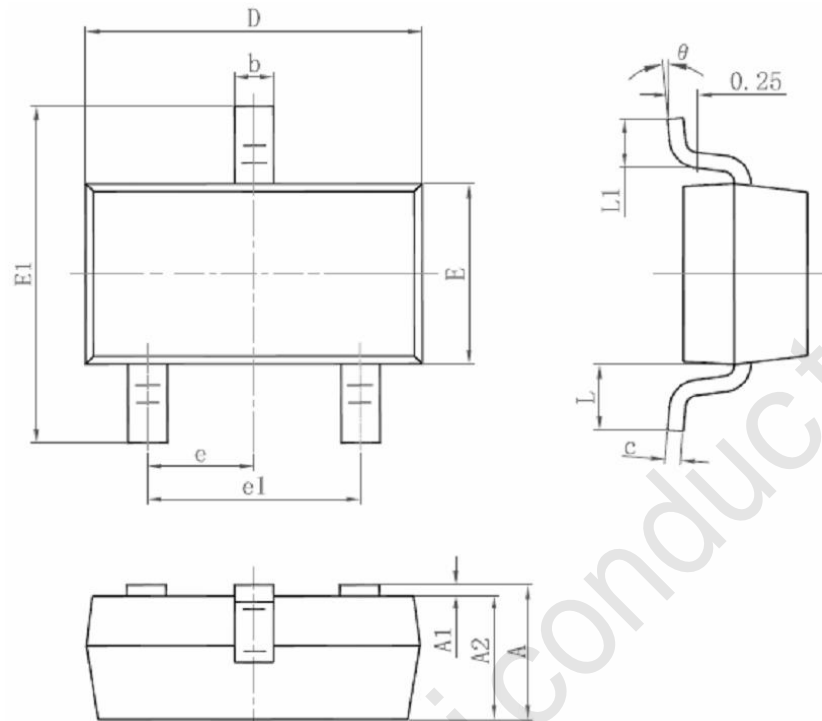
SOT- 23

| 符号 | 毫米 | | 英寸 | |
|----|------------|-------|------------|-------|
| | 最小 | 最大 | 最小 | 最大 |
| A | 0.900 | 1.150 | 0.035 | 0.045 |
| A1 | 0.000 | 0.100 | 0.000 | 0.004 |
| A2 | 0.900 | 1.050 | 0.035 | 0.041 |
| b | 0.300 | 0.500 | 0.012 | 0.020 |
| c | 0.080 | 0.150 | 0.003 | 0.006 |
| D | 2.800 | 3.000 | 0.110 | 0.118 |
| E | 1.200 | 1.400 | 0.047 | 0.055 |
| E1 | 2.250 | 2.550 | 0.089 | 0.100 |
| e | 0.950 TYP. | | 0.037 TYP. | |
| e1 | 1.800 | 2.000 | 0.071 | 0.079 |
| L | 0.550 REF. | | 0.022 REF. | |
| L1 | 0.300 | 0.500 | 0.012 | 0.020 |
| θ | 0° | 8° | 0° | 8° |