

1. CONFIGURATION & DIMENSIONS :

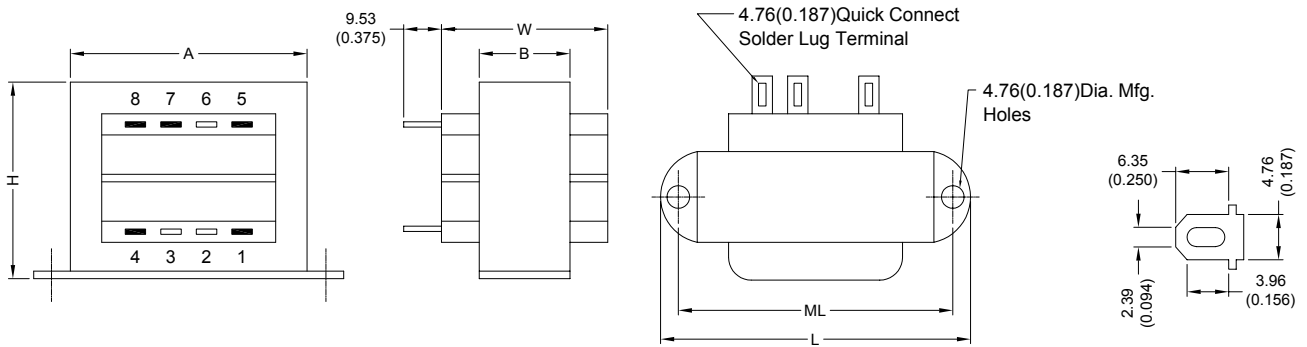

UNIT : mm (inch)

SIZE	VA	L	W	H	A	B	ML	gram
5	12	71.45 (2.813)	38.10 (1.500)	41.28 (1.625)	49.23 (1.938)	24.61 (0.969)	60.33 (2.375)	317.51

2. SCHEMATIC :

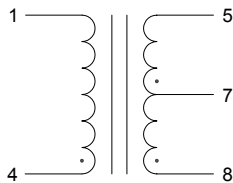

" . " indicates polarity

3. ELECTRICAL CHARACTERISTICS (@ 25°C) :

- | | |
|--------------------------------------|------------------------------|
| a. Primary Voltage | AC 115 V 60 Hz . |
| b. No Load Primary Current | Less Than 20mA . |
| c. Secondary Voltage (±5%) | |
| Pin 5-8 C.T. Pin 7 | AC 12.10 V . |
| d. Secondary Load Current | 1.2A . |
| e. Full Load Primary Current | Less Than 180mA . |
| f. Full Load Secondary Voltage (±5%) | 10.00V . |
| Pin 5-8 C.T. Pin 7 | |
| g. DC Resistance | |
| Pin 1-2 | Primary = 71.10 Ohm . |
| Pin 5-7 | Secondary-1 = 0.386 Ohm . |
| Pin 7-8 | Secondary-2 = 0.428 Ohm . |
| h. Insulation Resistance | DC 500V 100Meg Ohm Of More . |
| i. Withstand Voltage (Hi-Pot) | AC 2500V 60Hz 1 Minutes . |
| j. Temperature Rise | Less Than 60 Deg C . |
| k. Core Size | EI-48 x 20.80 m/m . |

l. Turns & Wire Gauge

- | | | | | |
|-----------|-----------|----------|----------------|---------|
| Primary | Pin 1-4 | 3027 | Turns Diameter | 0.18 mm |
| Secondary | Pin 5-7,8 | 0.54-109 | Turns Diameter | 0.35 mm |



RoHS Compliant

NOTE : Specifications subject to change without notice. Please check our website for latest information.

25.02.2008



SUPERWORLD ELECTRONICS (S) PTE LTD