

| | | | |
|-----------------|--------------------|-------------------------|--------------------------------------|
| REV A | AUTH JLE | DATE 10/17/02 | INITIAL RELEASE |
| REV B | AUTH RL | DATE 10/31/06 | ILLUSTRATION, NOTES, FORMAT UPDATED. |

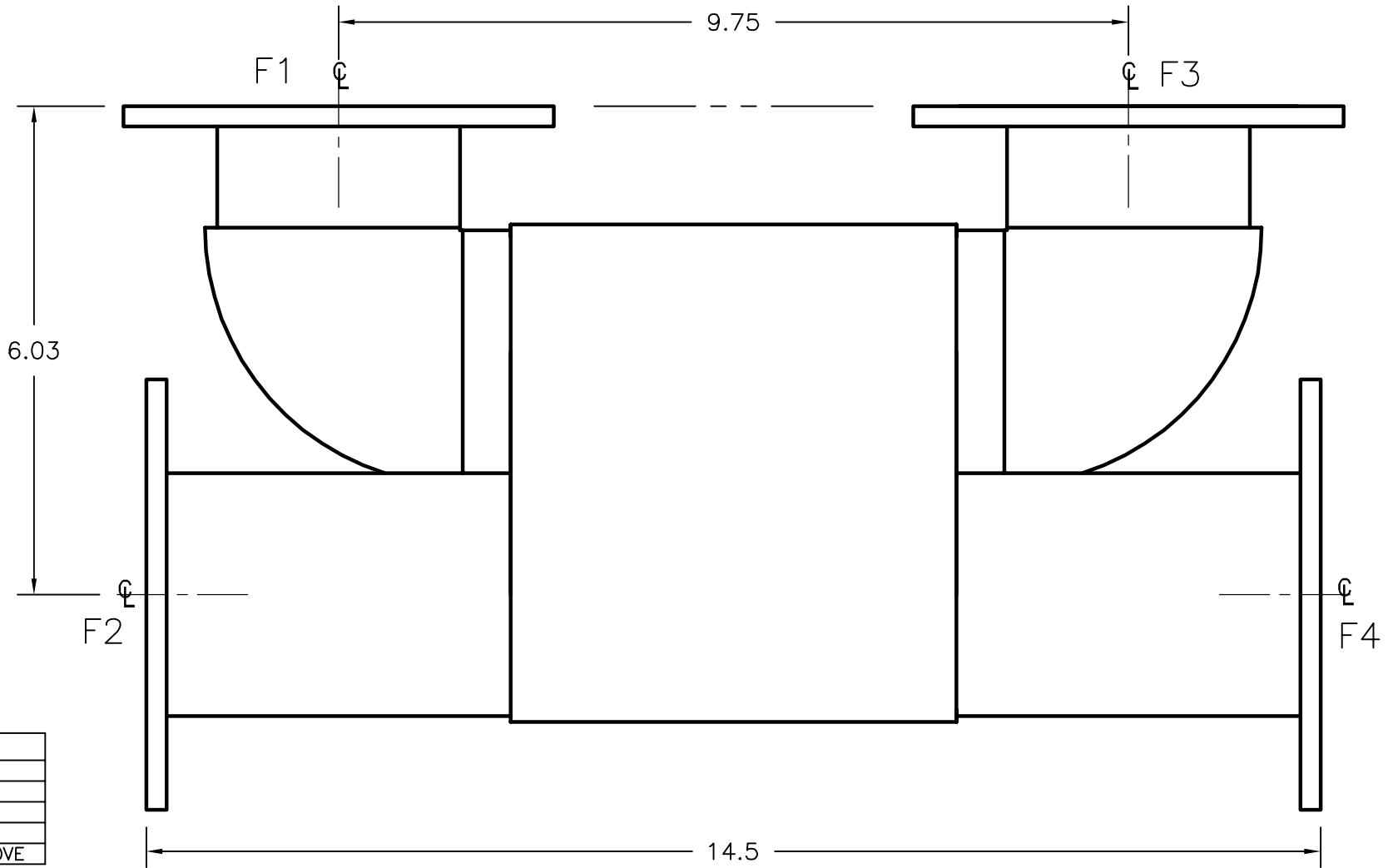

| FLANGE TYPE |
|----------------------|
| 1 = CPRG |
| 2 = CPRF |
| 6 = U/G COVER |
| 7 = U/G CHOKE |
| 8 = U/G COVER GROOVE |

| FREQUENCY | MODEL |
|---------------|------------------------|
| 2.66–2.99 GHz | 284–261X–Z–F1–F2–F3–F4 |
| 2.99–3.44 GHz | 284–262X–Z–F1–F2–F3–F4 |
| 3.44–3.95 GHz | 284–263X–Z–F1–F2–F3–F4 |

NOTE: REPLACE "F1, F2, F3, & F4" NOTATION WITH NUMBER CORRESPONDING TO FLANGE TYPE DESIRED, AS SHOWN ON TABLE ABOVE.

| | | | | | |
|--|-----------------------------|-----------------------------|-----------------|--|---|
| THIRD ANGLE PROJECTION: | | APPROVALS | DATE | ADVANCED TECHNICAL MATERIALS, INC. TEL: (631) 289-0363 FAX: (631) 289-0358 www.atmmicrowave.com | <small>THE INFORMATION IN THIS DRAWING IS PROPRIETARY AND SHALL NOT BE USED OR DISCLOSED WITHOUT THE PRIOR WRITTEN CONSENT OF ATM, INC. DO NOT SCALE DWG.</small> |
| UNLESS OTHERWISE NOTED, DIMENSIONS ARE IN INCHES, TOLERANCES ARE: FRACTIONS: $\pm 1/64$ ANGLES: $\pm 1/2^\circ$ | | DRAWN JLE | 10/17/02 | | |
| BASIC DIMENSION | DECIMALS 2 PLACE 3 PLACE | CHKD. | APRVD. | OUTLINE, WR284 'Z'-STYLE COMBINER-DIVIDER (HYBRID-COUP.) | |
| UNDER 6" | $\pm .02$ $\pm .005$ | MATERIAL PER ORDER | | | |
| 6" – 12" | $\pm .03$ $\pm .010$ | TREATMENT - | | | |
| OVER 12" | $\pm .06$ $\pm .015$ | FINISH ATM STD. GRAY | | SIZE A | CAGE CODE 0R8N4 |
| | | | | ATM DWG # 5221W | REVISION B |
| | | | | SCALE 1 : 2 | SHEET 1/1 |
| | | | | MODEL # SEE NOTES | |