

### 1. GSPW1651N SE- -TR (1W LED)



RoHS compliant  
 Pb-free soldering compatible

- Special color LED in which object is shown to more attractive.
- Special spectral characteristic matched to object.
- Various phosphors are originally combined.
- High Reliability Life time 40,000hrs

#### Package Dimensions

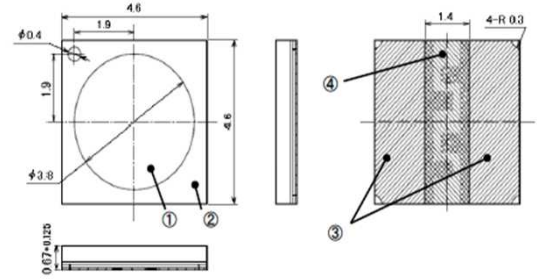

L4.6 x W4.6 x H0.67 mm

#### Electro-Optical Characteristics (Ta=25 )

Part Name	Color	VF	Luminous Flux		VF	Forward Current Max
				IF		
GSPW1651NPSE-11-TR	Purplish Pink	3.0V	85	350mA	600mA	Fresh Meat
GSPW1651NPSE-12-TR	Yellowish Pink		80			
GSPW1651NCSE-14-TR	Ice Blue		107			Crystal Glass
GSPW1651NSE-20Y-TR	Gold(2000K)		85			

### 2. GTEW1151ASE-16-TR (0.5W LED)



RoHS compliant  
 Pb-free soldering compatible

- Special spectral characteristic which is enhanced freshness of objects.
- Decrease a yellow color element and increase a red color element.

#### Package Dimensions

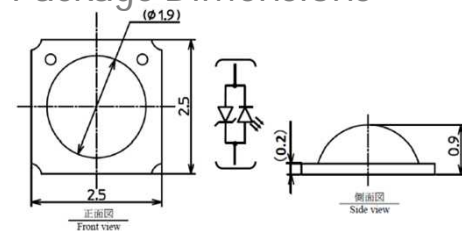

L2.5 x W2.5 x H0.9mm

#### Electro-Optical Characteristics (Ta=25 )

Part Name	Color	VF	Luminous Flux		Forward Current Max	Usage
				IF		
GTEW1151ASE-16-TR	Special color(White)	3.1V	85	80mA	170mA	Fresh Meat

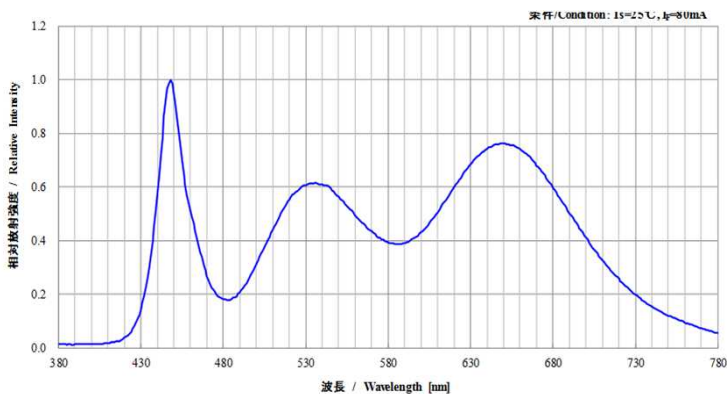

\*Performance and specification may revised without prior notice, in accordance to meet the engineering development. It is recommended to confirm the most updated specification before designing. Updated Sept 2014

1. GSPW1651N SE- -TR (1W LED)

Light effect



Purplish Pink



Purplish Pink



Gold (2000k)

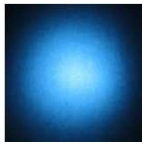

Ice Blue



2. GTEW1151ASE-16-TR (0.5W LED)

■ Application

- Lighting for Fresh meat and Fresh fish (Frozen refrigeration showcase)
- Lighting for 'Sushi neta case'. (Material case)



EW



SUSHI Shop  
Meguro Tokyo Japan



IMAGE

\*Performance and specification may revised without prior notice, in accordance to meet the engineering development. It is recommended to confirm the most updated specification before designing.

Updated Sept 2014