

HSF

Recommended P.C.B Layout(Top Side)
(PCB BOARD TOLERANCE±0.05)

NOTES:
Current Rating:1.5AMP
Contact Resistance:20mΩ max
Withstand Voltage:500V AC/DC
Insulation Resistance:1000MΩ min
Operation Temperature:-40°C to +105°C

Contact Material:Brass
Contact plating:Au or Sn Over Ni
Insulator Material:PA9T+30%GF(UL94V-0)

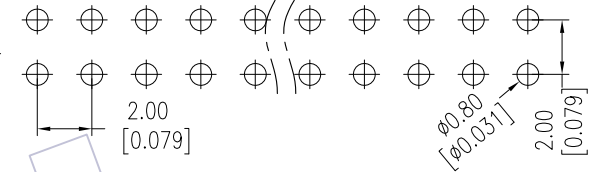
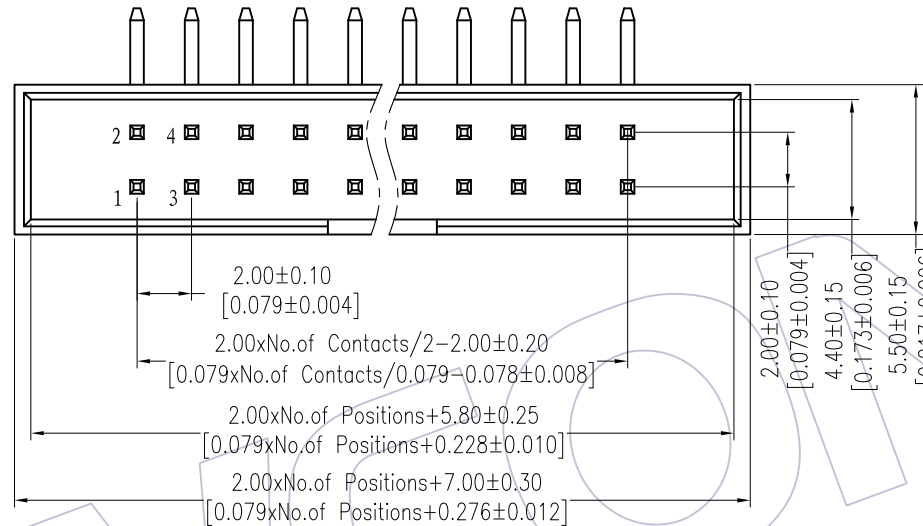

Ordering Information

3111-XX R XX B K00 X 1

No.of Pins	Contact Plating	Color Insulator	Packing
10 30	G0=Gold Flash	B=Black	A=Tray
14 34	G1=3u"Gold	U=Blue	T=Tube
16 40	G2=5u"Gold	W=White	
20 44	G3=10u"Gold		
24 50	G4=15u"Gold		
26 60	G5=30u"Gold		
	S0=Gold Flash/Tin		
	S1=3u"Gold/Tin		
	S2=5u"Gold/Tin		
	S3=10u"Gold/Tin		
	S4=15u"Gold/Tin		
	S5=30u"Gold/Tin		
	SN=Tin		

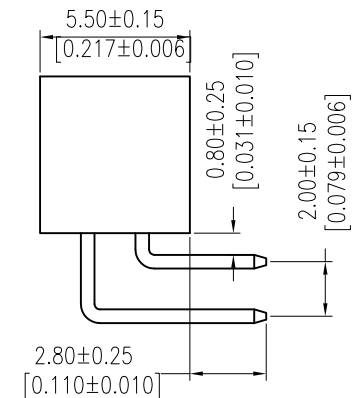
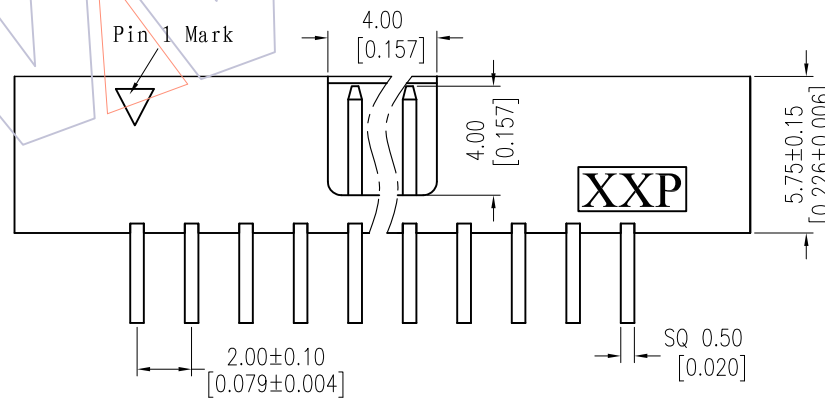

Item	Contact Length	Mating
Standard	4.00	5222 5224 5225
Alternate		

REV	DATE	MODIFICATION DESCRIPTION	CHANGE	OPERATION		DRAW Tsingsn	DATE 2012/05/31	SCALE UNIT	FIT mm linch	PART NO. 3111-XXRXXBK00X1
				X.X	±0.40					
				X.XX	±0.25	CHECK	DATE			TITLE: 2.00 BOX HEADER 90° H=5.7
A0	2012/05/31	NEW		X.XXX	±0.15	APPROVE	DATE	SHEET 1/1		Customer NO.
				Angle DIM	± 3' TOL			PROJ.		

WCON
Http: www.wcon.com

WCON-Dongguan
Tel: +86 769 85358920
Fax: +86 769 85358915
E-mail: sales@wcon.com

WCON-Kunshan
Tel: +86 512 57468408
Fax: +86 512 57468468
E-mail: salesks@wcon.com