

## GT-TC077X-HXXXX-LX

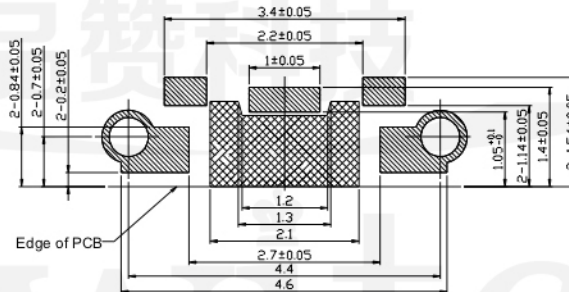
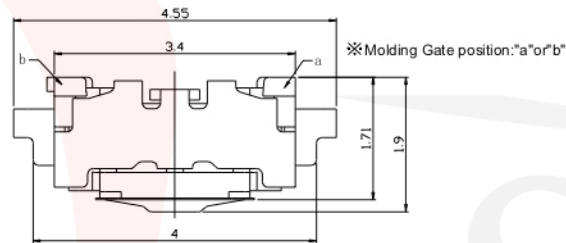

### P.C.B LAND DIMENSION

**G-SWITCH**

**Operating Force**  
 A=160gf L=0.56mm  
 B=250gf L=0.585mm  
 C=100gf L=0.53mm

**Switch Height (mm)**  
 H0165=1.65mm

**Switch lifetime (Force)**  
 L5=500,000 Cycles(A, B)

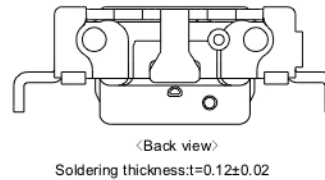
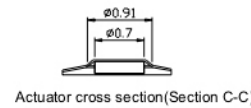
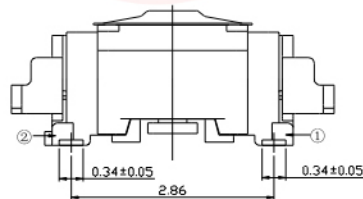

### G-Switch Specification:

Operating temperature range : -30°Cto+85°C  
 Rating : 50mA.12V DC  
 Insulation resistance: : 100MΩ min.100V DC  
 Dielectric strength : 250V AC for 1 min  
 Contact resistance: : 100m Ω max.  
 Travel:Operating Force(A/B)0.11±0.05mm,C 0.08±0.03mm.  
 IP67(\* 1) Dust resistance : 4 types of talc 8 h,  
 Water resistance : Immersion depth 1 m 30 min

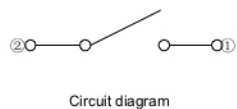

## G-Switch Electronic (HongKong) CO.,Ltd.

Unless otherwise specified, Tolerance:  
 X. ±0.30  
 X.x ±0.20  
 X.xx ±0.15  
 X.xxx ±0.10  
 Angles ±3°

DESIGN FengFengChen DATE 2020.12.09  
 CHECKED DATE  
 APPROVED DATE  
<http://www.dg-switch.com>  
 TEL:0769-82388879

Molde code:  
**GT-TC077X-HXXXX-LX**  
 REV.: X1 SCALE: 4:1 UNIT: mm  
 SIZE: A4 SHEET: 1/1