



FEATURES

- 90~264 VAC Universal Input
- Interchangeable Plugs Available
- Green Power Meets CEC and ErP Standards



ELECTRICAL SPECIFICATIONS

Input Voltage	90~264 VAC, 47~63Hz
Input Current	0.7A (rms) max.
Output Power	30W
Output Voltage, 11~27V	CEC level V, ErP Step 2
27~50V	CEC level IV, ErP Step 1
Voltage Regulation	±5% max.
Efficiency @ Full Load	80% typ
Standby Power @ No Load	0.5W max. for CEC level IV 0.3W max. for CEC level V
Operating Temperature	-10°C to +50°C
Derating	Derate linearly from 100% load @ 40°C to 75% load @ 50°C
Storage Temperature	-20°C to +85°C
Operating Humidity	20% to 90% RH
Protections	OVP, OLP, & short-circuit
Withstand Voltage	3000 VAC from input to output
Standard Output Connector	Barrel plug
Standard Output Cable	UL2468, 5ft

STANDARDS & COMPLIANCES

Safety Standards	UL60950-1, EN60950-1
Agency Approvals	UL, cUL, CB, CE
EMI Standards	EN55022, Class B CISPR22, Class B FCC Part 15
EMC Standards	EN61000-3-2, EN61000-3-3, EN61000-4-2, EN61000-4-3, EN61000-4-4, EN61000-4-5, EN61000-4-6, EN61000-4-8, EN61000-4-11, EN55024
Other Standards	CEC, ErP, RoHS

MECHANICAL DRAWINGS

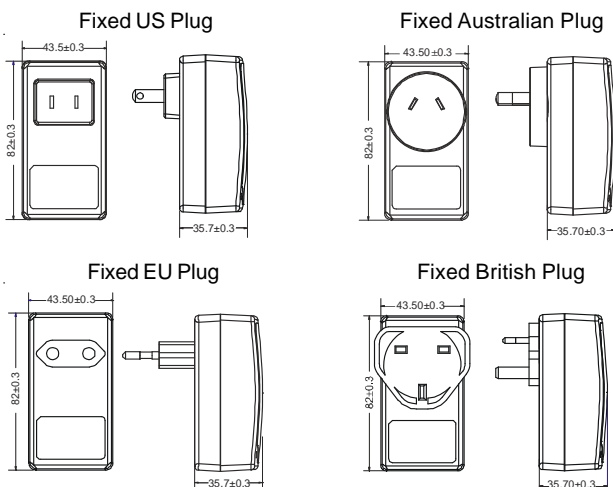

Unit: mm

MODELS LIST

Product No.	Output Voltage	Output Current	Max. Output Power
TRW30-12-X	11~13V	2.73~2.3A	30W
TRW30-15-X	13~16V	2.3~1.87A	30W
TRW30-18-X	16~21V	1.87~1.43A	30W
TRW30-24-X	21~27V	1.43~1.11A	30W
TRW30-30-X	27~33V	1.11~0.91A	30W
TRW30-36-X	33~40V	0.91~0.75A	30W
TRW30-48-X	40~50V	0.75~0.6A	30W

Note: X = AC plug code. See the below tables and drawings for details.

X	Fixed Wall Mount Plug
U	US Plug
A	Australian Plug
E	EU Plug
B	British Plug

X	Interchangeable Plug
I	Body for Interchangeable Plugs
IU	US Plug
IA	Australian Plug
IE	EU Plug
IB	British Plug

Ordering Information

1. Specify the output voltage and AC plug code when ordering, e.g. TRW30-19-E for 19V output model with a fixed EU wall plug.
2. For interchangeable plug orders, at least one interchangeable plug must be ordered together with the "main body" (X = I).
3. Contact TRUMPower for output connector options.