

GSD

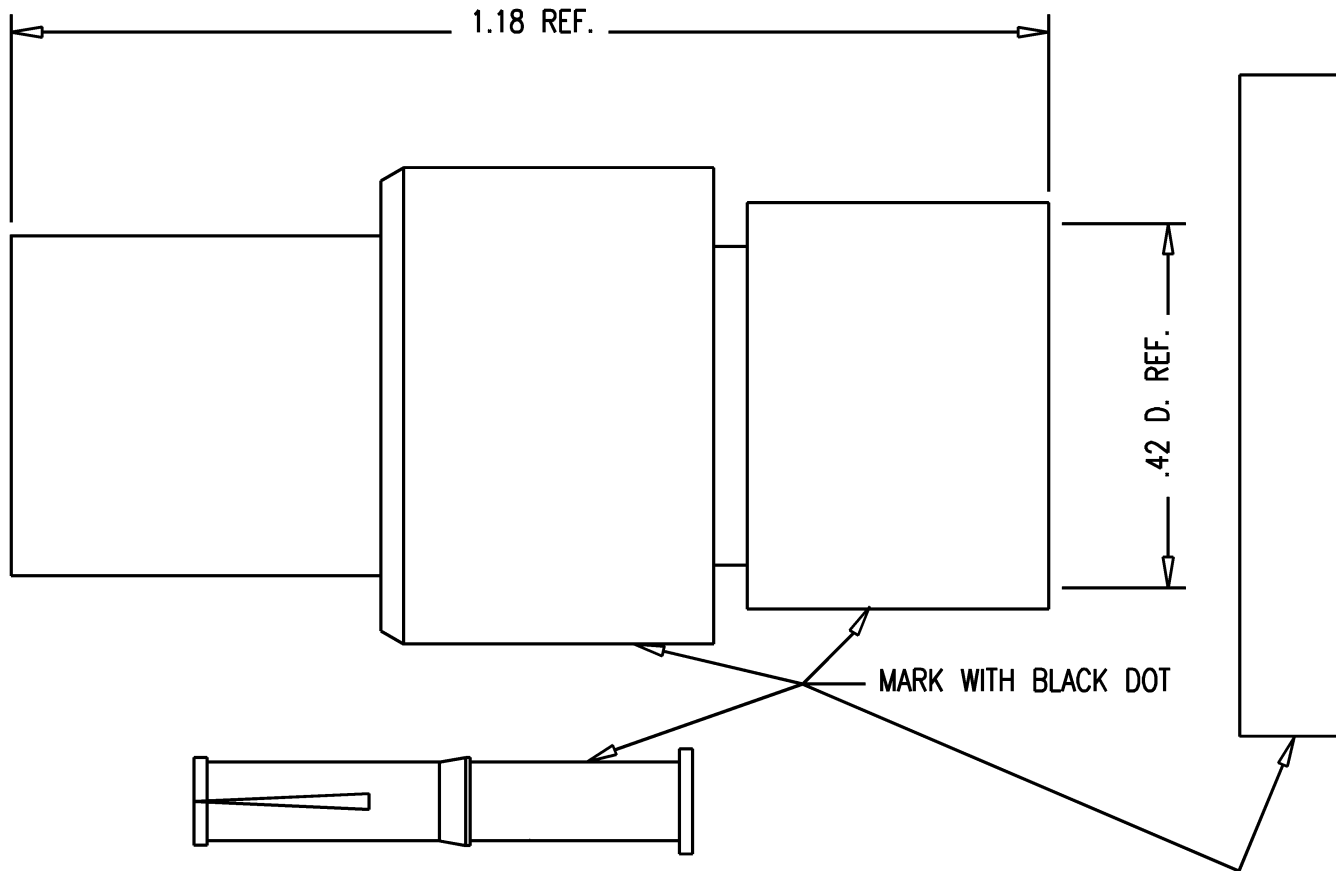

NOTES:

1. FOR CRIMPLING USE DIE KTH-2040.
2. MATERIALS:
 - INSULATOR: TEFLON, ASTM-D-4894
 - K-GRIP SLEEVE: COMMERCIAL BRONZE, ASTM-B-135
 - CENTER CONTACT: BER. COP., ASTM-B-196
 - GASKET: SILICONE RUBBER, ZZ-R-765
 - ALL OTHER METAL PARTS: BRASS, ASTM-B16
3. FINISHES:
 - CENTER CONTACTS: GOLD PLATE PER MIL-G-45204
 - ALL OTHER METAL PARTS: SILVER PLATE PER QQ-S-365

GSD

7708-4

REVISIONS	
ISSUE	CHANGES
0	ER 35422 KH 04/10/95
1	CN 37238 D KH 02/03/97

SCALE 4:1

APPROX SURFACE AREA

USED ON

REF:

RETRO-FIT ASSY

DRAWN KH	DATE 04/10/95
DESIGN DW	DATE 04/11/95
APPR.	DATE

KINGS

ELECTRONICS CO., INC.
ROCK HILL, SOUTH CAROLINA 29730

7708-4