

DASH NO. RANGE	"D" DIA. RANGE	"E" DIMENSION	"G" GAP	"T" GAUGE
T[ ]2 THRU T[ ]20	1/8" TO 1-1/4"	"D"/2 + .312	.06	.020
-2 THRU -20		"D"/2 + .322		.031
-21 THRU -32	1-5/16" TO 2"	"D"/2 + .322	.12	

**MATERIAL & FINISH CODES:**

**METAL:** "NO CODE" 1008/1020 LOW CARBON STEEL PER ASTM A 1008, ASTM A 109, QQ-S-698  
 FINISH: ZINC PLATE GOLD PER ASTM B 633, Fe/Zn 8, TY. II 1

"D" 2024-T42 ALUMINUM CLAD PER AMS-QQ-A-250/5  
 FINISH: NONE

"DC" 2024-T42 ALUMINUM CLAD PER AMS-QQ-A-250/5  
 FINISH: CHEMICAL FILM GOLD PER MIL-DTL-5541, TY. I, CL. 1A

"DZ" 2024-T42 ALUMINUM CLAD PER AMS-QQ-A-250/5  
 FINISH: ANODIZE CLEAR PER MIL-A-8625, TY. II, CL. 1

"SS" 302/321 STAINLESS STEEL PER AMS 5516/AMS 5510  
 FINISH: NONE

**CUSHION:** "A" GENERAL PURPOSE EPDM PER SAE J200 M3 BA 710 C12  
 COLOR: BLACK

"G" GENERAL PURPOSE NEOPRENE PER AMS 3209  
 COLOR: BLACK 2

"H" GENERAL PURPOSE SILICONE PER AMS 3303 WITH 100 PSI MIN. TEAR  
 COLOR: RED/ORANGE

"HL" SILICONE PER AMS 3303 & MIL-C-8603 WITH 100 PSI MIN. TEAR  
 COLOR: NATURAL WHITE

"T" TEFLON SKIVED PER AMS 3652  
 COLOR: WHITE

"X" TEFLON ANTI-SLIP PER AMS 3652 & AMS 2491  
 COLOR: BROWN



S179

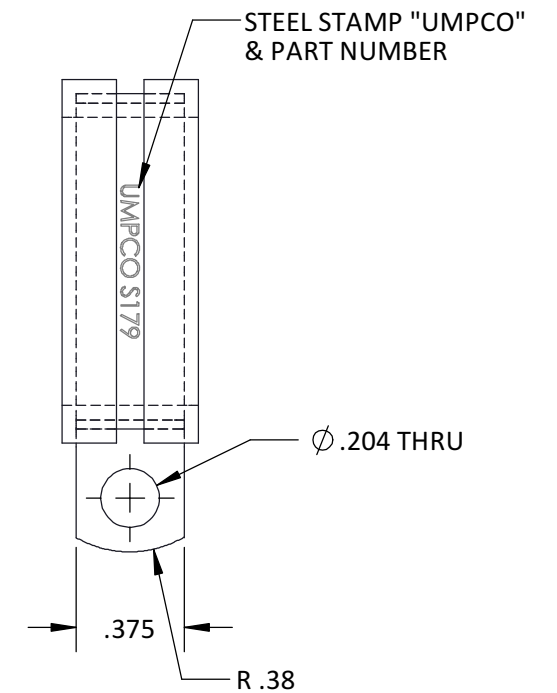
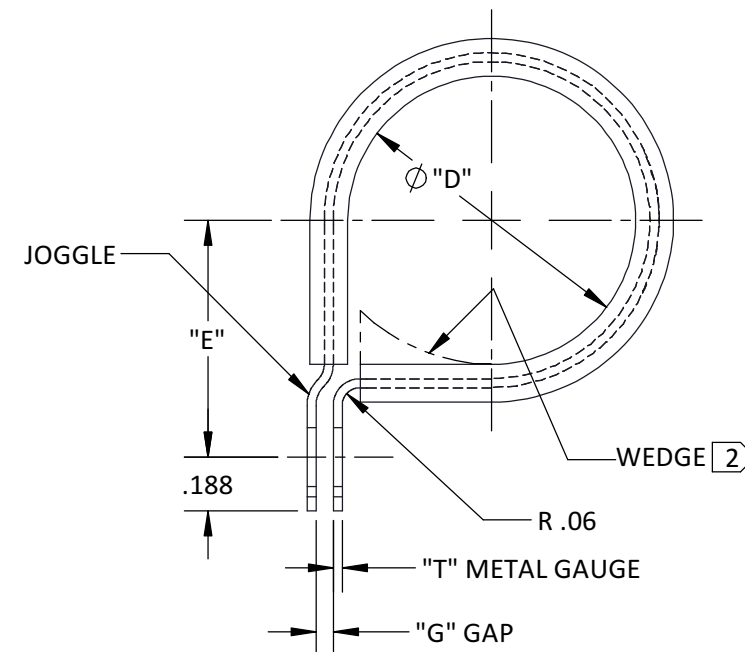

**EXAMPLE OF PART CALLOUT:**

1" DIA., .020 THK., ALUM. CLAMP W/WEDGED ANTI-SLIP TEFLON

S179 T W D X 16

- DIA. "D" IN 1/16th INCREMENTS
- CUSHION CODE
- METAL CODE (OMIT FOR "NO CODE")
- WEDGE CODE (OMIT IF NOT DESIRED)
- REDUCED METAL (OMIT IF NOT DESIRED)
- BASIC DRAWING NUMBER

**NOTES:**

- 1 OPTIONAL FINISH: CADMIUM PLATE GOLD PER AMS-QQ-P-416, TY. II, CL. 2
- 2 CUSHION "G" W/WEDGE, WILL BE BLACK W/BLUE LINE IDENTIFIER.
- 3) LOCKHEED APPLICATIONS ARE SILICONE ONLY AND MUST USE INTEGRAL MOLDED CUSHION, COLOR: WHITE
- 4) CLAMPS FURNISHED IN THE NORMAL OPEN (SPRINGBACK) CONDITION.
- 5) INSPECT PER MIL-C-8603 CLOSURE TEST.

SHEET 1 OF 1

REFERENCES:							
LIMITS ON DIMENSIONS UNLESS OTHERWISE SPECIFIED:	ANGULAR:	X	± 5°	<b>UMPCO . INC.</b> 7100 LAMPSON AVE. P.O. BOX 5158 GARDEN GROVE, CA. 92846		FSCM/CAGE CODE No. 18076	
	DECIMAL:	.XX	± .03			SCT	KEL
GENERAL MACHINE FINISHES EXCEPT AS NOTED:	PROPRIETARY AND CONFIDENTIAL THE INFORMATION CONTAINED IN THIS DRAWING IS THE SOLE PROPERTY OF UMPCO, INC. ANY REPRODUCTION IN PART OR AS A WHOLE WITHOUT THE WRITTEN PERMISSION OF UMPCO, INC IS PROHIBITED.			09/02/87 09/03/87 04/21/99 DRAWN CHECKED ENGR			
	INTERPRET GEOMETRIC TOLERANCING PER: ASME-Y14.5M			CLAMP, LOOP-CUSHIONED, COMMERCIAL, #10 MOUNTING SCREW		SCALE: NONE <b>S179</b>	
REMOVE ALL BURRS AND BREAK SHARP EDGES .010 MAX	ACT. WGHT.	-		PART AND/OR ASSEMBLY DESCRIPTION		PRINT NUMBER	
	CALC. WGHT.	-					