

MAPX	MODIFICATION	DATE

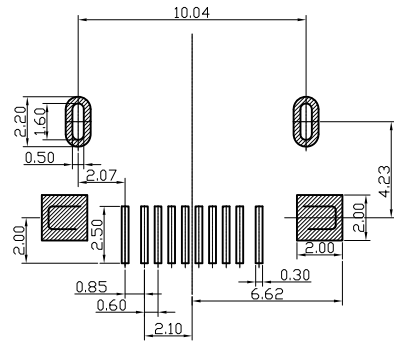
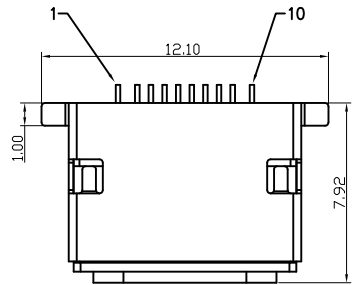

RECOMMENDED P.C.B LAYOUT(TOP VIEW)  
GENERAL TOLERANCE +/-0.05

NOTES:

1) MATERIAL:  
HOUSING: THERMOPLASTIC, UL 94V-0,  
COLOR: BLACK  
CONTACT: COPPER ALLOY T=0.20mm  
SHELL A: STAINLESS STEEL T=0.40mm  
SHELL B: STAINLESS STEEL T=0.25mm

2) SPECIFICATION;  
2.1, CURRENT RATING: 2.4A Max.  
2.2, DIELECTRIC WITHSTANDING  
VOLTAGE: 500 V(ac) for 1 min.  
2.3, CONTACT RESISTANCE: 100 mΩ Max.  
2.4, INSULATION RESISTANCE: 1000 MΩ Min.  
2.5, TOTAL MATING FORCE: 4.0 Kgf Max.  
2.6, TOTAL UNMATING FORCE: 0.2 Kgf Min.  
2.7, DURABILITY: 5000 cycles Min

3. PLATING:

CONTACT: 1u" MIN GOLD PLATING ON CONTACT AREA  
G/F PLATING ON SOLDER TAILS  
SHELL: G/F PLATING ON SOLDER TAILS

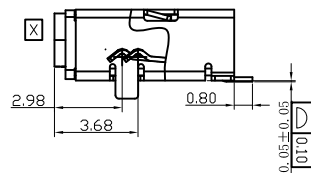
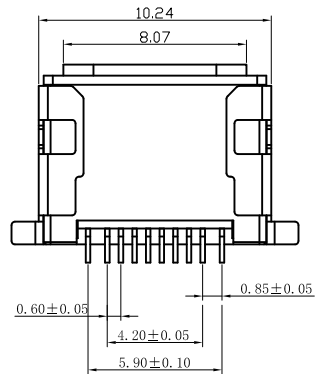
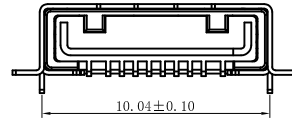
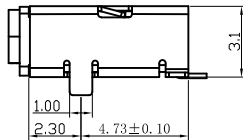
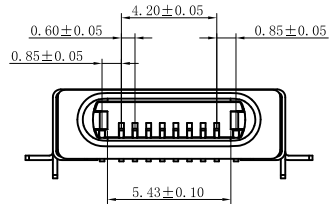

section A-A

Pin No.	SIGNAL
1	DETECT_1
2	GND
3	DP1
4	DN1
5	ACC1
6	PWR
7	DN1
8	DP1
9	ACC2
10	DETECT_2
SHELL_A	GND
SHELL_B	GND

<p>产品图 PRODUCT CHART DWG</p>				<p>深圳市精拓金电子有限公司</p>						
<p>公差一览表 TOLERANCE UNLESS OTHERWISE</p>				单位 UNITS	MM	制图 DRAWING	许榕强	制图料号 PRODUCT PART NO.	914-614A2025S10200	
X.	±0.25	X.	±5°	比例 SCALE	1:1	审核 CHKD	郭治富	产品名称 PRODUCT NO.	AF 苹果款15四脚前插后贴不锈钢LCP黑胶 SMT卷带	
XX	±0.15	XX	±1°	日期 DATE	2016-09-09	核准 APPD	黄国荣	角法 VIEW	版本 VER	A0
XXX	±0.10	XXX	±0.5°							

由 Autodesk 教育版产品制作

由 Autodesk 教育版产品制作