

FCI CONFIDENTIAL

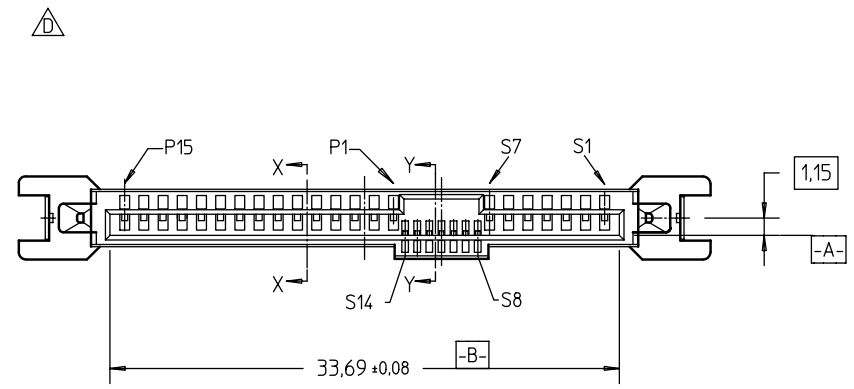

This document is the property of and embodies CONFIDENTIAL and PROPRIETARY information of FCI. No part of the information shown on this document may be used in any way or disclosed to others without the written consent of FCI. Copyright FCI.

PRODUCT NO	DIM L	DIM M	PLATING	RECOMMENDED P.C. BOARD THICKNESS
10031077-003LF	2.70	2.10	NOTE 2	1.57mm (0.062") / 2.36mm (0.093")



NOTES:

- 6 THE HOUSING WILL WITHSTAND EXPOSURE TO 260°C PEAK TEMPERATURE FOR 10 SECONDS IN A CONVECTION, INFRA-RED OR VAPOR PHASE REFLOW OVEN.
- 7 THIS PRODUCT MEETS EUROPEAN UNION DIRECTIVES AND OTHER COUNTRY REGULATIONS AS DESCRIBED IN GS-22-008.
- 8 PART NUMBERS ENDING IN "LF" MEANS FOR NOTE 7 LEAD FREE IDENTIFICATION. P/N XXXXXXXX-XXXLF IS EQUIVALENT TO PREVIOUS P/N XXXXXXXX-XXX- $\triangle D$
- $\triangle D$ 9 NOTE 7 AND 8 DO NOT APPLY TO TIN LEAD PLATING P/N XXXXXXXX-XXX IN TABLE.
- 10 THE STD PACKAGING IS IN TRAY
- 11 A $\triangle D$ SYMBOL WILL BE NEXT TO ANY DIMENSION, VIEW OR NOTE WHICH HAS BEEN MODIFIED WITH THE CURRENT DRAWING REVISION

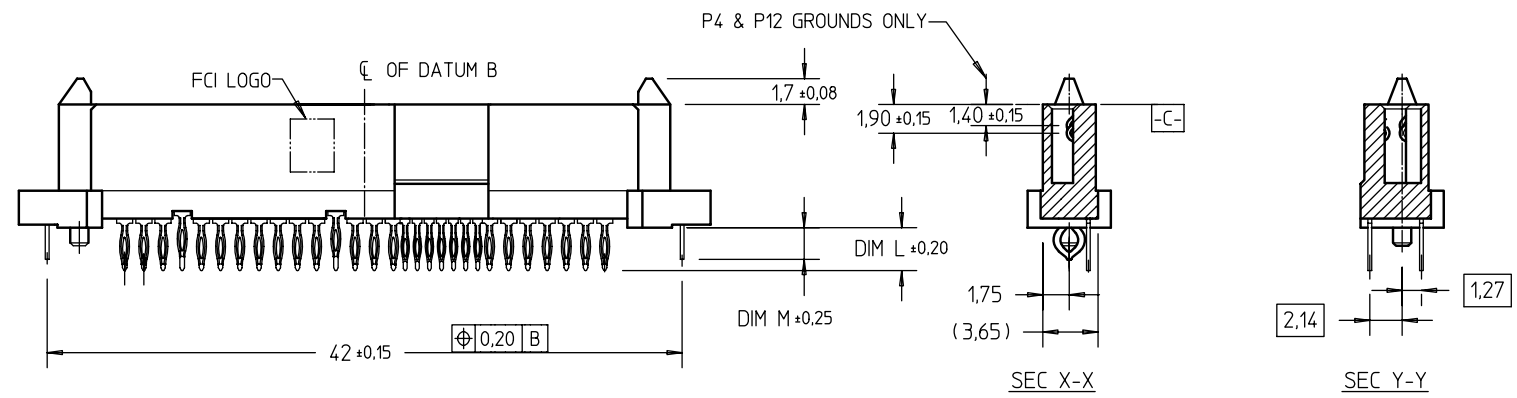
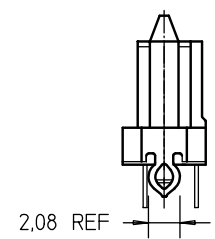

NOTES :
ALL OTHER DIMENSIONS, REFER TO SHEET 1.

mat'l. code		surface <input checked="" type="checkbox"/> ISO 1302		tolerance <input checked="" type="checkbox"/> ISO 406 ISO 1101		projection		product family		SAS	
ltr	ecn no	dr	date		tolerances unless otherwise specified		title		SAS RECEPTACLE VERTICAL PF TYPE ASSY		
D					angles		mm		dwg no		
					linear		scale 2:1		sheet 2 of 2 size		
					± 2°				10031077		
					dr		GL L00		2004-09-23		
					enr		GL L00		2004-09-23		
					chr		GL L00		2009-07-21		
					appd		JOEY NG		2009-07-21		
sheet index		revision sheet		1						type CUSTOMER Drawing	