

Aluminum Capacitors

Power Miniaturized General Purpose Snap-In

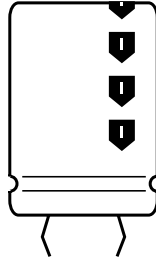
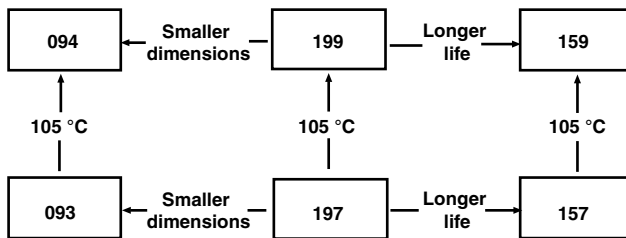

Fig.1 Component outlines



QUICK REFERENCE DATA	
DESCRIPTION	VALUE
Nominal case size (\varnothing D x L in mm)	22 x 25 to 35 x 50
Rated capacitance range, C_R	68 μ F to 2200 μ F
Tolerance on C_R	\pm 20 %
Rated voltage range, U_R	200 V to 450 V
Category temperature range	- 25 $^{\circ}$ C to + 85 $^{\circ}$ C
Useful life at 85 $^{\circ}$ C	2000 hours
Useful life at 40 $^{\circ}$ C and 1.4 x I_R applied	36 000 hours
Shelf life at 0 V, 85 $^{\circ}$ C	500 hours
Based on sectional specification	IEC 60384-4/EN130300/W of JISC5141

SELECTION CHART FOR C_R , U_R AND RELEVANT NOMINAL CASE SIZES (\varnothing D x L in mm)					
C_R (μ F)	U_R (V)				
	200	250	400	420	450
68	-	-	22 x 25	-	-
82	-	-	-	-	22 x 25
100	-	-	22 x 25	22 x 25	22 x 30
120	-	-	-	-	22 x 30 25 x 25
150	-	-	22 x 30 25 x 25	-	22 x 35
180	-	-	22 x 35 25 x 30	22 x 35 25 x 30	22 x 40 25 x 30 30 x 25
220	-	22 x 25	22 x 40 25 x 30 30 x 25	25 x 35 30 x 25	22 x 50 25 x 35 30 x 25
270	22 x 25	22 x 30	22 x 50 30 x 25	22 x 50 30 x 30	30 x 30 35 x 25

FEATURES

- Polarized aluminum electrolytic capacitors, non-solid electrolyte
- Large types, miniaturized dimensions, cylindrical aluminum case insulated with a blue sleeve
- Useful life: 2000 hours at 85 $^{\circ}$ C

RoHS
COMPLIANT

APPLICATIONS

- Consumer electronics
- Whitegood motor control
- Electronic drives
- Smps/ups

MARKING

The capacitors are marked (where possible) with the following information:

- Rated capacitance (in μ F)
- Tolerance on rated capacitance, code letter in accordance with IEC 60062 (M for \pm 20 %)
- Rated voltage (in V)
- Date code
- Name of manufacturer
- '-' sign to identify the negative terminal, visible from the top and side of the capacitor
- Code number (last 8 digits)
- Maximum operating temperature

SELECTION CHART FOR C_R, U_R AND RELEVANT NOMINAL CASE SIZES (∅ D x L in mm)					
C _R (μF)	U _R (V)				
	200	250	400	420	450
330	-	22 x 35	25 x 40 30 x 30 35 x 25	25 x 50 30 x 35	25 x 50 35 x 30
390	22 x 30 25 x 25	22 x 35 25 x 30	25 x 50 30 x 35 35 x 30	35 x 30	30 x 40 35 x 35
470	22 x 35	25 x 35	30 x 40 35 x 30	35 x 35	35 x 40
560	25 x 30	25 x 40	30 x 45 35 x 35	30 x 50 35 x 40	35 x 45
680	25 x 35	30 x 30	35 x 40	35 x 45	35 x 50
820	25 x 40	30 x 35	35 x 50	-	-
1000	30 x 35	30 x 40	-	-	-
1200	30 x 40	35 x 40	-	-	-
1500	30 x 45	35 x 45	-	-	-
1800	30 x 50 35 x 40	35 x 50	-	-	-
2200	35 x 45	-	-	-	-

DIMENSIONS in millimeters **AND AVAILABLE FORMS**

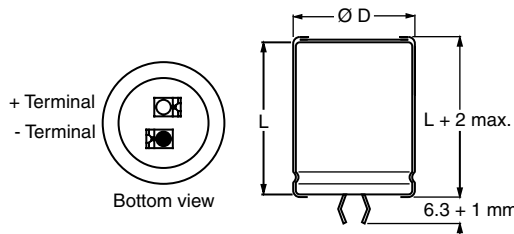

The minus and/or plus terminal can be marked with an imprinted sign

Fig.2 Two terminal snap-in

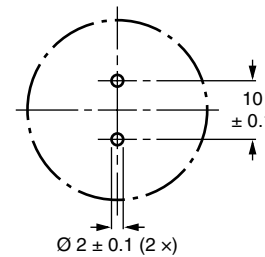

Fig.3 Mounting hole diagram

Table 1

DIMENSIONS in millimeters, MASS AND PACKAGING QUANTITIES					
NOMINAL CASE SIZE ∅ D x L	∅ D _{max.}	L _{max.}	MASS (g)	PACKAGING QUANTITIES	CARDBOARD BOX DIMENSIONS L x W x H
22 x 25	22.5	25.5	≈ 12	216	280 x 240 x 140
22 x 30	22.5	30.5	≈ 16	216	280 x 240 x 140
22 x 35	22.5	35.5	≈ 20	144	280 x 240 x 105
22 x 40	22.5	40.5	≈ 23	144	280 x 240 x 105
22 x 45	22.5	45.5	≈ 26	144	280 x 240 x 140
22 x 50	22.5	50.5	≈ 29	72	280 x 240 x 105
25 x 25	25.5	25.5	≈ 20	216	280 x 240 x 140
25 x 30	25.5	32.0	≈ 22	216	280 x 240 x 140
25 x 35	25.5	35.5	≈ 24	144	280 x 240 x 105
25 x 40	25.5	40.5	≈ 27	144	280 x 240 x 105
25 x 45	25.5	45.5	≈ 32	144	280 x 240 x 140
25 x 50	25.5	50.5	≈ 38	144	280 x 240 x 140
30 x 25	30.5	27.5	≈ 25	168	280 x 240 x 140
30 x 30	30.5	32.5	≈ 30	168	280 x 240 x 140
30 x 35	30.5	37.5	≈ 35	112	280 x 240 x 105
30 x 40	30.5	41.5	≈ 40	112	280 x 240 x 105
30 x 45	30.5	46.5	≈ 45	112	280 x 240 x 140
30 x 50	30.5	51.5	≈ 50	112	280 x 240 x 140
35 x 25	35.5	25.5	≈ 33	126	280 x 240 x 140
35 x 30	35.5	32.5	≈ 40	126	280 x 240 x 140
35 x 35	35.5	35.5	≈ 48	84	280 x 240 x 105
35 x 40	35.5	41.5	≈ 55	84	280 x 240 x 105
35 x 45	35.5	46.5	≈ 63	84	280 x 240 x 140
35 x 50	35.5	51.5	≈ 72	84	280 x 240 x 140



Aluminum Capacitors
Power Miniaturized General Purpose Snap-In

Vishay BCcomponents

ELECTRICAL DATA	
SYMBOL	DESCRIPTION
C _R	rated capacitance at 120 Hz
I _R	rated RMS ripple current at 120 Hz, 85 °C
I _{L5}	max. leakage current after 5 minutes at U _R
ESR	max. equivalent series resistance at 120 Hz ⁽¹⁾

Notes

- ESR at 100 Hz is approximately 1.05 x ESR 120 Hz
- Unless otherwise specified, all electrical values in table 2 apply at
T_{amb} = 20 °C, P = 86 to 106 kPa, RH = 45 to 75 °C

Table 2

ELECTRICAL DATA AND ORDERING INFORMATION								
U _R (V)	C _R 120 Hz (µF)	NOMINAL CASE SIZE Ø D x L (mm)	I _R 120 Hz (A)	I _{L5} (mA)	MAX. ESR ⁽¹⁾ 120 Hz (Ω)	MAX. Z 10 kHz (Ω)	ORDERING CODE MAL2093.....	
200	270	22 x 25	1.26	1.08	0.47	0.31	52271E3	
	390	22 x 30	1.55	1.50	0.33	0.22	52391E3	
	390	25 x 25	1.46	1.50	0.36	0.25	42391E3	
	470	22 x 35	1.78	1.50	0.27	0.18	52471E3	
	560	25 x 30	1.83	1.50	0.25	0.17	42561E3	
	680	25 x 35	2.06	1.50	0.21	0.15	42681E3	
	820	25 x 40	2.36	1.50	0.18	0.12	42821E3	
	1000	30 x 35	2.35	1.50	0.18	0.13	32102E3	
	1200	30 x 40	2.69	1.50	0.15	0.11	32122E3	
	1500	30 x 45	3.00	1.50	0.12	0.09	32152E3	
	1800	30 x 50	3.36	1.50	0.11	0.08	32182E3	
250	1800	35 x 40	2.91	1.50	0.14	0.10	22182E3	
	2200	35 x 45	3.23	1.50	0.12	0.09	22222E3	
	250	220	22 x 25	1.18	1.10	0.50	0.32	53221E3
		270	22 x 30	1.37	1.35	0.40	0.25	53271E3
		330	22 x 35	1.58	1.50	0.32	0.20	53331E3
		390	22 x 35	1.67	1.50	0.29	0.18	53391E3
		390	25 x 30	1.64	1.50	0.29	0.19	43391E3
		470	25 x 35	1.85	1.50	0.25	0.16	43471E3
		560	25 x 40	2.11	1.50	0.21	0.14	43561E3
		680	30 x 30	2.01	1.50	0.22	0.15	33681E3
		820	30 x 35	2.23	1.50	0.19	0.13	33821E3
1000		30 x 40	2.56	1.50	0.15	0.11	33102E3	
1200		35 x 40	3.82	1.50	0.15	0.11	23122E3	
400	1500	35 x 45	3.08	1.50	0.13	0.09	23152E3	
	1800	35 x 50	3.35	1.50	0.11	0.08	23182E3	
	400	68	22 x 25	0.80	0.54	2.06	1.49	56689E3
		100	22 x 25	0.98	0.80	1.48	1.09	56101E3
		150	22 x 30	1.11	1.20	1.00	0.74	56151E3
		150	25 x 25	1.10	1.20	1.03	0.77	46151E3
		180	22 x 35	1.26	1.44	0.83	0.61	56181E3
		180	25 x 30	1.27	1.44	0.81	0.59	46181E3
		220	22 x 40	1.46	1.50	0.68	0.50	56221E3
		220	25 x 30	1.38	1.50	0.70	0.52	46221E3
		220	30 x 25	1.43	1.50	0.71	0.53	36221E3
270		22 x 50	1.58	1.50	0.53	0.39	56271E3	
270		30 x 25	1.53	1.50	0.63	0.48	36271E3	
400	330	25 x 40	1.82	1.50	0.49	0.37	46331E3	
	330	30 x 30	1.77	1.50	0.50	0.39	36331E3	
	330	35 x 25	1.77	1.50	0.58	0.46	26331E3	
	390	25 x 50	2.21	1.50	0.40	0.30	46391E3	
	390	30 x 35	1.98	1.50	0.43	0.33	36391E3	
	390	35 x 30	2.10	1.50	0.44	0.34	26391E3	
	470	30 x 40	2.20	1.50	0.37	0.28	36471E3	
	470	35 x 30	2.14	1.50	0.40	0.32	26471E3	
	560	30 x 45	2.48	1.50	0.30	0.23	36561E3	
	560	35 x 35	2.35	1.50	0.34	0.27	26561E3	
	680	35 x 40	2.68	1.50	0.28	0.22	26681E3	
820	35 x 50	3.18	1.50	0.22	0.17	26821E3		

ORDERING EXAMPLE

Electrolytic capacitor 093 series
330 µF/400 V; ± 20 %
Nominal case size: Ø 25 x 40 mm
2-terminal snap-in:
Ordering code: MAL209346331 E3
Former 12NC: 222209346331



ELECTRICAL DATA AND ORDERING INFORMATION							
U _R (V)	C _R 120 Hz (μF)	NOMINAL CASE SIZE Ø D x L (mm)	I _R 120 Hz (A)	I _{L5} (mA)	MAX. ESR ⁽¹⁾ 120 Hz (Ω)	MAX. Z 10 kHz (Ω)	ORDERING CODE MAL2093.....
420	100	22 x 25	0.89	0.84	1.44	1.05	54101E3
	180	22 x 35	1.29	1.50	0.81	0.59	54181E3
	180	25 x 30	1.29	1.50	0.78	0.57	44181E3
	220	25 x 35	1.47	1.50	0.67	0.50	44221E3
	220	30 x 25	1.44	1.50	0.69	0.52	34221E3
	270	22 x 50	1.61	1.50	0.54	0.39	54271E3
	270	30 x 30	1.67	1.50	0.56	0.41	34271E3
	330	25 x 50	1.47	1.50	0.43	0.31	44331E3
	330	30 x 35	1.88	1.50	0.46	0.35	34331E3
	390	35 x 30	2.05	1.50	0.47	0.37	24391E3
	470	35 x 35	2.27	1.50	0.37	0.28	24471E3
	560	30 x 50	2.66	1.50	0.31	0.25	34561E3
	560	35 x 40	2.57	1.50	0.34	0.27	24561E3
	680	35 x 45	2.87	1.50	0.28	0.23	24681E3
450	82	22 x 25	0.80	0.74	1.77	1.31	57829E3
	100	22 x 30	0.95	0.90	1.45	1.07	57101E3
	120	22 x 30	1.00	1.08	1.26	0.95	57121E3
	120	25 x 25	1.00	1.08	1.29	0.97	47121E3
	150	22 x 35	1.17	1.35	1.01	0.76	57151E3
	180	22 x 40	1.34	1.50	0.85	0.63	57181E3
	180	25 x 30	1.27	1.50	0.86	0.65	47181E3
	180	30 x 25	1.32	1.50	0.86	0.65	37181E3
	220	22 x 50	1.45	1.50	0.66	0.49	57221E3
	220	25 x 35	1.45	1.50	0.73	0.56	47221E3
	220	30 x 25	1.42	1.50	0.76	0.59	37221E3
	270	30 x 30	1.64	1.50	0.61	0.47	37271E3
	270	35 x 25	1.66	1.50	0.68	0.54	27271E3
	330	25 x 50	2.07	1.50	0.46	0.35	47331E3
	330	35 x 30	1.98	1.50	0.50	0.39	27331E3
	390	30 x 40	2.11	1.50	0.42	0.32	37391E3
	390	35 x 35	2.18	1.50	0.43	0.33	27391E3
	470	35 x 40	2.47	1.50	0.35	0.27	27471E3
	560	35 x 45	2.74	1.50	0.30	0.23	27561E3
	680	35 x 50	3.07	1.50	0.25	0.20	27681E3

Note⁽¹⁾ ESR at 100 Hz is approximately 1.05 x ESR 120 Hz

ADDITIONAL ELECTRICAL DATA		
PARAMETER	CONDITIONS	VALUE
Voltage		
Surge voltage	≥ 200 V versions	U _S = 1.1 x U _R
Reverse voltage	≤ 1 V	-
Current		
Leakage current	After 5 minutes at U _R	I _{L5} ≤ 0.02 C _R x U _R or 1.5 mA, whichever is smaller
Inductance		
Equivalent series inductance (ESL)	All case sizes	19 nH typical/25 nH max.

Table 3

LOW TEMPERATURE CHARACTERISTIC (at 120 Hz)		
DESCRIPTION		U _R (V) ⁽¹⁾
		200 to 450
Impedance ratio	Z (- 25 °C)/Z (+ 20 °C)	4

Note⁽¹⁾ Impedance ratio shall not exceed the given values



RIPPLE CURRENT AND USEFUL LIFE

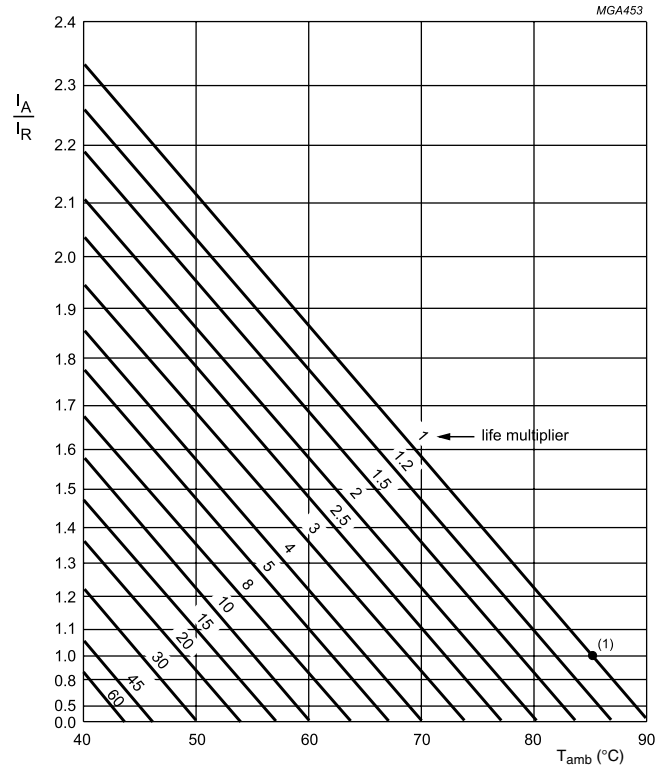

I_A = actual ripple current at 120 Hz
 I_R = rated ripple current at 120 Hz and 85 °C
 (1) Useful life at 85 °C and I_R applied: 2000 hours

Fig.4 Multiplier of useful life as a function of ambient temperature and ripple current load

Table 4

MULTIPLIER OF RIPPLE CURRENT (I_R) AS A FUNCTION OF FREQUENCY	
FREQUENCY (Hz)	I_R MULTIPLIER
	400 and 450 V
60	0.90
100	0.95
120	1.00
500	1.20
1000	1.30
≥ 10 000	1.40

Table 5

TEST PROCEDURES AND REQUIREMENTS			
TEST		PROCEDURE (quick reference)	REQUIREMENTS
NAME OF TEST	REFERENCE		
Useful life	CECC 30301 subclause 1.8.1	$T_{amb} = 85\text{ °C}$; U_R and I_R applied; 2000 hours	$\Delta C/C: \pm 30\%$ ESR $\leq 3 \times$ spec. limit $I_{L5} \leq$ spec. limit no short or open circuit, no visible damage total failure percentage: $\leq 3\%$
Shelf life (storage at high temperature)	IEC 60384-4/EN130300 subclause 4.17	$T_{amb} = 85\text{ °C}$; no voltage applied; 500 hours After test: U_R to be applied for 30 minutes, 24 hours to 48 hours before measurement	$\Delta C/C: \pm 20\%$ ESR $\leq 2 \times$ spec. limit $I_{L5} \leq 1 \times$ spec. limit



Disclaimer

All product specifications and data are subject to change without notice.

Vishay Intertechnology, Inc., its affiliates, agents, and employees, and all persons acting on its or their behalf (collectively, "Vishay"), disclaim any and all liability for any errors, inaccuracies or incompleteness contained herein or in any other disclosure relating to any product.

Vishay disclaims any and all liability arising out of the use or application of any product described herein or of any information provided herein to the maximum extent permitted by law. The product specifications do not expand or otherwise modify Vishay's terms and conditions of purchase, including but not limited to the warranty expressed therein, which apply to these products.

No license, express or implied, by estoppel or otherwise, to any intellectual property rights is granted by this document or by any conduct of Vishay.

The products shown herein are not designed for use in medical, life-saving, or life-sustaining applications unless otherwise expressly indicated. Customers using or selling Vishay products not expressly indicated for use in such applications do so entirely at their own risk and agree to fully indemnify Vishay for any damages arising or resulting from such use or sale. Please contact authorized Vishay personnel to obtain written terms and conditions regarding products designed for such applications.

Product names and markings noted herein may be trademarks of their respective owners.