

PLEASE CHECK WWW.MOLEX.COM FOR LATEST PART INFORMATION

Part Number: [0919990529](#)
Status: **Active**
Overview: [rast 5 connector system](#)
Description: 5.00mm (.197") Pitch Appli-Mate RAST 5 Header, Vertical, 3 Circuits, No Reference, Tin (Sn) Plating, Glow Wire Compatible

Documents:

[3D Model](#) [Product Specification PS-99020-0037 \(PDF\)](#)
[Drawing \(PDF\)](#) [RoHS Certificate of Compliance \(PDF\)](#)

Agency Certification

CSA LR19980
 UL E29179

General

Product Family PCB Headers
 Series [91999](#)
 Application Wire-to-Board
 Overview [rast 5 connector system](#)
 Product Name RAST 5

Physical

Breakaway No
 Circuits (Loaded) 3
 Circuits (maximum) 3
 Color - Resin Natural
 Durability (mating cycles max) 10
 First Mate / Last Break No
 Flammability 94V-0
 Glow-Wire Compliant Yes
 Guide to Mating Part No
 Keying to Mating Part Yes
 Lock to Mating Part No
 Material - Metal Brass
 Material - Plating Mating Tin
 Material - Resin Nylon
 Number of Rows 1
 Orientation Vertical
 PC Tail Length (in) 0.154 In
 PC Tail Length (mm) 3.90 mm
 PCB Locator Yes
 PCB Retention None
 PCB Thickness Recommended (in) 0.055 In
 PCB Thickness Recommended (mm) 1.40 mm
 Packaging Type Bag
 Pitch - Mating Interface (in) 0.197 In
 Pitch - Mating Interface (mm) 5.00 mm
 Plating min: Mating (µin) 200
 Plating min: Mating (µm) 5
 Polarized to PCB Yes
 Robotic Placement None
 Shrouded Fully
 Stackable No
 Surface Mount Compatible (SMC) No
 Temperature Range - Operating -20C TO +120C
 Termination Interface: Style Through Hole

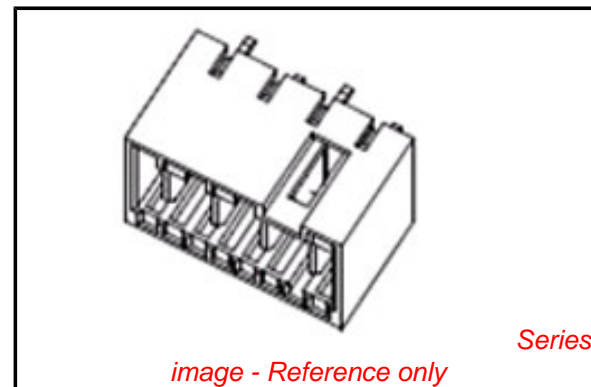

EU RoHS

ELV and RoHS Compliant
REACH SVHC
 Not Reviewed
Halogen-Free Status

China RoHS



Need more information on product environmental compliance?

Email productcompliance@molex.com
 For a multiple part number RoHS Certificate of Compliance, [click here](#)

Please visit the [Contact Us](#) section for any non-product compliance questions.

Search Parts in this Series
[91999Series](#)

Electrical

Current - Maximum per Contact
Voltage - Maximum

16A
250V AC

Material Info

Old Part Number

WITH ZYTEL RM

Reference - Drawing Numbers

Packaging Specification
Product Specification
Sales Drawing

PK-90858-001
PS-99020-0037
SD-91999-001

This document was generated on 05/26/2010

PLEASE CHECK WWW.MOLEX.COM FOR LATEST PART INFORMATION

13 12 11 10 9 8 7 6 5 4 3 2 1

PCB PIN POLARISATION
OPTION A AND B

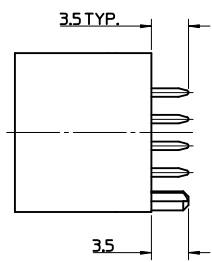
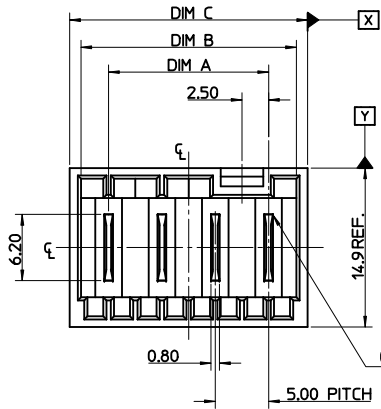

COLOUR STRIPE OPTION

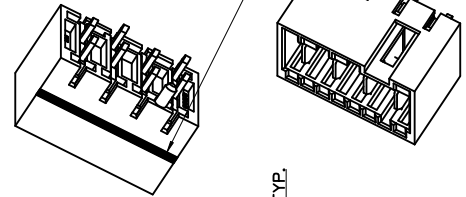

COLOUR STRIPE OPTION

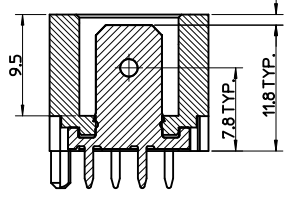
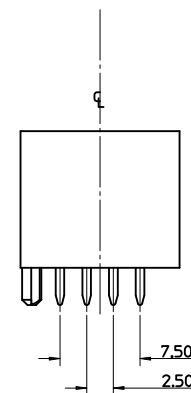
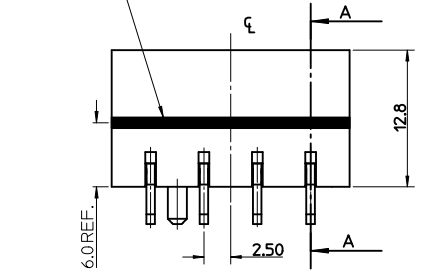

A-A
Scale 3:1

| CCT | DIM A | DIM B | DIM C | TOL |
|-----|-------|-------|-------|---------|
| 2 | 5.00 | 10.20 | 12.30 | |
| 3 | 10.00 | 15.20 | 17.30 | |
| 4 | 15.00 | 20.20 | 22.30 | |
| 5 | 20.00 | 25.20 | 27.30 | |
| 6 | 25.00 | 30.20 | 32.30 | +/-0.30 |
| 7 | 30.00 | 35.20 | 37.30 | |
| 8 | 35.00 | 40.20 | 42.30 | |
| 9 | 40.00 | 45.20 | 47.30 | |
| 10 | 45.00 | 50.20 | 52.30 | |
| 11 | 50.00 | 55.20 | 57.30 | |
| 12 | 55.00 | 60.20 | 62.30 | |

- NOTES:
- MATERIALS
HOUSING: PA 66, UL94 V-0 750°C GWT NO FLAME
TERMINAL: BRASS 0.80REF. THICK
PLATING: OPTIONAL (SEE CHARTS SHEETS 2-6)
5µm TIN OVER
2.5µm NICKEL ALLOVER
SELECTIVE SILVER
2µm MIN SILVER
3-5µm TIN OVER
2.5µm NICKEL ALLOVER
 - PRODUCT CONFORMS TO SPECIFICATION PS-99020-0037/39
 - MATES WITH MOLEX 91338, 90833, 90835, 91777, 91778, 91779, 91954 & 92000.
 - SEE PACKAGING SPECIFICATION PK-90858-001
TWO PACKAGING OPTIONS
"A" LOOSE IN POLYBAGS IN SHIPPING CARTON
"B" IN TUBES IN SHIPPING CARTON
SEE TABLES IN FOLLOWING SHEETS FOR PACKAGING TYPE FOR EACH PART NUMBER
 - PLATED THRU HOLE
 - NON-PLATED THRU HOLE
 - RECOMMENDED PCB THICKNESS: 1.4±0.1mm
 - PCB VIEW IS FROM SOLDER SIDE

HOLE ON SOME TOOLED VERSIONS

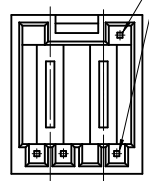

OPTION "C"

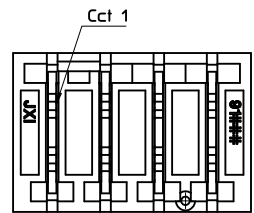

PCB LAYOUT

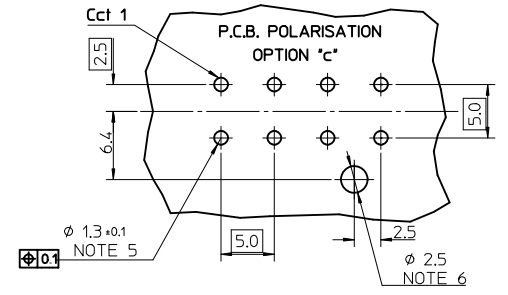

OPTION "B"

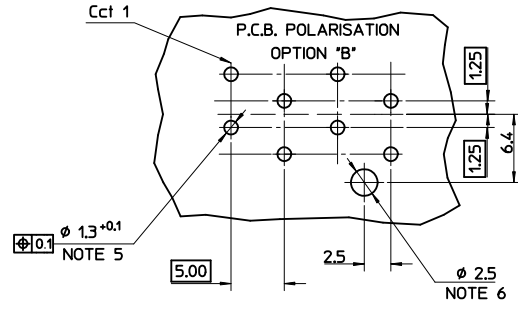
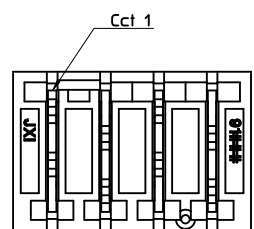

OPTION "A"

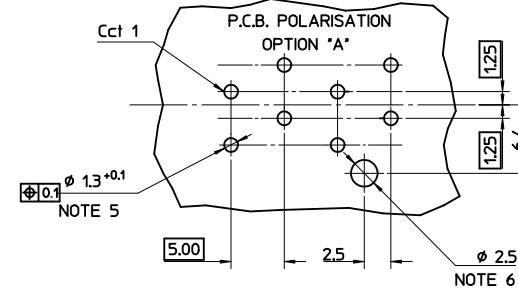
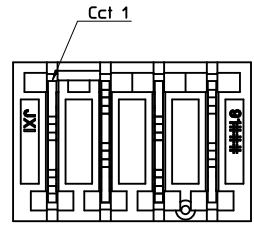

| | | |
|----------------------|--------------------|------------------|
| MOULD TOOLING CHANGE | EC NO: E2010-0370 | DATE: 2010/05/17 |
| | DRAWN: BRUTTLE | DATE: 2006/10/04 |
| | CHECKED: TOURSH | DATE: 2006/10/04 |
| | APPROVED: BMAGUIRE | DATE: 2010/06/08 |

| | |
|-----------------|-------------|
| QUALITY SYMBOLS | DESCRIPTION |
| ▽=0 | |
| ▽=0 | |

| | | |
|--|--------------|------------|
| GENERAL TOLERANCES (UNLESS SPECIFIED) | DRAWN BY | DATE |
| 4 PLACES ± --- | B. RUTTLE | 2006/10/04 |
| 3 PLACES ± --- | CHECKED BY | DATE |
| 2 PLACES ± 0.1 | T. TOURSH | 2006/10/04 |
| 1 PLACE ± 0.2 | APPROVED BY | DATE |
| ANGULAR ± 2° | BMAGUIRE | 2006/10/04 |
| DRAFT WHERE APPLICABLE MUST REMAIN WITHIN DIMENSIONS | MATERIAL NO. | |

| | | | |
|-----------------|-------------------------------|--------------|------------------------|
| DIMENSION STYLE | SCALE | DESIGN UNITS | THIRD ANGLE PROJECTION |
| MM ONLY | 1:1 | METRIC | THIRD ANGLE PROJECTION |
| TITLE | RAST 5 VERT HDR PA 66 HOUSING | | |

MOLEX INCORPORATED

DOCUMENT NO. SD-91999-001

SHEET NO. 1 OF 6

THIS DRAWING CONTAINS INFORMATION THAT IS PROPRIETARY TO MOLEX INCORPORATED AND SHOULD NOT BE USED WITHOUT WRITTEN PERMISSION

12 11 10 9 8 7 6 5 4 3 2 1

| 2 CIRCUIT | | SEE CODE DESIGNATION TABLE FOR NUMBERING FORMAT WHEN ADDING NEW PART NUMBERS | | | | | | P.C.B. POLARISATION OPTION | PACKAGING OPTION * | COLOUR STRIPE |
|-------------------|---------|---|--------------------------|-------------------|------------------------------|-----|----------------------|----------------------------------|-----------------------|------------------|
| PART NO. (TIN) | COLOUR | UNBLOCKED POSITION KEYS | UNBLOCKED CODING KEYS | LATCH POSITION | CONFIGURATION (SEE NOTES) | REF | PART NO. (SILVER) | | | |
| 91999-0003 | NATURAL | 1b 2a | 01c d20 | 1/2 | | K01 | 91999-0499 | A | A | NONE |
| 91999-0004 | NATURAL | 1a 2b | 01c | 1/2 | | K02 | 91999-0482 | A | | |
| 91999-0007 | NATURAL | 1b 2b | 01c | 1/2 | | K09 | 91999-0497 | A | | |
| 91999-0018 | NATURAL | 2a | 01c, d20 | 1/2 | | K03 | 91999-0495 | A | | |
| 91999-0019 | NATURAL | 1a 2b | d20 | 1/2 | | K05 | 91999-0478 | A | | |
| 91999-0021 | NATURAL | 1b | 01c, d20 | 1/2 | | K16 | 91999-0492 | A | | |
| 91999-0022 | NATURAL | 1a 2b | NONE | 1/2 | | K06 | 91999-0491 | A | | |
| 91999-0027 | NATURAL | 2b | NONE | 1/2 | | K11 | 91999-0487 | A | | |
| 91999-0029 | NATURAL | 1a 1b | d20 | 1/2 | | K13 | 91999-0486 | A | | |
| 91999-0030 | NATURAL | 2a 2b | NONE | 1/2 | | K31 | 91999-0485 | A | | |
| 91999-0032 | NATURAL | 2b | d20 | 1/2 | | K38 | 91999-0484 | A | | |
| 91999-0047 | NATURAL | 1a 2a | 01c d20 | 1/2 | | K44 | 91999-0483 | A | | |
| 91999-0055 | NATURAL | 1a 1b | NONE | 1/2 | | K40 | 91999-0480 | A | | |
| 91999-0020 | NATURAL | 1a 1b | 01c | 1/2 | | K04 | 91999-0475 | A | | |
| 91999-0054 | NATURAL | 2b | 01c d20 | 1/2 | | K15 | 91999-0476 | A | | |
| 91999-0057 | NATURAL | 1a | 01c d20 | 1/2 | | K12 | 91999-0477 | A | | |
| 91999-0058 | NATURAL | 1a 2a | 01c | 1/2 | | K10 | 91999-0472 | A | | |
| 91999-0059 | NATURAL | ALL | d20 | 1/2 | | K34 | 91999-0474 | A | | |
| 91999-0060 | NATURAL | 1b 2a 2b | d20 | 1/2 | | K07 | 91999-0473 | A | | |
| 91999-0061 | NATURAL | 1b 2a | 01c d20 | 1/2 | | K01 | 91999-0471 | B | | |
| 91999-0062 | NATURAL | 2a | 01c | 1/2 | | K42 | 91999-0470 | A | | |
| 91999-0063 | NATURAL | 1b, 2a | d20 | 1/2 | | K46 | 91999-0469 | A | | |
| 91999-0064 | NATURAL | 1a, 2b | 01c, d20 | 1/2 | | K48 | 91999-0468 | A | A | NONE |

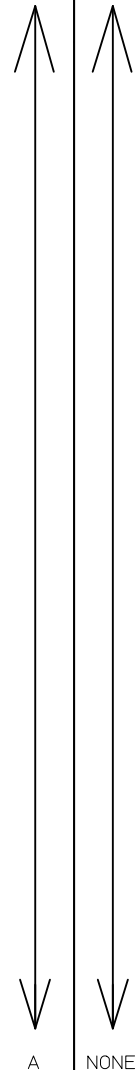

| 2 CIRCUIT | | SEE CODE DESIGNATION TABLE FOR NUMBERING FORMAT WHEN ADDING NEW PART NUMBERS | | | | | | P.C.B. POLARISATION OPTION | PACKAGING OPTION * | COLOUR STRIPE |
|-------------------|---------|---|--------------------------|-------------------|------------------------------|-----|----------------------|----------------------------------|-----------------------|------------------|
| PART NO. (TIN) | COLOUR | UNBLOCKED POSITION KEYS | UNBLOCKED CODING KEYS | LATCH POSITION | CONFIGURATION (SEE NOTES) | REF | PART NO. (SILVER) | | | |
| 91999-0065 | NATURAL | 1b 2a | 01c d20 | 1/2 | | K01 | 91999-0467 | A | B | NONE |
| 91999-0066 | NATURAL | 1a 2b | 01c | 1/2 | | K02 | 91999-0466 | A | B | NONE |
| 91999-0067 | NATURAL | ALL | ALL | 1/2 | | K00 | 91999-0465 | A | A | NONE |
| 91999-0068 | NATURAL | 1a 2b | 01c | 1/2 | | K02 | 91999-0464 | A | B | RED |
| 91999-0069 | NATURAL | 1a | 01c | 1/2 | | K57 | 91999-0463 | A | A | NONE |
| 91999-0070 | NATURAL | 2a 2b | 01c | 1/2 | | K32 | 91999-0462 | A | B | NONE |
| 91999-0071 | NATURAL | 1b 2b | 01c | 1/2 | | K09 | 91999-0461 | C | A | NONE |

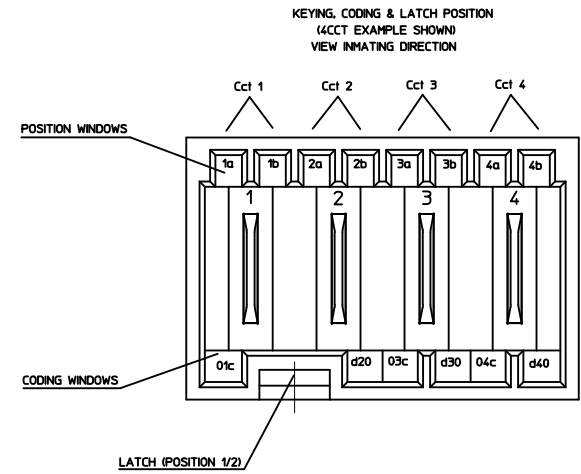

NOTES:
* SEE SHEET 1 NOTE 4

| | | | | | | |
|--|--------------------------|---|-----------------|---|--------------|------------------------|
| SEE SHEET 1 ELEC NO: E2010-0370 2010/05/17 DRN:BRITTLE 2006/10/04 CHKD: TOURSH APPR:BMAGUIRE 2010/06/08 | QUALITY SYMBOLS | GENERAL TOLERANCES (UNLESS SPECIFIED) | DIMENSION STYLE | SCALE | DESIGN UNITS | THIRD ANGLE PROJECTION |
| | $\nabla=0$ $\nabla=0$ | mm INCH 4 PLACES ± --- ± --- 3 PLACES ± --- ± --- 2 PLACES ± 0.1 ± --- 1 PLACE ± 0.2 ± --- ANGULAR ± 2° | MM ONLY | 1:1 | METRIC | |
| | | DRAFT WHERE APPLICABLE MUST REMAIN WITHIN DIMENSIONS | SEE CHART | RAST 5 VERT HDR PA 66 HOUSING | | |
| | | | | MOLEX INCORPORATED DOCUMENT NO. SD-91999-001 SHEET NO. 2 OF 6 | | |

THIS DRAWING CONTAINS INFORMATION THAT IS PROPRIETARY TO MOLEX INCORPORATED AND SHOULD NOT BE USED WITHOUT WRITTEN PERMISSION

| 3 CIRCUIT | | SEE CODE DESIGNATION TABLE FOR NUMBERING FORMAT WHEN ADDING NEW PART NUMBERS | | | | | P.C.B. POLARISATION OPTION | PACKAGING OPTION * | COLOUR STRIPE |
|-------------------|---------|---|--------------------------|-------------------|------------------------------|------|----------------------------------|-----------------------|------------------|
| PART NO. (TIN) | COLOUR | UNBLOCKED POSITION KEYS | UNBLOCKED CODING KEYS | LATCH POSITION | CONFIGURATION (SEE NOTES) | REF | PART NO. (SILVER) | | |
| 91999-0502 | NATURAL | 1b | 01c, d20 | 1/2 | | K01 | 91999-1249 | A | NONE |
| 91999-0508 | NATURAL | 1a | 03c | 1/2 | | K04 | 91999-1248 | A | |
| 91999-0511 | NATURAL | 1a 1b | d30 | 1/2 | | K05 | 91999-1247 | A | |
| 91999-0512 | NATURAL | 1a 3b | 01c | 1/2 | | K06 | 91999-1246 | A | |
| 91999-0513 | NATURAL | 1b | d20 03c | 1/2 | | K09 | 91999-1245 | A | |
| 91999-0524 | NATURAL | 1b 2a 2b | d30 | 1/2 | | K33 | 91999-1244 | A | |
| 91999-0525 | NATURAL | 2b | d20 | 1/2 | | K56 | 91999-1243 | A | |
| 91999-0528 | NATURAL | ALL | d10 d30 | 2/3 | | K38 | 91999-1242 | A | |
| 91999-0527 | NATURAL | ALL | d20 | 1/2 | | K40 | 91999-1240 | A | |
| 91999-0526 | NATURAL | 2b 3b | d10 02c | 2/3 | | K02 | 91999-1241 | A | |
| 91999-0529 | NATURAL | 1b | 01c d20 | 1/2 | | N/A | 91999-1239 | A | |
| 91999-0530 | NATURAL | 2b 3b | ALL | 2/3 | | k145 | 91999-1238 | A | |
| 91999-0531 | NATURAL | 3b | 01c d30 | 2/3 | | k10 | 91999-1237 | A | |
| 91999-0532 | NATURAL | 3b | d10, 02c | 2/3 | | N/A | 91999-1236 | A | |
| 91999-0533 | NATURAL | 2b 3b | ALL | 2/3 | | k145 | 91999-1235 | A | |
| 91999-0534 | NATURAL | ALL | ALL | 1/2 | | k00 | 91999-1234 | A | |
| 91999-0506 | NATURAL | 1a 3a | d20 | 1/2 | | k43 | 91999-1233 | A | |
| 91999-0507 | NATURAL | 2a | d10 d30 | 2/3 | | k44 | 91999-1232 | A | NONE |
| 91999-0535 | NATURAL | 3b | d10 d30 | 2/3 | | N/A | 91999-1231 | A | NONE |
| 91999-0536 | NATURAL | 1b | 01c | 1/2 | | N/A | 91999-1230 | A | NONE |

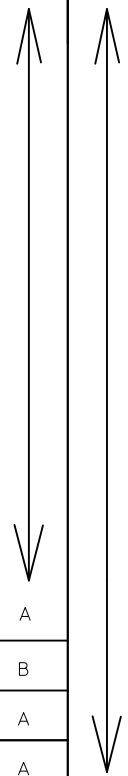

NOTES:
* SEE SHEET 1 NOTE 4

| | | | | | | |
|---|--|--|---|--|--------------|----------------------------------|
| SEE SHEET 1 EEC NO: E2010-0370 DRAWN BY: B. RUTLE CHECKED BY: T. TOURSH APPROVED BY: BMAGUIRE 2010/05/17 2006/10/04 2010/06/08 | QUALITY SYMBOLS | GENERAL TOLERANCES (UNLESS SPECIFIED) | DIMENSION STYLE | SCALE | DESIGN UNITS | THIRD ANGLE PROJECTION |
| | $\nabla=0$ $\nabla=0$ | mm INCH 4 PLACES ± --- ± --- 3 PLACES ± --- ± --- 2 PLACES ± 0.1 ± --- 1 PLACE ± 0.2 ± --- ANGULAR ± 2 ° | MM ONLY DRAWN BY: B. RUTLE DATE: 2006/10/04 CHECKED BY: T. TOURSH DATE: 2006/10/04 APPROVED BY: BMAGUIRE DATE: 2006/10/04 | 1:1 | METRIC | RAST 5 VERT HDR PA 66 HOUSING |
| | DRAFT WHERE APPLICABLE MUST REMAIN WITHIN DIMENSIONS | SEE CHART MATERIAL NO. SD-91999-001 | MOLEX INCORPORATED DOCUMENT NO. SD-91999-001 SHEET NO. 3 OF 6 | THIS DRAWING CONTAINS INFORMATION THAT IS PROPRIETARY TO MOLEX INCORPORATED AND SHOULD NOT BE USED WITHOUT WRITTEN PERMISSION | | |
| | SIZE: A 1 | | | | | |

| 4 CIRCUIT | | SEE CODE DESIGNATION TABLE FOR NUMBERING FORMAT WHEN ADDING NEW PART NUMBERS | | | | | P.C.B. POLARISATION OPTION | PACKAGING OPTION * | COLOUR STRIPE |
|-------------------|---------|---|--------------------------|-------------------|------------------------------|------|----------------------------------|-----------------------|------------------|
| PART NO. (TIN) | COLOUR | UNBLOCKED POSITION KEYS | UNBLOCKED CODING KEYS | LATCH POSITION | CONFIGURATION (SEE NOTES) | REF | PART NO. (SILVER) | | |
| 91999-1254 | NATURAL | 1b | 03c d40 | 1/2 3/4 | | K01 | 91999-1999 | A | |
| 91999-1264 | NATURAL | 1a 4b | d40 | 1/2 3/4 | | K03 | 91999-1998 | A | |
| 91999-1265 | NATURAL | 2a 4b | d20 | 1/2 3/4 | | K07 | 91999-1996 | A | |
| 91999-1267 | NATURAL | 1b 2a 3a 4b | 01c d40 | 1/2 3/4 | | K37 | 91999-1994 | A | |
| 91999-1270 | NATURAL | 1a 2b 4b | 01c 03c d40 | 1/2 3/4 | | K44 | 91999-1993 | A | |
| 91999-1274 | NATURAL | 1a 3a 3b | 01c d20 d40 | 1/2 3/4 | | K32 | 91999-1992 | A | |
| 91999-1275 | NATURAL | 1b 2a 4b | 01c d20 03c | 1/2 3/4 | | K61 | 91999-1991 | A | |
| 91999-1278 | NATURAL | 1a 3a | d40 | 1/2 3/4 | | K06 | 91999-1987 | A | |
| 91999-1280 | NATURAL | 1a 2b 3b 4a | 01c 03c d40 | 1/2 3/4 | | K65 | 91999-1988 | A | |
| 91999-1281 | NATURAL | 2a 4b | d20 03c | 1/2 3/4 | | K30 | 91999-1986 | A | |
| 91999-1282 | NATURAL | 3b | d30 | 2/3 | | K04 | 91999-1985 | A | |
| 91999-1283 | NATURAL | 1b 2a 4b | ALL | 1/2 3/4 | | N/A | 91999-1984 | A | |
| 91999-1284 | NATURAL | 2a 3a 3b 4b | ALL | 1/2 3/4 | | N/A | 91999-1983 | A | |
| 91999-1285 | NATURAL | 2a 2b 3b 4b | ALL | 1/2 3/4 | | k153 | 91999-1982 | A | |
| 91999-1286 | NATURAL | 2a 2b 3b 4b | ALL | 1/2 3/4 | | k153 | 91999-1981 | A | |
| 91999-1287 | NATURAL | 1a, 4b | 01c | 1/2 3/4 | | k02 | 91999-1980 | A | |
| 91999-1288 | NATURAL | 1b, 2b, 3b, 4a | 01c 03c d40 | 1/2 3/4 | | k-- | 91999-1979 | A | |
| 91999-1289 | NATURAL | 1b | 03c d40 | 1/2 3/4 | | k01 | 91999-1978 | C | |
| 91999-1290 | NATURAL | 1b 2a 2b 3a 4a 4b | 03c d40 | 1/2 3/4 | | k12 | 91999-1977 | A | |
| 91999-1291 | NATURAL | ALL | ALL | 1/2 3/4 | | k00 | 91999-1976 | A | |
| 91999-1292 | NATURAL | 1b 2a 3a 4a | 01c d20 03c | 1/2 3/4 | | k83 | 91999-1975 | A | |
| 91999-1293 | NATURAL | 1b 2b 3b 4a | 01c 03c d40 | 1/2 3/4 | | k120 | 91999-1974 | A | |
| 91999-1294 | NATURAL | 1a 2a 2b 3a 3b 4a 4b | NONE | 1/2 3/4 | | k102 | 91999-1973 | A | |
| 91999-1295 | NATURAL | 1b 3b 4b | 01c d20 03c | 1/2 3/4 | | k85 | 91999-1972 | A | |

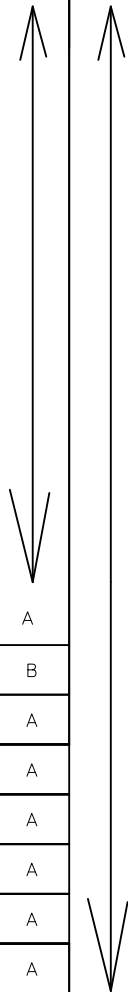

| | | | | | | | | | | | | | | | | |
|---|-------------------------------|---------------------------------------|----------------------|---|---------------------|--------------------|---|------------------------|--------------------|-------------------------|--------------------|-------------------------|--------------------|--------------|--------------|-----------|
| SEE SHEET 1 EC NO: E2010-0370 DRAWN: BRUTLE 2010/05/17 CHKD: TOURSH 2006/10/04 APPR: BMAGUIRE 2010/06/08 | QUALITY SYMBOLS ▽=0 ▽=0 | GENERAL TOLERANCES (UNLESS SPECIFIED) | | DIMENSION STYLE MM ONLY | | SCALE 1:1 | DESIGN UNITS METRIC | THIRD ANGLE PROJECTION | | | | | | | | |
| | | 4 PLACES ± --- ± --- | 3 PLACES ± --- ± --- | 2 PLACES ± 0.1 ± --- | 1 PLACE ± 0.2 ± --- | ANGULAR ± 2 ° | DRAFT WHERE APPLICABLE MUST REMAIN WITHIN DIMENSIONS | DRAWN BY B. RUTLE | DATE 2006/10/04 | CHECKED BY T. TOURSH | DATE 2006/10/04 | APPROVED BY BMAGUIRE | DATE 2006/10/04 | MATERIAL NO. | DOCUMENT NO. | SHEET NO. |
| | | SEE CHART | | THIS DRAWING CONTAINS INFORMATION THAT IS PROPRIETARY TO MOLEX INCORPORATED AND SHOULD NOT BE USED WITHOUT WRITTEN PERMISSION | | MOLEX INCORPORATED | | SD-91999-001 | | 4 OF 6 | | | | | | |
| | | SEE CHART | | THIS DRAWING CONTAINS INFORMATION THAT IS PROPRIETARY TO MOLEX INCORPORATED AND SHOULD NOT BE USED WITHOUT WRITTEN PERMISSION | | MOLEX INCORPORATED | | SD-91999-001 | | 4 OF 6 | | | | | | |

5 CIRCUIT

SEE CODE DESIGNATION TABLE FOR NUMBERING
FORMAT WHEN ADDING NEW PART NUMBERS

| PART NO. (TIN) | COLOUR | UNBLOCKED POSITION KEYS | UNBLOCKED CODING KEYS | LATCH POSITION | CONFIGURATION (SEE NOTES) | REF | PART NO. (SILVER) | P.C.B. POLARISATION OPTION | PACKAGING OPTION * | COLOUR STRIPE |
|-------------------|---------|----------------------------|--------------------------|-------------------|------------------------------|-----|----------------------|----------------------------------|-----------------------|------------------|
| 91999-2000 | NATURAL | 1a 5b | 01c d30 | 1/2 2/3 | | K01 | 91999-2749 | A | A | NONE |
| 91999-2001 | NATURAL | 1a 3a | 01c d30 | 1/2 4/5 | | K30 | 91999-2748 | A | A | NONE |
| 91999-2002 | NATURAL | 1a 5b | 01c d20 03c d50 | 1/2 3/4 | | K31 | 91999-2747 | A | A | NONE |
| 91999-2003 | NATURAL | 1b 2a 3b 5a | 01c 03c | 1/2 3/4 | | K35 | 91999-2746 | A | A | NONE |
| 91999-2004 | NATURAL | 1a 2a 2b 4b 5b | 01c d30 04c d50 | 1/2 2/3 4/5 | | K36 | 91999-2745 | A | A | NONE |
| 91999-2006 | NATURAL | 2a | 01c d50 | 2/3 4/5 | | K43 | 91999-2742 | A | A | NONE |
| 91999-2012 | NATURAL | 2a 4b | 01c d20 d40 | 1/2 3/4 | | K44 | 91999-2743 | A | A | NONE |
| 91999-2013 | NATURAL | 2b | d20 | 1/2 4/5 | | K02 | 91999-2741 | A | A | NONE |
| 91999-2014 | NATURAL | 4b 5a | 01c d30 04c d50 | 1/2 4/5 | | K45 | 91999-2740 | A | A | NONE |
| 91999-2015 | NATURAL | NONE | 01c d40 | 1/2 3/4 | | K46 | 91999-2739 | A | A | NONE |
| 91999-2017 | NATURAL | 1a 4a | d30 | 1/2 4/5 | | K04 | 91999-2737 | A | A | NONE |
| 91999-2024 | NATURAL | 1a 5b | d20 d40 | 1/2 3/4 | | K77 | 91999-2732 | A | A | NONE |
| 91999-2025 | NATURAL | 2b | d20 d50 | 1/2 3/4 | | K95 | 91999-2733 | A | A | NONE |
| 91999-2026 | NATURAL | 1a 5b | 01c d20 03c d50 | 1/2 3/4 | | N/A | 91999-2734 | A | A | NONE |
| 91999-2027 | NATURAL | 1a 3a 4b 5a | 03c 04c | 1/2 4/5 | | K73 | 91999-2735 | A | A | NONE |
| 91999-2028 | NATURAL | 2b | d20 | 1/2 4/5 | | N/A | 91999-2731 | A | A | NONE |
| 91999-2029 | NATURAL | 1b 2a 4a | 01c 04c d50 | 1/2 4/5 | | K51 | 91999-2730 | A | A | NONE |
| 91999-2030 | NATURAL | 2b 3b 4a | 01c d20 d40 | 1/2 3/4 | | K52 | 91999-2729 | A | A | NONE |
| 91999-2031 | NATURAL | 1a 5b | 01c d20 03c d50 | 1/2 4/5 | | K86 | 91999-2728 | A | A | NONE |
| 91999-2032 | NATURAL | 1a 1b 4a | d30 04c d50 | 1/2 4/5 | | K64 | 91999-2727 | A | A | NONE |
| 91999-2033 | NATURAL | 1a 5b | 01c d20 03c d50 | 1/2 3/4 | | N/A | 91999-2726 | B | A | NONE |
| 91999-2034 | NATURAL | 1a 3a | 01c d30 | 1/2 4/5 | | K30 | 91999-2725 | C | A | NONE |
| 91999-2035 | NATURAL | ALL | ALL | 1/2 4/5 | | K90 | 91999-2724 | A | A | NONE |

NOTES:
* SEE SHEET 1 NOTE 4

6 CIRCUIT

SEE CODE DESIGNATION TABLE FOR NUMBERING
FORMAT WHEN ADDING NEW PART NUMBERS

| PART NO. (TIN) | COLOUR | UNBLOCKED POSITION KEYS | UNBLOCKED CODING KEYS | LATCH POSITION | CONFIGURATION (SEE NOTES) | REF | PART NO. (SILVER) | P.C.B. POLARISATION OPTION | PACKAGING OPTION * | COLOUR STRIPE |
|-------------------|---------|----------------------------|--------------------------|-------------------|------------------------------|-----|----------------------|----------------------------------|-----------------------|------------------|
| 91999-2753 | NATURAL | 1b | 03c d60 | 1/2 4/5 | | K01 | 91999-3499 | A | A | NONE |
| 91999-2754 | NATURAL | 1a 3b 4b | 01c d50 06c | 1/2 4/5 | | K30 | 91999-3498 | A | A | NONE |
| 91999-2755 | NATURAL | 1a 1b 2b 3a 3b 4b | d30 04c d50 | 1/2 2/3 4/5 | | K37 | 91999-3497 | A | A | NONE |
| 91999-2756 | NATURAL | 1a 1b 4a 4b | d10 d50 | 2/3 4/5 | | K39 | 91999-3496 | A | A | NONE |
| 91999-2757 | NATURAL | 2a 4b 5a 6b | d20 03c 05c | 1/2 3/4 5/6 | | K42 | 91999-3495 | A | A | NONE |
| 91999-2758 | NATURAL | 1a 2b 3a 3b 5b 6b | 01c d40 d60 | 1/2 3/4 5/6 | | K43 | 91999-3494 | A | A | NONE |
| 91999-2759 | NATURAL | 1b 2a 3a 4b 5a 5b 6b | 01c 03c d60 | 1/2 3/4 5/6 | | K44 | 91999-3493 | A | A | NONE |
| 91999-2761 | NATURAL | 2b | d20 d60 | 1/2 5/6 | | K46 | 91999-3492 | A | A | NONE |
| 91999-2762 | NATURAL | 2b 3b 4a | 01c d50 06c | 1/2 4/5 | | K36 | 91999-3491 | A | A | NONE |
| 91999-2768 | NATURAL | 1b 4b | d20 03c d50 06c | 1/2 4/5 | | K58 | 91999-3486 | A | A | NONE |
| 91999-2769 | NATURAL | 1a 2b 3b 4a 6b | 01c 03c d40 05c d60 | 1/2 3/4 5/6 | | K59 | 91999-3485 | A | A | NONE |
| 91999-2770 | NATURAL | 1a 2b 4a 6b | 01c d40 | 1/2 3/4 5/6 | | K62 | 91999-3484 | A | A | NONE |
| 91999-2771 | NATURAL | 1b 6b | d40 | 1/2 5/6 | | K04 | 91999-3483 | A | A | NONE |
| 91999-2772 | NATURAL | 1b 2a 3a 4b 5a 5b 6b | 01c d60 | 2/3 5/6 | | K15 | 91999-3482 | A | A | NONE |
| 91999-2773 | NATURAL | 1b | 03c d60 | 1/2 4/5 | | K01 | 91999-3481 | C | A | NONE |
| 91999-2774 | NATURAL | 1a 1b 2b 3b | d20 05c d60 | 1/2 3/4 5/6 | | N/A | 91999-3480 | C | A | NONE |
| 91999-2775 | NATURAL | 1b 2a 3a 4b 5a 5b 6b | 01c d60 | 2/3 5/6 | | K15 | 91999-3479 | C | A | NONE |
| 91999-2776 | NATURAL | ALL | ALL | 1/2 4/5 | | K00 | 91999-3478 | A | A | NONE |
| 91999-2777 | NATURAL | 1b | 03c d60 | 1/2 5/6 | | K53 | 91999-3477 | A | A | NONE |
| 91999-2778 | NATURAL | 1b 2b 3b | 01c 05c d60 | 1/2 3/4 5/6 | | K51 | 91999-3476 | A | A | NONE |
| 91999-2779 | NATURAL | ALL | ALL | 2/3 4/5 | | K90 | 91999-3475 | A | A | NONE |
| 91999-2780 | NATURAL | 1b 6a | 04c | 1/2 5/6 | | K03 | 91999-3474 | A | A | NONE |

| | | | | | | | | |
|--|-----------------------------|---|---|--|--|--|------------------------|--|
| SEE SHEET 1 EC NO: E2010-0370 DRAWN BY: B. RUTLE CHKD: TOURSH APPR: BMAGUIRE REV: N | QUALITY SYMBOLS =0 =0 | GENERAL TOLERANCES (UNLESS SPECIFIED) mm INCH | | DIMENSION STYLE MM ONLY | | SCALE 1:1 | DESIGN UNITS METRIC | THIRD ANGLE PROJECTION |
| | | 4 PLACES ± --- ± --- | DRAWN BY B. RUTLE DATE 2006/10/04 | TITLE RAST 5 VERT HDR PA 66 HOUSING | | MOLEX INCORPORATED DOCUMENT NO. SD-91999-001 | | SHEET NO. 5 OF 6 |
| | | 3 PLACES ± --- ± --- | CHECKED BY T. TOURSH DATE 2006/10/04 | DRAFT WHERE APPLICABLE MUST REMAIN WITHIN DIMENSIONS | | SEE CHART | | THIS DRAWING CONTAINS INFORMATION THAT IS PROPRIETARY TO MOLEX INCORPORATED AND SHOULD NOT BE USED WITHOUT WRITTEN PERMISSION |
| | | 2 PLACES ± 0.1 ± --- 1 PLACE ± 0.2 ± --- | APPROVED BY BMAGUIRE DATE 2006/10/04 | | | | | |

| 7 CIRCUIT | | SEE CODE DESIGNATION TABLE FOR NUMBERING FORMAT WHEN ADDING NEW PART NUMBERS | | | | | | P.C.B. POLARISATION OPTION | PACKAGIG OPTION * | COLOUR STRIPE |
|----------------|---------|--|-------------------------|----------------|---------------------------|-----|-------------------|----------------------------|-------------------|---------------|
| PART NO. (TIN) | COLOUR | UNBLOCKED POSITION KEYS | UNBLOCKED CODING KEYS | LATCH POSITION | CONFIGURATION (SEE NOTES) | REF | PART NO. (SILVER) | | | |
| 91999-3511 | NATURAL | NONE | 03c d40 07c | 1/2 5/6 | | K01 | 91999-4249 | A | NONE | |
| 91999-3512 | NATURAL | 3a 4a | d30 d70 | 1/2 5/6 | | K30 | 91999-4248 | A | | |
| 91999-3504 | NATURAL | 2b | d20 d60 | 1/2 5/6 | | K32 | 91999-4247 | A | | |
| 91999-3508 | NATURAL | 1a 1b 3a 4b 5a | 01c 07c | 1/2 3/4 5/6 | | K40 | 91999-4243 | A | | |
| 91999-3509 | NATURAL | 2a | 01c d50 | 2/3 4/5 | | K41 | 91999-4242 | A | | |
| 91999-3515 | NATURAL | 7b | 01c d40 d70 | 1/2 3/4 6/7 | | K43 | 91999-4240 | A | | |
| 91999-3516 | NATURAL | 1b | 03c d60 | 1/2 4/5 | | K31 | 91999-4239 | A | | |
| 91999-3517 | NATURAL | 1a 3a 4b 7b | 01c d20 03c 06c | 1/2 3/4 6/7 | | K45 | 91999-4238 | A | | |
| 91999-3519 | NATURAL | 1b 7a | 02c d50 | 2/3 6/7 | | K48 | 91999-4237 | A | | |
| 91999-3521 | NATURAL | 1a 2b 3a 4b 6a | d20 03c d40 d50 d70 | 1/2 3/4 6/7 | | K51 | 91999-4236 | A | | |
| 91999-3522 | NATURAL | 1b 6a | d20 03c d50 d70 | 1/2 3/4 6/7 | | K69 | 91999-4235 | A | | |
| 91999-3523 | NATURAL | 1b 2a 5a 5b 7b | d20 d50 06c d70 | 1/2 4/5 6/7 | | K34 | 91999-4234 | A | | |
| 91999-3524 | NATURAL | 2b | d20 07c | 1/2 3/4 5/6 | | K35 | 91999-4233 | A | | |
| 91999-3525 | NATURAL | 2a 2b 4b 5b 6a | d20 03c d40 d60 | 1/2 3/4 5/6 | | K38 | 91999-4232 | A | | |
| 91999-3526 | NATURAL | 2b 4a 4b 5b 6a | 01c d20 d40 d60 | 1/2 3/4 5/6 | | K42 | 91999-4231 | A | | |
| 91999-3527 | NATURAL | 1b, 2a, 3a 5b, 6a, 6b, 7b | 01c, d70 | 2/3, 6/7 | | K05 | 91999-4230 | A | | |
| 91999-3528 | NATURAL | ALL | ALL | 1/2, 5/6 | | K00 | 91999-4229 | A | | NONE |
| 91999-3529 | NATURAL | 2a 3b 4b 5a 6a 6b 7a | 01c d30 04c 06c d60 d70 | 1/2 4/5 | | N/A | 91999-4228 | A | | NONE |
| 91999-3530 | NATURAL | NONE | 04c 07c | 1/2 5/6 | | N/A | 91999-4227 | A | NONE | |

NOTES:
* SEE SHEET 1 NOTE 4

| | | | | | | | | | |
|---|-------------------------|---------------------------------------|--|---|--|--------------------|--------------|----------------------------------|--|
| SEE SHEET 1 ELEC NO: E2010-0370 DRAWN BY: B. RUTLE CHKD BY: T. TOURSH APPR: BMAGUIRE 2010/05/17 2006/10/04 2010/06/08 | QUALITY SYMBOLS | GENERAL TOLERANCES (UNLESS SPECIFIED) | | DIMENSION STYLE | | SCALE | DESIGN UNITS | THIRD ANGLE PROJECTION | |
| | | | | MM ONLY | | 1:1 | METRIC | | |
| | | | | | | DRAWN BY DATE | | TITLE | |
| | | | | | | CHECKED BY DATE | | RAST 5 VERT HDR PA 66 HOUSING | |
| | | | | APPROVED BY DATE | | MOLEX INCORPORATED | | | |
| | | | | MATERIAL NO. | | DOCUMENT NO. | | | |
| | | | | SEE CHART | | SD-91999-001 | | | |
| | | | | DRAFT WHERE APPLICABLE MUST REMAIN WITHIN DIMENSIONS | | SHEET NO. 6 OF 6 | | | |
| | | | | THIS DRAWING CONTAINS INFORMATION THAT IS PROPRIETARY TO MOLEX INCORPORATED AND SHOULD NOT BE USED WITHOUT WRITTEN PERMISSION | | | | | |