

Thunderbolt 3 Dock, Dual Display - 4K 60 Hz, UHD, HDMI, DP, VGA, USB 3.2 Gen 1, USB-A/C Hub, GbE

MODEL NUMBER: MTB3-DOCK-02

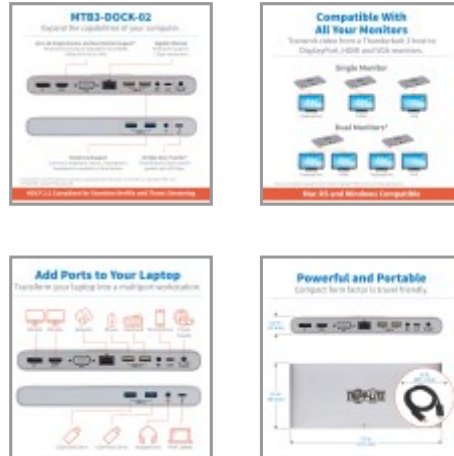

Adds HDMI, DisplayPort, VGA, USB-A, USB-C, Ethernet and 3.5 mm audio ports to your MacBook, ThinkPad or other Thunderbolt 3 device.

Features

Thunderbolt 3 Docking Station Turns Your MacBook or Other Notebook into a Workstation This Thunderbolt 3 dock expands the potential of your MacBook or ThinkPad's Thunderbolt 3 port. It's ideal for transmitting digital 4K video to two large displays simultaneously, adding as many as five USB peripherals, recording a podcast, listening to music and connecting to a Gigabit Ethernet network—all at the same time.

Supports DisplayPort Alternate Mode for Transmitting Audio/Video Signals By connecting the included Thunderbolt 3 cable to a source device that supports DisplayPort Alt Mode, you can output 4K video and digital audio to a compatible monitor, television or projector without installing special software drivers.

Thunderbolt 3 Supports Blisteringly Fast 40 Gbps Data Transfer Speeds The included Thunderbolt 3 cable supports bidirectional speeds up to 40 Gbps, which is eight times faster than USB 3.0, four times faster than Thunderbolt 1 and twice as fast as Thunderbolt 2. With dual 20 Gbps channels moving data both directions at the same time, the MTB3-DOCK-02 is perfectly suited for 4K video streaming and editing on two monitors, as well as transferring large RAW video or CAD files.

DisplayPort Multi-Stream Transport (MST) Allows Connection of Multiple Displays By connecting the included Thunderbolt 3 cable to a source that supports DisplayPort MST Mode, you may connect two displays simultaneously, so long as one of them is connected to the DisplayPort (DP) video port. Connect a DP monitor and an HDMI monitor or a DP monitor and a VGA monitor at the same time. This allows you to display the same image on both monitors, extend your host desktop across both with different windows open on each, or combine both into one large display as a video wall.

Transmits True 4K Video and Digital Audio The HDMI and DP outputs support true 4K resolutions up to 4K x 2K (4096 x 2160) at 60 Hz. The VGA output supports HD resolutions up to 1920 x 1080 (1080p) at 60 Hz. HDCP 2.2 compliance allows you to stream 4K Amazon and Netflix content with no complications.

USB Ports Connects Keyboards, Thumb Drives and Other USB Peripherals Four USB-A hub ports and one USB-C port accept USB peripherals, such as flash drives, mice, keyboards, external hard drives

Highlights

- Connects 2 displays at the same time for multitasking and increasing productivity
- Supports UHD resolutions up to true 4K @ 60 Hz for crystal-clear video
- Joins a wired 10/100/1000 Gigabit Ethernet network when no Wi-Fi is available
- Supports Thunderbolt 3 speeds up to 40 Gbps between compatible devices
- USB-A and USB-C data ports allow connection of flash drives and other peripherals

Applications

- Extend or mirror your MacBook or EliteBook on multiple displays to aid in multitasking and increase productivity
- Transfer files from one Thunderbolt 3 device to another at 40 Gbps
- Access a wired Gigabit Ethernet network in a location with no or spotty Wi-Fi
- Connect a microphone/headset to record a podcast and speakers to listen to music

System Requirements

- Source device with Thunderbolt 3 port that supports USB DisplayPort Alternate Mode and DisplayPort MST Mode (see owner's manual for details)
- Display device(s) with HDMI, VGA or DisplayPort input*

*Both HDMI and DisplayPort outputs can transmit 4K video simultaneously. See owner's manual for details.

Package Includes

- MTB3-DOCK-02 Thunderbolt 3 Dock, Dual Display, Black
- Thunderbolt 3 cable (M/M), 1.6 ft.
- External power supply (Input: 100–240V, 50/60 Hz, 3.0A; Output: 20V 6A)
- C13 to NEMA 5-15P Adapter, 4 ft.

and printers. The USB-C and two USB-A ports support fast USB 3.2 Gen 1 data transfer rates up to 5 Gbps (10 times faster than USB 2.0) and are backward compatible with USB 2.0 and USB 1.1 devices. The other two USB-A ports support USB 2.0 speeds of 480 Mbps.

• Owner's manual

Accesses a Wired Gigabit Ethernet NetworkThe RJ45 port offers access to a Gigabit Ethernet network when no Wi-Fi is available or when a wired connection offers faster speeds. Connect using a UTP cable (sold separately), and enjoy true 10/100/1000 Mbps Ethernet speeds for fast data transfers.

Connects Stereo Audio Equipment for Recording and PlaybackThis Thunderbolt 3 docking station offers two 3.5 mm mini stereo jacks, convenient for connecting speakers, headphones or a microphone to your workstation. You can listen to music and record the latest episode of your podcast.

Included Thunderbolt 3 Cable Attaches in Either DirectionUnlike traditional USB cables that connect in only one direction, the reversible Thunderbolt 3 male connector plugs into its port in either direction for an instant connection every time.

Ready to Use Right from the Package, So You Can Plug and Play ImmediatelyThe plug-and-play Thunderbolt 3 dock is specifically designed for use with the MacBook Pro and other notebook computers equipped with a Thunderbolt 3 port. It requires no extra software to download and install. The included external power supply provides up to 20V 3A (60W) to charge and power the connected source device. The docking station is slightly larger than a typical smartphone, making it easy to pack into a backpack or laptop bag for multipoint convenience wherever you go.

Specifications

OVERVIEW	
UPC Code	037332248459
Product Type	Docking Station
Technology	DisplayPort; HDMI; Thunderbolt; USB 2.0 (High Speed); VGA/SVGA
Host Connector	THUNDERBOLT 3 (Type-C MALE)
VIDEO	
Number of Monitors Supported	2
Video Ports	DISPLAYPORT (FEMALE); HDMI (FEMALE); HD15 (FEMALE)
Video Ports Details	DisplayPort 1.2; HDMI 2.0; HDCP 1.4; HDCP 2.2
Resolutions Supported	DisplayPort: 4K 60Hz (3840 x 2160)HDMI: 4K 60Hz (3840 x 2160)VGA: 1920 x 1200 60Hz
Max Supported Video Resolution	DisplayPort: 4096 x 2160 (4K x 2K) @ 60 Hz; HDMI: 4096 x 2160 (4K x 2K) @ 60 Hz; VGA: 1920 x 1080 @ 60 Hz
Extended Mode	Yes
Extended Mode Details	1x DP (4K 60Hz) + 1x HDMI (4K 60Hz)1x DP (4K 60Hz) + 1x VGA (1080p)
Mirror Mode	Yes
Mirror Mode Details	1x DP (4K 60Hz) + 1x HDMI (4K 60Hz)1x DP (1080p) + 1x VGA (1080p)
Max Supported Color Depth	36-bit Deep Color
HDR Support	No
Chroma Sub Sampling	4:4:4



AUDIO	
Audio Ports	(2) 3.5MM (FEMALE)
Audio Ports Details	Separate 3.5 mm mini stereo jacks for speakers and microphone
DATA	
Data Ports	(1) USB C (FEMALE); (4) USB A (FEMALE)
Data Ports Details	(1) USB-C - USB 3.2 Gen 1 (5 Gbps); (2) USB-A - USB 3.2 Gen 1 (5 Gbps); (2) USB-A - USB 2.0
NETWORK	
Network Ports	RJ45 (FEMALE)
INPUT	
Maximum Input Amps	3
Voltage Compatibility (VAC)	100; 110; 120; 125; 127; 200; 208; 220; 230; 240
Bus Powered	No
BATTERY	
Battery Charging (5V/1.5A Port)	No
POWER	
AC Adapter	Input: 100–240V, 50/60 Hz, 3.0A; Output: 20V, 6A
External Power Supply Input Specs (V / Hz / A)	100-240V / 50/60Hz / 3.0A
External Power Supply Output Specs (V / A)	20V / 6A
External Power Supply Cord Length (ft.)	4
External Power Supply Cord Length (m.)	1.2
DC Barrel Plug	OD: 4.5 x 0.6 x 10.5mm, Positive Pin, Negative Sleeve
USB Power Delivery (PD) Charging Support	No
External Power Supply Plug(s)	NEMA 5-15P North America
USER INTERFACE, ALERTS & CONTROLS	
LED Indicators	White (Connection to Power) and Orange (Activity)
CHARGING	
Total Charging Watts	60
Charging Ports	Supports 60W (20V 3A) Power to Host Computer



Charging Ports / Amps	3A
PHYSICAL	
Material of Construction	Aluminum, Zinc Alloy
Color	Gray
Shipping Dimensions (hwd / in.)	2.50 x 10.43 x 7.09
Shipping Weight (lbs.)	1.30
Unit Dimensions (hwd / in.)	0.87 x 3.46 x 7.68
Unit Dimensions (hwd / cm)	2.2 x 8.5 x 19.5
Unit Dimensions (hwd / mm)	22 x 85 x 195
Unit Packaging Type	Box
Unit Weight (lbs.)	0.948
Unit Weight (kg)	0.43
ENVIRONMENTAL	
Operating Temperature Range	32 to 113°F (0 to 45°C)
Storage Temperature Range	32 to 158°F (0 to 70°C)
Operating Humidity Range	10% to 85% RH, Non-Condensing
Storage Humidity Range	5 to 90% RH, Non-condensing
Power Provided to Connected Device(s)	20V/3A (60W) to Host Device
COMMUNICATIONS	
Network Compatibility	1 Gbps (Gigabit)
IEEE Standards Supported	802.3ab
CONNECTIONS	
Number of Ports	13
Dock Connectors	DISPLAYPORT, HDMI, VGA, RJ45, (2) USB-A 3.0, (2) USB-A 2.0, (2) 3.5MM, USB-C, TB3 USB-C
Side A - Connector 1	THUNDERBOLT 3 (Type-C FEMALE)
Side A - Connector 2	(2) USB 3.0 A (FEMALE)
Side A - Connector 3	USB C (FEMALE)
Side B - Connector 1	DISPLAYPORT (FEMALE); HD15 (FEMALE); HDMI (FEMALE)
Side B - Connector 2	RJ45 (FEMALE)
Side B - Connector 3	(2) USB A (FEMALE)
Side B - Connector 4	(2) 3.5MM (FEMALE)
Connector Plating	Nickel



FEATURES & SPECIFICATIONS	
Displayport Specification	1.2
HDCP Specification	2.2
USB Hub Ports	Yes
Number of USB Hub Ports	5
USB Specification	USB 2.0 (up to 480 Mbps); USB 3.0 (up to 5 Gbps)
Driver Required	No
Recommended Category Cable	Cat5/Cat5e/Cat6 Cables
UASP Support	No
Auto MDIX Support	No
Full Duplex Support	No
Suspend Mode Support	No
Remote Wakeup Support	No
Thunderbolt Specification	Thunderbolt 3 (up to 40Gbps short or active cables)
STANDARDS & COMPLIANCE	
External Power Supply Certifications	CCC; CE; GS; PSE; TUV; UL; cUL
Certification & Compliance	RoHS; REACH; FCC (USA)
WARRANTY	
Product Warranty Period (Worldwide)	3-year limited warranty

© 2022 Tripp Lite. All rights reserved. All product and company names are trademarks or registered trademarks of their respective holders. Use of them does not imply any affiliation with or endorsement by them. Tripp Lite has a policy of continuous improvement. Specifications are subject to change without notice. Tripp Lite uses primary and third-party agencies to test its products for compliance with standards. See a list of Tripp Lite's testing agencies: <https://www.tripplite.com/products/product-certification-agencies>