

DWG. NO.		RM5W5S-1026	
REV	DESCRIPTION	BY DATE	APPD
01	ECR 7562	JEM 12/18/02	12/18/02

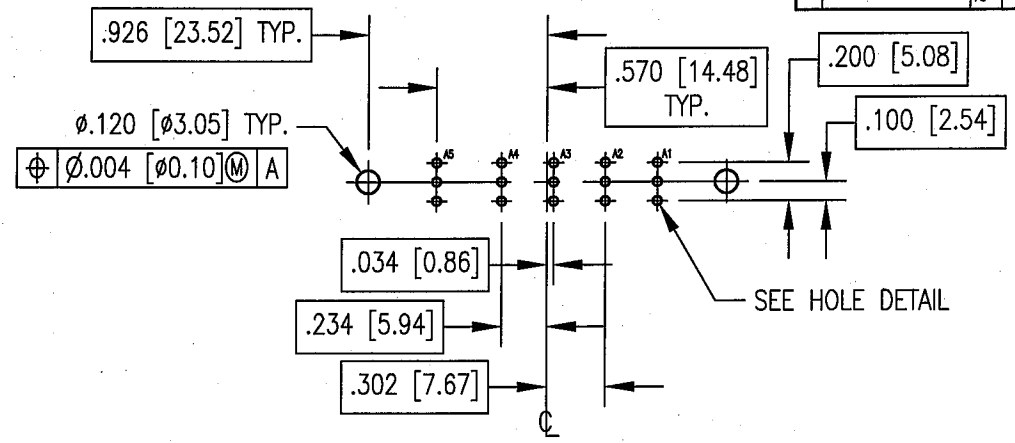

FOOTPRINT
VIEWED FROM COMPONENT SIDE OF P.C.B.

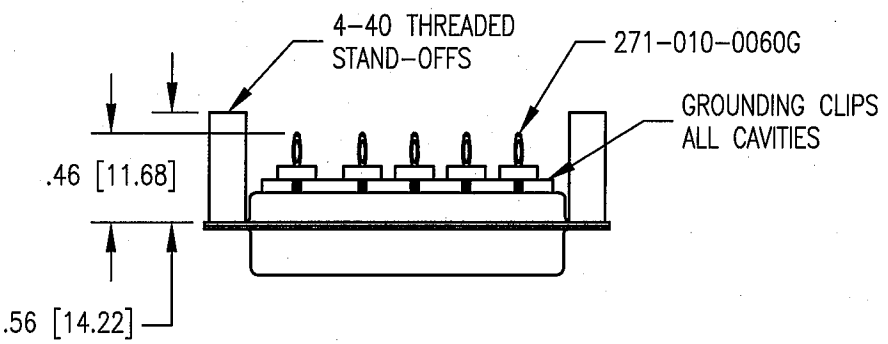
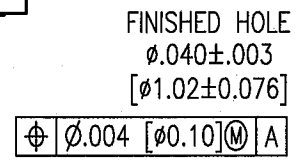
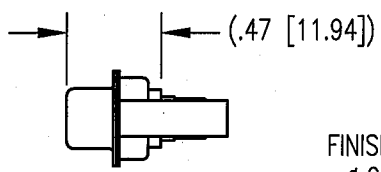
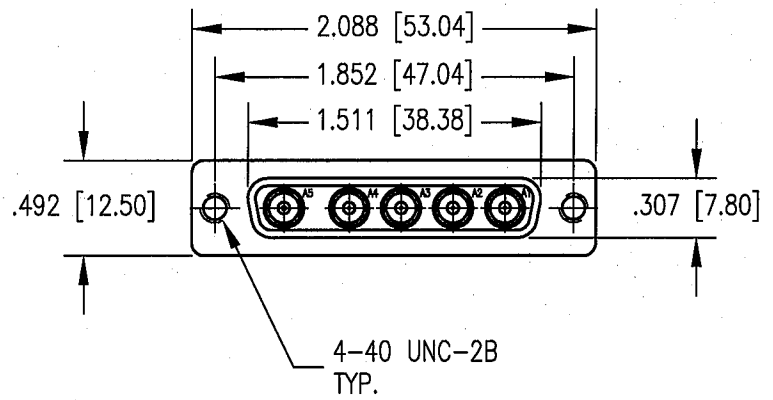

SOLDER THICKNESS
.0001/.0008
[0.003/0.020]

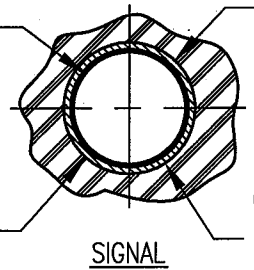

DRILLED HOLE
 $\phi .0453^{+.0015}_{-.0010}$
[$\phi 1.15^{+.038}_{-.025}$]
AFTER DEFLASHING
 $\phi .004$ [0.10] M A

COPPER THICKNESS
.0010/.0030
[0.025/0.076]

- NOTES:
- MATERIALS:
SHELLS: STEEL PER ASTM A568
INSULATOR: GLASS FILLED POLYESTER
STAND-OFFS: BRASS PER ASTM B16
GROUNDING CLIPS: COPPER ALLOY
FOR CONTACT SPECIFICATIONS SEE SALES DRAWING
 - FINISH:
SHELLS, GROUNDING CLIPS AND STAND-OFFS: TIN PLATE PER ASTM B545
FOR CONTACT SPECIFICATIONS SEE SALES DRAWING
 - CONTACT ARRANGEMENT AS SHOWN.

PER ASME Y14.5M-1994 UNLESS OTHERWISE SPECIFIED: DIMENSIONS ARE IN INCHES (MM)		NORTHROP GRUMMAN	
TOLERANCES: DECIMALS .XX ± .01 [0.254] XXX ± .005 [0.127] ANGLES ± 2°		Winchester Electronics 400 Park Road Watertown, CT 06795	
SCALE: 1:1		TITLE 5W5S D-SUB CONNECTOR WITH 75 OHM P.C.B. CONTACTS	
CUSTOMER DRAWING		A	
DRAWN JEM	DATE 12/10/02	CHECKED SD	DATE 12/11/02
APPROVED KJT	DATE 12/11/02	APPROVED JED	DATE 12/11/02
A		RM5W5S-1026	SHT. 1 OF 1 REV. A