

REV	DESCRIPTION	BY DATE	APPD
B	ECR 7733	JED 6/27/03	JEM

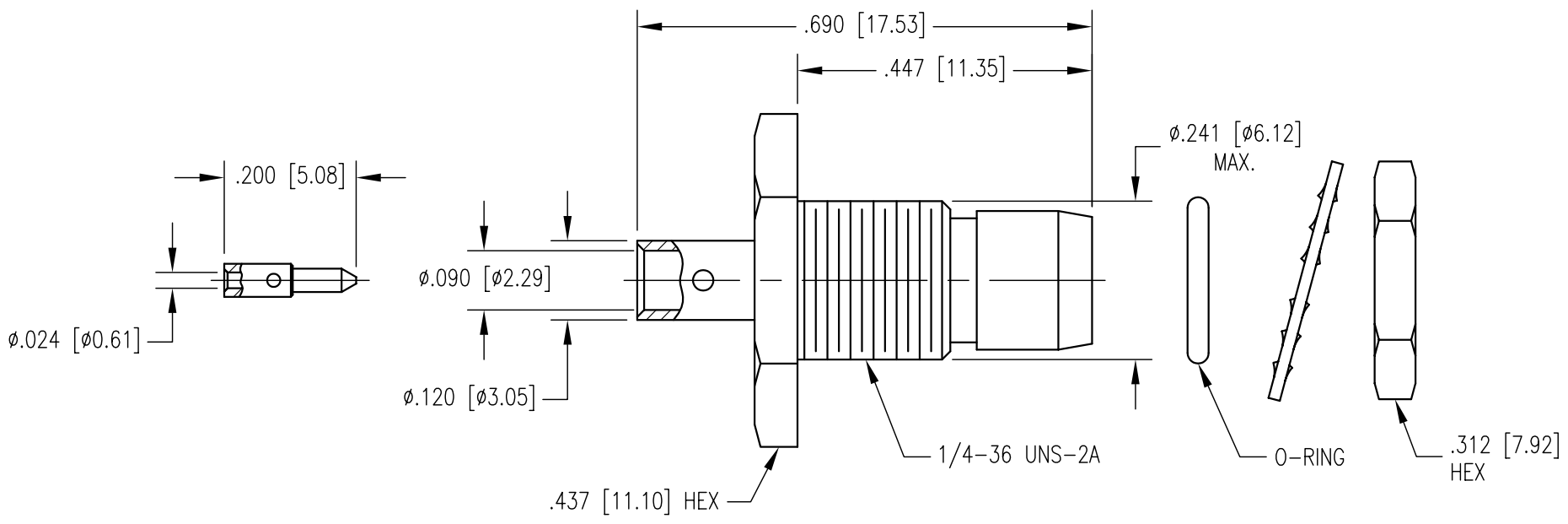

NOTES:

- MATERIALS:  
 FRONT CONTACT: COPPER ALLOY  
 LOCKWASHER: PHOSPHOR BRONZE PER ASTM B103  
 ALL OTHER METAL PARTS: BRASS PER ASTM B16  
 INSULATOR: TEFLON PER ASTM D1710  
 O-RING: SILICONE RUBBER PER ZZ-R-765
- FINISH:  
 CENTER CONTACTS: .000030 MIN. GOLD PER MIL-G-45204 OVER  
 .000050 MIN. NICKEL PER QQ-N-290  
 BODY: .000015 MIN. GOLD PER MIL-G-45204 OVER  
 .000050 MIN. NICKEL PER QQ-N-290  
 NUT AND LOCKWASHER: .000005 MIN. GOLD PER MIL-G-45204 OVER  
 .000050 MIN. NICKEL PER QQ-N-290
- FOR USE WITH .085 DIA. SEMI-RIGID CABLE OR EQUIVALENT.
- FOR CABLING PROCEDURES USE CAP 5-24 WITH TRIMMING DIMENSIONS SHOWN.

RECOMMENDED MOUNTING HOLE

CABLE TRIMMING DIMENSIONS

PER ASME Y14.5M-1994 UNLESS OTHERWISE SPECIFIED: DIMENSIONS ARE IN INCHES [MM] TOLERANCES: DECIMALS .XX ± .01 [0.254] .XXX ± .005 [0.127] ANGLES ± 2° SCALE: 4:1		<b>NORTHROP GRUMMAN</b> Winchester Electronics 62 Barnes Industrial Road North Wallingford, CT 06492	
<b>CUSTOMER DRAWING</b>		TITLE BMA STRAIGHT BULKHEAD PLUG	
DRAWN JED DATE 10/22/01	CHECKED JWH DATE 10/23/01	DATE 10/23/01	REV. B
APPROVED JEM DATE 10/23/01	APPROVED KJT DATE 10/23/01	A SD360-574-0850H	SHT. OF REV. 1 1 B