

1. PART NO. EXPRESSION :

SSC06033R0YZF-□□
 (a) (b) (c) (d)(e)(f) (g)

- (a) Series code
- (b) Dimension code
- (c) Inductance code : 3R0 = 3.00uH
- (d) Tolerance code : Y = ±30%
- (e) X, Y, Z : Standard part
- (f) F : RoHS Compliant
- (g) 11 ~ 99 : RoHS Compliant

2. CONFIGURATION & DIMENSIONS :

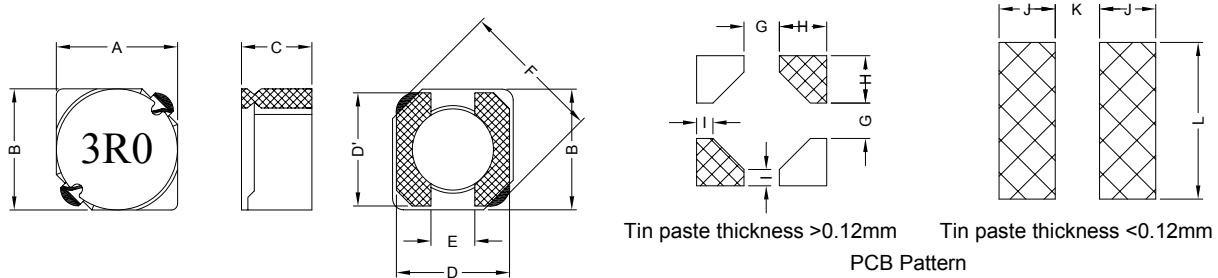

Unit:m/m

A	B	C	D	D'	E	F
6.70±0.3	6.70±0.3	3.00 Max.	6.50 Ref.	6.50 Ref.	2.00 Ref.	9.50 Max.
G	H	I	J	K	L	
2.20 Ref.	2.55 Max.	0.95 Max.	2.65 Ref.	2.00 Ref.	7.30 Ref.	

3. SCHEMATIC :

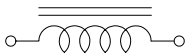

4. MATERIALS :

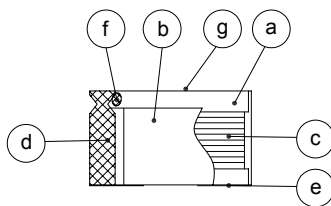

- (a) Core : DR Ferrite Core
- (b) Core : RI Ferrite Core
- (c) Wire : Enamelled Copper Wire
- (d) Terminal : Au+Ni Copper Plate
- (e) Adhesive : Epoxy
- (f) Adhesive : Epoxy
- (g) Ink : Bon Margue



RoHS Compliant

NOTE : Specifications subject to change without notice. Please check our website for latest information.

04.10.2010



SUPERWORLD ELECTRONICS (S) PTE LTD

5. GENERAL SPECIFICATION :

- a) Temp. rise : 30°C Typ. at rated current
- b) Rated current : Base on temp. rise & $\Delta L/L0A = 35\%$ Typ.
- c) Storage temp. : -40°C to +125°C
- d) Operating temp. : -40°C to +95°C
- e) Resistance to solder heat : 260°C.10 secs

6. ELECTRICAL CHARACTERISTICS :

Part No.	Inductance (μ H)	Test Frequency (Hz)	RDC (m Ω) Max.	IDC (A) Max.
SSC06033R0YZF-□□	3.0 \pm 30%	0.5V / 10K	24	3.00
SSC06033R9YZF-□□	3.9 \pm 30%	0.5V / 10K	27	2.60
SSC06035R0YZF-□□	5.0 \pm 30%	0.5V / 10K	31	2.40
SSC06036R0YZF-□□	6.0 \pm 30%	0.5V / 10K	35	2.25
SSC06037R3YZF-□□	7.3 \pm 30%	0.5V / 10K	54	2.10
SSC06038R6YZF-□□	8.6 \pm 30%	0.5V / 10K	58	1.85
SSC0603100YZF-□□	10.0 \pm 30%	0.5V / 10K	65	1.70
SSC0603120YZF-□□	12.0 \pm 30%	0.5V / 10K	70	1.55
SSC0603150YZF-□□	15.0 \pm 30%	0.5V / 10K	84	1.40
SSC0603180YZF-□□	18.0 \pm 30%	0.5V / 10K	95	1.32
SSC0603220YZF-□□	22.0 \pm 30%	0.5V / 10K	128	1.20
SSC0603270YZF-□□	27.0 \pm 30%	0.5V / 10K	142	1.05
SSC0603330YZF-□□	33.0 \pm 30%	0.5V / 10K	165	0.97
SSC0603390YZF-□□	39.0 \pm 30%	0.5V / 10K	210	0.86
SSC0603470YZF-□□	47.0 \pm 30%	0.5V / 10K	238	0.80
SSC0603560YZF-□□	56.0 \pm 30%	0.5V / 10K	277	0.73
SSC0603680YZF-□□	68.0 \pm 30%	0.5V / 10K	304	0.65
SSC0603820YZF-□□	82.0 \pm 30%	0.5V / 10K	390	0.60
SSC0603101YZF-□□	100.0 \pm 30%	0.5V / 10K	535	0.54



RoHS Compliant

NOTE : Specifications subject to change without notice. Please check our website for latest information.

04.10.2010



SUPERWORLD ELECTRONICS (S) PTE LTD

7. CHARACTERISTICS CURVES :

@ TEMP. RISE VS. DC SUPERPOSITION RESPONSE CURVE

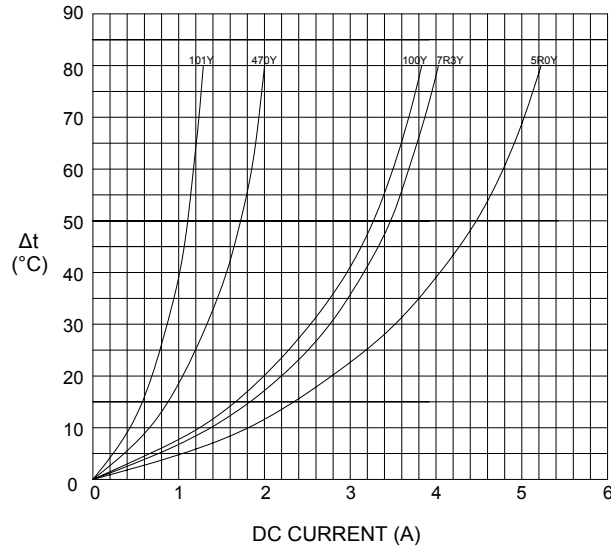

@ INDUCTANCE VS. FREQUENCY RESPONSE CURVE

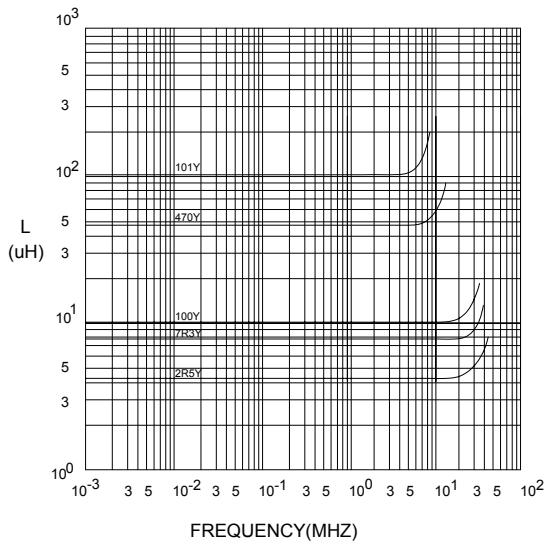

@ INDUCTANCE VS. DC SUPERPOSITION RESPONSE CURVE

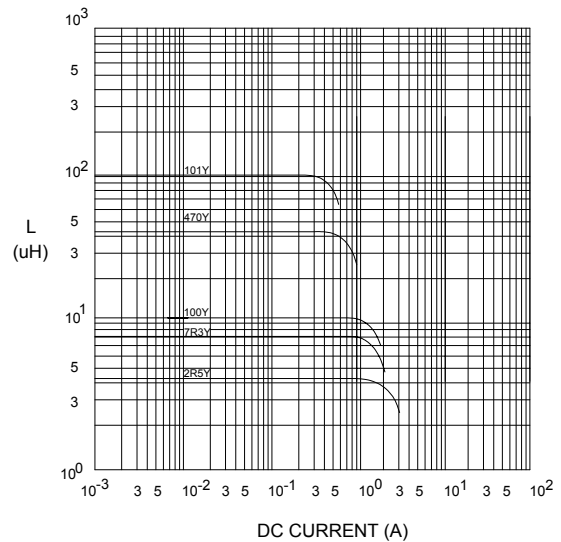

RoHS Compliant

NOTE : Specifications subject to change without notice. Please check our website for latest information.

04.10.2010



SUPERWORLD ELECTRONICS (S) PTE LTD

RECOMMENDED SOLDERING CONDITIONS REFLOW SOLDERINGS

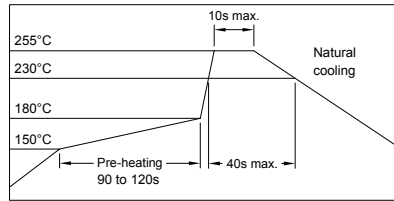

8. PACKAGING INFORMATION :

(1) CONFIGURATION

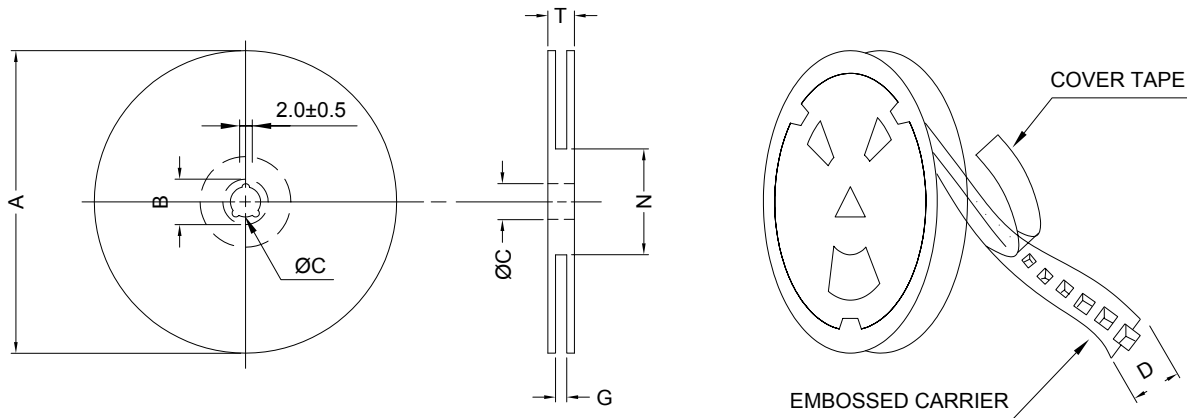

* CARRIER TAPE WIDTH : D

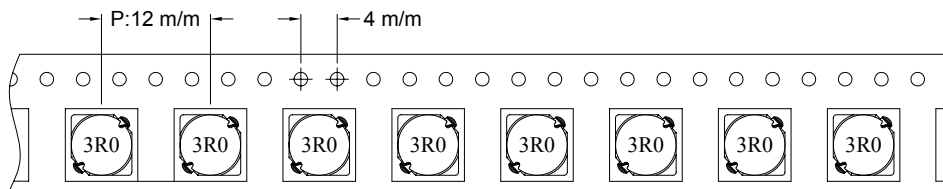

(2) DIMENSIONS

Unit:m/m

STYLE	A	B	C	D	G	N	T
13-16	330	21±0.8	13	16	18 ⁺⁰	50 ⁻⁰	22.4

(3) Q'TY & G.W. PER PACKAGE

SERIES	INNER : REEL			OUTER : CARTON		
	Q'TY (PCS)	G.W. (gw)	STYLE	Q'TY (PCS)	G.W. (Kg)	SIZE (cm)
SSC0603	1000	600	13-16	6000	7.1	40 x 40 x 24



RoHS Compliant

NOTE : Specifications subject to change without notice. Please check our website for latest information.

04.10.2010



SUPERWORLD ELECTRONICS (S) PTE LTD

9. RELIABILITY AND TEST CONDITION :

TEST ITEM	SPECIFICATION	TEST CONDITION
SOLDERABILITY	MORE THAN 90% OF THE TERMINAL ELECTRODE SHALL BE COVERED WITH FRESH SOLDER.	PREHEAT : 125±25°C FOR 60 SECONDS SOLDER : 99%Sn/0.3%Ag/0.7%Cu OR EQUIVALENT SOLDER TEMP. : 245±5°C FLUX : ROSIN DIP TIME : 4±1 SECONDS
THERMAL SHOCK TEST (TEMP. CYCLE)	INDUCTANCE SHALL NOT CHANGE MORE THAN ±20%	ROOM TEMP. → -25±2°C 15 MINUTES 30 MINUTES
		ROOM TEMP. → 85±2°C 15 MINUTES 30 MINUTES
		TOTAL : 50 CYCLES
HUMIDITY RESISTANCE TEST		TEMPERATURE : 40±2°C HUMIDITY : 90 ~ 95% APPLIED CURRENT : PER SPEC. TIME : 500 HOURS
HIGH TEMP. RESISTANCE TEST		TEMPERATURE : 85±2°C APPLIED CURRENT : PER SPEC. TIME : 500 HOURS

10. UL CARD :

OBMW2		November 30, 2000	
Magnet Wire - Component			
PACIFIC ELECTRIC WIRE & CABLE (SHENZHEN) CO LTD 607 BAOLONG INDUSTRIAL ESTATE LONGGANG, SHENZHEN GUANGDONG CHINA			E201757
Mtl Dsg	BC	TC	ANSI Type
UEW/U	Polyurethane	—	TI 130
PEW/U	Polyester	—	MW5-C 155°C
PEWH/U	Modified Polyester	—	MW30-C 180
PEW-NY/U	Polyester	Polyamide	MW24-C 155
HAI/U	Polyester(Amide)(Imide)	Polyamideimide	MW35,73 200
UEW-NY/U	Polyurethane	Polyamide	MW80-C 155 MW28-C 130
<p>Marking: Company name and material designation or marked designation on package or reel, and Recognized Component Mark.</p> <p>See General Information Preceding These Recognitions</p>			
1/3/2001	Underwriters Laboratories Inc.	Card 1 of 2	



RoHS Compliant

NOTE : Specifications subject to change without notice. Please check our website for latest information.

04.10.2010

