

TYPE: QUANTITY: PROJECT:

CATALOG
NUMBER:

FIXTURE

WATTAGE

VOLTAGE

FINISH

OPTION

OPTION

OPTION

OPTION

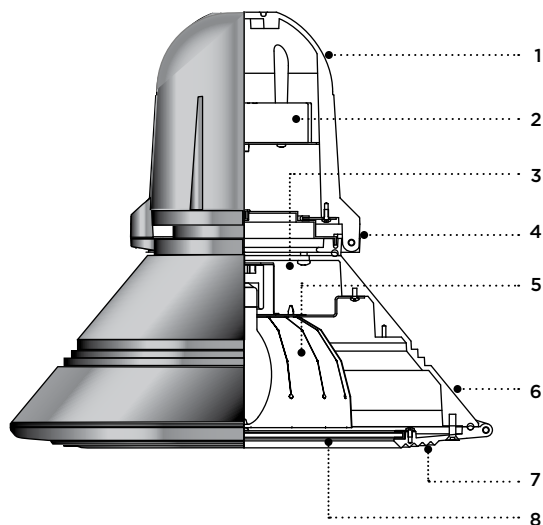

Full cutoff luminaire

- 1- Cast aluminum ballast housing.
- 2- Universal ballast tray with twist lock design.
- 3- Sealed and isolated lamp compartment.
- 4- Housing/shade assembly hinge mechanism.
- 5- Standard Distribution Type II (see options for other available distribution types).
≥ 95% specular aluminum multi-facet reflector.
- 6- Cast aluminum shade.
- 7- Cast aluminum lens frame with hinge mechanism.
- 8- Clear tempered lens.

SR125T

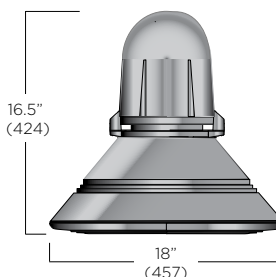

EPA: 0.68

MATERIALS

Scirocco is made of corrosion resistant 356 aluminum alloy with a copper (CU) content of less than 0.1%. The luminaire is designed with two separate hinge mechanisms isolating the ballast chamber from the optical assembly. The top ballast housing and shade are made of cast aluminum. The lower shade optical assembly includes a cast aluminum hinged lens frame enclosing a clear tempered sealed glass lens.

ELECTRICAL

HIGH INTENSITY DISCHARGE (H.I.D.)

BALLAST Electronic 120/277V multi volt, or 347V (50-60HZ) with a minimum starting temperature of -30°C/-20°F, including end of life protection.

SOCKET Medium base pulse rated 4KV porcelain body with a nickel plated screw shell, and center contact rated 600V. Supplied with 200°C leads.

COMPACT FLUORESCENT (CFL)

BALLAST 120/277V-50/60HZ multi volt or 347V electronic ballast with end of life protection. Minimum starting temperature of 0°F/-18°C

SOCKET Thermoplastic body rated for 75W-600V. Supplied with 105°C leads.

FINISH

Five-stage preparation process including preheating of cast aluminum parts for air extraction, and an environmentally friendly alloy sealant. Polyester powder coating is applied through an electrostatic process and oven cured for long term finish.

MOUNTING

Maximum weight: 22.5lbs (10.2kg)

Scirocco is designed as a modular luminaire concept offering a selection of mounting arrangements for various architectural requirements. Pole, wall or suspended attachments are proposed with high quality components to meet multiple installation conditions.

CERTIFICATION

Tested to UL1598 and CSA 22.2 #250. ETL listed wet location.

CE certification on request.

Rated IP65.

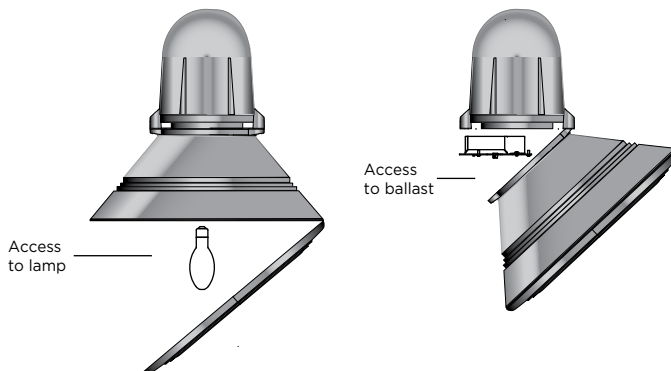

Scirocco is designed for ease of access with a double hinge sealed mechanism isolating the light chamber from the driver compartment minimizing maintenance handling an possible components damage.

TYPICAL PHOTOMETRY SUMMARY

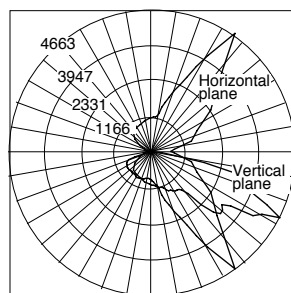

Descriptive Information
 Total Lms: 9300 Lumens
 Total Input Watts: 128 W
 Lamps: ED17/Clear Metal Halide
 Total efficiency: 64%
 BUG Rating: B2-U1-G1
 Cutoff classification: Full-Cutoff
 Distribution: Type III

SR125-M100

Outdoor report Polar graph
 Maximum Candela = 4663 CP

Please visit our web site www.luminis.com for complete I.E.S. formatted download data.

LUMINAIRE SELECTION

MODEL#	LAMP SELECTION ¹	VOLTAGE ²	FINISH	
 <input type="checkbox"/> SR125	METAL HALIDE ⁶ ED LAMP TYPE <input type="checkbox"/> M50E ANSI M110 <input type="checkbox"/> M70E (ED17/E26 base) ANSI M98 <input type="checkbox"/> M100E ANSI M90 <input type="checkbox"/> M150E ANSI M102	<input type="checkbox"/> 120V <input type="checkbox"/> 277V <input type="checkbox"/> 347V	STANDARD COLORS <input type="checkbox"/> WHT Snow white <input type="checkbox"/> BKT Jet black <input type="checkbox"/> BZT Bronze <input type="checkbox"/> MST Matte silver <input type="checkbox"/> GRT Titanium gray <input type="checkbox"/> DGT Gun metal <input type="checkbox"/> CHT Champagne	
	COSMOPOLIS™ Lighting System (includes lamp) <input type="checkbox"/> M60C <input type="checkbox"/> M90C (T6/PGZ12 base) 2800K, 70CRI } 90W/140W 277V Only <input type="checkbox"/> M140C	For better results, luminaire is supplied for a horizontal lamp position only. Please specify R3 Type III or R4 Type IV reflector with lamp selection.	<input type="checkbox"/> 120V <input type="checkbox"/> 277V	OPTIONAL COLORS <input type="checkbox"/> CS Custom color <input type="checkbox"/> RAL RAL# color (Refer to color chart)
	COMPACT FLUORESCENT Single lamp <input type="checkbox"/> F132 1X32W <input type="checkbox"/> F142 1X42W <input type="checkbox"/> F157 1X57W Two lamps <input type="checkbox"/> F232 2X32W <input type="checkbox"/> F242 2X42W (Gx24q)	OPTIONAL COSMOPOLIS™ Lumistep™ Dimming <input type="checkbox"/> LM60 (60W Step Dimming Ballast - 6 hours) <input type="checkbox"/> M60-120/277V <input type="checkbox"/> LM90 (90W Step Dimming Ballast - 6 hours) <input type="checkbox"/> M90-277V <input type="checkbox"/> LM140 (140W Step Dimming Ballast - 6 hours) <input type="checkbox"/> M140-277V	<input type="checkbox"/> 120V <input type="checkbox"/> 277V <input type="checkbox"/> 347V	

The CosmoPolis™ system offers a step-dimming option.

The ballast will dim the 90W and 140W lamps to 60 % lamp power.

The ballast calculates the mid-point of the evening, which is the starting point for 6 hour LumiStep™.

8 or 10 hours LumiStep™ available on request. * CosmoPolis™ and LumiStep™ are registered trademarks of Royal Philips Electronics.

OPTIONS

ELECTRICAL	MOUNTING	ACCESSORIES
<input type="checkbox"/> FS Fuse ³ <input type="checkbox"/> PH Photocell ³ <input type="checkbox"/> QS 120V Max. 100W bayonet lamp base for emergency external power ⁴ <input type="checkbox"/> QRS Quartz lamp standby restrick. Max. 100W bayonet lamp. 120-277V ⁵	<input type="checkbox"/> ACA Pole mounted attachment with 45° support <input type="checkbox"/> ACW Wall mounted attachment with 45° support <input type="checkbox"/> APA Pole mounted shepherd arm attachment <input type="checkbox"/> APC Pole mounted straight arm attachment <input type="checkbox"/> APS Post top shepherd arm attachment <input type="checkbox"/> CAT Catenary suspension attachment <input type="checkbox"/> W Wall mounted shepherd arm attachment <input type="checkbox"/> T Wall mount straight arm attachment <input type="checkbox"/> STM 36" Field-cutable stem with 45° swivel (other lengths available, please specify)	<input type="checkbox"/> SPG Silver braided power cord with adjustable suspension cable. 36" in length (other lengths on request). <input type="checkbox"/> SC Safety cable extends 18" over mounting plate (with stem mounting only) <input type="checkbox"/> SSC Stabilizer cables <input type="checkbox"/> HS House shield installed within the glass diffuser <input type="checkbox"/> R3 Type III distribution reflector <input type="checkbox"/> R4 Type IV distribution reflector <input type="checkbox"/> R5 Type V distribution reflector

NOTES

- 1- Unless otherwise noted, lamps are by others.
- 2- Luminaires are factory prewired for 120V (if no voltage is specified.) For other voltages, please specify with catalog number, or consult factory.
- 3- Fuse and photocell options are normally installed with poles when specified with Luminis luminaires. (Except for other types of mounting.)
- 4- QS option requires a separate 120V emergency external power line.
- 5- QRS option requires a 120/277V line.
- 6- High Pressure Sodium sources are available on request.

LUMINIS®

LUMINIS | Toll free: 866.586.4647 Fax: 514.683.8872
 260 Labrosse, Pointe-Claire (QC) Canada H9R 5L5

Luminaires may be altered for design improvement or discontinued without prior notice.
 Unless specified, lamps are not included with luminaires.

LUMINIS.COM

POLE MOUNT

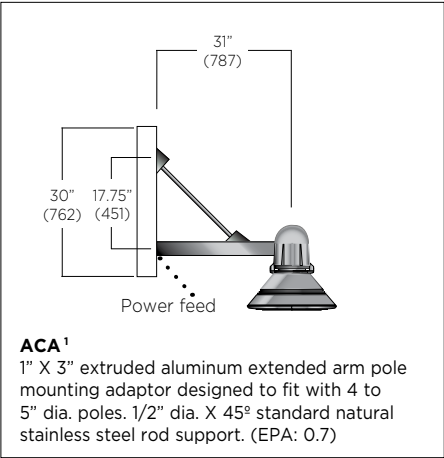

ACA¹
1" X 3" extruded aluminum extended arm pole mounting adaptor designed to fit with 4 to 5" dia. poles. 1/2" dia. X 45° standard natural stainless steel rod support. (EPA: 0.7)

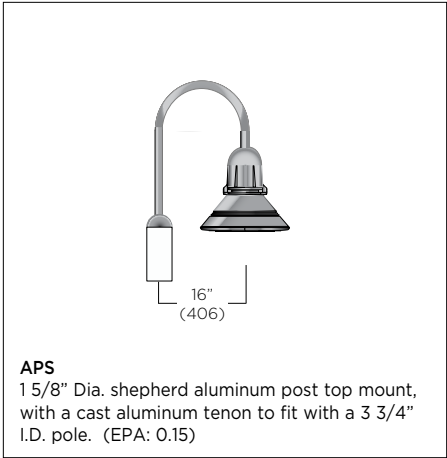

APS
1 5/8" Dia. shepherd aluminum post top mount, with a cast aluminum tenon to fit with a 3 3/4" I.D. pole. (EPA: 0.15)

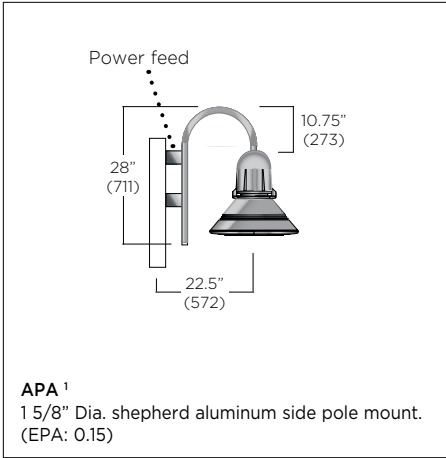

APA¹
1 5/8" Dia. shepherd aluminum side pole mount. (EPA: 0.15)

NOTE 1: PCA Pole with ACA and APA attachments require a 30" (762) tenon extension over pole nominal height. Factory installed.

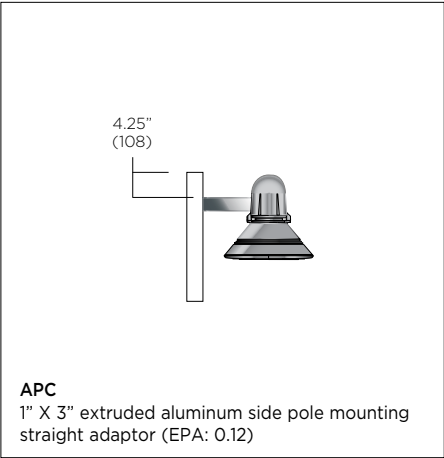

APC
1" X 3" extruded aluminum side pole mounting straight adaptor (EPA: 0.12)

MATCHING POLE SELECTION

Ø 4"	Ø 5"	Ø 4"	Tapered Pole	Ø 4"	Height
PAA410	PAA510	PST10	-----	PSB10	10 Ft. (3 M)
PAA412	PAA512	PST12	-----	PSB12	12 Ft. (3,6 M)
PAA414	PAA514	PST14	-----	PSB14	14 Ft. (4,2 M)
PAA416	PAA516	PST16	PTA16	PSB16	16 Ft. (4,8 M)
PAA418	PAA518	-----	PTA18	PSB18	18 Ft. (5,5 M)
PAA420	PAA520	-----	PTA20	PSB20	20 Ft. (6,0 M)
-----	-----	-----	PTA25	-----	25 Ft. (7,6 M)

For additional pole details, please refer to separate pole specification sheet.
Ø 4"= 100mm Ø5"= 127mm



WALL MOUNT

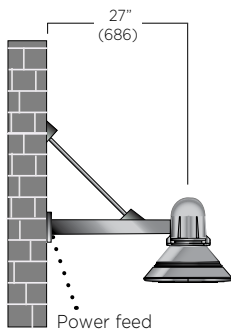

ACW

1" X 3" extruded aluminum extended arm wall mounting adaptor with cast aluminum covers and galvanized steel mounting plates. 1/2" dia. X 45° standard natural stainless steel rod support.

Mounting

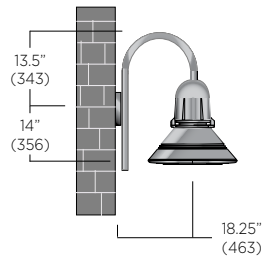
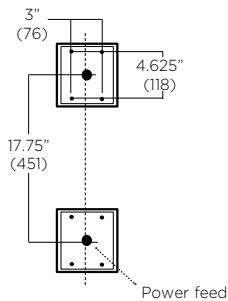

W

1 5/8" Dia. shepherd aluminum arm wall mount, with a cast aluminum wall cover and galvanized steel mounting plate.

Mounting

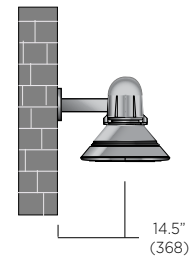
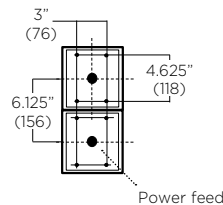

T

1" X 3" extruded aluminum wall mounting straight adaptor with cast aluminum cover and galvanized steel mounting plate.

Mounting

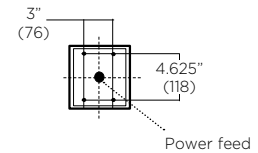

CATENARY SUSPENSION

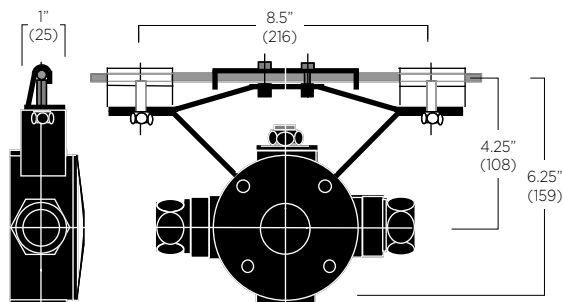

CAT

Attachment includes a sealed cast aluminum connection box with (2) 1/2" sealed connectors for armored power cable (by Others). Ready to accept 1/4" stainless steel suspension cable. (By others)

CEILING PENDANT MOUNT

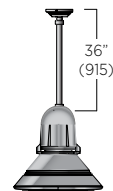

STM



SPG



SSC

STM

36" lg. (914) stem with 45° swivel ceiling mount Ø 5/8" (16) aluminum suspension stem. Luminaire top swivel adaptor allows to cut stem to length on site. (Mounts over a standard 4" octagonal box with 3 1/2" C/C holes)

SPG

4/18 Silver braided power cable, with stainless steel adjustable cable. Standard 36" lg. (914). Other lengths available on request.

SSC

Set of three stabilizer cables

LUMINIS®