

SECTION A-A

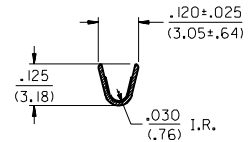

SECTION B-B

- NOTES:
- △ THESE TERMINALS ARE FOR USE WITH THE 1461-* SERIES HOUSINGS.
 - THE -1* GROUP CRIMPS #18 TO #22 AWG WIRE WITH INSULATION DIAMETERS OF .061/(1.55) TO .102/(2.59).
 - THE -2* GROUP CRIMPS #14 TO #16 AWG WIRE WITH AN INSULATION DIAMETER OF .140/(3.56) MAX.
 - △ THESE TERMINALS ARE PRODUCED ONLY FOR EXPORT TO JAPAN.
 - △ CARRIER CUT OFF DIMENSION: .007/(.18) MAX.
 - △ PRODUCT SPECIFICATION PS 50-36 APPLIES.
 - △ A 4° ANGLE IS ALLOWED.

MATERIAL:
260 BRASS

PART NO.	ENG. NO.	DIM. C	DIM. D	DIM. E	FORM	PLATING PER SDES-
05-02-0047	1457-1	.145±.025	.135	.045	CHAIN	88-P901
05-02-0048	1457-1L	.145±.025	(3.68±.64)	(1.14)	LOOSE	TIN
05-02-0056	1457-1G	.145±.025	.135	.045	CHAIN	88-P550
05-02-0057	1457-1GL	(3.68±.64)	(3.43)	(1.14)	LOOSE	SEL. GOLD
05-02-0058	1457-1(P555)	.145±.025	.135	.045	CHAIN	88-P555
	1457-1(P555)L	(3.68±.64)	(3.43)	(1.14)	LOOSE	SEL. GOLD
05-02-0049	1457-2	.21±.03	.185±.015	.060	CHAIN	88-P901
05-02-0050	1457-2L	(5.3±.8)	(4.70±.38)	(1.52)	LOOSE	TIN

3	S
2	S
1	S
MFG. SH. REV.	

S	REV ADD -6* ECR U60463 12-19-95 SAMIEC	DIMENSIONS SHOWN METRIC () INCH UNLESS OTHERWISE SPECIFIED TOLERANCES: ANGULAR ± .5°		▽ = 0 ▼ = 0	REVISE ONLY ON CAD SYSTEM
	RI	ADDED OPTION ECN #13.0016 01-14-93 RHR	INCH METRIC 3 PLACE ±.010 --- 2 PLACE ±.014 ±0.25 1 PLACE --- ±0.35	TITLE TERMINAL, COMMONING, CRIMP (1457-1* AND 1457-2*)	
R	ADD OPTION & REDRAW ECN #10538 02-11-91 A.GUZIK	DRAFT WHERE APPLICABLE MUST REMAIN WITHIN DIMENSIONS		PART NO. MOLEX INCORPORATED SHEET NO. DATE L15LEJLL. 60532 U.S.A. 1 OF 3 02/11/91	
LTR.	REVISIONS	LTR.	REVISIONS	DRWG. NO. SD-1457-*	DRWG. NO. SD-1457-*
APP'D BY GWF		CHK'D BY RHR		FILE NAME SD1457X1	
SCALE 4 : 1		SCALE 4 : 1		THIS DRAWING CONTAINS INFORMATION THAT IS PROPRIETARY TO MOLEX INC. AND SHOULD NOT BE USED WITHOUT WRITTEN PERMISSION.	