

CIRCUIT DIAGRAM
回路图

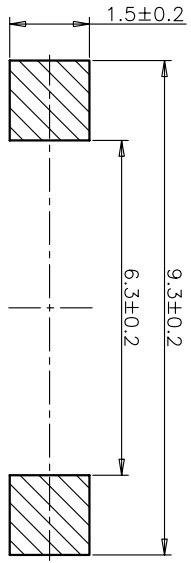

RECOMMENDED P.C.B. LAYOUT
安装尺寸图

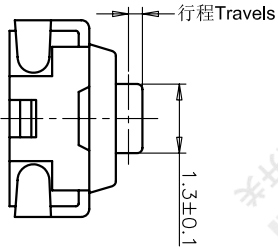
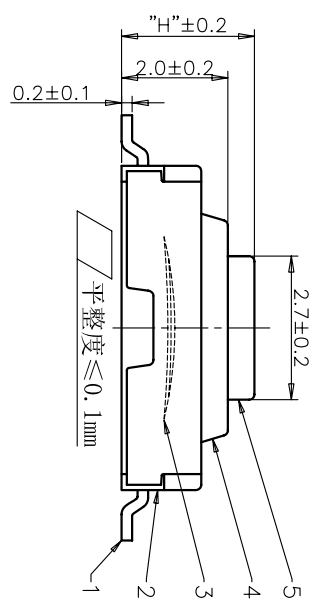

| REV | ECN NO. | APPD |
|-----|----------|---------|
| A | HC110006 | PRIOJOM |
| B | HC120062 | PRIOJOM |
| C | HC130004 | PRIOJOM |
| D | HC140000 | PRIOJOM |

规格 Specifications

| | |
|----------------------------|----------------------------------|
| 额定负荷 Rating | DC 12V/50mA |
| 接触电阻 Contact Resistance | 100mΩ max. |
| 绝缘电阻 Insulation resistance | DC:100V/ 60S 100MΩ min. |
| 抗电强度 Dielectric strength | AC250V/50-60HZ) 60S min. |
| 操作力 Operation force | ≤ 180±30gf ≤ 300±50gf |
| 寿命试验 Operating Life | 50,000 cycles 30,000 cycles |
| 行程 Travels | 0.25±0.1mm |

PRODUCT NO.: 1TS002E*****

- 轻触开关 3X6系列
- 外形: A=插脚, B=贴片, C=贴片带柱, K=贴片带柱8.8, L=贴片10.2
- 按钮颜色: 底座颜色: 盖板颜色: 操作力度: 0=常规(弹片), 1=大手感(弹片), 2=小手感(弹片), 3=特殊手感(弹片)
- 有无贴膜: 0=不贴膜, 1=贴膜
- 其它: CT=编带(非编带, 不启用)
- 产品高度(H): 250=2.5mm

| ITEM | PART NAME | QUANTITY | MATERIAL | FINISH |
|------|-----------|----------|-----------------|-----------|
| 5 | ACTUATOR | 1 | LCP | RED |
| 4 | COVER | 1 | STAINLESS STEEL | NATURAL |
| 3 | DOME | 1 | STAINLESS STEEL | Ag-PLATED |
| 2 | HOUSING | 1 | LCP | BLACK |
| 1 | TERMINAL | 1 | BRASS | Ag-PLATED |

| NAME(INTENDED USE) | 3X6 T/H SERIES TACT SWITCH | TITLE: | PRODUCT DRAWING |
|------------------------|----------------------------|----------|------------------|
| PART NO.(INTENDED USE) | 1TS002E***** | DWG NO.: | 1TS002E |
| APPD: | ZO 8/08/2014 | CHKD: | M.H.LI 8/08/2014 |
| DR: | WP.LU 8/07/2014 | SCALE | 10/1 |
| | | SHEET | 2/2 |
| | | REV. | D |

THESE DRAWINGS AND SPECIFICATIONS ARE THE PROPERTY OF HON YUAN PRECISION IND. CO., LTD. AND SHALL NOT BE REPRODUCED, COPIED OR USED IN ANY MANNER WITHOUT THE PRIOR WRITTEN CONSENT OF HON YUAN PRECISION IND. CO., LTD.