

Leiterplatten-Layout für SMT
PCB-Layout for SMT

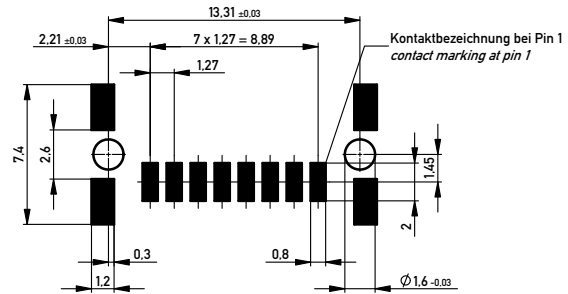

Verpackt im Gurt nach DIN IEC 60286-3
Tape on Reel Packaging according to DIN IEC 60286-3
Verpackungseinheit: 650 Stück
Packaging unit: 650 pcs

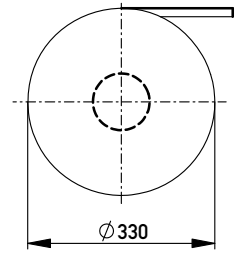

Abspulrichtung - Reel off Direction

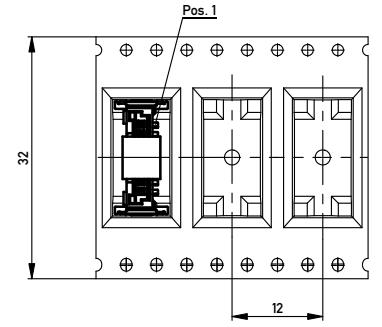

Anforderungsstufe 1
Performance Level 1

Kontaktbereich vergoldet
Mating Area gold plating

Anschlussbereich verzinkt 4-6 µm
Terminal Area 4-6 µm tin plating

Koplanarität der Anschlüsse ≤ 0.1 mm
Coplanarity Area of Termination ≤ 0.1 mm

Copyright by ERNI GmbH
Proprietary notice pursuant to ISO 16949 to be observed

Information:		Tolerances	Scale 5:1	Für die Anforderung nach PG 9 der LV214 (Koshiri-Sicherheit)	
All rights reserved. Only for Information. To ensure that this is the latest version of this drawing, please contact one of the ERNI companies before using.		 All Dimensions in mm		For the requirement of the LV214 PG 9 (Koshiri-security)	
Subject to modification without prior notice. Drawing will not be updated.		Designation		M 1.27 SRC P. 8-polig KS M 1.27 SRC P. 8-pin KS	
www.ERNI.com		474818		I A2	
b	24.03.2014	Class		SRCPC	
Index	Date				