

Class 2 UL5085-3 Transformer

40VA - 50VA, Core 7/8", Inherently Energy Limited

Series: CL - Lead Wires & Quick-Connects

- Power Rating 40VA to 50VA
- No Secondary Fusing Required
- Frequency 50/60Hz
- Insulation Class F (155°C)

Agency Approvals:

- UL/cUL 5085-3 Class 2 Recognized (File E49606)
- Insulation File No. E95662



* Multi voltage combinations are available - consult factory.

Lead Wires

Type HX Foot Mount - Steel bracket welded to the bottom of the laminations for easy mounting
Type GX Panel Mount - 0.156" (3.96 mm) diameter holes in each corner to allow direct mounting to a panel.
Lead Wires: All leads are 18 AWG stranded 2/64" (0.794 mm) insulation thickness. Standard parts have 12" (305 mm) total length with 1/2" (12.7 mm) strip.

Type HX - Foot Mount

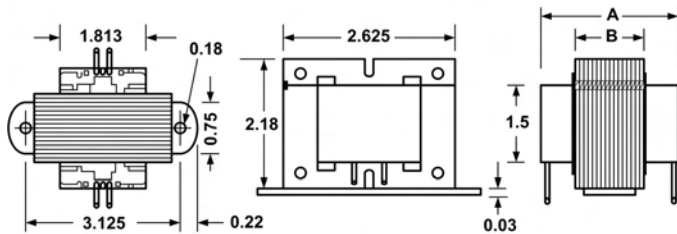

Type GX - Panel Mount

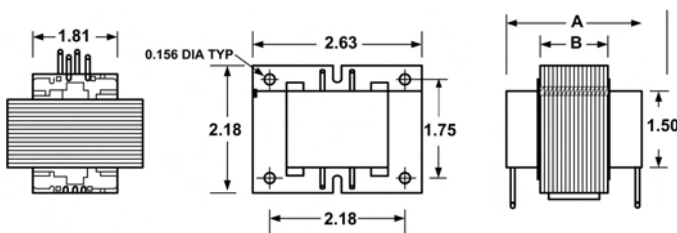

Quick-Connects

Type BB Foot Mount, Pri & Sec on Same Side - Quick connect terminals with line and load terminations on the same side of transformer.
Type AE Laydown, Pri & Sec on Top Side - Quick connect terminals with line and load terminations on the top of transformer.
Type AB Foot Mount, Pri & Sec on Opposite Side - Quick connect terminals with line and load terminations on opposite sides of transformer

Terminals:
 Standard male quick connects - 0.250" x 0.032" (6.35 x 0.81mm)
 Other available quick connects - 0.187" x 0.032" (4.75 x 0.81mm)

Type BB - Foot Mount, Pri & Sec on Same Side

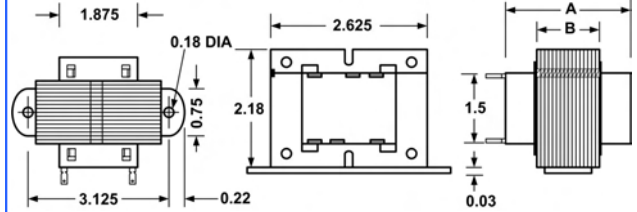

Type AE - Laydown, Pri & Sec on Top Side

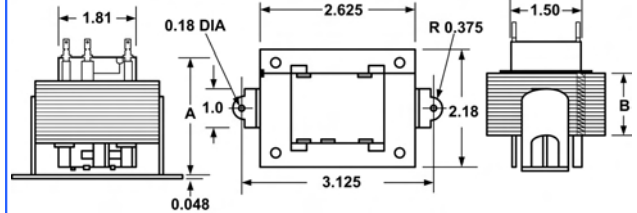

Type AB - Foot Mount, Pri & Sec on Opposite Side

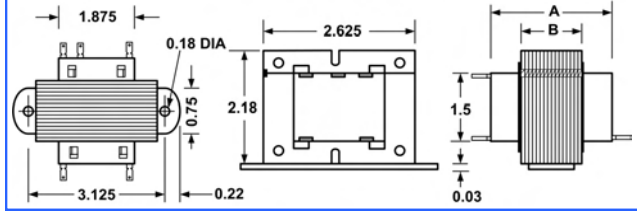

Dimensions (Inches)	40VA - E	50VA - LP	50VA - AW
A	2.000	2.000	2.470
B	0.890	0.890	1.250
Weight (Lbs)	0.740	0.889	0.968

Any application, Any requirement, Contact us for our Custom Designs



Class 2 UL5085-3 Transformer
40VA - 50VA, Core 7/8", Inherently Energy Limited
Series: CL - Lead Wires & Quick-Connects



Partial Selection Guide

Primary Voltage	Secondary Voltage	40 VA Size - 7/8" X 7/8"	UL	50 VA Size - 7/8" X 7/8"	UL	50 VA Size - 7/8" X 1-1/4"	UL
208/230	24	CL40E00-000*	✓	—	-	—	-
120	24	CL40E01-000*	✓	CL50LP01-000*	-	CL50AW01-000*	✓
277	24	CL40E02-000*	✓	CL50LP02-000*	-	CL50AW02-000*	✓
120/208/240	24	CL40E03-000*	✓	CL50LP03-000*	-	CL50AW03-000*	✓
480	24	CL40E04-000*	✓	CL50LP04-000*	-	CL50AW04-000*	✓
120/208/240/480	24	—	-	—	-	CL50AW05-000*	✓
600	24	CL40E06-000*	✓	CL50LP06-000*	-	CL50AW06-000*	✓
120/240	24	CL40E07-000*	-	CL50LP07-000*	-	CL50AW07-000*	✓
380	24	CL40E09-000*	-	CL50LP09-000*	-	CL50AW09-000*	✓
240	24	CL40E40-000*	✓	CL50LP40-000*	-	CL50AW40-000*	✓
208/240	24	CL40E15-000*	✓	CL50LP15-000*	-	CL50AW15-000*	✓
	25	CL40E61-000*	-	CL50LP61-000*	-	CL50AW61-000*	✓
415	24	CL40E16-000*	-	—	-	—	-
380/415	24	CL40E17-000*	-	CL50LP17-000*	-	CL50AW17-000*	✓
575	24	CL40E21-000*	-	CL50LP21-000*	-	CL50AW21-000*	✓
215/230	24	CL40E22-000*	✓	CL50LP22-000*	-	CL50AW22-000*	✓
208/240/277	24	CL40E23-000*	-	—	-	—	-
240/480	24	CL40E24-000*	-	—	-	CL50AW24-000*	✓
380/415/575	24	CL40E27-000*	-	—	-	—	-
460	24	CL40E28-000*	-	—	-	—	-
480/575	24	CL40E30-000*	-	CL50LP30-000*	-	CL50AW30-000*	✓
120/208/240/277	24	CL40E36-000*	-	—	-	—	-
120/277	24	CL40E41-000*	-	CL50LP41-000*	-	CL50AW41-000*	✓
208/277/480	24	CL40E42-000*	-	—	-	—	-
277/380/415	24	CL40E43-000*	-	—	-	—	-
208/240/480	24	CL40E44-000*	-	CL50LP44-000*	-	CL50AW44-000*	✓
208	24	CL40E45-000*	-	CL50LP45-000*	-	CL50AW45-000*	✓
220/240	24	CL40E47-000*	-	CL50LP47-000*	-	CL50AW47-000*	✓
100	24	CL40E48-000*	✓	CL50LP48-000*	-	CL50AW48-000*	✓
220	24	CL40E49-000*	-	CL50LP49-000*	-	CL50AW49-000*	✓
115	24	CL40E51-000*	-	CL50LP51-000*	-	CL50AW51-000*	✓
265	24	CL40E52-000*	-	CL50LP52-000*	-	CL50AW52-000*	✓
346	24	CL40E53-000*	-	CL50LP53-000*	-	CL50AW53-000*	✓
208/230/460	24	CL40E54-000*	-	CL50LP54-000*	-	CL50AW54-000*	✓
400	24	CL40E55-000*	-	CL50LP55-000*	-	CL50AW55-000*	✓
575/600	24	CL40E56-000*	-	—	-	—	-
200/230/460	24	CL40E58-000*	-	CL50LP58-000*	-	CL50AW58-000*	✓
230/460	24	CL40E59-000*	-	CL50LP59-000*	-	CL50AW59-000*	✓
380/460	24	CL40E60-000*	-	CL50LP60-000*	-	CL50AW60-000*	✓
115/230	24	CL40E62-000*	-	—	-	—	-
230	24	CL40E63-000*	-	—	-	—	-
240/277/480	24	CL40E64-000*	-	—	-	—	-

* Refer to page number 7. Must complete part number to specify voltages, termination, mounting & fusing.
 For custom designs 3 digit customer ID will be added at the end of the part number.

Lead Wire Details:

Primary Voltage	COM	110,115,120	200,208,215	220, 230, 240	265, 277	380	400, 415	460, 480	575	600
Color	Black	White	Red	Orange	Brown	Violet	Red/White	Grey	Black/Red	Black/White
Secondary Voltage	COM	12	24	Standard leads: All leads are 12.0" L.O.C (length out of coil) 1/2" strip						
Color	Blue	Yellow	Blue							

Any application, Any requirement, Contact us for our Custom Designs

