

备注：  
套垫圈，拧螺母。

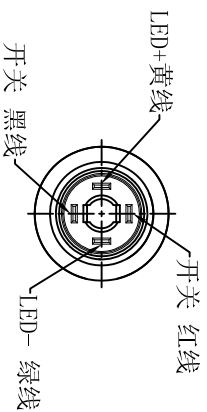

Nut Torque: 5 ~ 14Nm  
 Operating Pressure: 350gf ±80gf  
 Operating Stroke: 3.0mm±0.3  
 Protection Grade: IK08  
 Function: ON-OFF  
 Base: PA66  
 Shell: SUS  
 Button: SUS  
 Lamp Type: LED  
 Lamp Life: 50000H  
 Lamp current : 20mA Max  
 Rating (Resistive load): 0.3A 12V DC  
 Contact Resistance: 50mΩ Max  
 Insulation Resistance: 100MΩ Min  
 Dielectric Strength: 1000V AC 1 minute  
 Electrical life: 50,000 cycles  
 Mechanical life : 100,000 cycles  
 Operating Temperature: -20°C~80°C  
 Safety Approval: **RoHS**

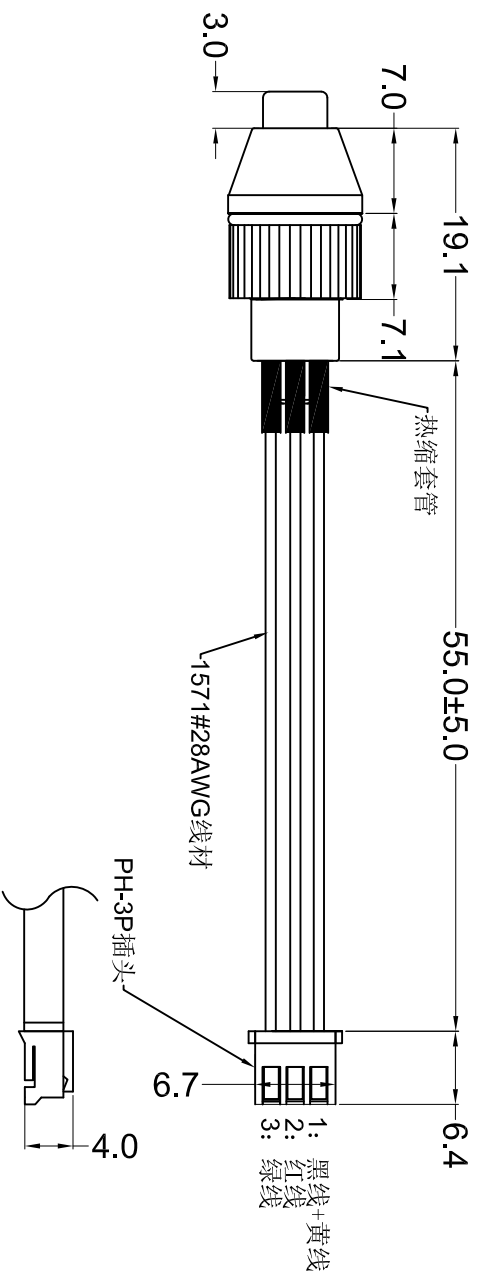
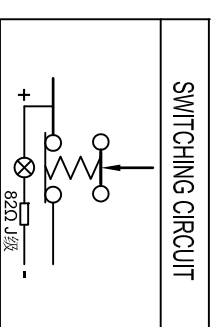
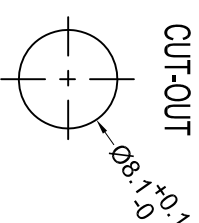

公差 TOLERANCES	.X±0.5	.XX±0.3	角度 ANGLE	±1°	单位 UNIT	DIMENSION UNIT	mm.
版本 VERSION	A0	比例尺 SCALE	1:1	日期 DATE	品名 TITLE	图号 DRAWING NO	
核准 APPROVED BY		核对 CHECKED BY		绘图 DRAWN BY	孙成	PBM-8Z12-HT-G4-S3-3-S7S-D-0005 (L-55-1571#28-BYRG-PH-3P)	1013280
变更说明 CHANGE DESCRIPTION	日期 DATE	ECN NO.					