

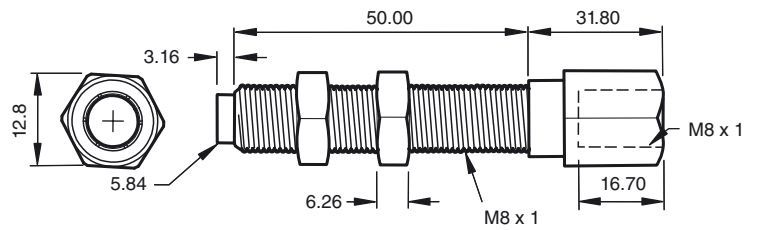

## Dimensions



## Model Number

**ES-08-50**

Mounting adapter

## Features

- End stop adapter
- For 8 mm diameter sensors

## Application

The end stop adapter turns a standard 8 mm diameter shielded inductive sensor into a durable mechanical stop switch. These adapters are useful for applications where end-of-travel signals are required. Sensor activation point is dependent upon the insertion depth (0 - 1.5 mm).

## Technical data

### Mechanical specifications

Material Heat-treated alloy steel