

Series D (Standard D-Sub) Dual Port Solder Dip

I/O Connectors

Specifications

Insulation Resistance: 5,000MΩ min.
 Withstanding Voltage: 1,000V AC
 Contact Resistance: 10mΩ max.
 Current Rating: 5A
 Operating Temp. Range: -55°C to +105°C
 Soldering Temp.: 240°C / 3 sec.

Materials and Finish

Shell: Steel, Tin plated
 Insulator: Polyester Resin (glass filled)
 Fiber reinforced, UL94V-0
 Contacts: Stamped Copper Alloy
 Plating: Gold over Nickel

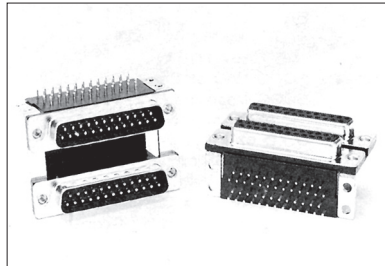

Part Number (Details)

D DP - 01 * * 1

Series

Connector Version:
 DP = Dual Port

No. of Contacts (Top/Bottom):
 01 = 9 / 9
 02 = 15 / 15
 03 = 25 / 25
 10 = 37 / 37

Connector Types (Top / Bottom):
 1 = Male / Male
 2 = Male / Female
 3 = Female / Male
 4 = Female / Female

Vertical Distance between Connectors:
 S = 15.88mm, M = 19.05mm, L = 22.86mm

Assembly:
 1 = Snap-in + 4-40 Clinch Nut (Standard)
 2 = 4-40 Threaded

Outline Connector Dimensions

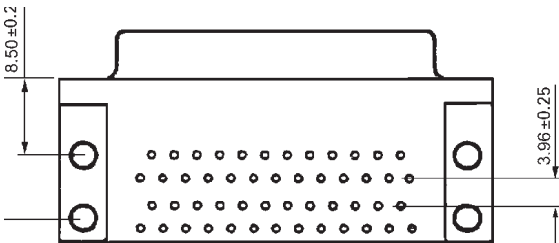
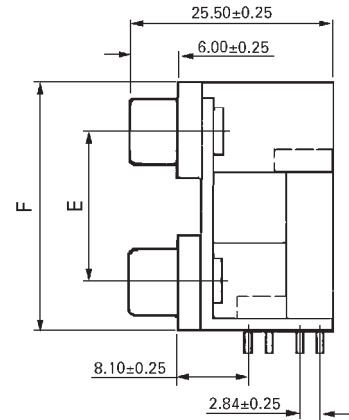
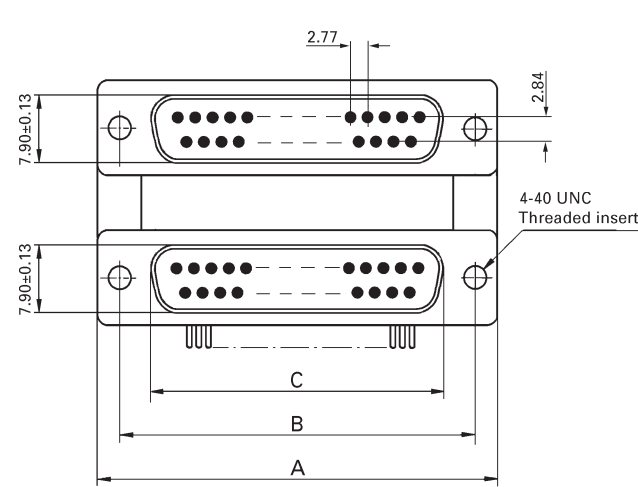

Recommended PCB Layouts

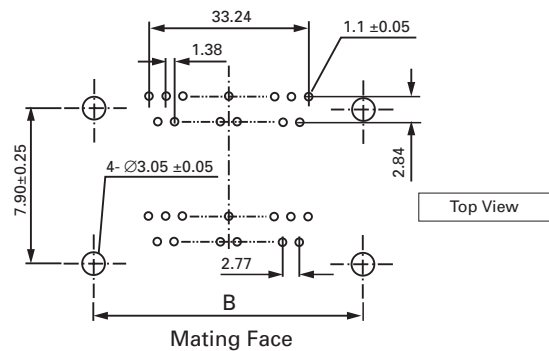

Standard D-Sub

Part Number	No. of Contacts	A	B	C	Vertical Distances	E	F
DDP-01**1	9 / 9	30.81	24.99	16.33	Type S	15.88	28.42
DDP-02**1	15 / 15	39.14	33.32	24.66	Type M	19.05	31.60
DDP-03**1	25 / 25	53.04	47.04	38.38	Type L	22.86	35.41
DDP-10**1	37 / 37	69.32	63.50	54.84			

Specifications

Insulation Resistance: 5,000MΩ min.
 Withstanding Voltage: 1,000V AC
 Contact Resistance: 10mΩ max.
 Current Rating: 5A
 Operating Temp. Range: -55°C to +105°C
 Soldering Temp.: 240°C / 3 sec.

Materials and Finish

Shell: Steel, Tin plated
 Insulator: Polyester Resin (glass filled)
 Fiber reinforced, UL94V-0
 Contacts: Stamped Copper Alloy
 Plating: Gold over Nickel

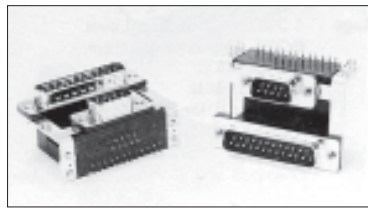

Part Number (Details)

D DP - 04 * * 1

Series

Connector Version:
 DP = Dual Port

No. of Contacts (Top / Bottom):

04 = 9 / 15
 05 = 9 / 25
 06 = 15 / 9
 07 = 15 / 25
 08 = 25 / 9
 09 = 25 / 15

Connector Types (Top / Bottom):

1 = Male / Male
 2 = Male / Female
 3 = Female / Male
 4 = Female / Female

Vertical Distance between Connectors:

S = 15.88mm, M = 19.05mm, L = 22.86mm

Assembly: 1 = With Snap-in 4-40 Clinch Nut (Std.)
 2 = 4-40 UNC Threaded

Outline Connector Dimensions

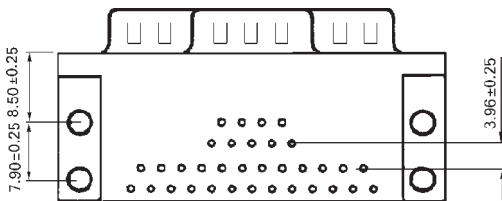
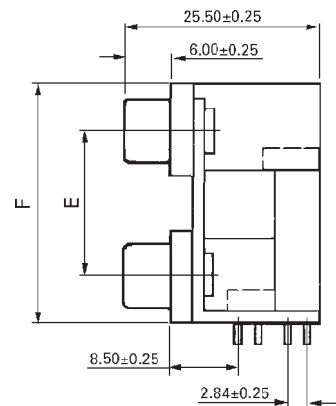
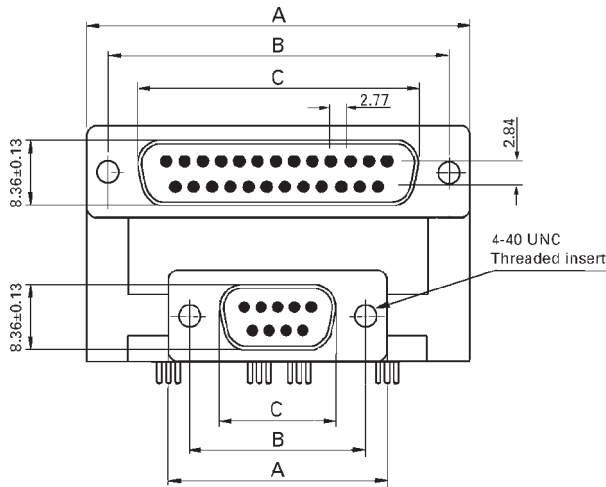

Recommended PCB Layouts

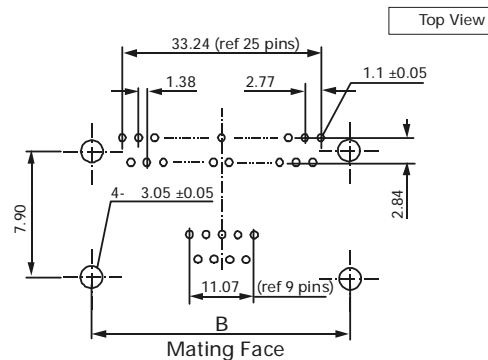

Part No.	No. of Cont.	A	B	C
DDP-04**1	9 / 15	30.81 / 39.14	24.99 / 33.32	16.33 / 24.66
DDP-05**1	9 / 25	30.81 / 53.04	24.99 / 47.04	16.33 / 38.38
DDP-06**1	15 / 9	39.14 / 30.81	33.32 / 24.99	24.66 / 16.33
DDP-07**1	15 / 25	39.14 / 53.04	33.32 / 47.04	24.66 / 38.38
DDP-08**1	25 / 9	53.04 / 30.81	47.04 / 24.99	38.38 / 16.33
DDP-09**1	25 / 15	53.04 / 39.14	47.04 / 33.32	38.38 / 24.66

Vertical Distances	E	F
Type S	15.88	28.42
Type M	19.05	31.60
Type L	22.86	35.41