

# D款, 正向10.6前两脚, SMT-\*6.80

|      |              |      |
|------|--------------|------|
| MAPX | MODIFICATION | DATE |
|      |              |      |

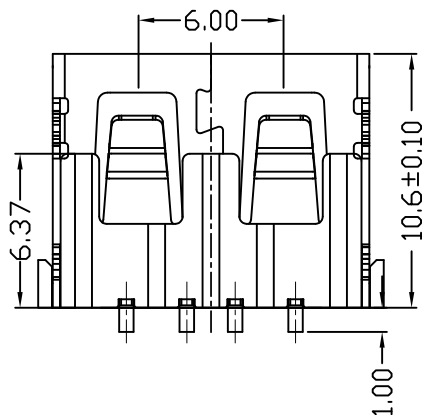
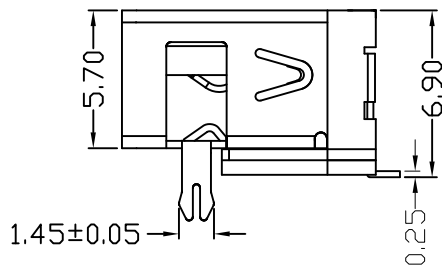
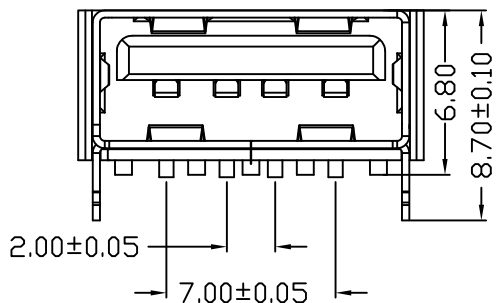
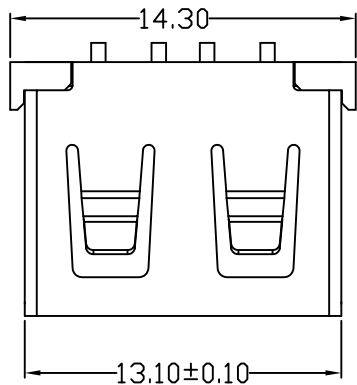

### NOTES:

- 1.HOUSING: SEE NOTES, UL94V-0 .
- TERMINAL: SEE NOTES.
- SHELL: SEE NOTES.

### SPECIFICATION:

- 1.ELECTRICAL CHARACTERISTIC:
  - CONTACT RESISTANCE: 30MΩ MAX
  - DIELECTRIC WITHSTANDING VOLTAGE: 500V AC FOR 1MIN
  - INSULATION RESISTANCE: 1000MΩ MIN
- 2.MECHANICAL CHARACTERISTIC:
  - INSERTION FORCE: 35N(3.57KGF) MAX
  - EXTRACTION FORCE: 10~35N(1.02~3.57KGF)MIN
  - DURABILITY: 1500 CYCLES EXTRACTION FORCE:10~35N 5000 CYCLES MIN
  - 5000 CYCLES EXTRACTION FORCE:3~35N

### 3.ENVIRONMENTAL:

OPERATING TEMPERATURE: -55°C+85°C

### 4.Contact finish:

- 01:Selective Gold Flash
- 02:Selective Gold 3U"
- 03:Selective Gold 5U"
- 04:Selective Gold 15U"
- 05:Selective Gold 30U"

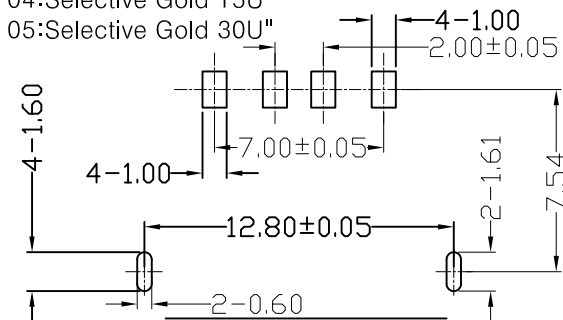

FRONT EDGE OF CONNECTOR  
PCB LAYOUT (T=1.60mm)

|  |       |      |       |                     |            |      |       |      |                              |  |
|--|-------|------|-------|---------------------|------------|------|-------|------|------------------------------|--|
| <b>产品图</b><br>PRODUCT CHART DWG<br>公差一览表<br>TOLERANCE UNLESS OTHERWISE |       |      |       | <b>深圳市精拓金电子有限公司</b> |            |      |       |      |                              |  |
| X.   | ±0.15 | X.   | ±5.°  | 单位                  | MM         | 制图   | Z-Y-B | 制图料号 | 912-121A2023S10100           |  |
| .X   | ±0.10 | .X   | ±2.°  | 比例                  | 1:1        | 审核   |       | 产品名称 | AF10.6D款前两脚无边方弹铁壳LCP黑胶6.8SMT |  |
| .XX  | ±0.05 | .XX  | ±1.°  | 日期                  | 2012.09.24 | 核准   |       | 角法   | 版本<br>VER                    |  |
| .XXX   | ±0.03 | .XXX | ±0.5° | 日期                  |            | APPD |       | 角法   | AD                           |  |