

## XFWI453630-xxx SERIES INDUCTORS

- \* True Surface Mount Design
- \* Low Cost, Extremely High Quality Product
- \* Tape & Reel Packaging Standard
- \* High Inductance, High Power Ratings For Your Laptop, Palmtop, Point of Power Application
- \* Custom Versions Available At No Extra Charge
- \* Operating Temp: -40 to +85°C

### Dimensions:

### Schematic:

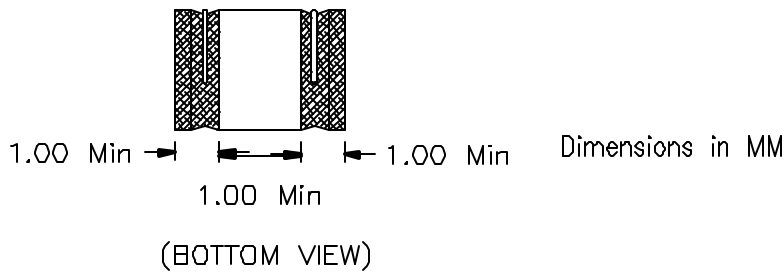
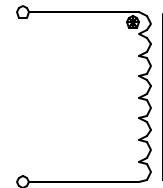
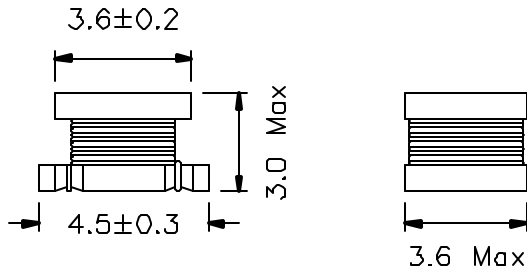

Part Number	QCL (uH)	QCL Test Freq. (MHz)	Q Min.	Q Test Freq. (MHz)	DCR Max (OHM)	SRF MHz Min.	I RATED (mA)
XFWI453630-1R0M	1.0	1	20	1	0.2	120	500
XFWI453630-1R2M	1.2	1	20	1	0.2	100	500
XFWI453630-1R5M	1.5	1	20	1	0.3	85	500
XFWI453630-1R8M	1.8	1	20	1	0.3	75	500
XFWI453630-2R2M	2.2	1	20	1	0.3	62	500
XFWI453630-2R7M	2.7	1	20	1	0.32	53	500
XFWI453630-3R3M	3.3	1	20	1	0.35	47	500

## XFWI453630-xxx SERIES INDUCTORS

Part Number	OCL (uH)	OCL Test Freq. (MHz)	Q Min.	Q Test Freq. (MHz)	DCR Max (OHM)	SRF MHz Min.	I RATED (mA)
XFWI453630-3R9M	3.9	1	20	1	0.38	41	500
XFWI453630-4R7K	4.7	1	30	1	0.40	38	500
XFWI453630-5R6K	5.6	1	30	1	0.47	33	500
XFWI453630-6R8K	6.8	1	30	1	0.50	31	450
XFWI453630-8R2K	8.2	1	30	1	0.56	27	450
XFWI453630-100K	10.0	1	35	1	0.24	23	650
XFWI453630-120K	12.0	1	35	1	0.62	21	380
XFWI453630-150K	15.0	1	35	1	0.73	19	360
XFWI453630-180K	18.0	1	35	1	0.82	17	340
XFWI453630-220K	22.0	1	35	1	0.94	15	320
XFWI453630-270K	27.0	1	35	1	1.10	14	300
XFWI453630-330K	33.0	1	35	1	1.20	12	270
XFWI453630-390K	39.0	1	35	1	1.40	11	240
XFWI453630-470K	47.0	1	35	1	1.50	10	220
XFWI453630-560K	56.0	1	35	1	1.70	9.3	200
XFWI453630-680K	68.0	1	35	1	1.90	8.4	180
XFWI453630-820K	82.0	1	35	1	2.20	7.5	170
XFWI453630-101K	100	1	35	1	2.50	6.8	160
XFWI453630-121K	120	1	35	1	3.00	6.2	150
XFWI453630-151K	150	1	40	1	3.70	5.5	130
XFWI453630-181K	180	1	40	1	4.5	5.0	120
XFWI453630-221K	220	1	40	1	5.4	4.5	110
XFWI453630-271K	270	1	40	1	6.8	4.0	100
XFWI453630-331K	330	1	40	0.796	8.2	3.6	95
XFWI453630-391K	390	1	40	0.796	9.7	3.3	90
XFWI453630-471K	470	0.001	40	0.796	11.8	3.0	80
XFWI453630-561K	560	0.001	40	0.796	14.5	2.7	70
XFWI453630-681K	680	0.001	40	0.796	17.0	2.5	65
XFWI453630-821K	820	0.001	40	0.796	20.5	2.2	60
XFWI453630-102K	1000	0.001	40	0.252	25	2.0	50
XFWI453630-122K	1200	0.001	40	0.252	30	1.8	45
XFWI453630-152K	1500	0.001	40	0.252	37	1.6	40