

**PLEASE CHECK WWW.MOLEX.COM FOR LATEST PART INFORMATION**

**Part Number:** [0022051101](#)  
**Status:** **Active**  
**Description:** 2.50mm (.098") Pitch Header, Right Angle, Square Pin, 10 Circuits, Tin (Sn) Plating

**Documents:**

<a href="#">3D Model</a>	<a href="#">Product Specification PS-3094-002 (PDF)</a>
<a href="#">Drawing (PDF)</a>	<a href="#">Product Specification PS-99020-0088 (PDF)</a>
<a href="#">Product Specification PS-3094-001 (PDF)</a>	<a href="#">RoHS Certificate of Compliance (PDF)</a>

**Agency Certification**

CSA	LR19980
UL	E29179

**General**

Product Family	PCB Headers
Series	<a href="#">3094</a>
Application	Wire-to-Board
Product Name	N/A

**Physical**

Breakaway	No
Circuits (Loaded)	10
Circuits (maximum)	10
Color - Resin	Natural (White)
Flammability	94V-0
Glow-Wire Compliant	No
Lock to Mating Part	None
Material - Metal	Brass
Material - Plating Mating	Tin
Material - Plating Termination	Tin
Material - Resin	Nylon
Number of Rows	1
Orientation	Right Angle
PC Tail Length (in)	0.134 In
PC Tail Length (mm)	3.40 mm
PCB Locator	No
PCB Retention	None
PCB Thickness Recommended (in)	0.062 In
PCB Thickness Recommended (mm)	1.60 mm
Packaging Type	Bag
Pitch - Mating Interface (in)	0.098 In
Pitch - Mating Interface (mm)	2.50 mm
Plating min: Mating (µin)	200
Plating min: Mating (µm)	5
Plating min: Termination (µin)	200
Plating min: Termination (µm)	5
Polarized to Mating Part	No
Polarized to PCB	No
Shrouded	No
Stackable	Yes
Temperature Range - Operating	-40°C to +105°C
Termination Interface: Style	Through Hole

**Electrical**

Current - Maximum per Contact	3A
Voltage - Maximum	250V

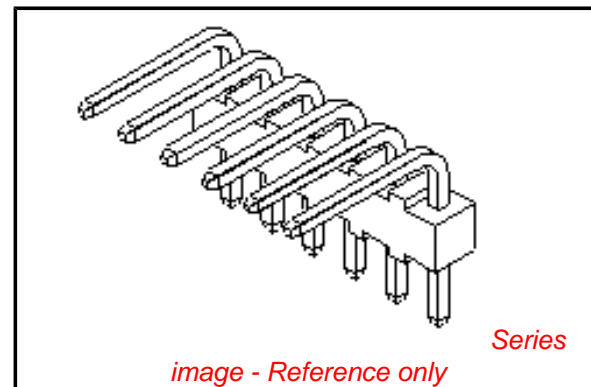

*image - Reference only*

**EU RoHS**

**ELV and RoHS  
Compliant**  
**REACH SVHC**  
 Not Reviewed  
**Halogen-Free  
Status**

**China RoHS**



**Need more information on product  
environmental compliance?**

Email [productcompliance@molex.com](mailto:productcompliance@molex.com)  
 For a multiple part number RoHS Certificate of  
 Compliance, [click here](#)

Please visit the [Contact Us](#) section for any  
 non-product compliance questions.

**Search Parts in this Series**

[3094Series](#)

**Mates With**

[5051](#) , [7534](#)

**Solder Process Data**

Lead-free Process Capability

Wave Capable (TH only)

**Material Info**

Old Part Number

3094-10A

**Reference - Drawing Numbers**

Product Specification

PS-3094-001, PS-3094-002, PS-99020-0088

Sales Drawing

SD-3094-NA, SDAE-3094-N\*(\*)

This document was generated on 04/15/2010

**PLEASE CHECK [WWW.MOLEX.COM](http://WWW.MOLEX.COM) FOR LATEST PART INFORMATION**

8 7 6 5 4 2 1

ENG. NO. 22-05-1\*\*1 SD -3094-NA

EDP NO. 22-05-1\*\*1

MM DIMENSIONS IN METRIC DO NOT SCALE DRAWING

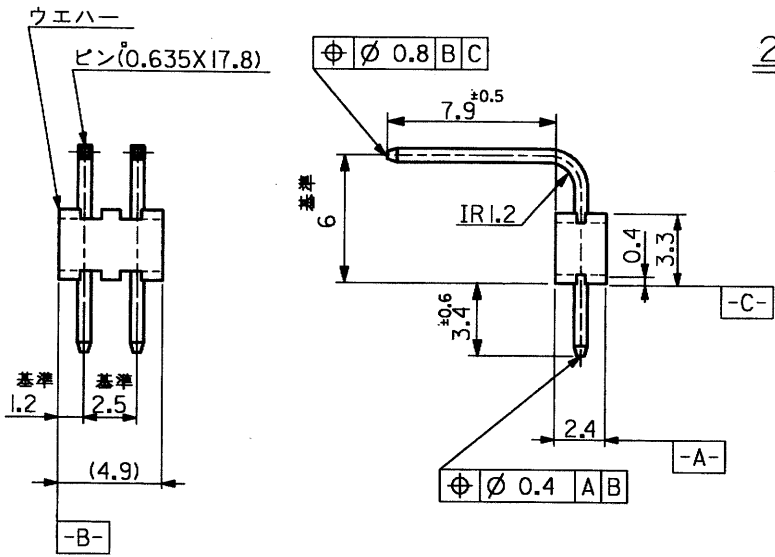

2 極

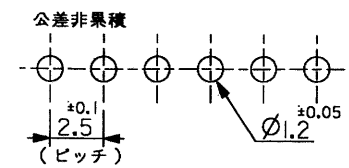

基板取付穴推奨寸法

NOTES:

1. ウエハーのソリは、長さ 25.4mm に対して 0.2mm MAX.
2. ( ) 内寸法は参考値。

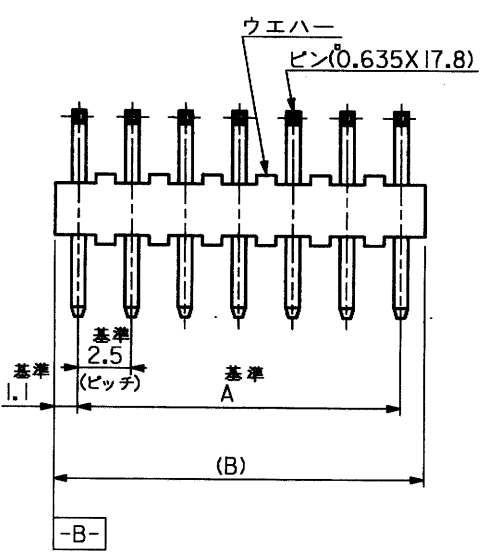

3 極 ~ 20 極

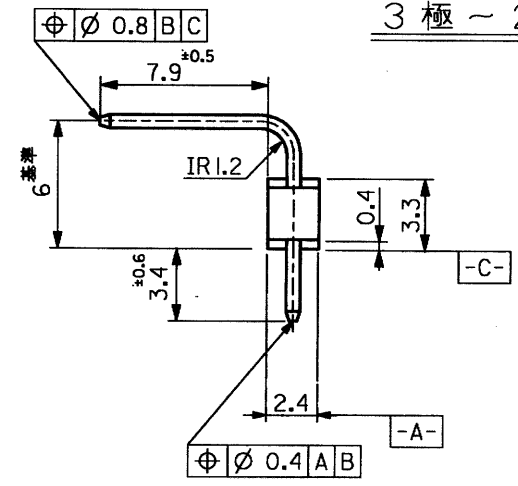

47.5	49.7	22-05-1201	3094-20A	20
45	47.2	-1191	-19A	19
42.5	44.7	-1181	-18A	18
40	42.2	-1171	-17A	17
37.5	39.7	-1161	-16A	16
35	37.2	-1151	-15A	15
32.5	34.7	-1141	-14A	14
30	32.2	-1131	-13A	13
27.5	29.7	-1121	-12A	12
25	27.2	-1111	-11A	11
22.5	24.7	-1101	-10A	10
20	22.2	-1091	-09A	9
17.5	19.7	-1081	-08A	8
15	17.2	-1071	-07A	7
12.5	14.7	-1061	-06A	6
10	12.2	-1051	-05A	5
7.5	9.7	-1041	-04A	4
5	7.2	-1031	-03A	3
2.5	4.9	22-05-1021	3094-02A	2
A	(B)	EDP. NO.	ENG. NO.	極数

角度 ANGLE	±3°			
30 以上 OVER	±0.3	J	REVISED BY	Y. M
10 以上 OVER 30 UNDER	±0.25	H	REDRAWN W/O CHANGE	K.K
10 未満 UNDER	±0.2		ECN NO. 4648	1/9
一般公差 GENERAL TOLERANCES			変更内容 REVISION RECORD	DR. 日付 DATE

材料 MATERIAL	ウエハー: 66ナイロン, UL94V-0
仕上げ FINISH	—
適用電線範囲 WIRE RANGE	—
適用外径 INS. RANGE	—
DRAWN BY	K. KAMATA
CHK'D BY	
APP'D BY	
尺度 SCALE	4 - 1

MOLEX-JAPAN CO., LTD. 日本モレックス株式会社	
EDP. NO.	22-05-1**1
ENG. NO.	SD -3094-NA
TITLE 名称	K.K. 2.5 WAFER ASS'Y
REV	J

THIS DRAWING CONTAINS INFORMATION THAT IS PROPRIETARY TO MOLEX/JAPAN AND SHOULD NOT BE USED WITHOUT WRITTEN PERMISSION  
本図面は日本モレックス(株)の所有する情報を含むもので当社の許可なく複製を禁止する。

PART NO. SEE CHART  
 DWG. NO. SDAE-3094-N\*(\*)

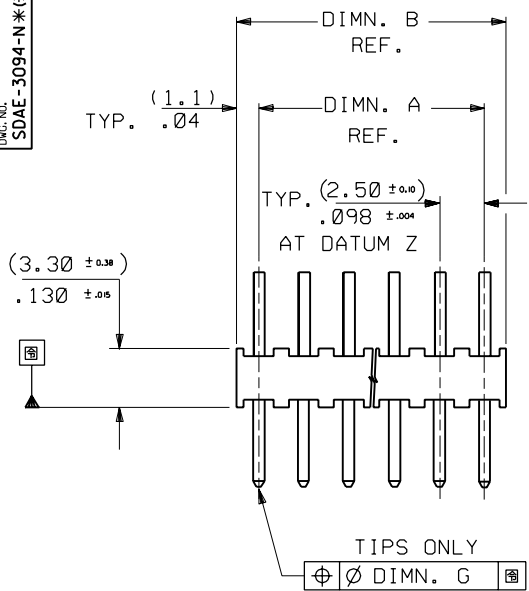

TERMINAL PIN, (0.64) / .025 SQ. FOR PART NOS, PLATING & MATERIAL SEE CHARTS

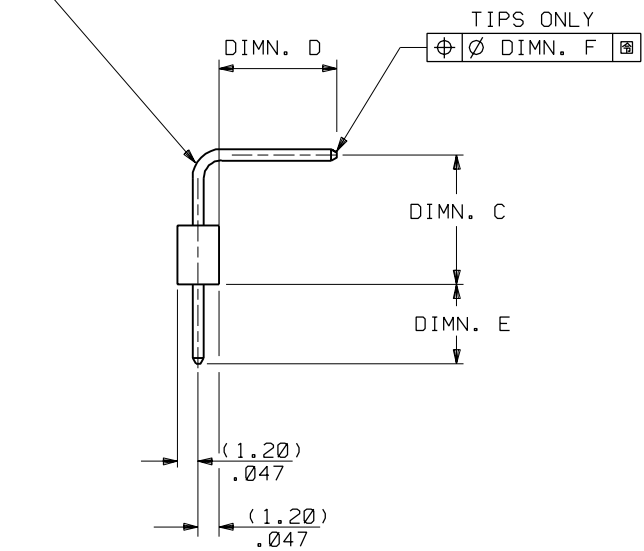

AE-3094-N\*(\*)  
 PLATING CODE WHERE APPLICABLE  
 NO. OF CKTS. | VERSION

NOTES:

1. WAFER MATL. NYLON 6/6, 94V-0.
2. PIN PUSH OUT FORCE (0.907 KG)/2 LBS. MIN.
3. PARTS ARE STACKABLE END TO END AND SIDE TO SIDE ON (2.50) / .098 CENTRES.
4. FOR DIMENSIONS C, D, E, F & G SEE SUBSEQUENT SHEETS.
5. PINS MUST CONFORM TO MOLEX SOLDERABILITY SPEC. ES-152.

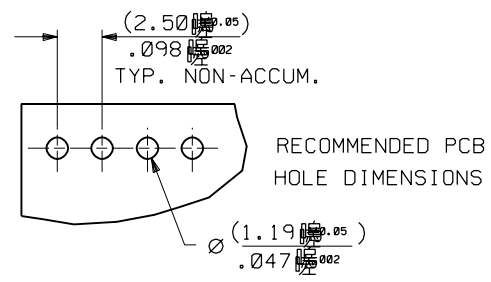

20	喉47.50 ± 0.25 1.870 ± 0.010	喉49.70 ± 0.16 1.957 ± 0.014
19	喉45.00 ± 0.20 1.772 ± 0.009	喉47.20 ± 0.33 1.858 ± 0.013
18	喉42.50 ± 0.20 1.673 ± 0.009	喉44.70 ± 0.10 1.760 ± 0.013
17	喉40.00 ± 0.20 1.575 ± 0.008	喉42.20 ± 0.10 1.662 ± 0.012
16	喉37.50 ± 0.20 1.476 ± 0.008	喉39.70 ± 0.10 1.563 ± 0.012
15	喉35.00 ± 0.20 1.378 ± 0.008	喉37.2 ± 0.10 1.462 ± 0.012
14	喉32.50 ± 0.20 1.280 ± 0.007	喉34.70 ± 0.10 1.367 ± 0.011
13	喉30.00 ± 0.18 1.181 ± 0.007	喉32.20 ± 0.10 1.268 ± 0.011
12	喉27.50 ± 0.18 1.083 ± 0.007	喉29.70 ± 0.10 1.169 ± 0.011
11	喉25.00 ± 0.15 .984 ± 0.006	喉27.20 ± 0.10 1.071 ± 0.010
10	喉22.50 ± 0.15 .886 ± 0.006	喉24.70 ± 0.10 .972 ± 0.010
9	喉20.00 ± 0.13 .787 ± 0.005	喉22.20 ± 0.10 .874 ± 0.009
8	喉17.50 ± 0.13 .689 ± 0.005	喉19.70 ± 0.10 .776 ± 0.009
7	喉15.00 ± 0.13 .591 ± 0.005	喉17.20 ± 0.10 .677 ± 0.009
6	喉12.50 ± 0.10 .492 ± 0.004	喉14.70 ± 0.10 .578 ± 0.009
5	喉10.00 ± 0.10 .394 ± 0.004	喉12.20 ± 0.10 .480 ± 0.008
4	喉7.50 ± 0.10 .295 ± 0.004	喉9.70 ± 0.10 .382 ± 0.008
3	喉5.00 ± 0.10 .197 ± 0.004	喉7.20 ± 0.10 .284 ± 0.008
2	喉2.50 ± 0.10 .098 ± 0.004	喉4.70 ± 0.10 .185 ± 0.008
NO. OF CCTS.	DIMN. A	DIMN. B

2	G
1	J
	SH. REV.

REVISE ONLY ON CAD SYSTEM

CAD/CAM FILENAME: SA3094X1 DGN

TITLE: WAFER ASSY, RT. ANGLE (2.50) / .098 CENTRES (0.64) / .025 SQ. PIN

MOLEX EUROPE | SHEET NO. 1 OF 2 | DATE 9 / 2 / 88

PART NO. SEE CHART | DWG NO. SDAE-3094-N\*(\*) | SIZE B

FOR PREVIOUS DRAWING ISSUES SEE MRI.

ECN E00230  
 COLOUR CHANGE  
 90.NOV.29 P.M.M

REVISIONS

DIMENSIONS SHOWN ( METRIC ) INCH	
UNLESS OTHERWISE SPECIFIED TOLERANCES: ANGULAR ± 1/2°	
INCH	( METRIC )
3 PLACE ± .010	
2 PLACE ± .014	± 0.25
1 PLACE	± 0.35

DRAFT WHERE APPLICABLE MUST REMAIN WITHIN DIMENSIONS

DESIGN DIMENSION (PRIMARY)  (MM)  IN.

EQUIVALENT DIMENSION (SECONDARY)  (MM)  IN.

DRWG BY: MCC  
 CHK'D BY:  
 APP'D BY:  
 SCALE: 4:1

PART NO. SEE CHART  
 DWG. NO. SDAE-3094-N\*(\*)

PIN MATERIAL	
DIMn. C	± (0.51) .020
DIMn. D	± (1.02) .040
DIMn. E	± (0.51) .020
DIMn. F	
DIMn. G	
No. OF CCTS.	
2	
3	
4	
5	
6	
7	
8	
9	
10	
11	
12	
13	
14	
15	
16	
17	
18	
19	
20	
PLATING TO E.S. 88	

AE-3094-NA		
BRASS		
	(5.95)/.234	
	(7.50)/.295	
	(3.43)/.135	
	(0.76)/.030	
	(0.38)/.015	
PART No.	ENG. No.	
22-05-1021	AE-3094-	2 A
↑ 1031	↑	3 A
1041		4 A
1051		5 A
1061		6 A
1071		7 A
1081		8 A
1091		9 A
1101		10 A
1111		11 A
1121		12 A
1131		13 A
1141		14 A
1151		15 A
1161		16 A
1171		17 A
1181		18 A
1191		19 A
22-05-1201	AE-3094-	20 A
(0.005)/.0002 MIN. ELECTRO-TIN OVER (0.0025)/.0001 MIN. COPPER		

AE-3094-NAG		
BRASS		
	(5.95)/.234	
	(7.50)/.295	
	(3.43)/.135	
	(0.76)/.030	
	(0.38)/.015	
PART No.	ENG. No.	
22-12-1021	AE-3094-	2 AG
↑ 1031	↑	3 AG
1041		4 AG
1051		5 AG
1061		6 AG
1071		7 AG
1081		8 AG
1091		9 AG
1101		10 AG
1111		11 AG
1121		12 AG
1131		13 AG
1141		14 AG
1151		15 AG
1161		16 AG
1171		17 AG
1181		18 AG
1191		19 AG
22-12-1201	AE-3094-	20 AG
(0.0005)/.00002 MIN. GOLD OVER (0.00076)/.00003 MIN. NICKEL		

AE-3094-NF		
BRASS		
	(4.00)/.157	
	(9.86)/.388	
	(3.10)/.122	
	(0.76)/.030	
	(0.38)/.015	
PART No.	ENG. No.	
22-05-1029	AE-3094-	2 F
↑ 1039	↑	3 F
1049		4 F
1059		5 F
1069		6 F
1079		7 F
1089		8 F
1099		9 F
1109		10 F
1119		11 F
1129		12 F
1139		13 F
1149		14 F
1159		15 F
1169		16 F
1179		17 F
1189		18 F
1199		19 F
22-05-1209	AE-3094-	20 F
(0.005)/.0002 MIN. ELECTRO-TIN OVER (0.0025)/.0001 MIN. COPPER		

AE-3094-NT(102)		
PHOS. BRONZE		
	(4.00)/.157 ± (0.38) .015	
	(15.68)/.617	
	(3.50)/.138	
	(0.76)/.030	
	(0.38)/.015	
PART No.	ENG. No.	
NOT TOOLED	AE-3094-	2 T (102)
38-00-1446	↑	3 T ↑
NOT TOOLED		4 T
38-00-1447		5 T
38-00-1448		6 T
38-00-1449		7 T
NOT TOOLED		8 T
NOT TOOLED		9 T
38-00-1450		10 T
NOT TOOLED		11 T
↑		12 T
		13 T
		14 T
		15 T
		16 T
		17 T
		18 T
↓		19 T ↓
NOT TOOLED	AE-3094-	20 T (102)
(0.005)/.0002 MIN. ELECTRO-TIN OVER (0.0025)/.0001 MIN. COPPER		

FOR PREVIOUS DRAWING ISSUES SEE MRI.

G SEE SHEET I.

LTR	REVISIONS	DIMENSIONS SHOWN ( METRIC ) INCH UNLESS OTHERWISE SPECIFIED TOLERANCES: ANGULAR ± 1/2°	DRWG BY <b>MCC</b>
		INCH ( METRIC )	CHK'D BY
		3 PLACE ± .010 ± .025 2 PLACE ± .014 ± .025 1 PLACE ± .035	APP'D BY
		DRAFT WHERE APPLICABLE MUST REMAIN WITHIN DIMENSIONS	SCALE
	DESIGN DIMENSION ( PRIMARY ) <input checked="" type="checkbox"/> IN. <input type="checkbox"/> MM		
	EQUIVALENT DIMENSION ( SECONDARY ) <input type="checkbox"/> IN. <input checked="" type="checkbox"/> MM		

REVISE ONLY ON CAD SYSTEM		SH.	REV.
CAD/CAM FILENAME SA3094X2 DGN		THIS DRAWING CONTAINS INFORMATION THAT IS PROPRIETARY TO MOLEX INC. & SHOULD NOT BE USED WITHOUT WRITTEN PERMISSION	
TITLE <b>WAFER ASSY, RT. ANGLE (2.50)/.098 CENTRES (0.64)/.025 SQ. PIN</b>			
MOLLEX MOLEX EUROPE		SHEET NO. DATE 20F2 5 /2 /88	
PART NO. <b>SEE CHART</b>	DWG NO. SDAE-3094-N*(*)	SIZE B	