



**Model Number**

SB2-Z0 GELB

**Features**

- 2 mm slot width
- Basic series
- 2-wire sensor

**Connection**

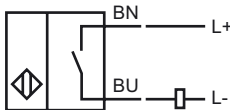

**Dimensions**

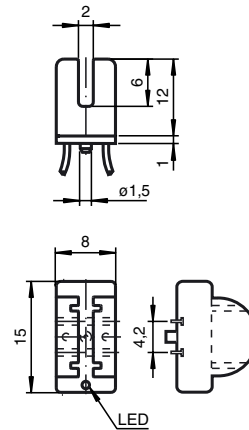

**Technical Data**

**General specifications**

Switching element function	DC	NO
Slot width	2 mm	
Depth of immersion (lateral)	5 ... 7	
Installation	not embeddable	
Output polarity	DC	

**Nominal ratings**

Operating voltage	$U_B$	5 ... 30 V DC
Switching frequency	$f$	0 ... 2000 Hz
Hysteresis	$H$	0 ... 0.05 mm
Reverse polarity protected	tolerant	
Short-circuit protection	pulsing	
Voltage drop	$U_d$	$\leq 4.9$ V
Operating current	$I_L$	2 ... 50 mA
Off-state current	$I_r$	0 ... 0.5 mA typ.
Indication of the switching state	LED, yellow	

**Ambient conditions**

Ambient temperature	-25 ... 70 °C (-13 ... 158 °F)
---------------------	--------------------------------

**Mechanical specifications**

Connection type	flexible leads LIFYW , 500 mm
Core cross-section	0.06 mm <sup>2</sup>
Housing material	PBT
Protection degree	IP67

**Compliance with standards and directives**

Standard conformity	
Standards	EN 60947-5-2:2007 IEC 60947-5-2:2007

**Approvals and certificates**

UL approval	cULus Listed, General Purpose
CSA approval	cCSAus Listed, General Purpose
CCC approval	Products with a maximum operating voltage of $\leq 36$ V do not bear a CCC marking because they do not require approval.

Release date: 2010-11-16 09:25 Date of issue: 2010-11-18 105928\_ENG.xml