

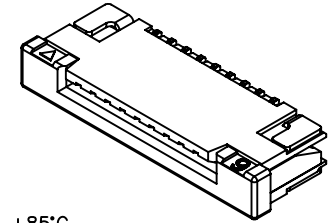

P/N LEGEND

F1003 WR-S-XP N L N XX X TO R
 ① ② ③ ④ ⑤ ⑥ ⑦ ⑧ ⑨ ⑩ ⑪

- ① Series No.
- ② Connector type: WR=Right angle
- ③ Mounting type: S=SMT
- ④ No. of circuits
- ⑤ N=Halogen Free
- ⑥ Material: L=LCP
- ⑦ Color: N=Natural(Beige)
- ⑧ Plating code for contacts:
T1=Matte Tin-plated; G1=Gold-flash
- ⑨ Plating code for solder tabs:
T=Matte Tin-plated; G=Gold-flash
- ⑩ Option code: T0=Top contact style
- ⑪ Packing code:
R=Tape & Reel(Without Cap or Mylar)



SPECIFICATIONS

Current Rating: 0.5A AC,DC
 Voltage Rating: 50V AC,DC
 Temperature Range: -25°C ~ +85°C
 Contact Resistance: 30mΩ Max.
 Insulation Resistance: 500MΩ Min.
 Withstanding Voltage: 500V AC/minute
 Contacts: Phosphor Bronze/Matte Tin-plated or Gold-flash
 Solder Tabs: Brass/Matte Tin-plated or Gold-flash
 Housing: LCP,UL94V-0,Natural(Beige)
 Actuator: Nylon 6T,UL94V-0,Natural(Black)

| Circuit No. | Dimensions | | | Circuit No. | Dimensions | | |
|-------------|------------|-------|-------|-------------|------------|-------|-------|
| | A | B | C | | A | B | C |
| 04P | 3.00 | 11.00 | 5.10 | 20P | 19.00 | 27.00 | 21.10 |
| 05P | 4.00 | 12.00 | 6.10 | 21P | 20.00 | 28.00 | 22.10 |
| 06P | 5.00 | 13.00 | 7.10 | 22P | 21.00 | 29.00 | 23.10 |
| 07P | 6.00 | 14.00 | 8.10 | 23P | 22.00 | 30.00 | 24.10 |
| 08P | 7.00 | 15.00 | 9.10 | 24P | 23.00 | 31.00 | 25.10 |
| 09P | 8.00 | 16.00 | 10.10 | 25P | 24.00 | 32.00 | 26.10 |
| 10P | 9.00 | 17.00 | 11.10 | 26P | 25.00 | 33.00 | 27.10 |
| 11P | 10.00 | 18.00 | 12.10 | 27P | 26.00 | 34.00 | 28.10 |
| 12P | 11.00 | 19.00 | 13.10 | 28P | 27.00 | 35.00 | 29.10 |
| 13P | 12.00 | 20.00 | 14.10 | 29P | 28.00 | 36.00 | 30.10 |
| 14P | 13.00 | 21.00 | 15.10 | 30P | 29.00 | 37.00 | 31.10 |
| 15P | 14.00 | 22.00 | 16.10 | 31P | 30.00 | 38.00 | 32.10 |
| 16P | 15.00 | 23.00 | 17.10 | 32P | 31.00 | 39.00 | 33.10 |
| 17P | 16.00 | 24.00 | 18.10 | 33P | 32.00 | 40.00 | 34.10 |
| 18P | 17.00 | 25.00 | 19.10 | 34P | 33.00 | 41.00 | 35.10 |
| 19P | 18.00 | 26.00 | 20.10 | | | | |

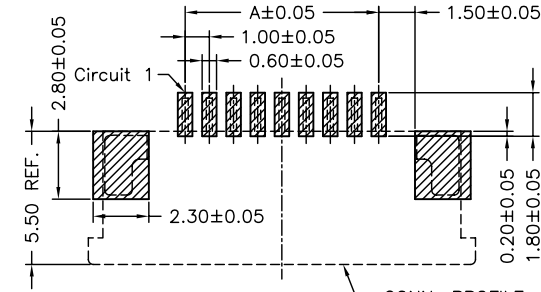

SUGGESTED PCB LAYOUT (TOP VIEW)

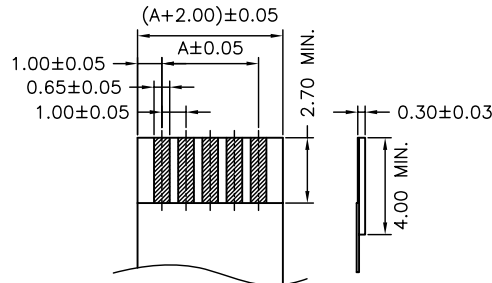

RECOMMENDED FFC/FPC DIMENSION

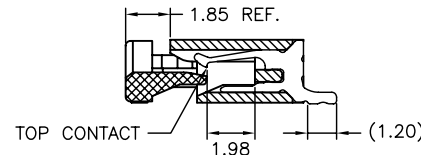

(ACTUATOR OPEN)

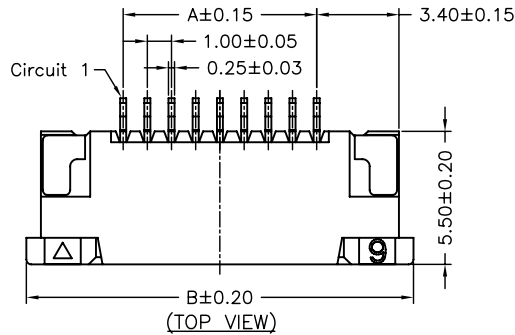

(TOP VIEW)

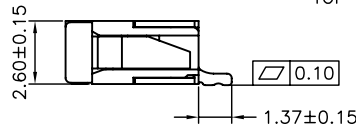

MATED CONDITION

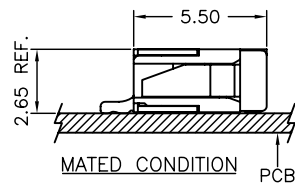

PCB

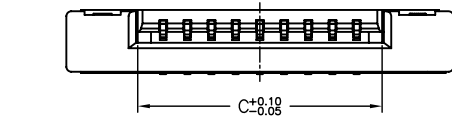

(TOP VIEW)

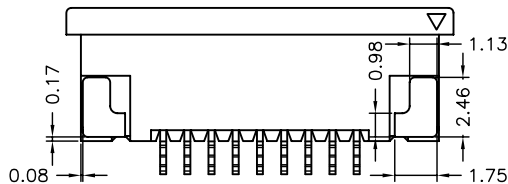

| | | | | | | |
|------|--------------|------------|-------|--|--------|--|
| | | | | | | |
| | | | | 燦達電子工業股份有限公司 JOINT TECH ELECTRONIC IND. CO., LTD. | | |
| | | UNIT | SCALE | SHEET | | TITLE: |
| | | mm | 1 : 1 | 1 of 2 | | |
| | | DRAWN BY | | APPROVED BY | | 1.00mm PITCH FFC/FPC CONNECTOR, 90° SMT TYPE, ZIF, TOP CONTACT STYLE |
| | | 王自友 | | 董正一 | | |
| | | 2009.11.26 | | 2009.11.26 | | |
| | | | | GENERAL TOLERANCE | | |
| A2 | EN1011150264 | 2010.11.15 | 權生新 | X.X±0.25 | ANGLE± | |
| A1 | EN1008170218 | 2010.08.16 | 權生新 | X.XX±0.15 | | |
| REV. | DESCRIPTION | DATE | NAME | X.XXX±0.05 | | |
| | | | | | | DRAW NO. : |
| | | | | | | F1003WR-S-XPXXXXXXTOX |
| | | | | | | REV. A2 |