



LED395V-66-16100-110

- UV High Power LED Array
- 395 nm, 8 W
- Chip: 1x1 mm, 16 pcs., InGaN
- TO-66 package, Silicone and/or Epoxy resin
- Viewing Angle: 110°



Description



LED395V-66-16100-100 is composed by 16 pcs. of 1 x 1 mm² high current driven InGaN chip dies, mounted on a metal stem TO-66 and covered with epoxy resin or silicon resin.
It is designed for wide viewing and extremely high output power illuminator.
On forward bias, it emits a power radiation of typical **8 W** at a peak wavelength at **395 nm**.

Maximum Ratings (T_{CASE}=25°C)

Parameter	Symbol	Values		Unit
		Min.	Max.	
Power Dissipation	P_D		32	W
Forward Current	I_F		2	A
Reverse Voltage	V_F		20	V
Operating Temperature	T_{CASE}	- 30	+ 80	°C
Storage Temperature	T_{STG}	- 30	+ 100	°C
Lead Solder Temperature *	T_{SLD}		+ 265	°C

* must be completed within 3 seconds

Electro-Optical Characteristics (T_{CASE}=25°C)

Parameter	Symbol	Conditions	Values			Unit
			Min.	Typ.	Max.	
Peak Wavelength	λ_P	$I_F=2A$	385	395	405	nm
Half Width	$\Delta\lambda$	$I_F=2A$		12		nm
Forward Voltage	V_F	$I_F=2A$		15.5		V
Radiated Power *	P_O	$I_F=2A$		8		W
Viewing Angle	φ	$I_F=100mA$		110		deg.

* measured by S3584-08



Typical Performance Curves

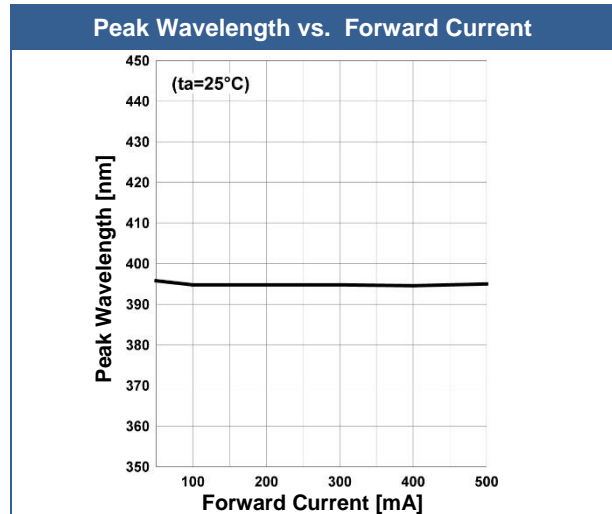
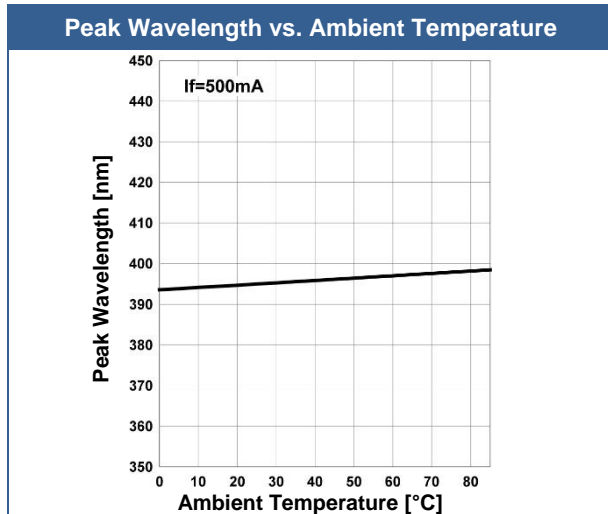
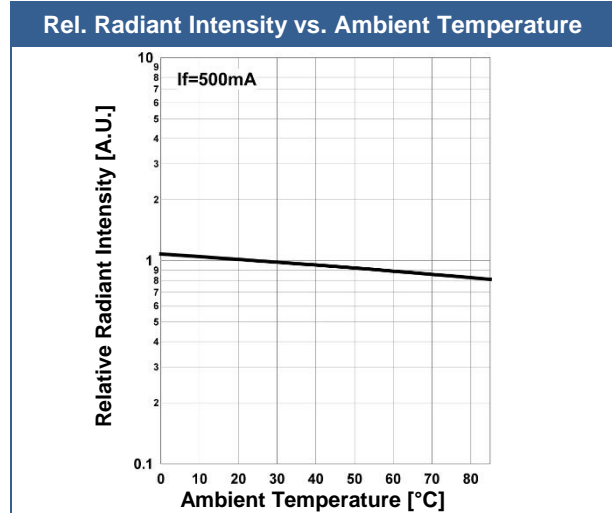
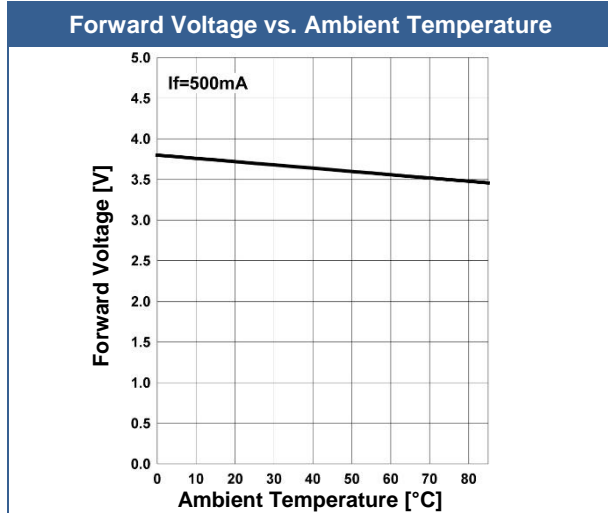
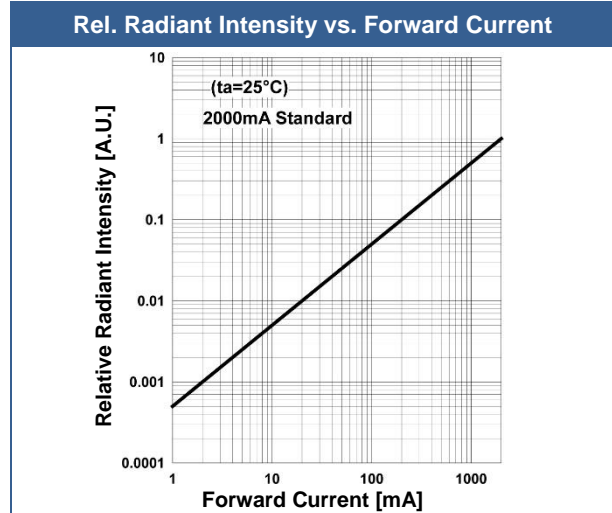
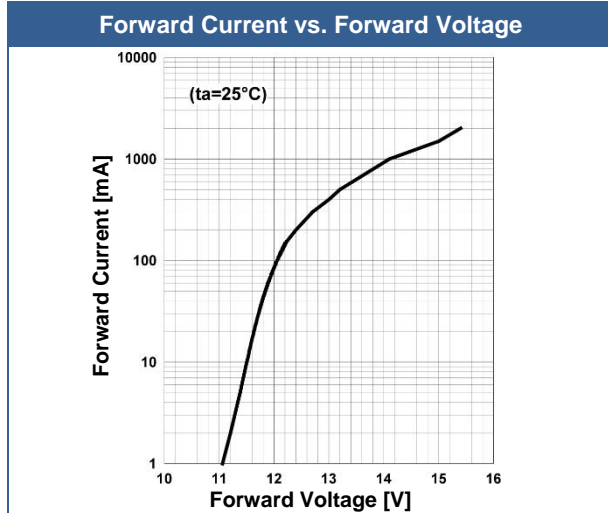

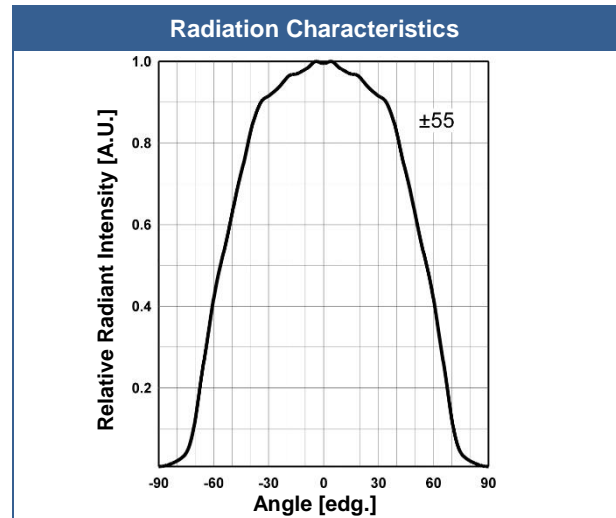
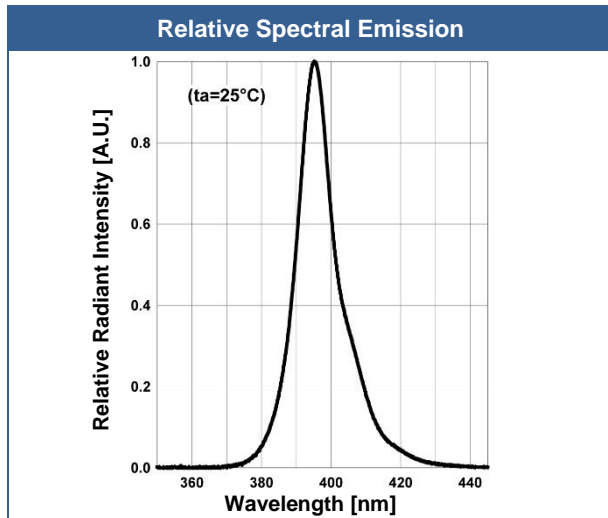

Outline Dimensions

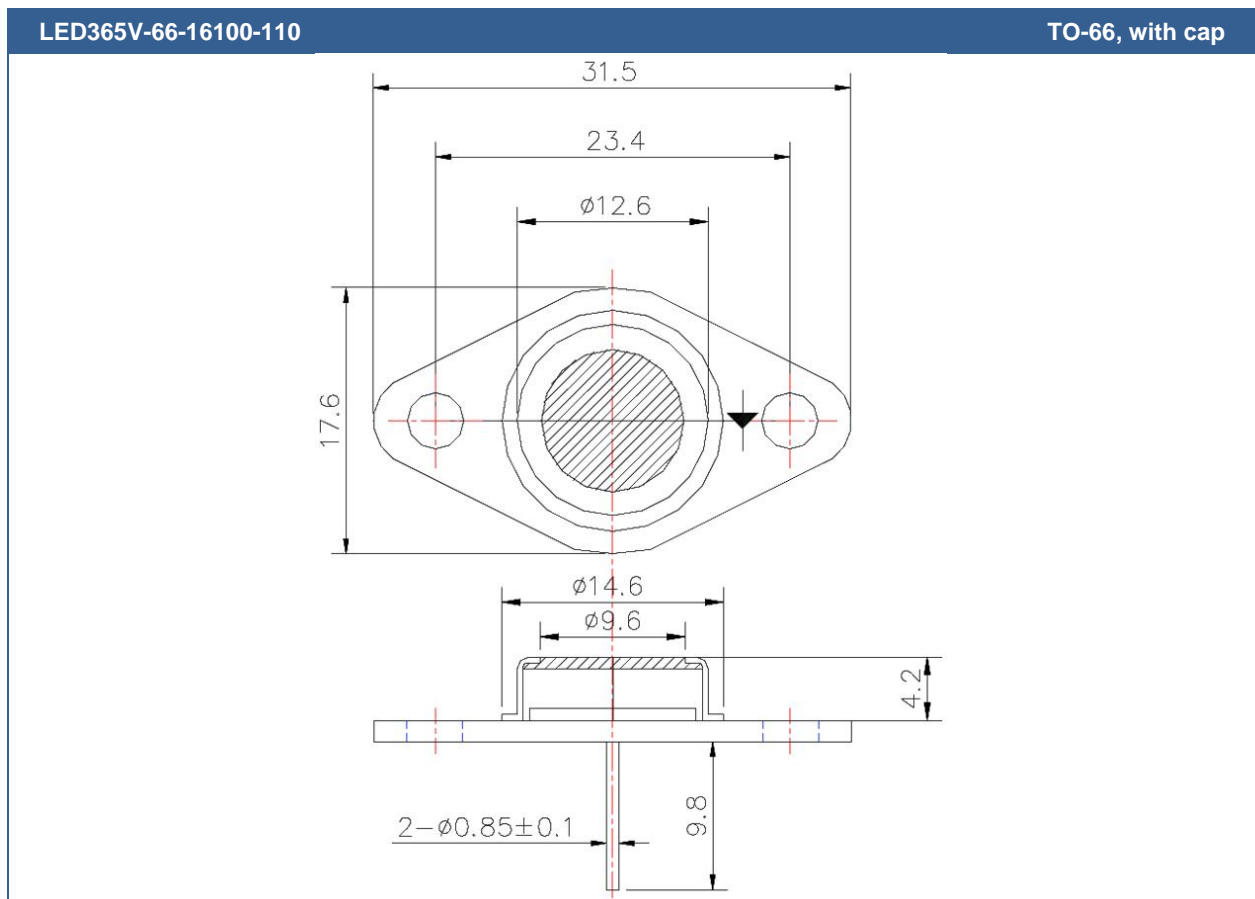

All Dimensions in mm



Precautions

Cautions:

- This high power LED must be cooled!
- NOT look directly into the emitting area of the LED during operation!

Soldering:

- Do avoid overheating of the LED
- Do avoid electrostatic discharge (ESD)
- Do avoid mechanical stress, shock, and vibration
- Do only use non-corrosive flux
- Do not apply current to the LED until it has cooled down to room temperature after soldering

Cleaning:

Cleaning with isopropyl alcohol, propanol, or ethyl alcohol is recommended

DO NOT USE acetone, chloroform, trichloroethylene, or MKS

DO NOT USE ultrasonic cleaners

Static Electricity:

LEDs are sensitive to electrostatic discharge (ESD). Precautions against ESD must be taken when handling or operating these LEDs. Surge voltage or electrostatic discharge can result in complete failure of the device.

Radiation:

During operation these LEDs do emit **high intensity light**, which is hazardous to skin and eyes, and may cause cancer. Do avoid exposure to the emitted light. **Protective glasses are recommended.** It is further advised to attach a warning label on products/systems.

Operation:

Do only operate LEDs with a current source.

Running these LEDs from a voltage source will result in complete failure of the device.

Current of a LED is an exponential function of the voltage across it. Usage of current regulated drive circuits is mandatory.