

APPROVED: \_\_\_\_\_  
 DATE: \_\_\_\_\_ TITLE: \_\_\_\_\_

Rev	AWO #	Description	Date	Appr
-		RELEASED	3/30/04	
A		CORRECTED SCREWS LOCATION	10/13/05	BAS
B		ADDED DIM.	9/27/10	

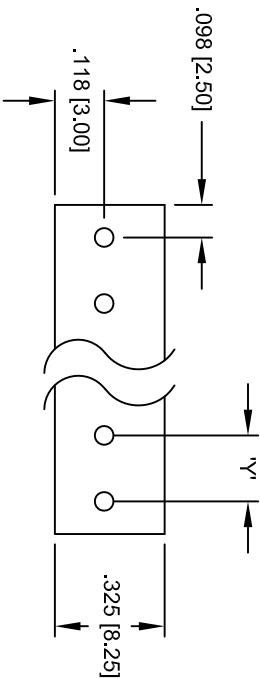

RECOMMENDED  
PCB LAYOUT

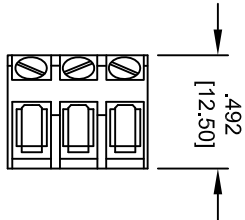
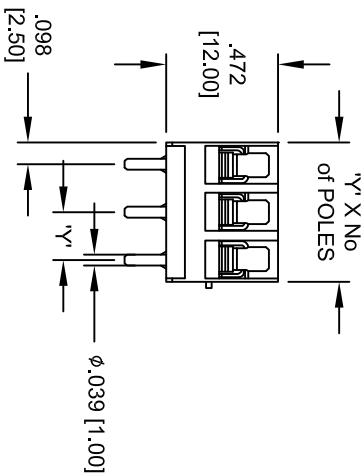
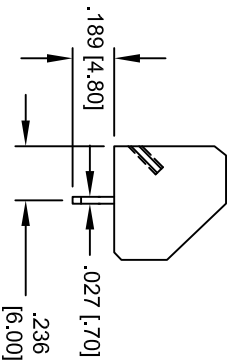

REPLACE 'Y' WITH PITCH  
 C = .197 [5.00] D = .200 [5.08] H = .394 [10.00]

**SPECIFICATIONS:**  
 Material: Nylon, rated UL 94V-0  
 Insulator color: Black  
 Electrical:  
 Operating voltage: 300V AC max  
 Current rating: 10 Amps max per Pole  
 Insulation resistance: 5000 Mohms min @ 1000V  
 Dielectric withstanding voltage: 1500 VAC for 1 minute  
 Mechanical:  
 Wire range: 14-22 awg  
 Torque: 4 Kg.cm (max.)  
 Environmental:  
 Operating temperature: -55°C to +105°C  
 Lead free, RoHS Compliant  
 Recommended soldering temp: 235°C for 5 seconds

Operating temperature: -55°C to +105°C  
 Lead free, RoHS Compliant  
 Recommended soldering temp: 235°C for 5 seconds



UNLESS OTHERWISE SPECIFIED  
 ALL DIMENSIONS ARE INCHES [MM]  
 TOLERANCES: EXCEPT AS NOTED  
 INCHES Holes

.X	± .10	Ø.X	± .10
.XX	± .020	Ø.XX	± .015
.XXX	± .015	Ø.XXX	± .010

APPROVALS

DRAWN	SLS	3/30/04
CHECKED		
APPROVED		

**ADAM TECH**  
 909 Rahway Avenue, Union, NJ 07083  
 Phone: 908-687-5000 Fax: 908-687-5710

TITLE: EURO BLOCK, VERTICAL, ANGLED ENTRY  
 MULTIPLE PITCHES

SIZE	PART NO.	REV.
X	EBC-XX-X	-
REF:	SCALE: NTS	SHEET 1 OF 1