

环保物料

TEL:0769-82001899

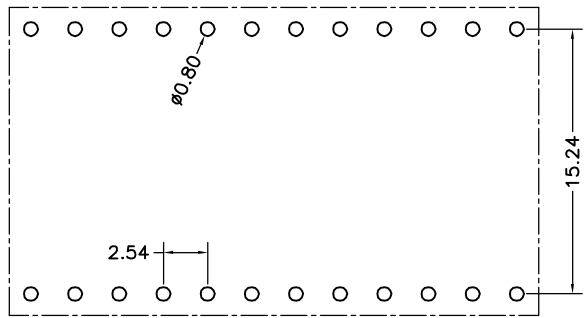
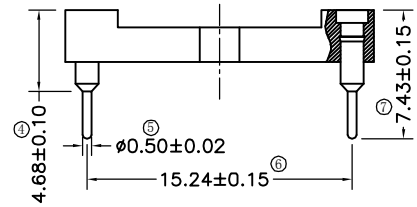
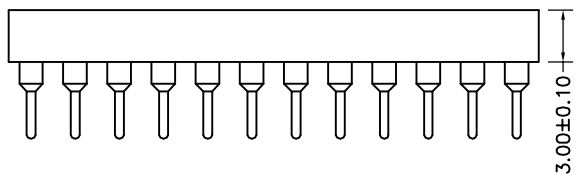
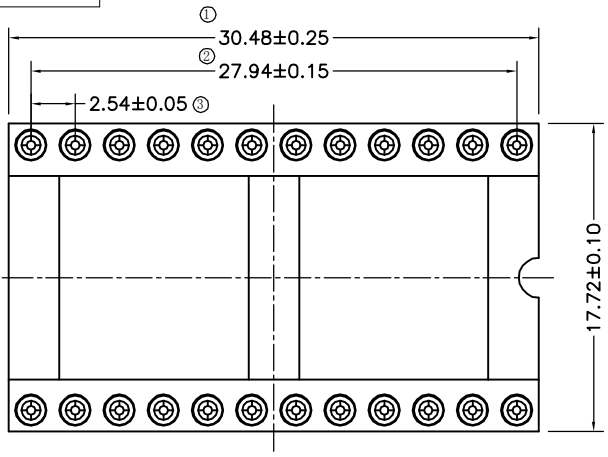

P. C. B LAYOUT

Technical Data  
 Material:  
 Pin(outer sleeve):Brass,machined CuZn38Pb2  
 Plating(outer sleeve):  
 Tin Plated:2μm/80μ"NI, 5μm/200μ"Sn  
 Gold Plated:2μm"/80μ"Ni, 0.8μ" gold  
 Plating(Contact ):2μm/80μ"NI, gold or Tin plated  
 Insuiator:PPS UL94V-0  
 ClIp(Contact 4 Flnger):Beryllium copper,heat teated

Electrical:  
 Current rating:3Amps/contact max.  
 Contact resistance:≤4mΩ/contact  
 Insuiation resistance:≥1000MΩ at V=100V  
 Operaing voltage:60VAC/DC

Mechanical:  
 Average Insertion force with steel pin of ∅0.432:<250g  
 Average withdrawal force with steel pin of ∅0.432:>70g  
 Mechanical lige cycle:min 200  
 Operaling temperature:-40° C to+105° C  
 Soldering temperature:+255° C  
 Critical Dimensions:⊗

				TOLERANCE UNLESS OTHERWISE		DRAWN	CK tan	<b>XFCN</b> 兴飞连接器有限公司 XFCN CONNECTORS CO.,LTD.	SHEET	1/1	
				X.	±0.30	X°	±5°		CHKD	DATE	2020.04.12
				.X	±0.20	.X°	±2°		APPD	UNITS	mm
				.XX	±0.08	.XX°	±1°		VIEW	SCALE	1:1
AO	MODIFICATION			DRAW	DATE	.XXX	±0.03	.XXX°	±0.5°	DWG NO.	009