

Split ferrite clamp for intermediate frequency range from 3 to 50MHz.

Feature

- Effective for suppression both of conducted noise up to 30MHz and radiated noise over 30MHz.
- Split ferrite clamp with plastic housing enables to attach assembled cable and cables with connector.
- Cable tie can assist to hold electric wires and enables the product to be fixed to wire harness. (Excluding KRFC-4)
- Wire guiding system prevent wires from being pinched when winding assembly.

Material

- Ferrite Core: Soft ferrite
- Housing: PA66 (Color: natural / Flammability: UL94V-0)

Profile : ①

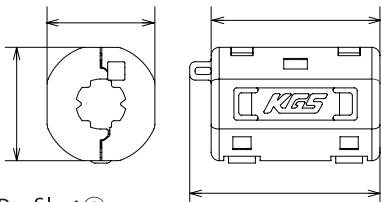

Profile : ②

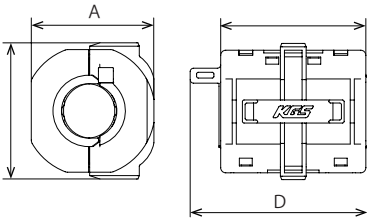

Unit: mm

Part No.		A	B	C	D	Applicable cable diameter	Impedance(Ω) 100MHz (1 Turn)
KRFC-4	①	13.7	13.5	27.5	-	ϕ 3.5~4.5	\geq 70
KRFC-6	①	18.1	18.4	31.5	35.5	ϕ 5.5~6.5	\geq 110
KRFC-8	①	20.1	20.4	31.5	35.5	ϕ 7.5~8.5	\geq 80
KRFC-9	①	20.1	20.4	31.5	35.5	ϕ 8.5~9.5	\geq 80
KRFC-10	①	26.3	26.4	32.4	37.2	ϕ 9.5~10.5	\geq 120
KRFC-13	①	29.1	29.4	31.5	36.3	ϕ 12.5~13.5	\geq 105
KRFC-15	②	36.1	40.1	42.8	52.3	Max ϕ 15.5	\geq 221

※1)P/N for the product with fixture : KRFC2-15



● Impedance vs Frequency characteristic (Number of turns in the wire: 1 turn)

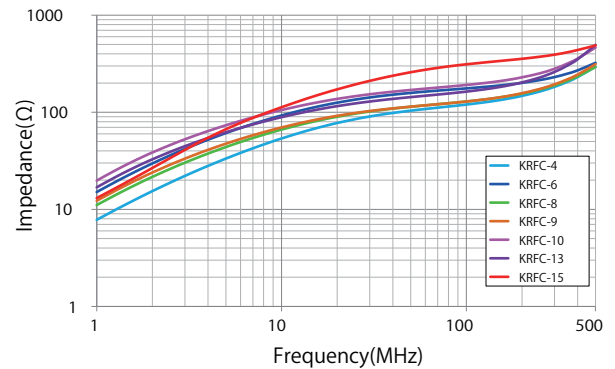
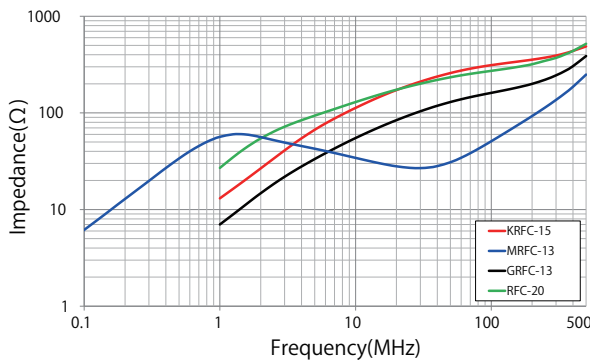

● All specifications and characteristics shown herein are typical values, but are not guaranteed.
All specifications and characteristics shown herein are subject to change without notice for improvements or changes in specification.