

1. Features

1. This specification applies Low Profile Power Inductors.
2. 100% Lead(Pb) & Halogen-Free and RoHS compliant.
3. High reliability -Reliability tests comply with AEC-Q200
4. Operating temperature-55~+125°C (Including self - temperature rise)

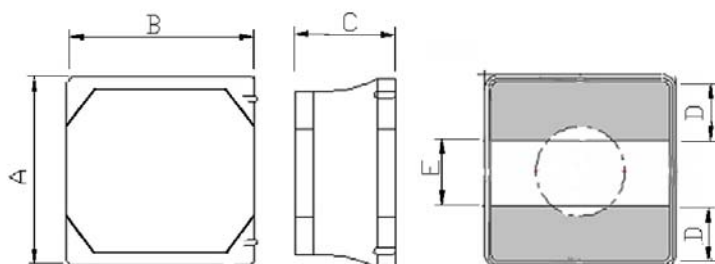

2. Dimension



Series	A(mm)	B(mm)	C(mm)	D(mm)	E(mm)
HPC4010TV	4.0±0.2	4.0±0.2	1.0 max.	1.2 ref.	1.6 ref.

Units: mm

3. Part Numbering

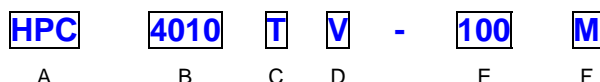

A: Series

B: Dimension

C: Lead Free

D: Category Code

V=Vehicle

E: Inductance

100=10uH

F: Inductance Tolerance

M=±20% ; Y=±30%

4. Specification

TAI-TECH Part Number	Inductance (uH)	Tolerance (%)	Test Frequency (Hz)	SRF (MHz) typ.	DCR (Ω) ±20%	I sat (A)typ.	I sat (A)Max.	I rms (A)typ.	I rms (A)Max.
HPC4010TV-1R0Y	1.0	±30%	1V100K	116	0.056	2.40	2.00	2.30	1.90
HPC4010TV-2R2M	2.2	±20%	1V100K	73	0.085	1.50	1.20	1.80	1.50
HPC4010TV-3R3M	3.3	±20%	1V100K	58	0.100	1.30	1.10	1.70	1.40
HPC4010TV-4R7M	4.7	±20%	1V100K	47	0.140	1.20	0.95	1.50	1.20
HPC4010TV-6R8M	6.8	±20%	1V100K	38	0.200	1.00	0.80	1.20	1.00
HPC4010TV-100M	10	±20%	1V100K	31	0.300	0.80	0.62	0.90	0.75
HPC4010TV-150M	15	±20%	1V100K	24	0.430	0.70	0.54	0.80	0.60
HPC4010TV-220M	22	±20%	1V100K	19	0.570	0.60	0.45	0.80	0.50

Note:

Isat : Based on inductance change (ΔL/L0 : ≤30%) @ ambient temp. 25°C

I rms : Based on temperature rise (ΔT : 40°C typ.) max

