

Kinghelm®

REV.	EDN NO	LOCATIONS	DESCRIPTION	DATE

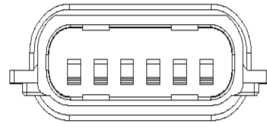
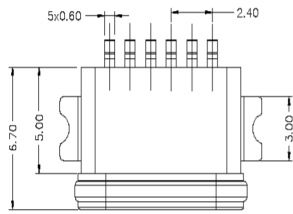

Note:

1.Material:

- 1.1 Housing: LCP
- 1.2 Contact: C5191,t=0.20mm
- 1.3 Shell: Zinc Alloy.

2.ELECTRICAL:

- 2-1:CURRENT RATING:
VBUS AND GND CONTACTS RATED AT 1.25A
PARALLELED FOR A TOTAL OF 5A;
- 2-2:INITIAL CONTACT RESISTANCE :40 MEGOHMS
- 2-3:DIELECTRIC WITHSTANDING VOLTAGE:
100V AC MIN;

3:MECHANICAL CHARACTERISTICS:

- 3-1:MATING FORCE:5~20N
- 3-2:UNMATING FORCE:8~20N(INITIAL),
6~20N(AFTER 10000 CYCLES)
- 3-3:FREQUENCY: 200±50 CYCLES /HOUR,10000 CYCLES
- 3-4:OPERATING TEMPERATURE ;-40°~80°
- 4: WATERPROOF: IP-X7.

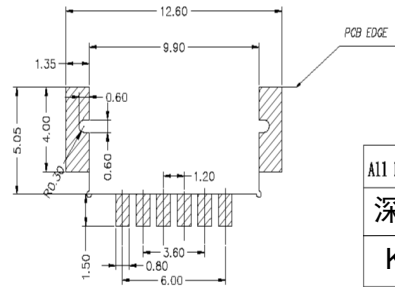
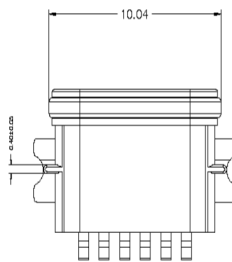
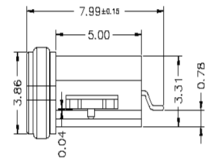
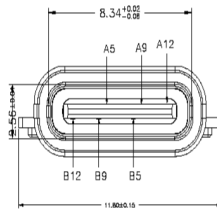

PCB LAYOUT 图仅供参考

料号: B000166-0103-XXX-XX-OX

- "1"表示PBT
- "0"表示黑色
- "1"表示端子镀金 G/F
- R=(卷装)
- H表示无卤
- ..00: 有LOGO
- 01: 没LOGO

TABLE B

A5	CC1	B12	GND
A9	VBUS	B9	VBUS
A12	GND	B5	CC2
PIN	SIGNAL NAME	PIN	SIGNAL NAME

ALL MATERIAL MEET THE FORMAN'S SPC: ENVIRONMENT-RELATED SUBSTANCES MANAGEMENT TECHNICAL STANDARD

深圳市金航标电子有限公司

WWW.BDS666.COM

KH-TYPE-C-FSCB0.8-6P

0755-83044319

<input checked="" type="checkbox"/> RoHS <input checked="" type="checkbox"/> HF	品名 TITLE: 防水TYPE-C 6P 沉板0.8 料号 ITEM NO: B000166-0103-XXX-XX-OX 审核 APPROVE BY: 设计 DESIGN BY: L S W	比例 SCALE 1:1	图号 DWG NO.: B000166-0103 张数 SHEET 1/1 版本 REV. 1 单位 UNITS: mm
--	---	---------------------------	---