

Rev	AWO #	Description	Date	Appr
-		RELEASED	11/8/04	

APPROVED: _____
 DATE: _____ TITLE: _____

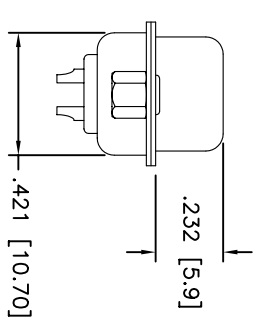
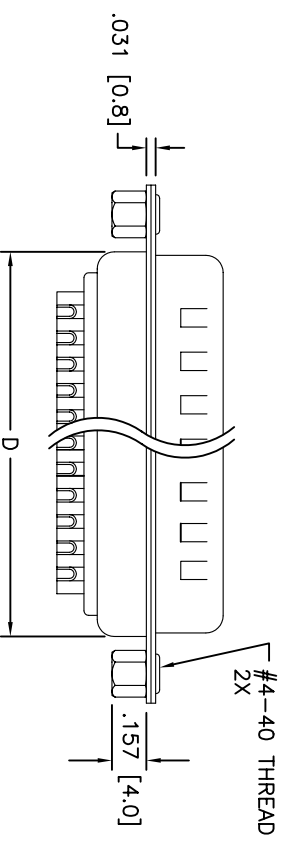
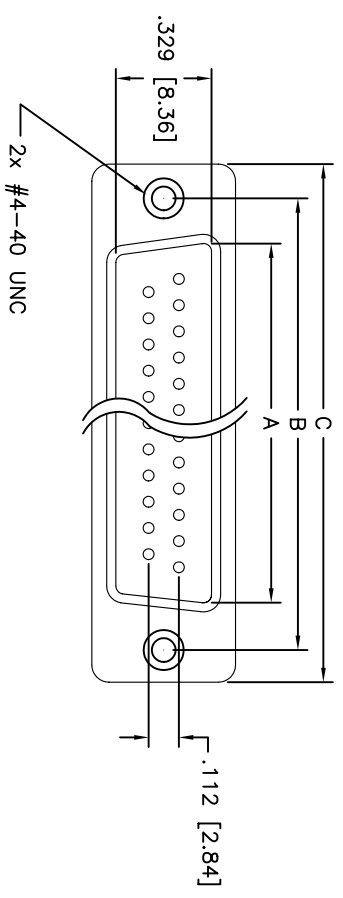

POSITIONS	Plug Dimensions			
	A	B	C	D
9	.666 (16.92)	.984 (24.99)	1.213 (30.81)	.759 (19.28)
15	.994 (25.25)	1.312 (33.32)	1.541 (39.14)	1.083 (27.51)
25	1.534 (38.96)	1.852 (47.04)	2.088 (53.04)	1.625 (41.30)
37	2.182 (55.42)	2.500 (63.50)	2.729 (69.32)	2.272 (57.71)
50	2.079 (52.81)	2.406 (61.11)	2.635 (66.93)	2.178 (55.32)

UNLESS OTHERWISE SPECIFIED
 ALL DIMENSIONS ARE INCHES [MM]
 TOLERANCES: EXCEPT AS NOTED
 INCHES HOLEES ±.10
 .XX ±.020 ØXXX ±.015
 .XXX ±.015 ØXXX ±.010

ADAM TECH
 909 Rahway Avenue, Union, NJ 07083
 Phone: 908-687-5000 Fax: 908-687-5710

TITLE: **SOLDER CUP D-SUB, MALE, RIVITED**
#4-40 CLINCH NUTS

SPECIFICATIONS:
 Material: Insulator: PBT, rated UL 94V-0
 Insulator color: Black
 Contacts: Brass
 Shell: Steel, Nickel plated
 Plating: Gold flash over Nickel underplate overall
 Electrical: Operating voltage: 250 VAC max
 Current rating: 5 Amps max
 Contact resistance: 20 mohms max
 Insulation resistance: 5000 Mohms min @ 500 VDC
 Dielectric withstanding voltage: 1000 VAC for 1 minute
 Temperature Rating: Operating temperature: -55°C to +105°C

APPROVALS	DATE
DRAWN SS	11/8/04
CHECKED	
APPROVED	

SIZE	PART NO.	REV.
X	DXXX+PD-SL	