

**A FEATURES**

- Low cost, high performance choke coils are designed to virtually eliminate line conducted common mode noise.
- 2CX9H series is horizontal configuration of 2CX9, which reduces their height to less than 12.5 mm.
- Operating temperature range from -40°C to +125°C (Including Self-heating)
- Typical applications: switching power supplies and power supply circuits.



**B PART NUMBER SYSTEM**

$\frac{2CX}{1}$      $\frac{9}{2}$     -     $\frac{182}{3}$      $\frac{E}{4}$

<b>1</b>	Series	<b>2</b>	Dimension Code (L*W*H) (mm)	
2CX	Series Code	9 (17×11×17)	9H (17×15.5×12.5)	
<b>3</b>	Inductance Code	<b>4</b>	RoHS Compliant	
182	18×10 <sup>2</sup> μH = 1.8mH			

**C DRAWINGS AND DIMENSIONS**

Schematics

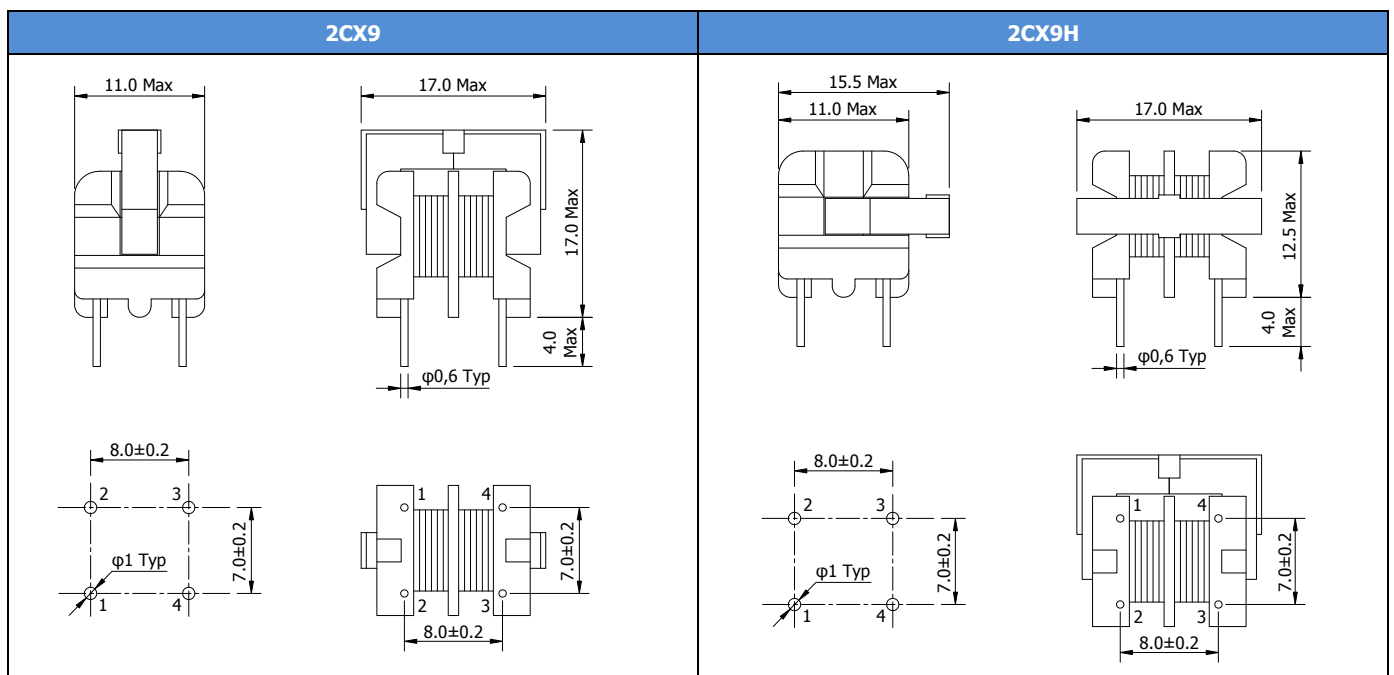
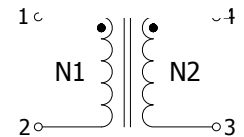

**D SPECIFICATIONS**

Part Number	Inductance <sup>1</sup>		DCR <sup>2</sup>	Ir	U <sub>T</sub>	U <sub>R</sub>
	mH	Tolerance	Max.(Ω)	(A)	V(AC)	V(AC)
2CX9-182F	1.8	+50/-30%	0.31	1.0	2000	250
2CX9-332F	3.3	+50/-30%	0.51	0.8	2000	250
2CX9-562F	5.6	+50/-30%	0.83	0.6	2000	250
2CX9-822F	8.2	+50/-30%	1.30	0.5	2000	250
2CX9-123F	12	+50/-30%	2.00	0.4	2000	250
2CX9-183F	18	+50/-30%	3.10	0.3	2000	250
2CX9-253F	25	+50/-30%	3.60	0.3	2000	250
2CX9H-182F	1.8	+50/-30%	0.31	1.0	2000	250
2CX9H-332F	3.3	+50/-30%	0.51	0.8	2000	250
2CX9H-562F	5.6	+50/-30%	0.83	0.6	2000	250
2CX9H-822F	8.2	+50/-30%	1.30	0.5	2000	250
2CX9H-123F	12	+50/-30%	2.00	0.4	2000	250
2CX9H-183F	18	+50/-30%	3.10	0.3	2000	250
2CX9H-253F	25	+50/-30%	3.60	0.3	2000	250

1. Inductance measured @ 10KHz, 0.1V at 20°C temperature.
2. DCR measured @ 20°C.

**E Typical Attenuation Curves**

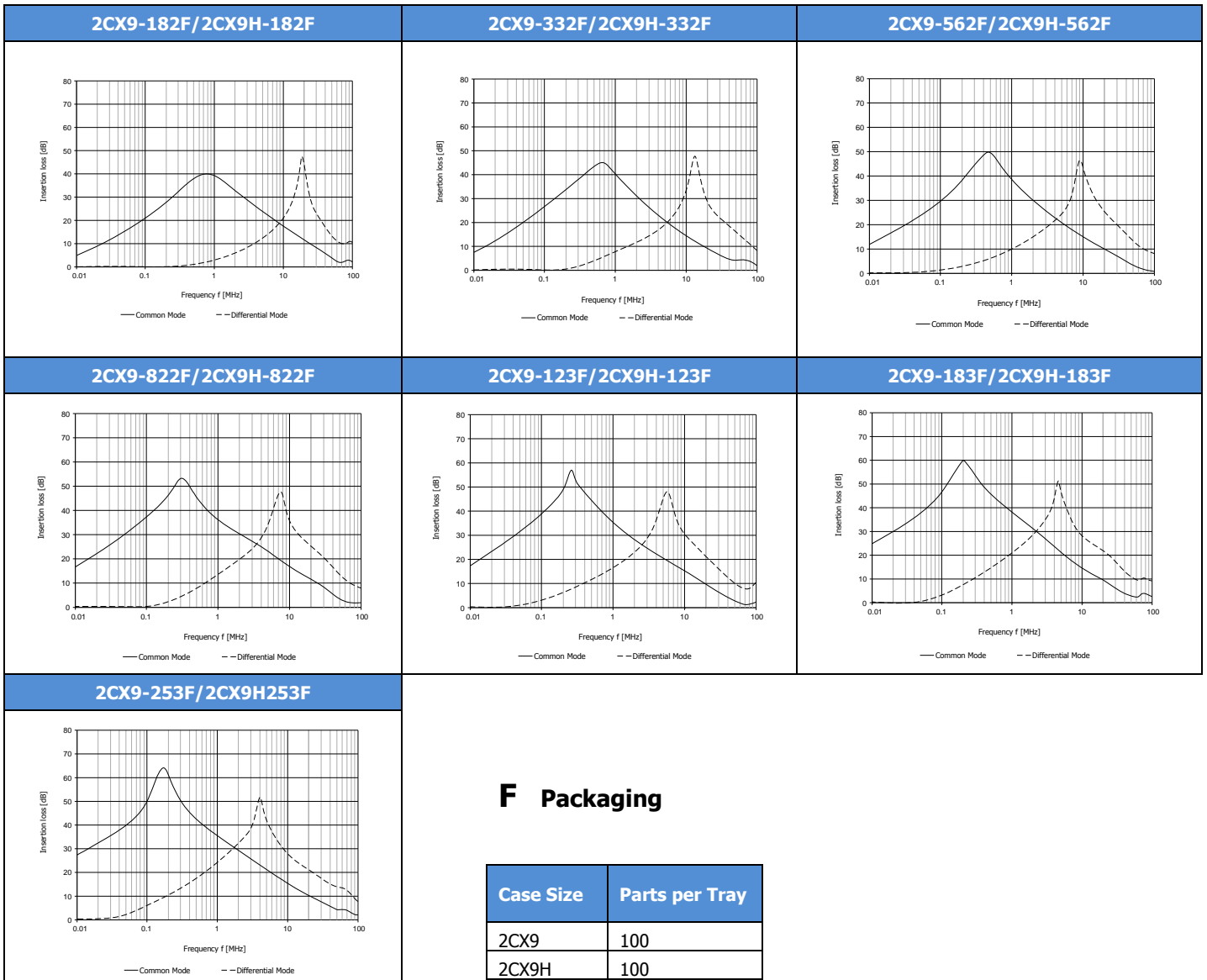

**F Packaging**

Case Size	Parts per Tray
2CX9	100
2CX9H	100