

Housing - HC-B 6-TFL-H-O1PG21S - 1460022

Please be informed that the data shown in this PDF Document is generated from our Online Catalog. Please find the complete data in the user's documentation. Our General Terms of Use for Downloads are valid (<http://download.phoenixcontact.com>)

HEAVYCON B6 sleeve housing, for single locking latch, height: 72 mm, with 1 x Pg21 gland, lateral cable outlet



Key commercial data

| | |
|----------------------|----------|
| Packing unit | 1 1 |
| Custom tariff number | 85389099 |
| Country of origin | Germany |

Technical data

Dimensions

| | |
|--------|-------|
| Height | 72 mm |
| Width | 43 mm |
| Length | 60 mm |

Ambient conditions

| | |
|---------------------------------|-------------------|
| Schutzart Gehäuse (IP) | IP65 |
| Ambient temperature (operation) | -40 °C ... 125 °C |

General

| | |
|------------------------------|--|
| Note | For contact inserts HC-B6, BB10, DD24, M |
| Design | B6 |
| Housing type | Sleeve housings |
| Locking type | for single locking latch |
| No. of cable exits | 1 |
| Cable exit | Lateral |
| Screw connection | None |
| Type of the screw connection | 1x Pg21 |
| Housing material | Aluminum die-cast |

Housing - HC-B 6-TFL-H-O1PG21S - 1460022

Technical data

General

| | |
|--------------------------|---------------------|
| Housing surface material | Powder-coated, gray |
|--------------------------|---------------------|

Classifications

eCl@ss

| | |
|------------|----------|
| eCl@ss 4.0 | 27140816 |
| eCl@ss 4.1 | 27140816 |
| eCl@ss 5.0 | 27143424 |
| eCl@ss 5.1 | 27143424 |
| eCl@ss 6.0 | 27143424 |
| eCl@ss 7.0 | 27440209 |
| eCl@ss 8.0 | 27440209 |

ETIM

| | |
|----------|----------|
| ETIM 3.0 | EC000437 |
| ETIM 4.0 | EC000437 |
| ETIM 5.0 | EC000437 |

UNSPSC

| | |
|---------------|----------|
| UNSPSC 6.01 | 31261502 |
| UNSPSC 7.0901 | 31261502 |
| UNSPSC 11 | 31261502 |
| UNSPSC 12.01 | 31261502 |
| UNSPSC 13.2 | 31261502 |

Drawings

Schematic diagram

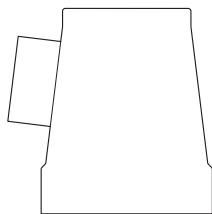

Dimensioned drawing

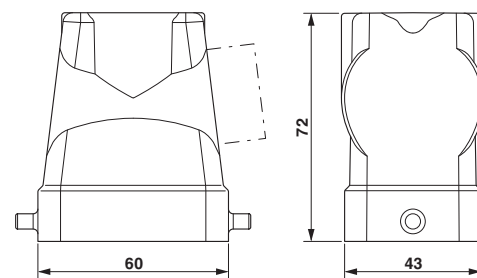

Dimensional drawing

