

### FEATURES

- Rating to 1000V PRV
- Surge overload rating to 70Amperes peak
- Ideal for printed circuit board
- Reliable low cost construction utilizing molded plastic technique results in inexpensive product
- Lead solderable per MIL-STD-202 method 208
- Plastic material has UL flammability classification 94V-O
- Glass passivated chip junctions

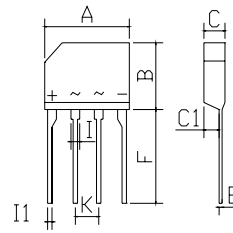

GBP		
Dim	Min	Max
A	14.45	14.85
B	10.30	10.70
C	3.45	3.75
C1	2.00	2.40
E	0.40	0.60
F	14.30	14.90
I	1.30	1.60
I1	0.60	0.90
K	3.75	4.30

All Dimensions in mm

### Maximum Ratings (@TA = 25°C unless otherwise specified)

Characteristic	Symbol	GBP 3005	GBP 301	GBP 302	GBP 304	GBP 306	GBP 307	GBP 308	GBP 310	UNITS
Maximum recurrent peak reverse voltage	$V_{RRM}$	50	100	200	400	600	700	800	1000	V
Maximum RMS voltage	$V_{RMS}$	35	70	140	280	420	490	560	700	V
Maximum DC blocking voltage	$V_{DC}$	50	100	200	400	600	700	800	1000	V
Maximum average forward Output current @TA=25°C	$I_{F(AV)}$	3.0								A
Peak forward surge current 8.3ms single half-sine-wave superimposed on rated load	$I_{FSM}$	70								A
I <sup>2</sup> t Rating for fusing @Tj=25°C	I <sup>2</sup> t	33.6								A <sup>2</sup> S

### Thermal Characteristics

Characteristic	Symbol	GBP 3005	GBP 301	GBP 302	GBP 304	GBP 306	GBP 307	GBP 308	GBP 310	UNITS
Typical Thermal Resistance (Note)	$R_{\theta JA}$ $R_{\theta JC}$ $R_{\theta JL}$	45 2.5 10								°C/W
Operating junction temperature range	$T_J$	- 55 ---- + 150								°C
Storage temperature range	$T_{STG}$	- 55 ---- + 150								°C

### Electrical Characteristics (@TA = 25°C unless otherwise specified)

Characteristic	Symbol	GBP 3005	GBP 301	GBP 302	GBP 304	GBP 306	GBP 307	GBP 308	GBP 310	UNITS
Maximum instantaneous forward voltage @3A	$V_F$	1.1								V
Maximum reverse current @TA=25°C at rated DC blocking voltage @TA=100°C	$I_R$	5.0 0.5								$\mu$ A mA

**RATINGS AND CHARACTERISTICS CURVES**

( $T_A = 25^\circ\text{C}$  unless otherwise noted)

**FIG1:Io-Tc Curve**

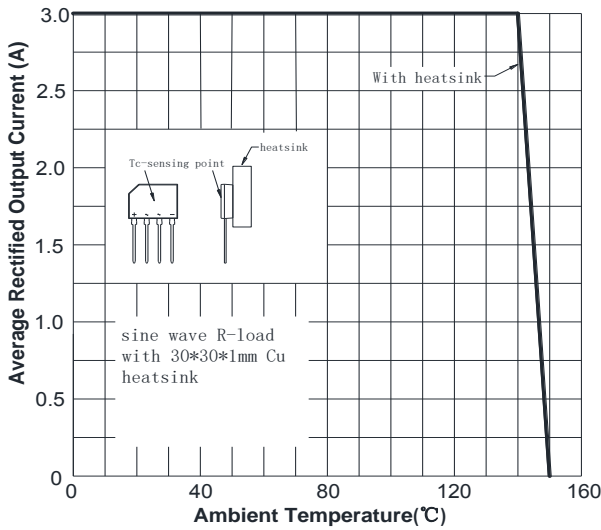

**FIG2:Surge Forward Current Capability**

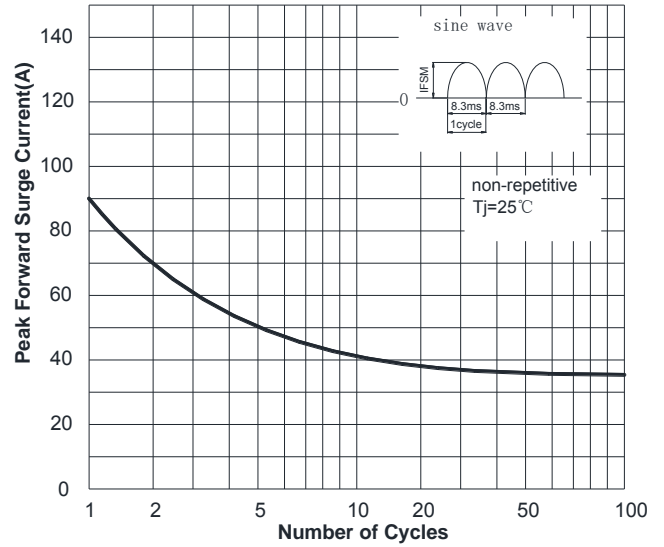

**FIG3: Forward Voltage**

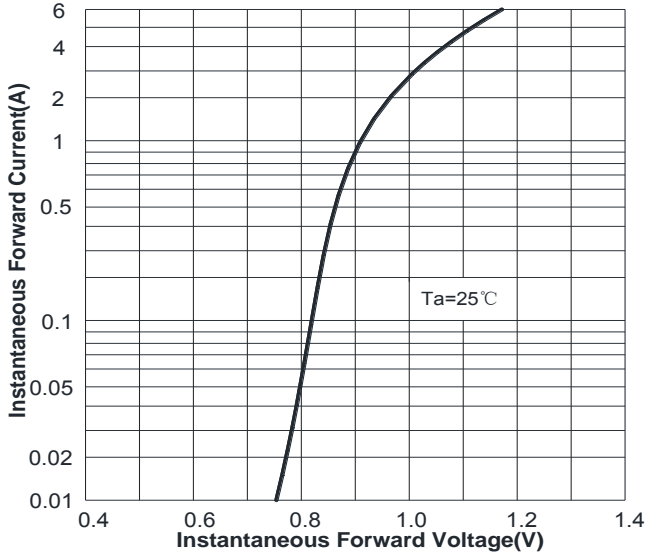

**FIG4:Typical Reverse Characteristics**

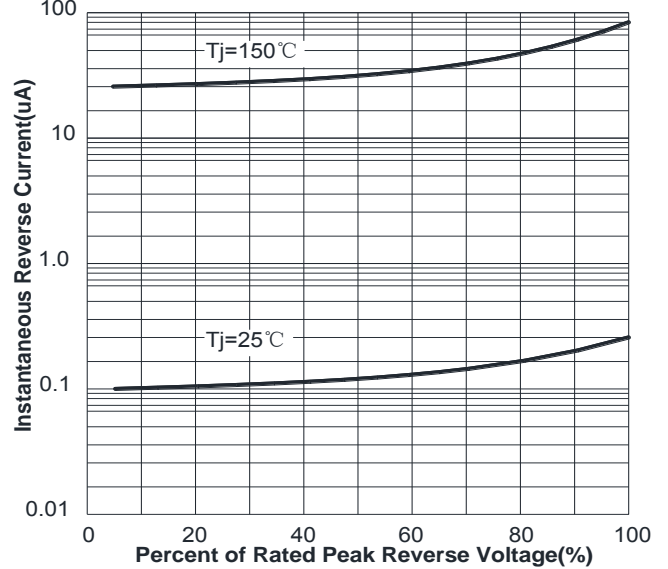

Device	Package	Shipping
GBP3005--GBP310	GBP	500Units/Box