

Specification.  
 \*Electrical Characteristics:  
 Current Rating:1.5A.  
 Withstanding Voltage:AC500V r.m.s.  
 Insulation Resistance:1000Megohms  
 Minimum at DC 500V  
 Contact Resistance:100Miliohms Maximum.  
 \*Mechanical Characteristics:  
 Mating Cyeles:5000 Insertions

PART NUMBER INFORMATION

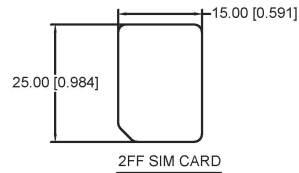

Connector terminal NO.	Pin NO.
Pin 1	VCC:PWR signal and GND
Pin 2	RST:Reset signal
Pin 3	CLK:Clocking signal
Pin 4	RESERVED
Pin 5	GND:PWR signal and GND
Pin 6	VCC:Porgramming Voltage
Pin 7	I/O:Serial date input/output
Pin 8	RESERVED

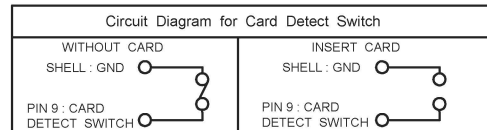
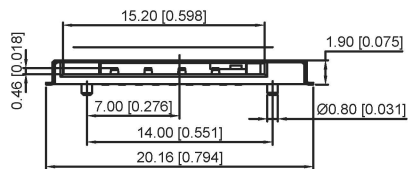

ITEM	PAPT NAMF	QTY	MATERIAL	FINISHING
③	Shell	1	SUS	
②	Terminal	9	COPPER ALLOY	
①	Housing	1	LCP UL 94V-0	BLACK

广东星坤科技股份有限公司

生效日期

文件工程章

日期

REVISIONS

www.hellokb.com www.hellokb.com www.hellokb.com

ANGLAR ±5°  
 L ≤ 4 ±0.2  
 4 < L ≤ 16 ±0.3  
 16 < L ≤ 63 ±0.4  
 L > 63 ±0.5

UNSPECIFIED TOLERANCES

DSND	DATE	SCALE: N/A	MODEL TYPE:
DWN	DATE	VIEW:	SIM CARD CONN
CHKD	DATE	UNIT: mm/in	PART NO.:
APPD	DATE	SIZE: A4	DWG NO.:
			XKSIM-220
			WEIGHT
			1.0g
			SHEET
			1/1
			REVISION
			A0

XKB INDUSTRIAL PRECISION CO., LIMITED